

Ontario Line

Pape-Cosburn and Minton Place CLC

June 17, 2026

AGENDA

Introduction

- Land Acknowledgement
- Safety Moment
- Session Guidelines

Cosburn Station Works

- Construction Update
- Monitoring Update
- Upcoming Works

Minton Place Tunnel Portal Works

- Construction Update
- Monitoring Update
- Upcoming Works

Don Valley Crossing Bridge Works

- Construction Update
- Upcoming Works

Action Items

- May 20, 2026, CLC meeting



Plaza in front of the future station entrance on Cosburn Avenue.

LAND ACKNOWLEDGEMENT

Metrolinx acknowledges that we connect communities by building and operating transit within the traditional lands of the Anishinaabe, the Haudenosaunee and the Wendat peoples, for whom these lands continue to have great importance.

Treaties between First Nations and governments cover these lands, and the promises contained in these Treaties remain relevant to this day.

Metrolinx and its employees are committed to understanding the history of these lands and the continued impacts of colonization and take responsibility for actions to advance reconciliation.

Metrolinx will continue to seek the knowledge, expertise and experience of Indigenous partners and commits to doing business in a manner that is built on a foundation of trust, respect, and collaboration.



Session Guidelines

We greatly appreciate the community members who are here to take part in this public session.

To ensure that everyone can contribute to a positive and safe community experience, all participants shall adhere to the following *Code of Conduct*:

- Treat the presenters and participants with respect and understanding
- Acknowledge and appreciate the diversity of individuals and their situations
- Refrain from supporting or engaging in any form of discriminatory behaviour

**Metrolinx is committed to fostering a safe and respectful environment.
We encourage respectful and constructive communication.**

Safety Moment – Student Safety Near Construction Zones

- Keeping communities safe during construction is our priority. To do this, site staff sometimes need to provide safety instructions to passersby, including students travelling to or from school.

Key Safety Reminders for Students:

- Always listen to and follow directions from traffic control personnel and construction workers.
- Stay alert and be cautious when walking near construction areas.
- Obey all posted signs and respect barriers—they are there for your protection.
- Let's work together to keep our students and community safe. Please remind students regularly about these important safety practices.



Cosburn Station Works

Cosburn Station Construction Update

- Site activities are currently focused on preparing for major excavation work.
- Ground improvement work called piling has been completed.
- Crews have started constructing shallow concrete structures called guide walls to maintain the alignment and stability of equipment while building slurry walls.
- Slurry walls are reinforced concrete walls constructed deep into the ground. These walls will support the surrounding soil and keep the excavation areas stable.
 - Slurry refers to the clay and water mixture used to temporarily stabilize a trench while concrete is poured to create the wall. As concrete fills the trench, the slurry is pumped out.
- Drill rigs, excavators, cranes, loaders, concrete trucks, dump trucks and other machinery will be required to complete this work.
- Work will be conducted weekdays from 7 a.m. to 11 p.m. Some weekend work may be required.
- On average once per month, the delivery of oversized equipment may take place overnight during off-peak hours when vehicle and pedestrian traffic is minimal.



Cosburn Station Site - June 2026

Cosburn Station Traffic Changes Status Update

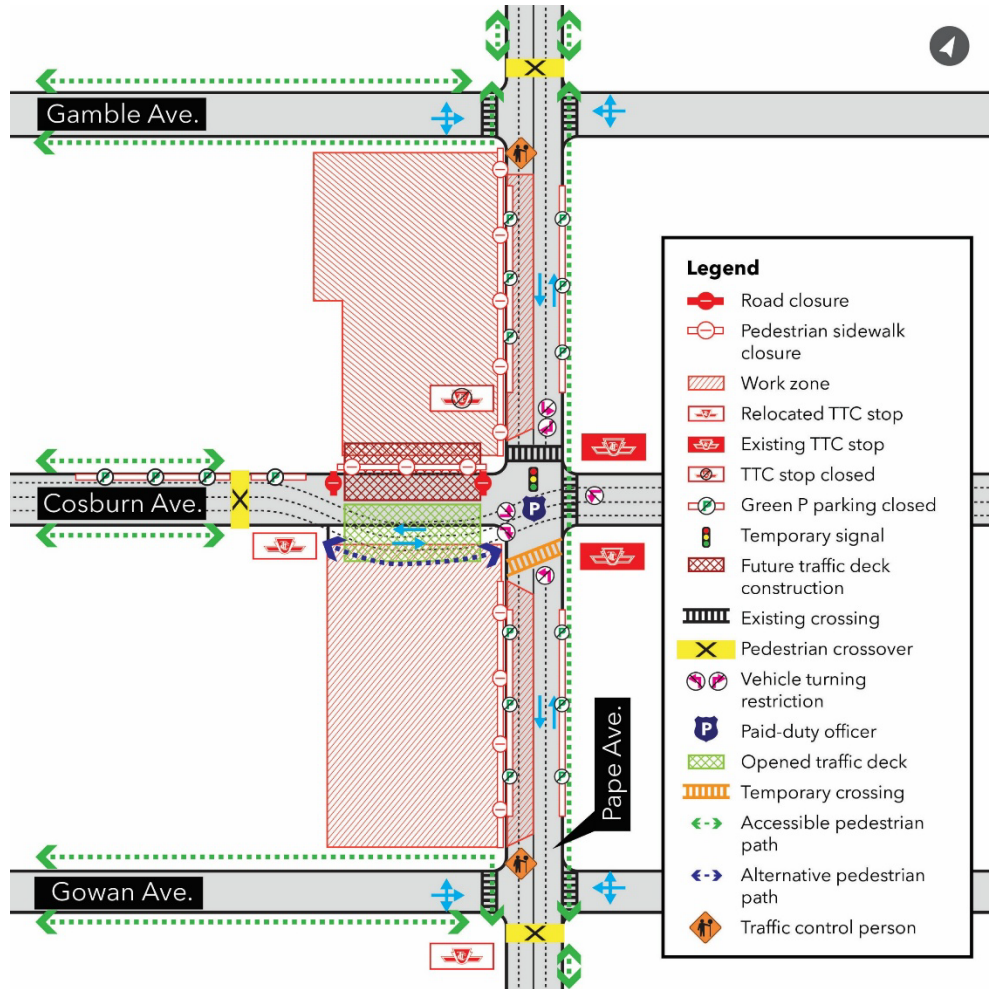

- Work to construct the signalized pedestrian crossovers (PXOs) on Pape Avenue north of Gamble Avenue, south of Gowan Avenue and west of Pape Avenue on Cosburn Avenue has begun.
- Crews will also install temporary traffic signals at the intersection of Pape Avenue and Cosburn Avenue. The intersection will remain open while this work is completed.
- The work to install the temporary traffic signals and construct the signalized pedestrian crossovers are projected to take approximately 3 months. This work will take place during weekdays from 7 a.m. to 7 p.m.
- The eastbound 87 Cosburn bus stop has been temporarily moved east of Pape Avenue to accommodate Enbridge gas main relocation activities and the construction of the pedestrian crossover. Once these activities are completed, this bus stop will be relocated near 101 Cosburn Avenue.
- Two traffic lanes and the west sidewalk on Pape Avenue between Gamble Avenue and Gowan Avenue will be closed by the end of June or early July. This will expand the site to support the construction activities. Concrete barriers and noise walls will be installed along Pape Avenue.
- Traffic control persons will be present during active construction hours and when construction vehicle movements require traffic or pedestrian control.

Monitoring Summary – May 2026 (Cosburn Station)

- There were no continuous noise, vibration or outdoor air quality spikes related to PNC activities throughout the month of May.

Cosburn Station – Upcoming Works

#	Activity	Location	Expected Start	Expected Duration	Impact	Hours of Work	Mitigations
1	Support of Excavation	Cosburn site	Winter 2026	21 months	Vibration, noise, air quality, traffic, lane and sidewalk closures	7:00 am - 11:00 pm	Noise, vibration and air quality monitoring. Permanent hoarding. Dust mitigation includes street spraying and sweeping, work stoppage during high winds.
2	Utility Pole Removals (Toronto Hydro)	Cosburn site	April 13	3 months	Vibration, noise, traffic, lane and sidewalk closures	Weekdays 7:00 am - 7:00 pm	Traffic control persons, safety signage. Contact Toronto Hydro to report concerns with construction activity 416-542-8000
3	Geotechnical Monitoring Equipment Installations	Cosburn site	May 14	1-2 months	Dust, noise, lane and sidewalk closures	Weekdays 8:00 am - 5:00 pm 9:00 pm - 5:00 am	Traffic control persons. Dust mitigation includes misting, sweeping and hydrovac trucks. Erosion and sediment control.
4	Temporary Traffic Signals and Pedestrian Crossover Installations	Cosburn site	June 10	3 months	Traffic, temporary lane and sidewalk closures	Weekdays 7:00 am - 7:00 pm	Traffic control persons, paid duty officer, safety signage.



Minton Place Tunnel Portal Works

Minton Portal – Monthly Progress

- The Minton Place portal for the Ontario Line will serve as the point where the underground tunnels emerge at the eastern embankment of the Don Valley, transitioning onto the Don Valley Crossing bridge. This structure will connect the Pape tunnel section with the elevated part of the Ontario Line that spans the Don Valley.
- Excavation for Bench 3 has been completed, with more than 1,500 m³ of soil exported.
- The Shotcrete Facing Wall has been poured along the East Wall.
- The drill pad has been completed, and drilling of secant piles has commenced for Bench 3.
- 11 Filler Piles have been installed out of total of 22 piles at Bench 3.
- Riprap and drainage works at the bottom of the Minton slope were completed during the weekend DVP closure.





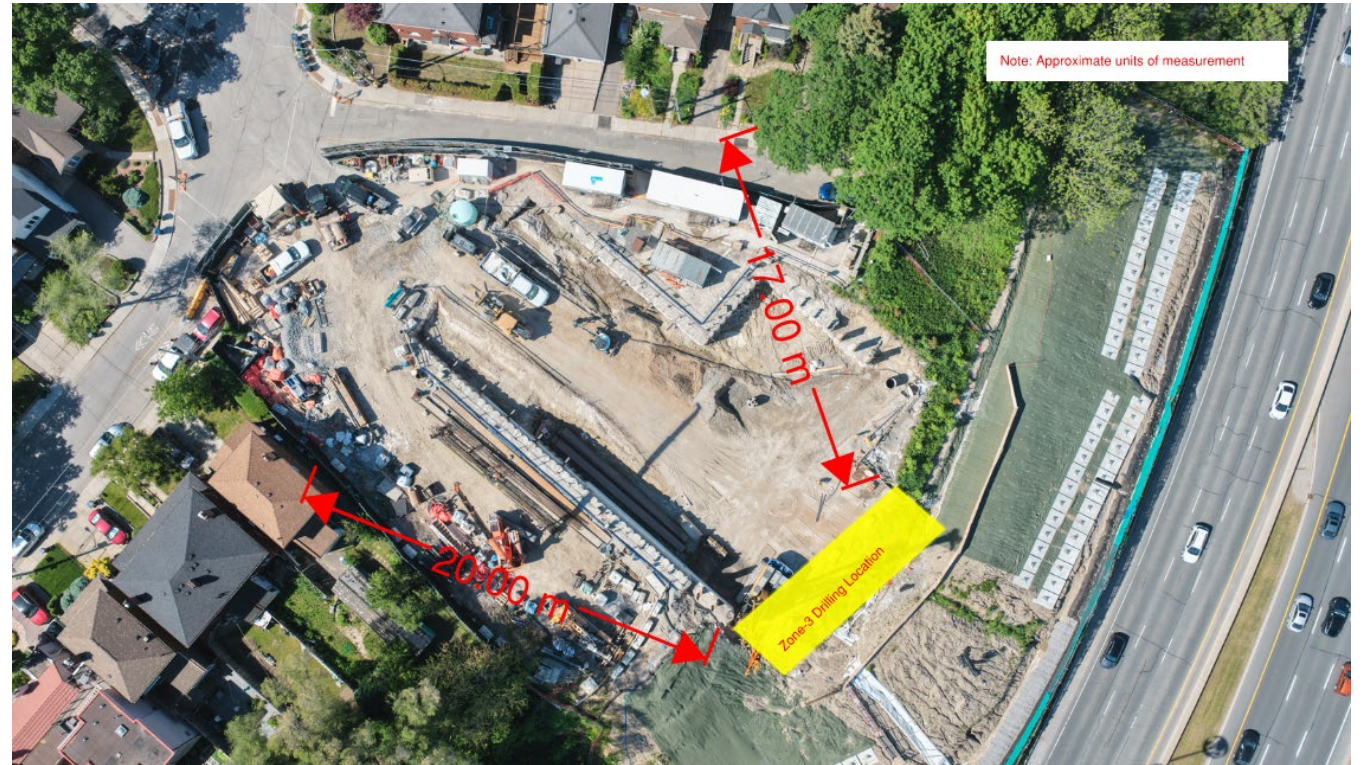

Minton Portal – Upcoming Bench 4 Planning

- Secant pile drilling at Bench-3 is expected to be completed by mid June, which will be followed by excavation for the next available tieback anchor.
- Nearly 1,500 m³ of soil will be exported in the upcoming months to reach the next elevation level, EL 115.
- Approximately 40 tieback anchors will be installed from EL 117 and EL 115.
- Once tieback anchors are proof tested, secant pile drilling will resume at EL 115.
- A total of 8 piles will be installed from Bench-4.

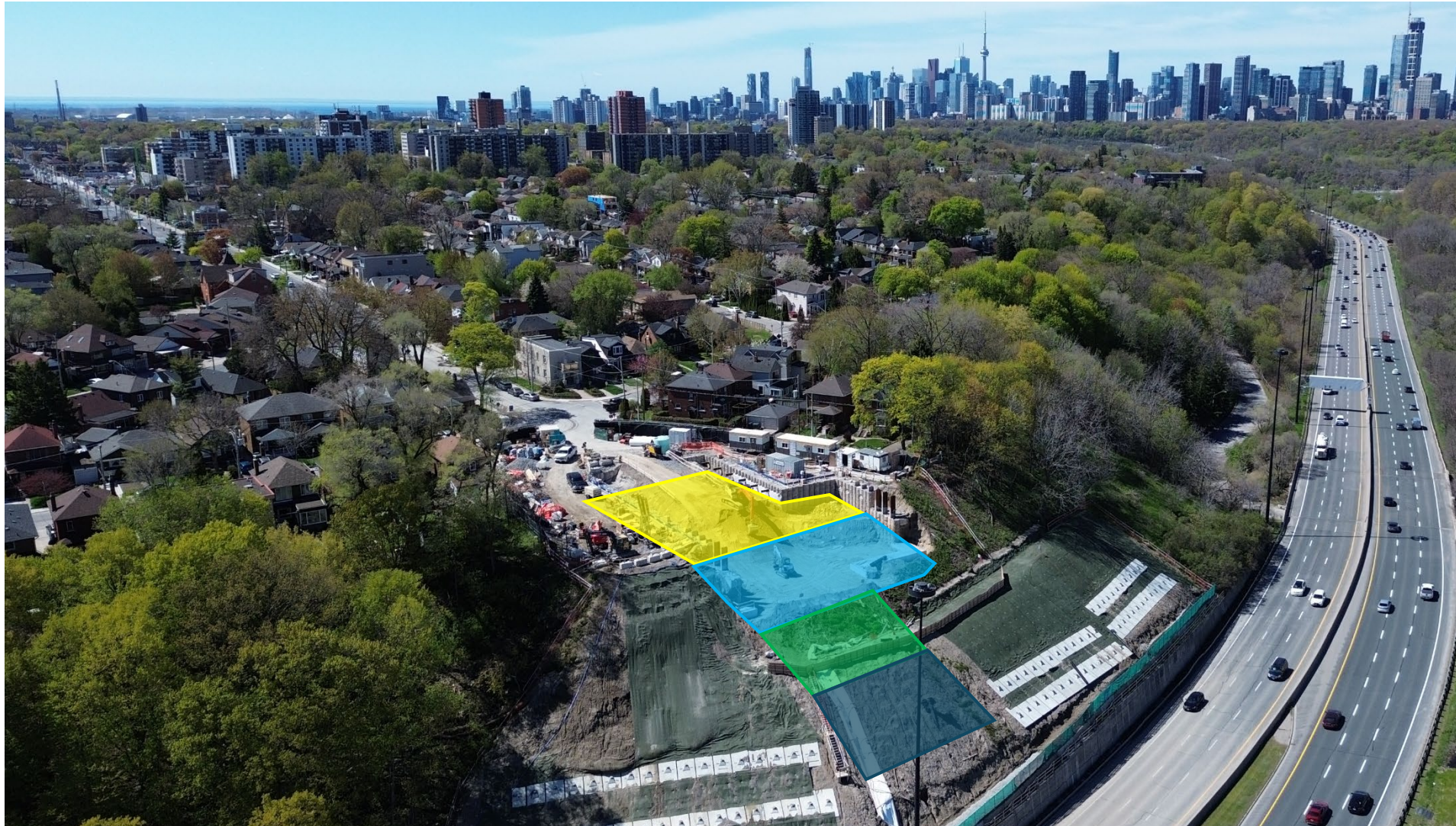

Minton Portal - Zones



-  Zone 1
-  Zone 2
-  Zone 3
-  Zone 4

Monitoring Summary – May 2026 (Minton Place Tunnel Portal Works)

- Noise-related spikes were recorded near the Minton Place Tunnel Portal Works monitoring locations.
- These increases were primarily associated with a worker tapping a perimeter fence and carpentry work (hammering nails and wood) next to the monitor.
- To mitigate these impacts, the following measures were implemented:
 - Workers were instructed not to tap the perimeter fence.
 - Carpentry work has stopped in the immediate area of the noise monitor.

Eight Week Look-Ahead

#	Activity	Location	Expected Start	Expected Duration	Impact	Hours of Work	Mitigations
1	Tieback Anchor Drilling and Portal SOE Excavation	Minton Portal	December 1, 2025	1 year	Vehicular traffic, vibration, noise	7:00 am 5:30 pm**	Monitoring of traffic control plans, traffic control personnel, vibration monitoring, noise monitoring
2	Zone-2,3,4 Secant Pile Installation	Minton Portal	February 1, 2026	1 Year			Echo barriers were installed since previous piling scope.

*** Please note that, given the unpredictable nature of subsurface conditions, extended hours may be required on weekdays. Crews will do their best to complete construction activities by 5:30pm, but extended hours until 7:00pm may be required at times. Saturday works will occur from 9:00am to 7:00pm.*

Bridge Construction (Don Valley Crossing)

Don Valley Crossing – Monthly Progress

The Don Valley Crossing (DVC) bridge over the Don Valley Parkway is in the pier construction stage that includes piling, concrete lifts and pier construction. Five piers will be constructed and construction updates for each are provided below:

Pier A1: Secant pile wall construction continued, with **67 of 70 filler piles (96%)** and **19 of 47 king piles (40%)** completed. Work is progressing toward completion of the secant pile wall and commencement of excavation for tieback installation.

Pier A2: Rebar installation for the sixth lift is underway. Once rebar is ready, the sixth concrete lift will take place. Construction of the first phase of the pier table will commence following the sixth lift pour.

Pier A3: The second concrete lift has been completed. Rebar installation in preparation for the third concrete lift is currently underway.

Pier A4: Preparatory works continue at Pier A4, with the first concrete lift expected to occur in August.

Pier A5: Caisson pile construction has been completed. Construction of the permanent facing wall is underway, including excavation, reinforcement installation, and concrete works.



Don Valley Crossing – What the site looks like now



Eight Week Look Ahead

#	Activity	Location	Expected Start	Expected Duration	Impact	Hours of Work	Mitigations
1	Secant Pile	Don Valley Crossing (Pier A1)	December 2025	Six months	Noise, Vibration, Air Quality	7:00 am – 5:30 pm	Monitoring noise and air quality levels. Enacting noise mitigation controls and dust suppression as required.
2	Tieback Installation	Don Valley Crossing (Pier A1)	July 2026	One months			
3	Pier Construction	Don Valley Crossing (Pier A2)	November 2025	Seven months			
4	Pier Table Construction	Don Valley Crossing (Pier A2)	June 2026	Eight months			
5	Pier Construction	Don Valley Crossing (Pier A3)	March 2026	Ten months			
6	Pier Construction	Don Valley Crossing (Pier A4)	August 2026	Three months			
7	Permanent Facing Wall	Don Valley Crossing (Pier A5)	May 2026	Two Months			
8	Pile cap Installation	Don Valley Crossing (Pier A5)	August 2026	Two Months			

Action Items

#	Action Item	Response/Resolution	Status
1	Request for Metrolinx to organize onsite discussion regarding vibration concerns at Minton Place.	Metrolinx Response: Metrolinx will follow up with the resident regarding how and when this request can be accommodated.	In Progress
2	Metrolinx to provide information regarding what training truck drivers are receiving?	Metrolinx Response: As per the Ontario Line Truck Safety Plan , truck drivers of (sub)contractors are briefed primarily on public safety requirements and designated truck routes. As part of operations, drivers sign a form at the gate confirming that they have reviewed and acknowledged all related items.	Completed
3	Request for Metrolinx to re-instate traffic flaggers on Hopedale and Stanhope avenues.	Metrolinx Response: If an upward trend in haul route deviation incidents is reported, Metrolinx will consider reinstating flaggers as a potential mitigation measure.	Completed



Discussion

