

Partial Lane/Sidewalk Closures on York Street

October 11 - 27

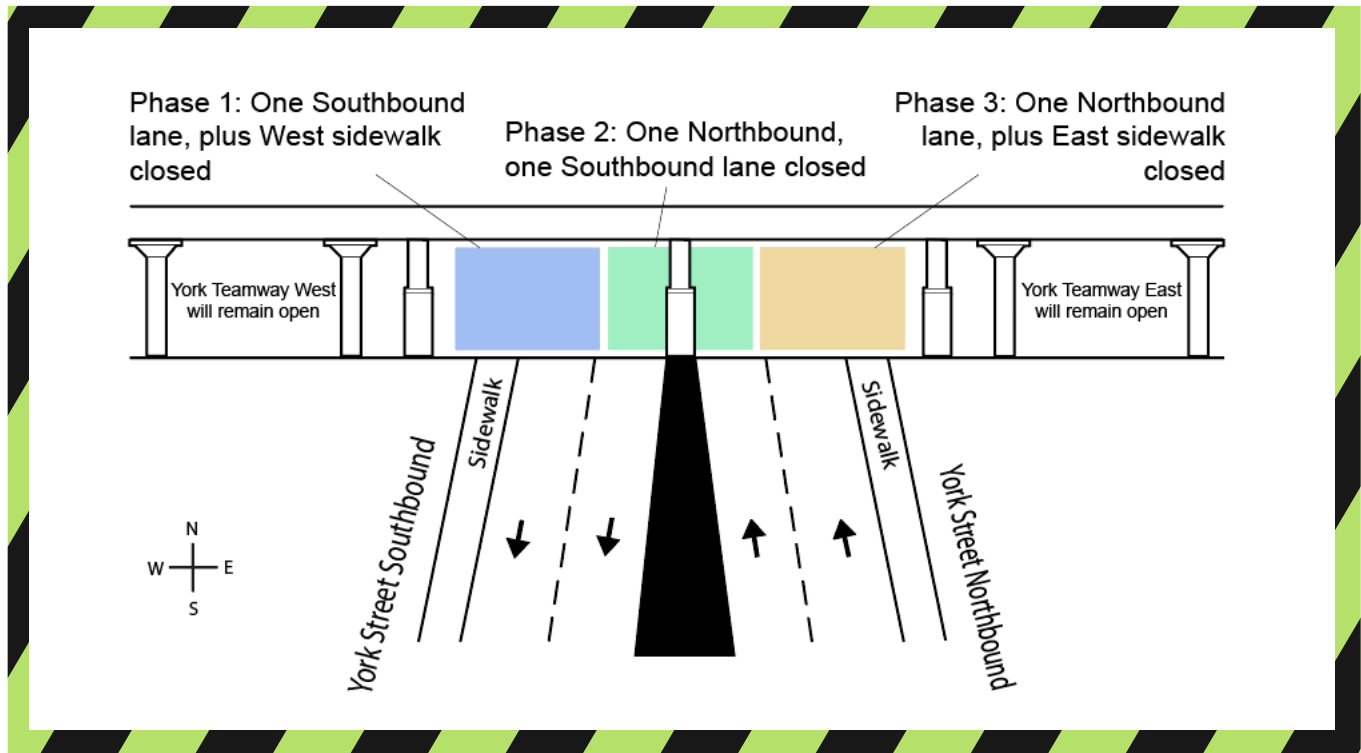

Figure 1. shows the phased partial lane/sidewalk closures on York Street (looking North) for the Union Station Enhancement Project (USEP). Not to scale.

Background

Work has already started at Union Station to get you where you need to go, better, faster, and easier. The Union Station Enhancement Project (USEP) is being completed in phases to deliver the required infrastructure needed to enable two-way, all-day service every 15 minutes or better along core segments of the GO rail network.

The USEP includes a new southern passenger concourse, wider platforms for customers and improved access. A more modernized and convenient open concept south passenger concourse will provide smoother, easier customer connections.

For more information on the Union Station Enhancement Project, please visit:

www.metrolinx.com/UnionStation

What work is taking place?

- North and Southbound lanes on York Street will be closed in a phased approach from west to east while the demolition of the Union Station platforms takes place on the track level above.
- This is a public safety protective measure to allow demolition to take place during the day and avoid extended noise impacts overnight. Spotters will be present during working hours on the sidewalk. North and southbound through traffic will be maintained at all times (down to 1 lane depending on the phase).

When is the work taking place?

- October 11 - 27, 2022
- 7:00 AM - 11:00 PM
- Work may be rescheduled or extended due to weather conditions or unforeseen circumstances.

Where is the work taking place?

- Demolition is taking place at track level above the southern half the York Street bridge within the USEP work area.

Phasing of lane closures (west to east):

- Phase 1 - Close the York West outdoor sidewalk and west Southbound lane.
- Phase 2 - Close the east south bound lane and the west Northbound lane.
- Phase 3 - Close the York east outdoor sidewalk and the east Northbound lane.

Questions

- If you have any questions about this work or would like to be included on future email communications from us, please call us at 416-202-6911 or email us at: TorontoWest@metrolinx.com

When near construction areas, please be safe and respect all safety measures in place.

Thank you for your patience as we work to transform the rail corridor in your area.

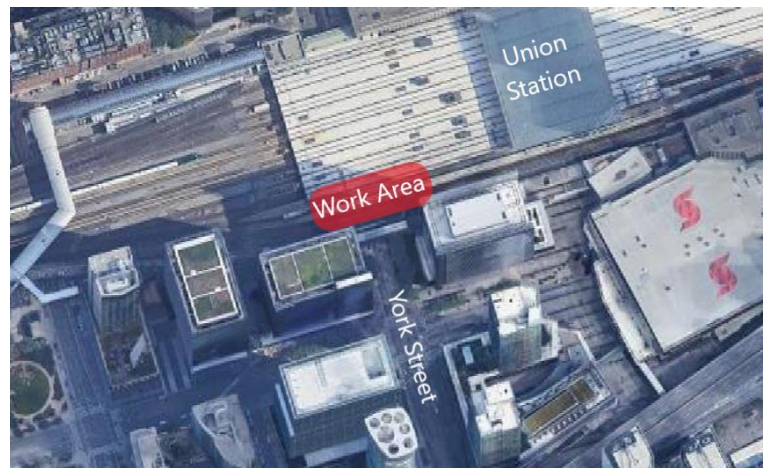

This construction notice can be translated into a different language upon request by emailing us at TorontoWest@metrolinx.com

Cet avis de travaux de construction est disponible en français. Si vous êtes intéressé, veuillez envoyer un courriel à TorontoWest@metrolinx.com

Write to us at: TorontoWest@metrolinx.com

Call us: 416-202-6911

Find us on Twitter @GOExpansion

Visit the website: www.metrolinx.com/unionstation

Subscribe to the Toronto West E-blast: www.metrolinx.com/subscribe