

GO Expansion

Davenport Diamond Greenway

Live Virtual Event

November 24, 2022

7 p.m – 8:30 p.m

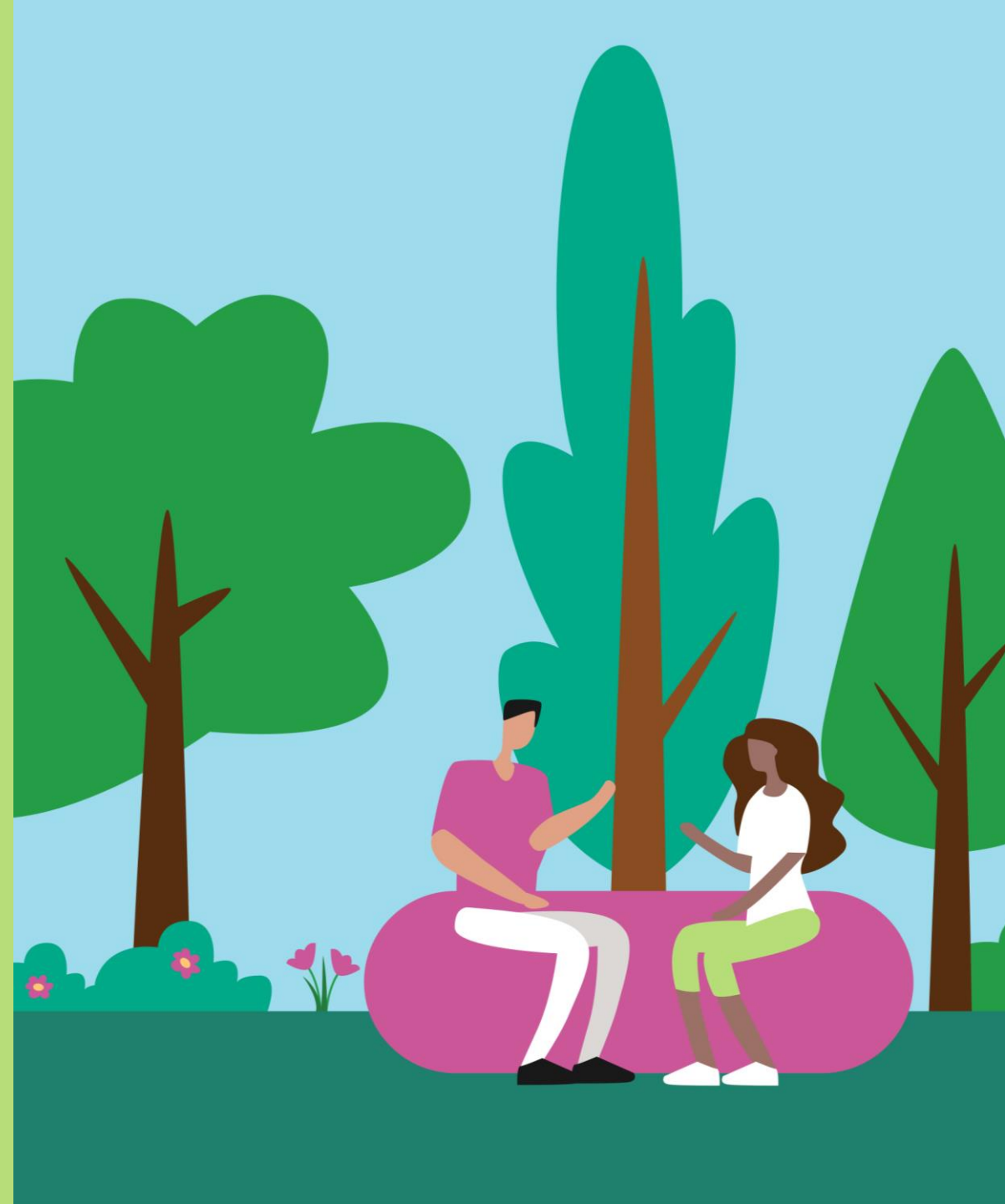

AGENDA: November 24, 2022

- Welcome
- Land Acknowledgment
- Safety Moment
- Introductions and Greenway Design Update
 - **Greenway Detailed Design**
 - **Updated Views**
 - **Landscape & Planting – Community Conversation**
 - **Community Engagement – update + upcoming events**
- Panel Q and A

LAND ACKNOWLEDGMENT

Let us take a moment to acknowledge we are on lands that have been, and continue to be, home to many Indigenous Peoples including the Anishnabeg, the Haudenosaunee and the Huron-Wendat peoples.

We are all Treaty people. Many of us have come here as settlers, as immigrants or involuntarily as part of the trans-Atlantic slave trade, in this generation, or generations past.

We acknowledge the historic and continued impacts of colonization and the need to work towards meaningful reconciliation with the original caretakers of this land.

We acknowledge that Metrolinx operates on territories and lands covered by many treaties that affirm and value the rights of Indigenous communities, Nations and Peoples.

We understand the importance of working towards reconciliation with the original caretakers of this land. At Metrolinx, we will conduct business in a manner that is built on a foundation of trust, respect and collaboration

SAFETY MOMENT



Introductions and Greenway Design Update

Greenway Detail Design

- Work is proceeding on 95% detail design;
- Construction detailing of design elements and civil / structural / lighting infrastructure;
- Ongoing meetings with City of Toronto to review key elements – the Dog Off Leash Area, the raised Dupont sidewalk, connections to Davenport Village Park, and Davenport Road.
- Updated and new views of the Public Realm.



New and updated Views of the Public Realm - Looking North Across Campbell Park



Evening Views - Looking north across Campbell Park



New and updated Views of the Public Realm – looking northeast from Campbell Park



New and updated Views - Paton Road Underpass



New and updated Views - Multi-Use Path South of Wallace Avenue



New and updated Views - Market Square at Wallace Avenue



New and updated Views - Pedestrian Bridge over CP Rail



Davenport Diamond Public Realm - Connection Points



-  Davenport Diamond Guideway and Greenway
-  Key Greenway Connection Points
-  Employment Areas
-  Parks and Public Amenities

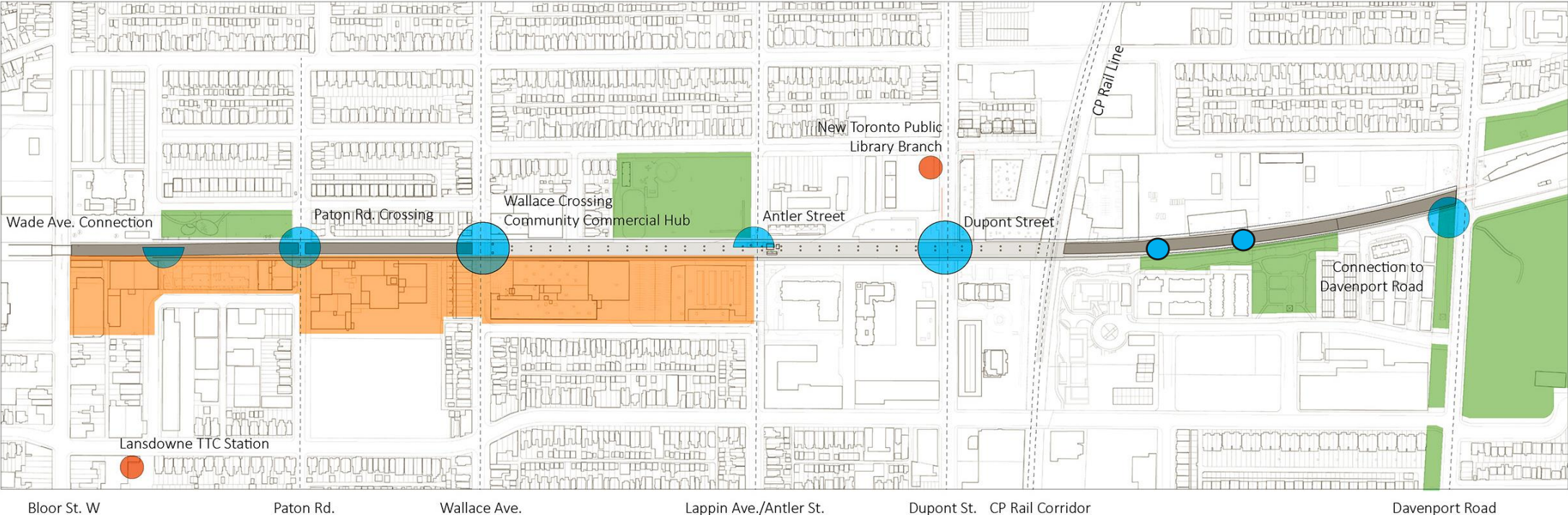

Pedestrian Connections at Dupont Street Sidewalk

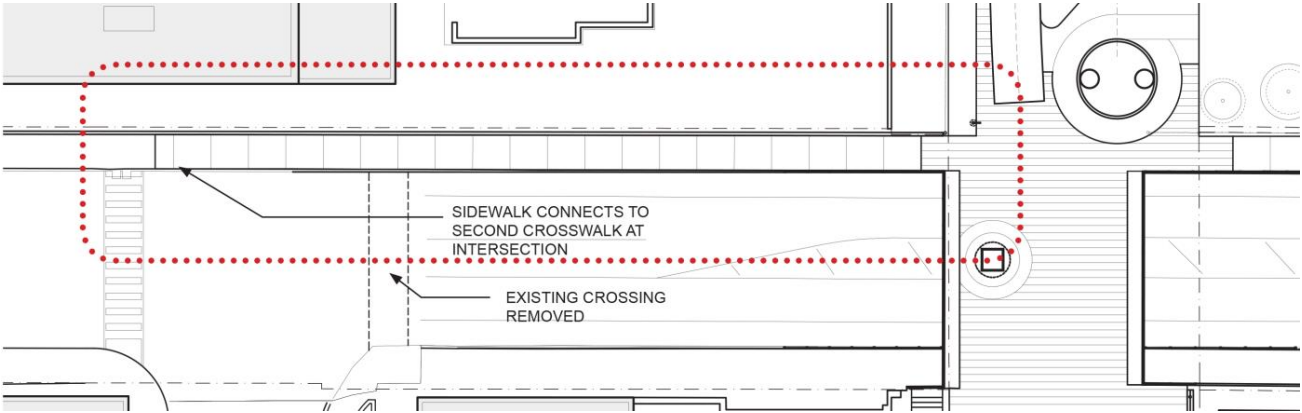

Pedestrian Connections at Dupont Street Sidewalk

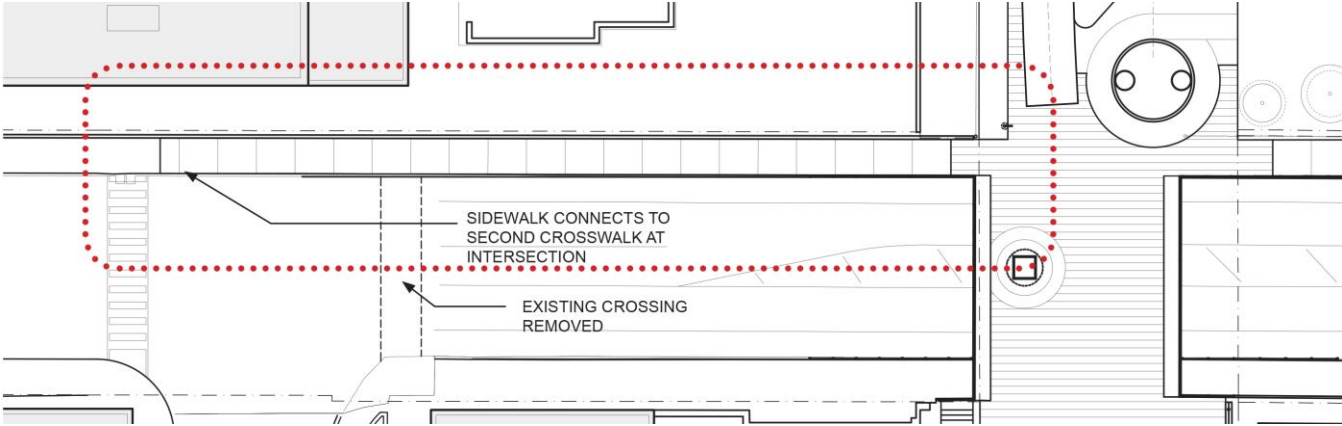
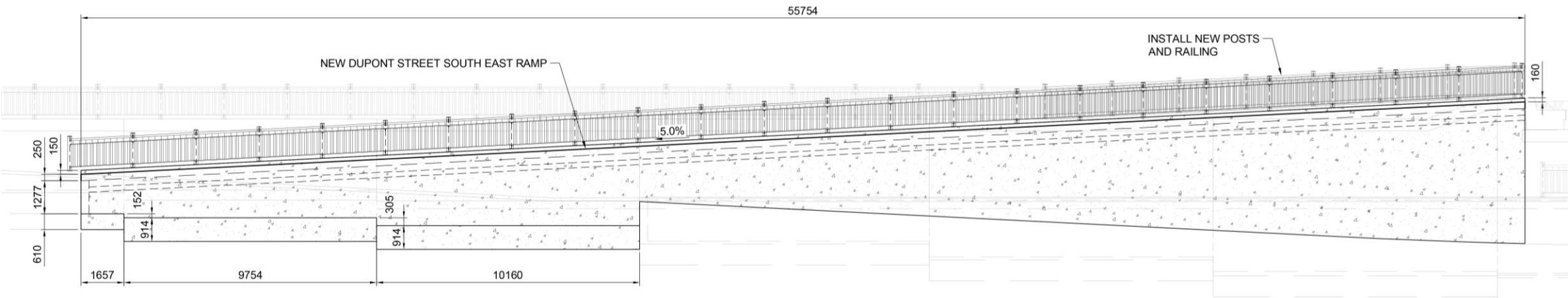

East Sidewalk

Pedestrian Connections at Dupont Street Sidewalk

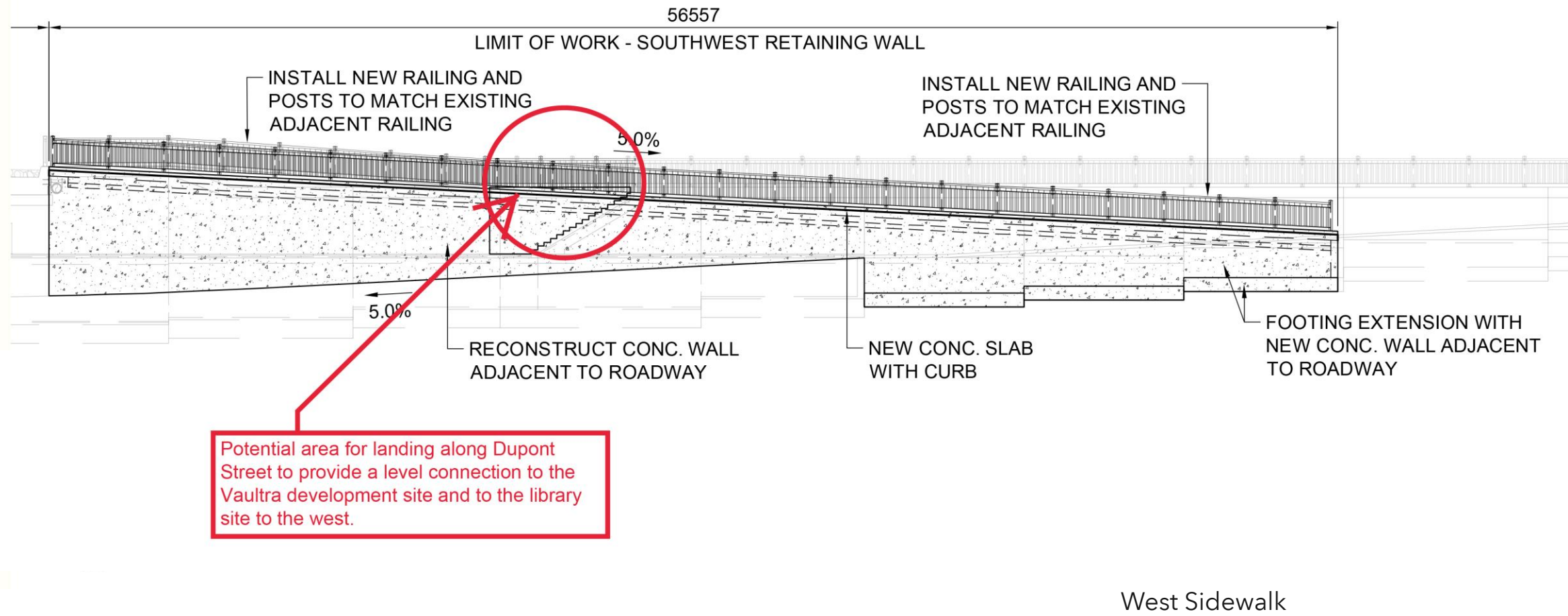

Pedestrian Connections at Davenport Village Park

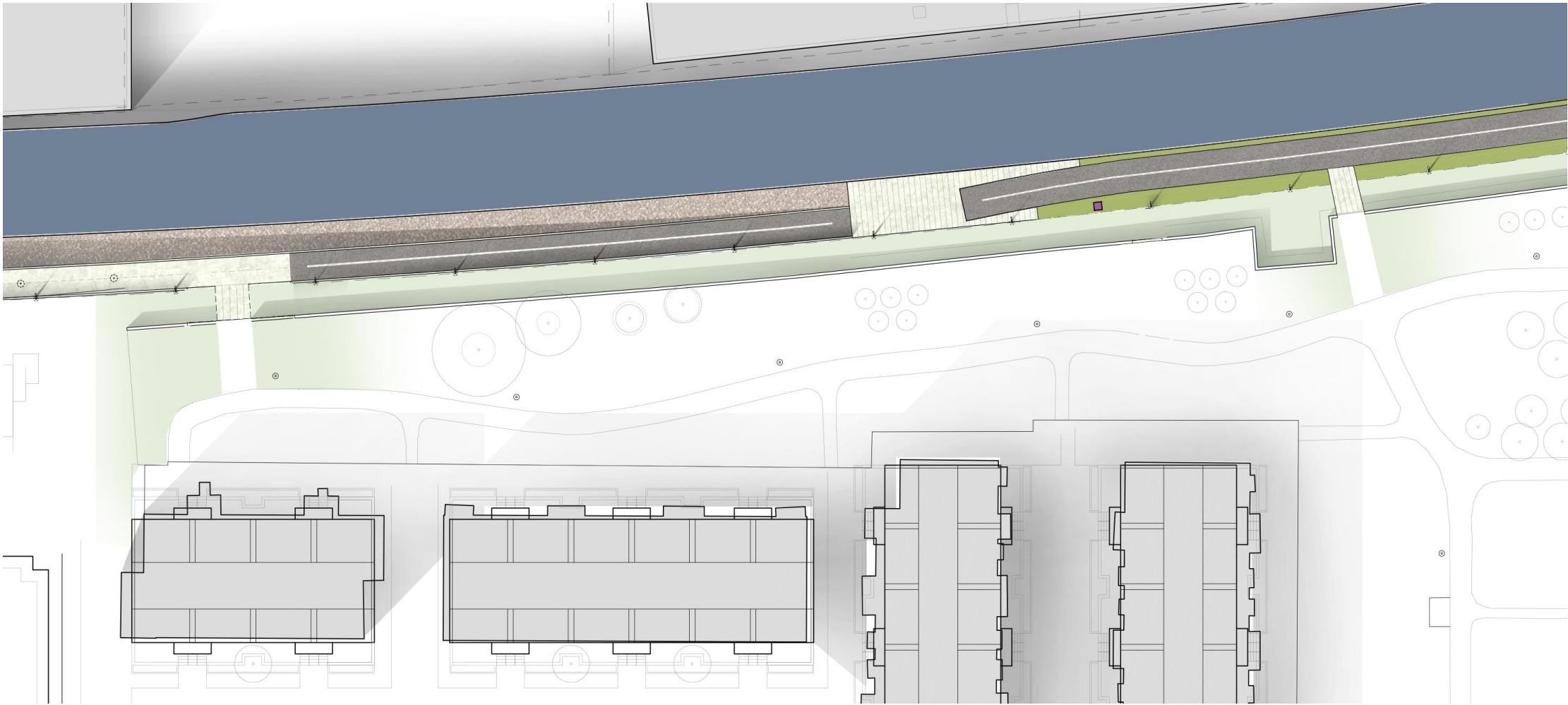

Pedestrian Ramp at Davenport Road

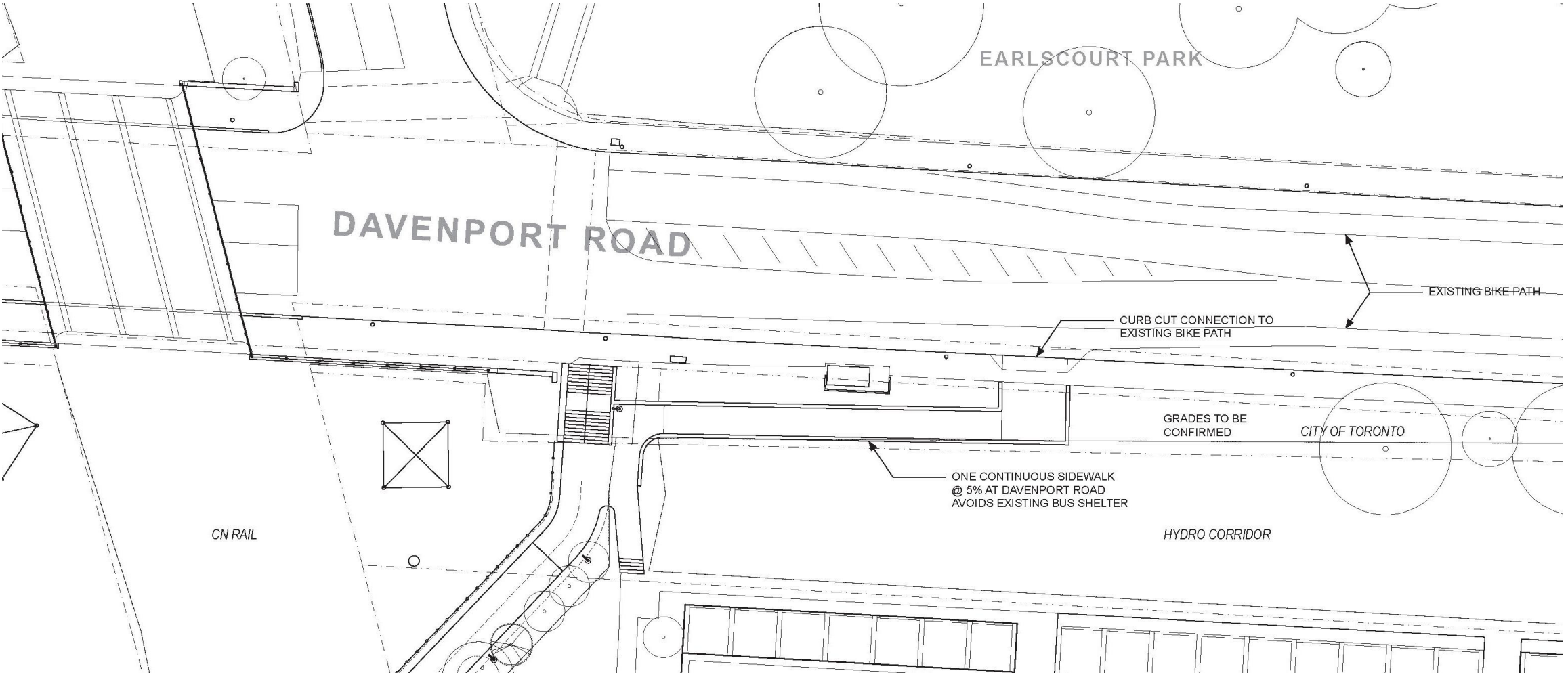

Pedestrian Ramp at Davenport Road at Caledonia Park Road



Landscape and Planting Update

Community Conversation

GO Expansion

Davenport Diamond Greenway Community Conversation: Plants and Pollinators

April 28, 2022 | 7:00 PM to 8:30 PM



Typical Greenway Plan & Section



Hardscape vs. Softscape

- Between Wallace and the Dupont ramp, soft landscape represents 58% of the overall surface.
- Without the MUT, the soft landscape represents 70% of the overall surface.



Landscape and Planting Types in Section

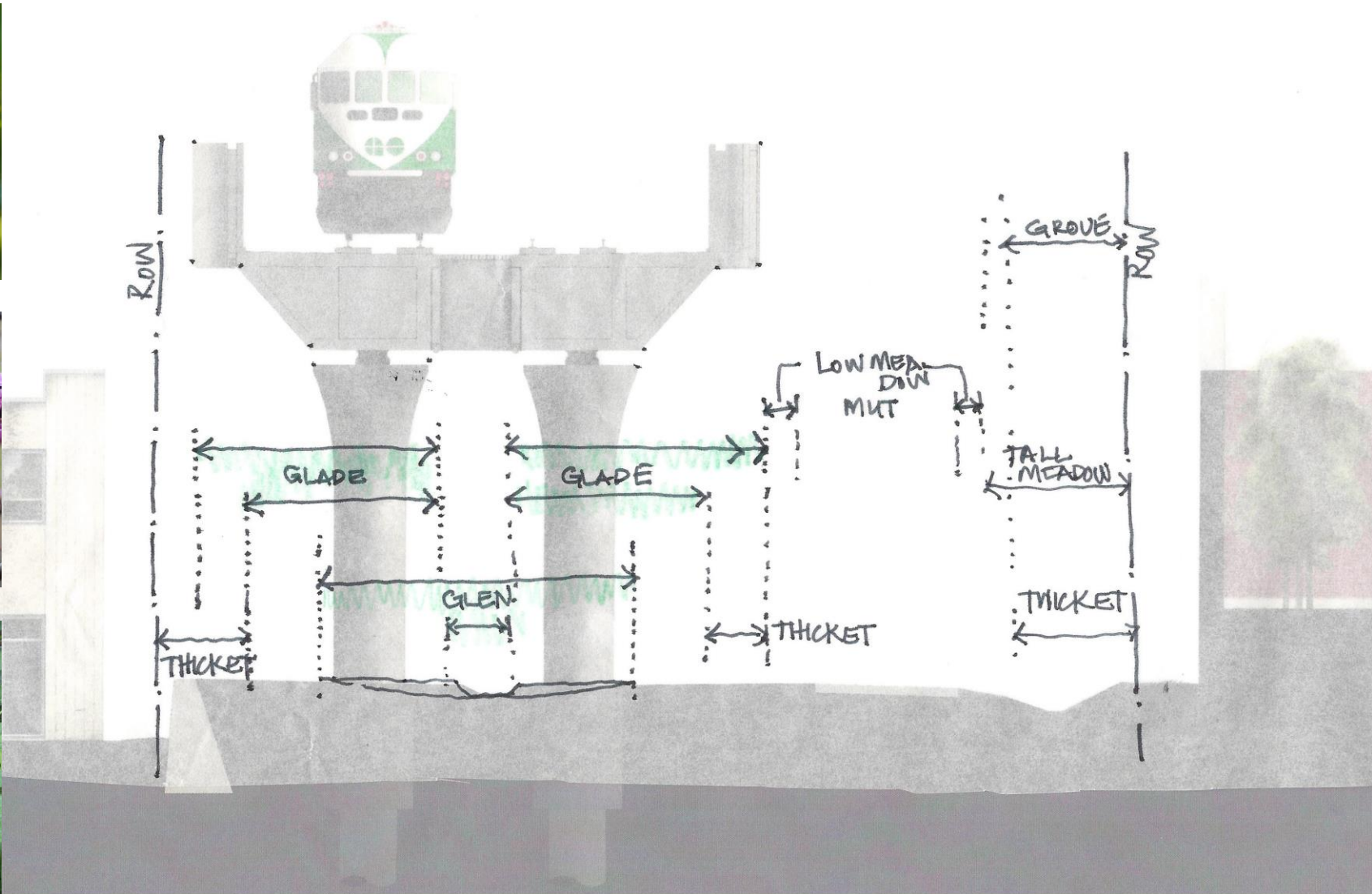
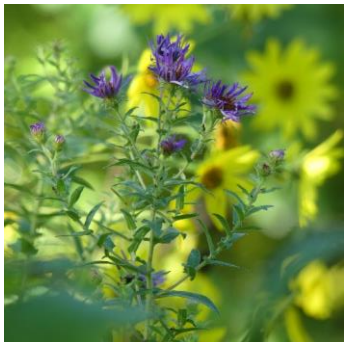

Meadow

Open habitat with succession of blooms providing nectar and pollen for beneficial insects. The soil can be wet or dry with the super foods for pollinators of sunflowers, asters and goldenrods. Protected by a mown buffer edge where it meets the trail.

Glade

A low-growing shade-tolerant habitat that will allow accessible views in all directions across the site. The glade is comprised of understory plants that provide nectar and pollen for beneficial insects along with protective cover for small animals.

Glen

A swale of varying widths planted with water-filtering shade-tolerant understory plants such as Carex species. These plantings filter runoff and stormwater.



Sunny
Dry or wet
Cut to prevent weed trees
200-2200 mm tall

goldenrod,
grasses, milkweed,
sedges, asters

Shaded
Moist
Self-sustaining
200-900 mm tall

bergamot,
bottlebrush,
milkweed, wood
poppy, wild violets

Shade
d Wet
Self sustaining
150-300 mm
tall

sedges, snakeroot,
spiderwort, asters,
waterleaf,
anemones

Graffiti Update

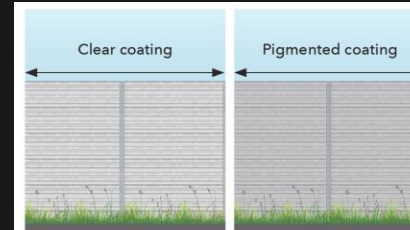

Figure 1: Graffiti resistant coatings (note: coatings result in minor visual impacts)



Figure 2: Murals and supergraphics have a successful track record in reducing graffiti vandalism



Figure 3: Vines and plantings to deter access or limit exposed surfaces

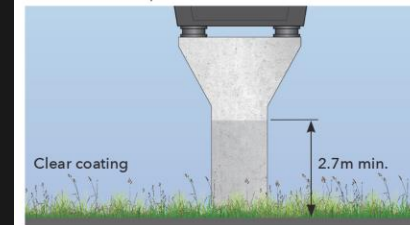

Figure 4: Clear anti-graffiti coating applied to a pier up 2.7m above grade (minimum)

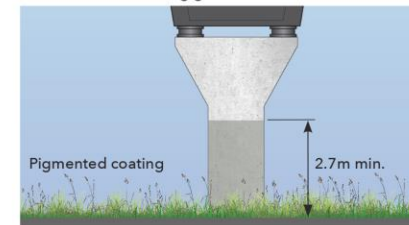

Figure 5: Pigmented (grey or coloured) anti-graffiti coating applied to a pier up 2.7m above grade (minimum)



Figure 6: Piers and columns can be painted with murals to deter graffiti



Figure 7: Restrict access to walls, columns, and other vulnerable surfaces



Figure 8: Lighting and clear sightlines



Figure 9: an example of lighting design and murals used in combination to deter graffiti and tagging

Community Engagement: Next Steps

1. Ongoing CLC meetings and Project Website updates
2. Community Pop-ups and Community Engagement contact:

Twitter.com/GOExpansion
Metrolinx.com/Subscribe
Metrolinx.com/Davenport
TorontoWest@Metrolinx.com
416-202-6911

Davenport Diamond Greenway Design Schedule

Stage 1	Preliminary Design	25%	April – September 2021 - Completed
Stage 2	Detail Design	50 / 75%	September – March 2022 - Completed
		95%	April 2022 – November 2022 - Completed
		100%	November 2022 – February 2023
Stage 3	Tender		Spring 2023
Stage 4	Construction		Fall 2023

PANEL Q & A

Stay in Touch!

[Twitter.com/GOExpansion](https://twitter.com/GOExpansion)

[Metrolinx.com/Subscribe](https://metrolinx.com/Subscribe)

[Metrolinx.com/Davenport](https://metrolinx.com/Davenport)

TorontoWest@Metrolinx.com

416-202-6911

