

# Finch West LRT Project Construction Liaison Committee (CLC)

January 2023



# AGENDA

- **Welcome and Introductions**
- **Safety Moment**
- **Land Acknowledgement**
- **Previous Minutes and Action Items**
- **Important Milestones**
- **Work Update**
  - Finch West Station
  - Keele Street to Jane Street
  - Jane Street to York Gate Boulevard
  - Maintenance and Storage Facility
  - York Gate Boulevard to Weston Road
  - Weston Road to Highway 27
  - Humber College Station
  - Light Rail Vehicle Testing
- **Communications and Community Engagement**





**Safety Moment**

# **Land Acknowledgement**



# METROLINX LAND ACKNOWLEDGEMENT

Let us take a moment to acknowledge we are on lands that have been, and continue to be, home to many Indigenous Peoples including the Anishnabeg, the Haudenosaunee and the Huron-Wendat peoples.

We are all Treaty people. Many of us have come here as settlers, as immigrants or involuntarily as part of the trans-Atlantic slave trade, in this generation, or generations past.

We acknowledge the historic and continued impacts of colonization and the need to work towards meaningful reconciliation with the original caretakers of this land.

We acknowledge that Metrolinx operates on territories and lands covered by many treaties that affirm and value the rights of Indigenous communities, Nations and Peoples.

We understand the importance of working towards reconciliation with the original caretakers of this land. At Metrolinx, we will conduct business in a manner that is built on a foundation of trust, respect and collaboration.

# **Review of Previous December 6, 2022 CLC Minutes and Action Items**



## SUMMARY OF PREVIOUS CLC MEETING ACTION ITEMS

- No action item

# **Important Milestones**



# IMPORTANT MILESTONES

- Norfinch reopened, more north and south lanes to be opened
- Signet will have all Northbound and Southbound lanes open by end of third week of January
- Paving and line marking on Highway 400 ramps
- Canopy delivery and glazing installation on Driftwood, Tobermory, and Jane stops
- Delivery and assembly of all escalators in Finch West Station
- Delivery of elevators in Finch West Station and Humber College Station started



*Photo: Humber College Station Portal Track slab . 2022.12.14*

# **Finch West Station Update**



## FINCH WEST STATION

### Keele Street and Finch Avenue West

- Structural and masonry works of all stairs are completed
- Emergency exit building completed
- Main Entrance Building steel structure Completed
- Pedestrian Tunnel backfilling is complete
- All escalators are delivered, and located in place
- Elevators delivery and assemble have been started
- Track slab and rail installation completed in the portal area and will continue in station's public platform
- Masonry, Mechanical, Electrical and Plumbing, and Architectural works continue
- Systems panels/racks installation continue



Photo: Internal view of Finch West Station, Architectural finishes. 2022.12.14

**Keele Street to Jane Street**

# KEELE STREET TO JANE STREET

## Keele Intersection

- Shown traffic staging at Keele intersection has been implemented
- This staging will last for three month
- To facilitate Finch West Station operations and roadworks west of the intersection
- Same movements, traffic divided east of Keele

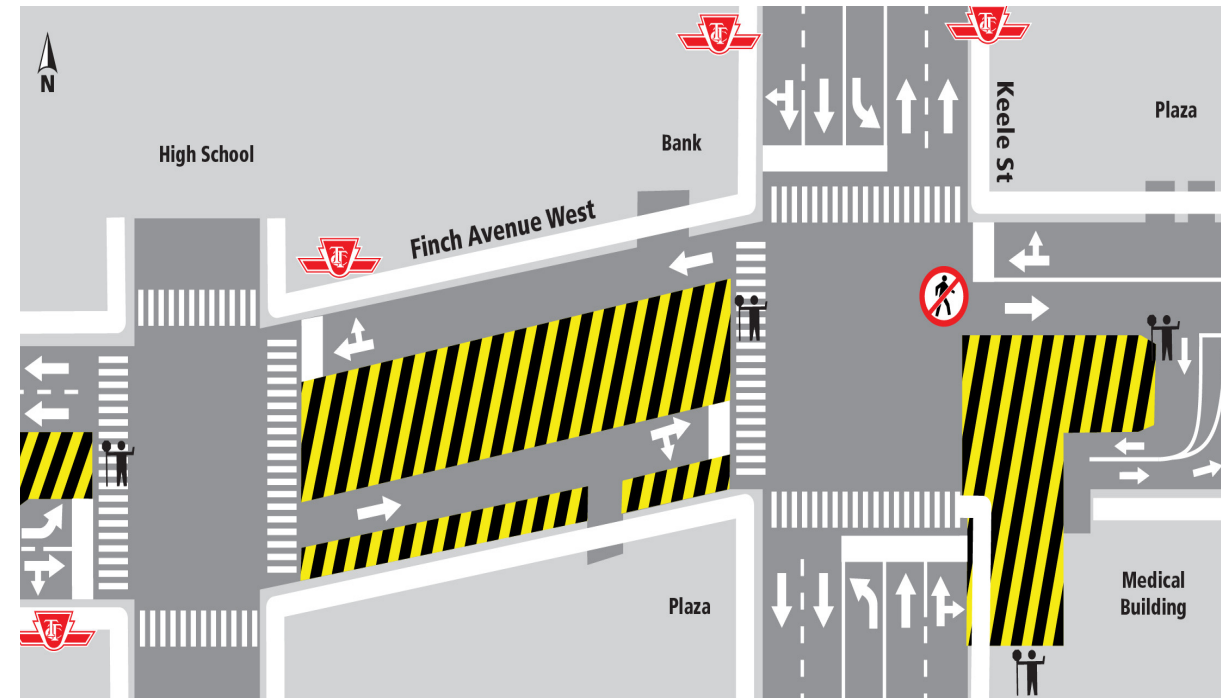

*Drawing: Traffic staging plan at Keele Street and Finch Avenue West and surrounding area*



# KEELE STREET TO JANE STREET

## Keel Street To Jane Street

- Almost all curbs, sidewalks, bike lanes, and road works completed, with two lanes in each direction, final paving and landscaping to follow based on weather
- All stops' platform have been poured, canopies are installed in Tobermory, Driftwood, Jane and Sentinel east bound stops
- Guideway and OCS Poles are complete between Jane Street and Romfield Lane
- Minor field modifications including bus stops relocation, periodic sidewalk and crosswalk closures may occur to complete work safely and minimize impact on the public
- Paid Duty Officer, flaggers, and detour signs will be used to direct traffic, as needed
- Community members will be notified of any significant construction related impacts, separately



Photo: Aerial view of Finch West Avenue and Tobermory Drive, looking east. 2022.12.22

**Jane Street to York Gate Boulevard**



# JANE STREET TO YORK GATE BOULEVARD

- Guideway construction works completed
- Two lanes in each direction is stages while south side curbs, sidewalks, bike lane completed
- North widening has been done for North boulevard works such as curbs, sidewalks, bike lane
- Minor field modifications including bus stops relocation, periodic sidewalk and crosswalk closures may occur to complete work safely and minimize impact on the public
- Paid Duty Officer, flaggers, and detour signs will be used to direct traffic, as needed
- Community members will be notified of any significant construction related impacts, separately



Photo: Aerial view of Finch West Avenue and Jane Street, looking west. 2022.12.22

# **Maintenance and Storage Facility**



# MAINTENANCE AND STORAGE FACILITY

- Interior and exterior building envelope completed
- Systems testing is ongoing
- Nine trains are delivered to the facility to date
- Nine more trains to be delivered in coming months
- LRV train testing is ongoing inside and, on the guideway



*Photo: Aerial view of Maintenance and Storage Facility, looking southeast. 2022.12.22*

**York Gate Boulevard to Weston Road**



# YORK GATE BOULEVARD TO WESTON ROAD

## Norfinch and Signet Drive Intersections

- Guideway works completed at Norfinch & Signet intersections
- Guideway works between Pelican and Norfinch and east of Signet is ongoing and planned to be completed by early February 2023
- Norfinch platform concrete pour is completed for the westbound stop and eastbound stop is planned to be completed by late January
- Signet platforms concrete pour is ongoing, westbound platform stop is planned to be completed by late February/early March while eastbound stop is planned to be completed by late January
- Road widening and boulevard works, including curb, sidewalk, landscaping will continue



Photo: Aerial view of Norfinch Drive and Finch Avenue West, looking west. 2022.12.22



# YORK GATE BOULEVARD TO WESTON ROAD

## Highway 400 and Finch Avenue West

- Road and guideway work is almost completed
- Multi-Use Pathway tunnel installation is completed
- Wet and dry utilities relocation is ongoing
- Minor field modifications including bus stops relocation, periodic sidewalk and crosswalk closures may occur to complete work safely and minimize impact on the public
- Paid Duty Officer, flaggers, and detour signs will be used to direct traffic, as needed
- Community members will be notified of any significant construction related impacts, separately
- Periodic ramp closures are probable
- Occasional night work occurs from **6 pm - 7 am**. Additional notices will be provided as needed



Photo: Highway 400 and Finch Avenue West, looking northeast. 2022.12.22

**Weston Road to Highway 27**



# WESTON ROAD TO HIGHWAY 27

## Weston Road to Jayzel Drive

- The intersection traffic staging was improved with more lanes during New year's holiday
- Utility crossing will be continued at the intersection
- Road widening and boulevard works has started
- Wet and dry utilities relocation continues at multiple locations
- Overhead and underground electrical continues
- Guideway work is scheduled to start in mid April 2023



Photo: Aerial view of Weston Road and Finch Avenue West, looking west. 2022.12.22



# WESTON ROAD TO HIGHWAY 27

## Jayzel Drive to Islington Avenue

- North and south widening completed, Curbs and sidewalk works continue
- Wet and dry utilities relocation continue in multiple areas
- Overhead and underground electrical continues
- Guideway works has started and will continue in Winter
- Milvan Drive is scheduled to be reopened in late winter 2023, approximately
- Duncanwoods Drive is scheduled to be reopened in late winter 2023, approximately
- Three U-Turns are in place at west of Milvan, Finchdale plaza, and Milady
- TPSS 4, Milady and Pearldale retaining walls, are almost completed
- Rolling traffic plans in place in this area



Photo: Aerial view of Finch Avenue West and Milvan Drive, looking west. 2022.12.22



# WESTON ROAD TO HIGHWAY 27

## Islington Avenue Intersection

- Bridge rehabilitation is completed
- Duct banks designed to be installed below the deck
- Guideway works completed on the both side of the bridge
- The bridge will be reponed in coming days
- Rail installation is the next operation on the bridge
- Islington westbound stop platform is completed, eastbound to follow



Photo: Aerial view of Finch Avenue West and Islington Avenue, looking east. 2022.12.22



# WESTON ROAD TO HIGHWAY 27

## Islington Avenue to Kipling Avenue

- North widening, sidewalk and curbs are almost completed
- Guideway works including excavation, duct bank, track slab, OCS bases and poles continue and completed in many areas up to Farr Avenue bridge
- Rail installation is ongoing
- South sidewalk and curbs to follow north side



*Photo: Finch Avenue West, between Islington and Kipling Avenues, looking west. 2022.12.22*



# WESTON ROAD TO HIGHWAY 27

## Kipling Avenue to Martin Grove Road

- Kipling intersection track slab works has started from east side and will continue by early spring 2023
- Guideway installation at Albion intersection has started on the west side and will be completed late winter 2023
- Roadworks, and guideway installation is ongoing between Kipling Avenue and Martin Grove Road
- Overhead and underground electrical continues
- OCS poles installation is ongoing
- Curbs and sidewalks are ongoing



Photo: Aerial view of Finch Avenue West and Albion Road, looking southeast. 2022.12.22



# WESTON ROAD TO HIGHWAY 27

## Martin Grove Road to Highway 27

- Guideway works for all intersections except east half of Martin Grove is completed
- Guideway works is also completed west of Silverstone Drive up to Highway 27 and road works is ongoing
- Curbs, Sidewalks, and bike lane placement is ongoing
- Overhead and underground electrical work continues
- Westmore platforms concrete pour completed for the eastbound stop and is ongoing for the westbound stop
- Minor field modifications including bus stops relocation, periodic sidewalk and crosswalk closures may occur to complete work safely and minimize impact on the public
- Paid Duty Officer, flaggers, and detour signs will be used to direct traffic, as needed
- Community members will be notified of any significant construction related impacts, separately



Photo: Aerial view of Finch Avenue West and Westmore Drive, looking east. 2022.12.22

# Humber College Station



# HUMBER COLLEGE STATION

## Highway 27 to Humber College Boulevard

- Access road to Humber College is completed and covered walkway will be started in January 2023
- Elevators delivery and assembly have been started
- Utility relocations, excavation, structural steel and concrete works are completed
- Track slab and rail work is completed in Finch West Avenue portal and continue in Highway 27 portal
- Road works, Mechanical, Electrical, Plumbing and Masonry, and Architectural work continue
- Minor field modifications including bus stops relocation, periodic sidewalk and crosswalk closures may occur to complete work safely and minimize impact on the public
- Paid Duty Officer, flaggers, and detour signs will be used to direct traffic, as needed
- Community members will be notified of any significant construction related impacts, separately



Photo: Aerial view of Humber College station, looking northeast. 2022.12.22

# Light Rail Vehicle Testing



# LIGHT RAIL VEHICLE TESTING

- Nine vehicles have been received, nine more expected
- Seven Light Rail Vehicles (LRVs) have completed high speed testing (around 60 km/hr)
- Two vehicles are being prepared for testing
- Signs are installed to keep residents informed about the closure
- Paid Duty Officer, flaggers, and detour signs will be used as needed
- Notices will be shared, and Community members will be notified of related impacts



*Photo: Light Rail Vehicle testing on the guideway. 2022.09.21*

# **Communications and Community Engagement**

# COMMUNICATION AND COMMUNITY ENGAGEMENT

## Updates

- Structure fly-through video and story for Finch West Station
- Year In Review story for the project
- Mosaic team food drive to support local community food banks
- Participated in the TCBN Quarterly General Meeting
- Shop Local Holiday Newspaper Ads



Photos: Mosaic Team collects food for local food bank donation December 2022.



Photos: Downsview Advocate and North York Mirror Holiday Ads to support community shopping.



# COMMUNICATION AND COMMUNITY ENGAGEMENT

## Upcoming Events

- Structure fly-through video and story for Humber College Station progress
- Metrolinx Q1 2023 Newsletter
- Green in Construction Symposium event
- Humber College Site Tour
- Humber College Open House
- TCBN Site Tour
- Webinar Series: Community Benefits Round Table
- Guideway construction and Safety local newspaper ads

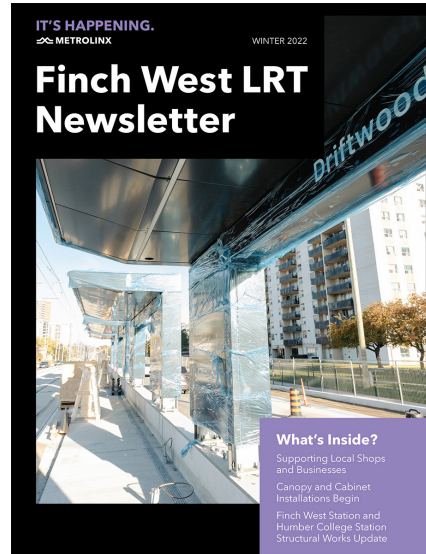

Photo: Project Newsletter.



Photo: Newspaper ads.



Photo: Apprentice Tour 2022.



Photo: Humber College North building structural steel completed.

# KEEPING YOU INFORMED

## Communication Methods

- Construction Liaison Committee (CLC)
- Emails to Mailing List, Weekly E-Newsletter, Project Website Updates
- Construction Notices
- Frequently Asked Questions (FAQ)
- Metrolinx News Blog
- Social media - Geo-targeting
- Community Project Updates through brochure , Quarterly Newsletters and postcards
- Wayfinding and Signage
- Billboards

## Engagement Tools

- Virtual Open House via Metrolinx Engage
- Working or Advisory Group Meetings
- Business Liaison
- Public Meetings



**Stay Informed:** [metrolinx.com/finchwestlrt](https://metrolinx.com/finchwestlrt) and sign up to our Toronto West e-newsletter

**Questions or comments:** [TorontoWest@metrolinx.com](mailto:TorontoWest@metrolinx.com), @FinchWestLRT, 416-202-6500



# NEXT CLC MEETING

Next meeting will be on Tuesday, February 7, 2023, via Microsoft Teams.



**Thank you and Stay Safe**



