

# Leaside-Laird CLC

Eglinton Crosstown LRT

July 10, 2023

# LAND ACKNOWLEDGEMENT

Let us take a moment to acknowledge we are on lands that have been, and continue to be, home to many Indigenous Peoples including the Anishnabeg, the Haudenosaunee and the Huron-Wendat peoples.

We are all Treaty people. Many of us have come here as settlers, as immigrants or involuntarily as part of the trans-Atlantic slave trade, in this generation, or generations past.

We acknowledge the historic and continued impacts of colonization and the need to work towards meaningful reconciliation with the original caretakers of this land.

We acknowledge that Metrolinx operates on territories and lands covered by many treaties that affirm and value the rights of Indigenous communities, Nations and Peoples.

We understand the importance of working towards reconciliation with the original caretakers of this land. At Metrolinx, we will conduct business in a manner that is built on a foundation of trust, respect and collaboration.

# Leaside Station

# LEASIDE STATION UPDATE

Activity	Location	Approx. Date & Duration
<b>Station Box Construction</b> Architectural, mechanical, and electrical finishes, and testing and commissioning	Underneath Eglinton Avenue within the Station Box	Underway through Summer 2023
<b>Main Entrance Construction</b> Architectural, mechanical, and electrical finishes, concrete works and landscaping	Southeast corner of Bayview Ave and Eglinton Ave	Underway through Summer 2023
<b>Secondary Entrance Construction</b> Architectural, mechanical, and electrical finishes, concrete works and landscaping	Northwest corner of Bayview Ave and Eglinton Ave	Underway through Summer 2023

# CURRENT TRAFFIC CONFIGURATION

Expected through 2023

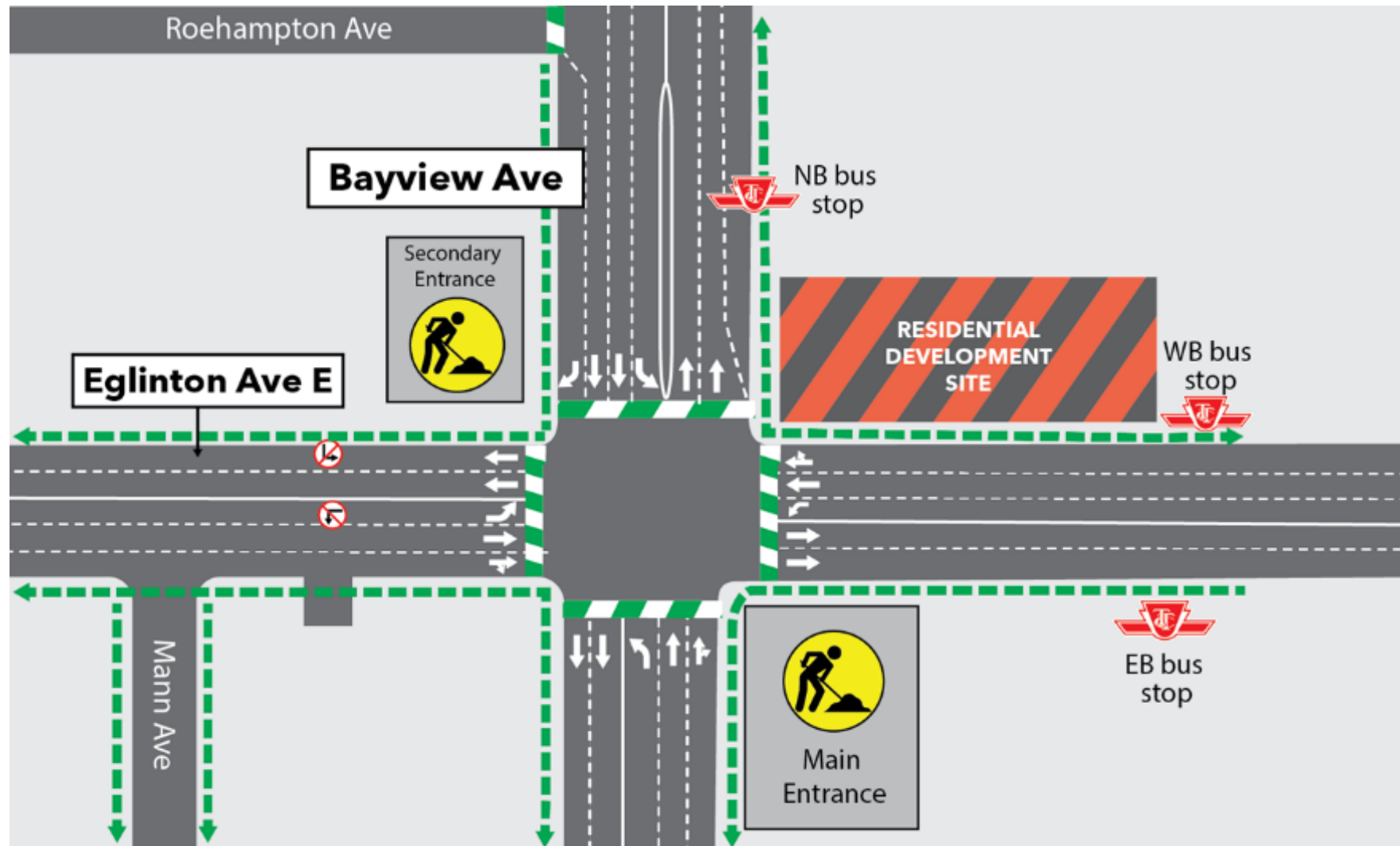

Periodic short-term lane closures may be required to facilitate certain activities

# PERMANENT LOCATION OF TTC BUS STOPS

Note: timeline for reinstatement at these locations is not confirmed

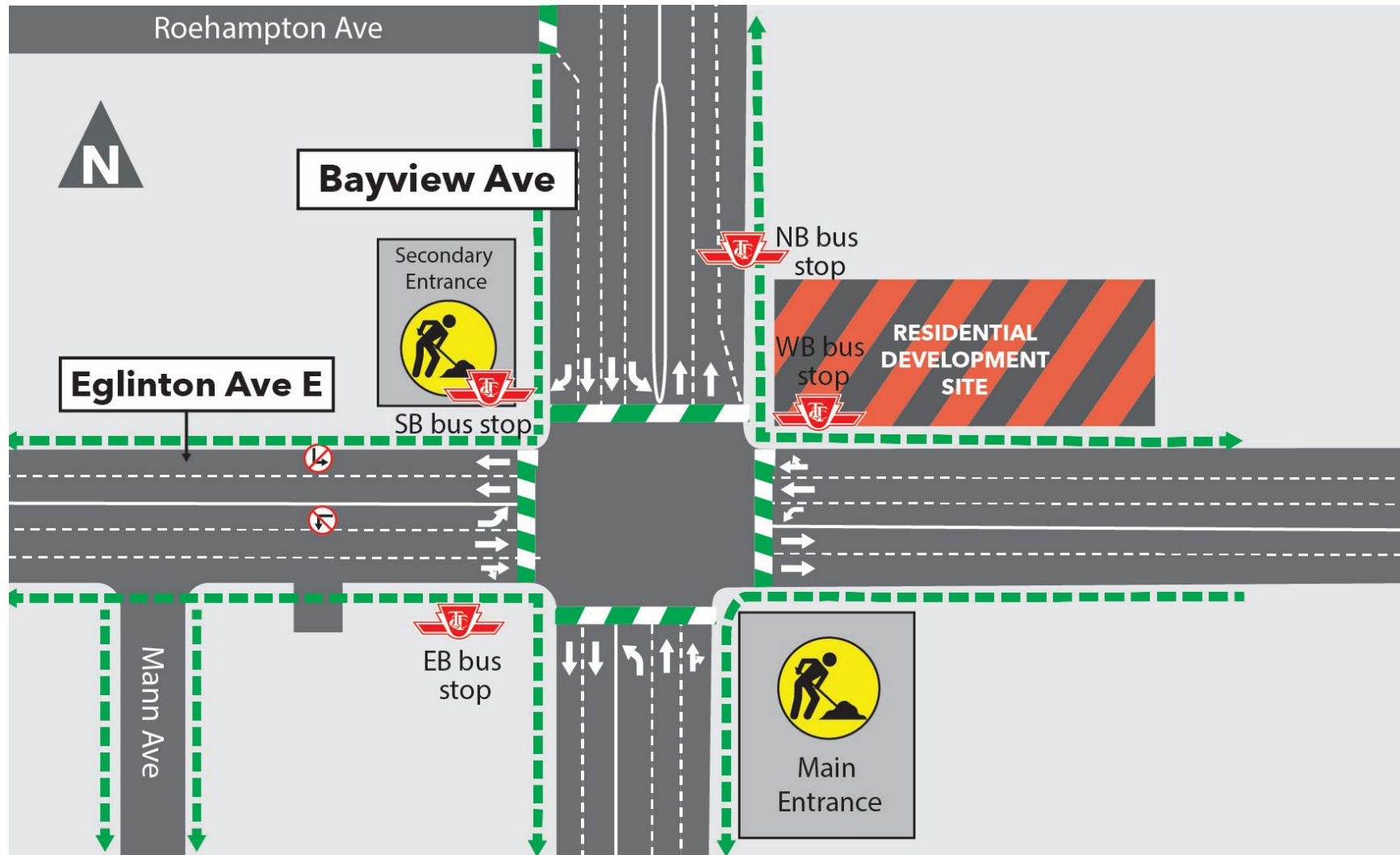

# CONSTRUCTION PROGRESS PHOTOS



PLATFORM LEVEL



MAIN ENTRANCE

# Laird Station



# LAIRD STATION UPDATE

Activity	Location	Approx. Date & Duration
<b>Station Entrances</b> Electrical, mechanical, and architectural finishes. Sidewalk pours and station cleaning.	South-west corner of Laird Drive and Eglinton Avenue East	Underway through Summer 2023
<b>Station Box Construction</b> Electrical, mechanical, and architectural finishes. Station and systems testing and inspections, and station cleaning.	Beneath Eglinton Avenue East	Underway through Summer 2023
<b>Periodic Lane Reductions</b> Trenching, asphalt restoration, and line painting works	Eglinton Avenue East at Laird Drive	Ongoing until approx. late-July 2023

# PERIODIC LANE REDUCTIONS FOR ASPHALT PAVING WORKS

Ongoing until approximately late-July 2023

- Rolling lane closures are required on Eglinton Avenue East at Laird Drive to complete this work.
- Periodically, Eglinton Ave East and Laird Dr will be reduced to one lane in each direction, while this work takes place.
- Noise from construction activities can be expected.
- Affected properties have been notified directly.
- Work is expected to take place between 7:00 a.m. and 6:00 p.m.

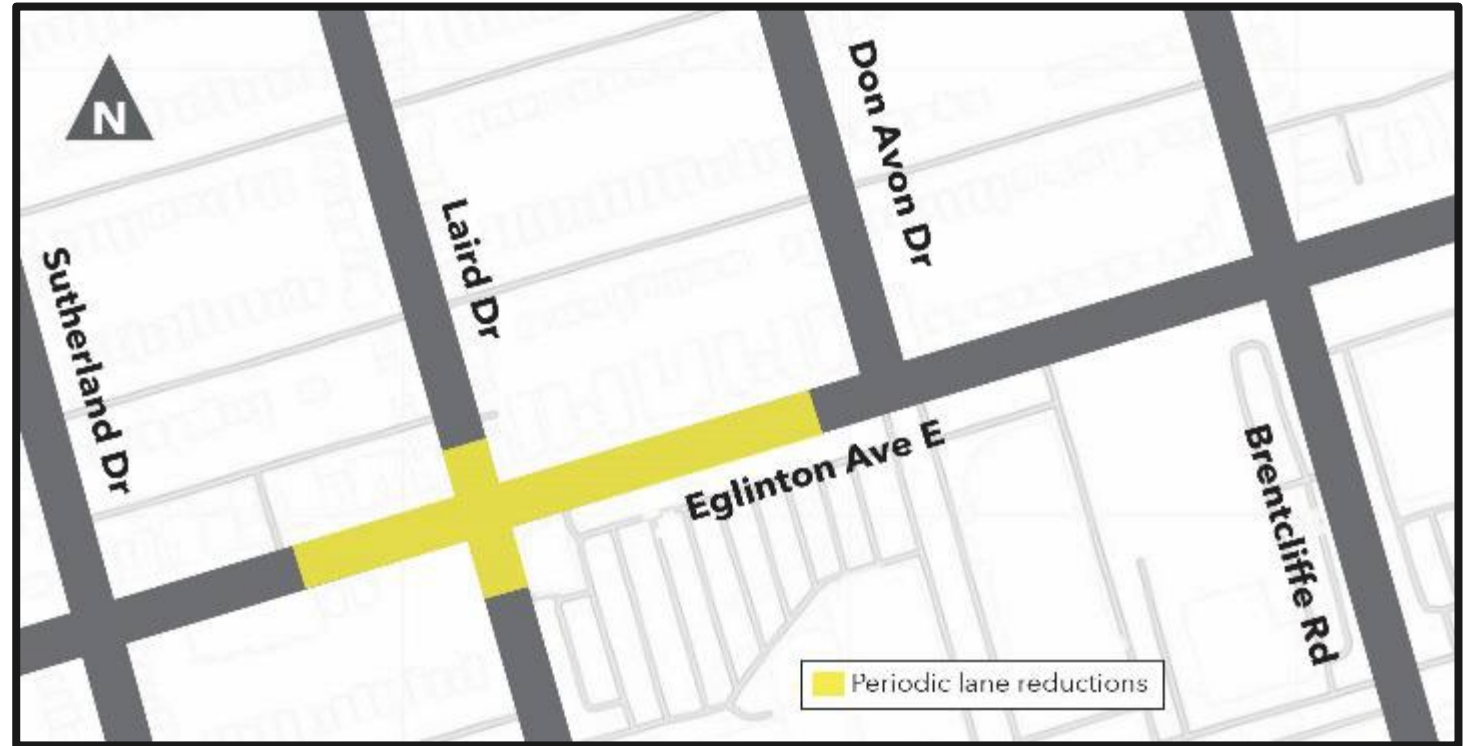

# TRAFFIC CONFIGURATION AT LAIRD STATION

Expected through 2023



- Periodic short-term lane closures will be required during this traffic stage to facilitate specific activities
- Fencing will remain in place around the Station Entrances for security purposes

# CONSTRUCTION PROGRESS PHOTOS



SECONDARY ENTRANCE

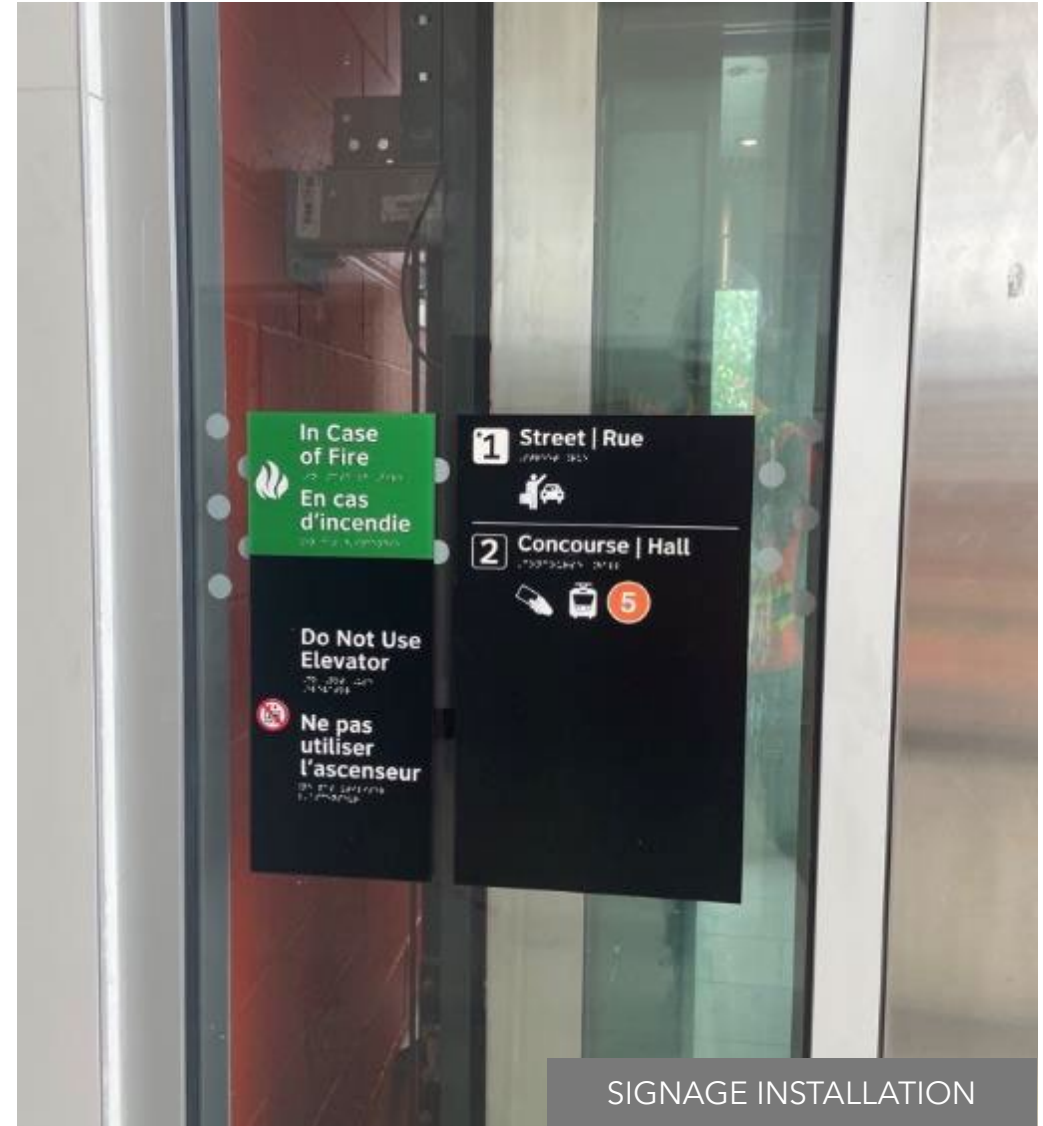

SIGNAGE INSTALLATION



## EAST OF LAIRD ONGOING WORKS

- Vehicle and systems testing
- Landscaping between Brentcliffe Road and Kennedy Road - Ongoing through Summer 2023
- Multi-use path construction and landscaping restoration works - Ongoing through Summer 2023
- Noise barrier wall removal - Completed May 2023; Soil nail wall removal - Resuming Summer 2023
- Sidewalk Segment Restoration Works - Numerous locations along Eglinton Avenue East - Ongoing through Summer 2023
- Architectural and electrical finished - Numerous At-Grade Stops - Ongoing through Summer 2023



HIGHWAY GUIDE SIGNAGE  
INSTALLATION (COMPLETE)



INSTALLATION OF GREEN SURFACE  
FOR THE BIKE LANES (ONGOING)

# RETAINING WALL LOCATIONS

