

Update: utility relocation and construction work at Queen Street East bridge

Starting Monday, July 31, 2023 for approximately two (2) months

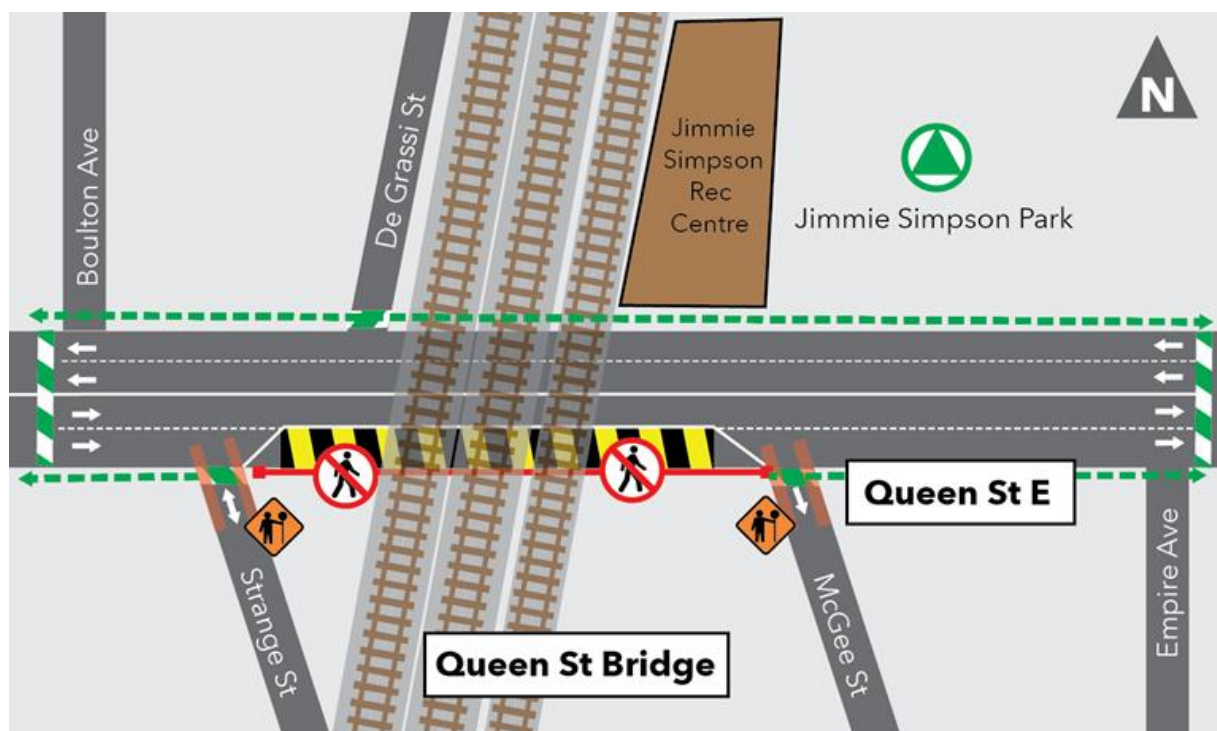

What is happening?

- *Please note this is an update to the previous notice issued on June 1, 2023.
- As early as Monday, July 31, 2023, utility relocation and bridge reinforcement work will continue at Queen Street East between Strange Street and McGee Street.
- Utility relocation activities will include excavation, saw cutting, concrete breaking, shoring, concrete pours, and cable pulling.
- Bridge reinforcement activities will include installation of bearings and concrete blocks.
- This work is expected to take place Monday - Friday between 7:00 a.m. - 7:00 p.m. for approximately two (2) months.
- **Crews may be required to work overnight within the rail corridor at and around the Queen Street East bridge between Monday July 31 to Friday August 11, 2023, to complete bridge reinforcement work.**
- **To keep workers safe, work will need to take place overnight (11:00 p.m. - 6:00 a.m.) when trains are not running in the rail corridor.**
- **Overnight activities will include drilling and placing concrete blocks; minimal noise is expected.**

Traffic and Pedestrian Details

Information as of July 27, 2023

- Eastbound traffic on Queen Street East will be reduced to one lane between Strange Street and McGee Street.
- As early as Monday, August 8, 2023, traffic on McGee Street will be reduced to one lane at Queen Street East for approximately two (2) weeks.
- As early as Monday, August 21, 2023, traffic on Strange Street will be reduced to one lane at Queen Street East, with traffic alternating in each direction, for approximately two (2) weeks.
- Traffic control personnel will be present to maintain road access and assist vehicles and pedestrians navigating the area.
- Access to private property will be maintained.
- The sidewalk on the south side of Queen Street East will be closed between Strange Street and McGee Street.
- The sidewalk on the north side of Queen Street East will remain open during this work. Pedestrians will be directed to use the existing pedestrian crossings at Empire and Boulton Avenues.

What to Expect

- Daytime noise from construction equipment including excavators, jackhammers, concrete trucks, loaders, and a hydro-vacuum truck can be expected.
- Excavators, lifts, drills, and other hand tools may be used overnight; minimal noise is expected.
- To protect and safely verify locations of buried utilities, crews are required to use non-mechanical excavation methods (hydro-vacuuming) when working within 2 metres of any utility.
- Site lighting will be positioned downward and away from residential properties.
- Traffic control personnel and/or a Paid Duty Officer will be present while this work takes place.
- Advance signage will be in place to direct drivers and pedestrians navigating the area.
- Traffic barrels, fencing and barricades will be in place to prevent drivers, cyclists, and pedestrians from entering work areas.
- Construction equipment and materials will be properly secured within the work zones.
- Traffic lanes and sidewalks will reopen upon completion of the works.
- Work may be delayed due to weather conditions or unforeseen circumstances.

About the Ontario Line

- 15.6-kilometre subway line that will make it faster and easier to travel within Toronto and beyond.
- 15 stops and more than 40 connections to other transit, including GO train, subway, LRT, streetcar and bus lines.
- Less than 30 minutes from one end of the line to the other.
- 28,000 fewer car trips each day.

Contact us:

Call us 24/7 at: [416-202-5100](tel:416-202-5100)

Write to us at: ontarioline@metrolinx.com

Find us on Twitter, Facebook, and Instagram: [@ontarioline](https://www.instagram.com/ontarioline)

Visit the website: www.metrolinx.com/ontarioline

Visit our community office:

770 Queen Street East (near Queen & Broadview)

General hours:

Mondays, Tuesdays, and Fridays: 9:00 a.m. to 5:00 p.m.

Wednesdays and Thursdays: 10:00 a.m. to 6:00 p.m.