

Extended: Road Restoration Works on the South Side of Eglinton Avenue between Avenue Road and Oriole Parkway

As early as Friday, August 18, 2023

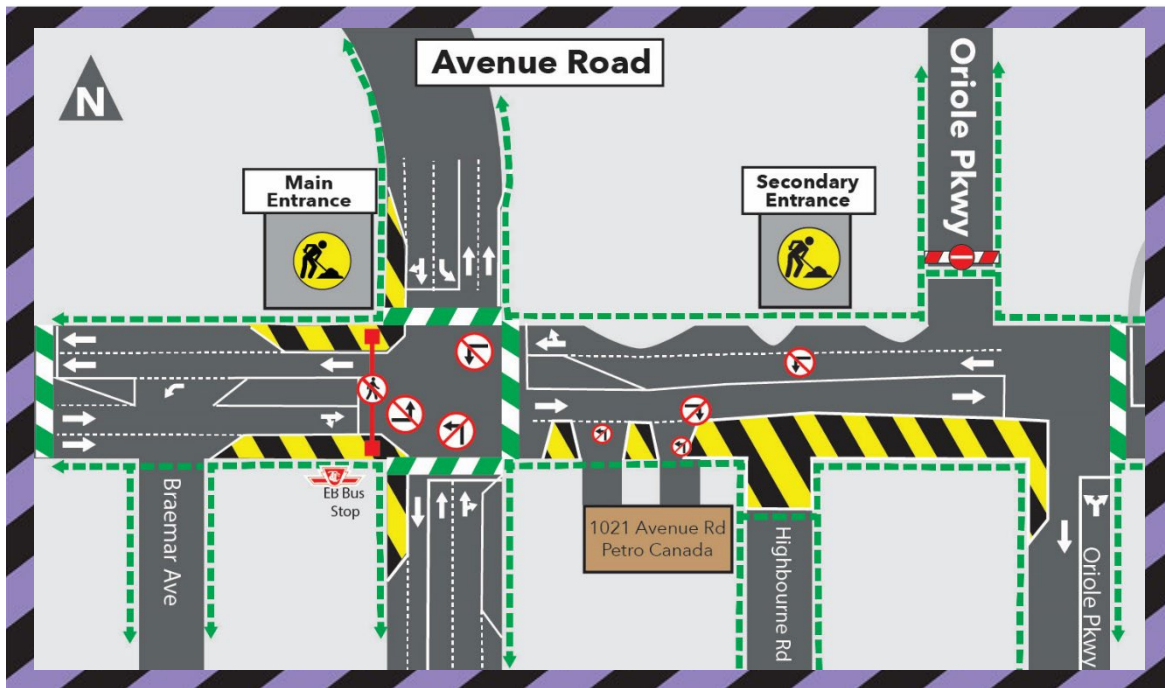

What Work is Taking Place?

As early as Friday, August 18, 2023, crews at Avenue Station will be continuing road restoration works on the south side of Eglinton Avenue between Avenue Road and Oriole Parkway. Traffic on Eglinton Avenue will remain on the north side of the road between Avenue Road and Oriole Parkway, and construction will remain to the south side. Access to Highbourne Road will remain restricted for the duration of work. One lane of traffic in each direction will be maintained at all times on Eglinton Avenue. All other traffic staging, turn restrictions, crosswalk closures and pedestrian rerouting will remain in place. **Businesses on the south side of Eglinton Avenue between Avenue Road and Oriole Parkway and on Highbourne Road will remain opened while work takes place.** Work is expected to take place on Monday - Friday between 7:00 a.m. and 7:00 p.m. until approximately Friday, September 1, 2023. Occasional overnight work may be required

for special activities. Upon completion of this work, short term lane reductions may be required to facilitate special activities. Please review the complete notice or visit www.metrolinx.com/eglintoncrosstownlrt for more information.

What to Expect

Noise from construction activities including asphalt removals (milling) and asphalt paving can be expected. Concrete barriers, fencing, and signage will be in place to delineate the work zones. One lane of traffic in each direction will be maintained at all times on Eglinton Avenue. Occasional overnight work may be required for special activities. Affected properties have been notified directly. Expect delays while traveling through the area.

HOURS OF WORK

- As early as Friday, August 18, 2023, until approximately Friday, September 1, 2023.
- Work is expected to take place on Monday – Friday between 7:00 a.m. and 7:00 p.m.
- Occasional overnight work may be required for special activities.
- Work may be rescheduled due to inclement weather or unforeseen circumstances.
- Work may be longer or shorter than expected.

TRAFFIC DETAILS

- Traffic on Eglinton Avenue will remain on the north side of the road between Avenue Road and Oriole Parkway, and construction will remain to the south side.
- Access to Highbourne Road will remain restricted for the duration of work.
- One lane of traffic in each direction will be maintained at all times on Eglinton Avenue.
- All other traffic staging, turn restrictions, crosswalk closures and pedestrian rerouting will remain in place.

PEDESTRIAN DETAILS

- No changes to the current pedestrian routes are expected as a result of this work.

TRANSIT INFORMATION

- Access to TTC will be maintained at all times.
- Please visit www.ttc.ca for more information.

East Community Office:
Hours of Operation: Monday to Friday, 9:00 a.m. to 5:00 p.m.
Tel: 416-482-7411

West Community Office:
Hours of Operation: Monday to Friday, 9:00 a.m. to 5:00 p.m.
Tel: 416-782-8118

Contact Us:

Write to us at: crosstown@metrolinx.com
Find us on Twitter @CrosstownTO
Visit the website: www.metrolinx.com/eglintoncrosstownlrt

Disponible en français.