

# Long-term lane closures at Queen St W and Spadina Ave.

**Expected Installation Date:** As early as, August 30, 2023

**Planned work hours:** one (1) night 9 p.m. to 5 a.m.

**Expected duration of lane closures:** six (6) months (north side), one (1) month (south side)

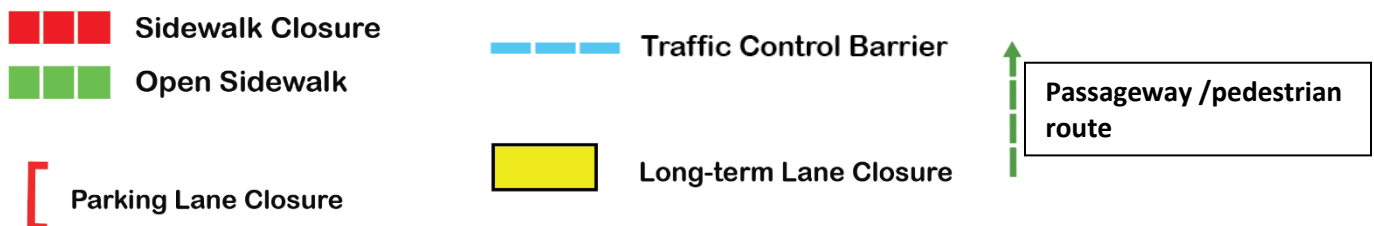
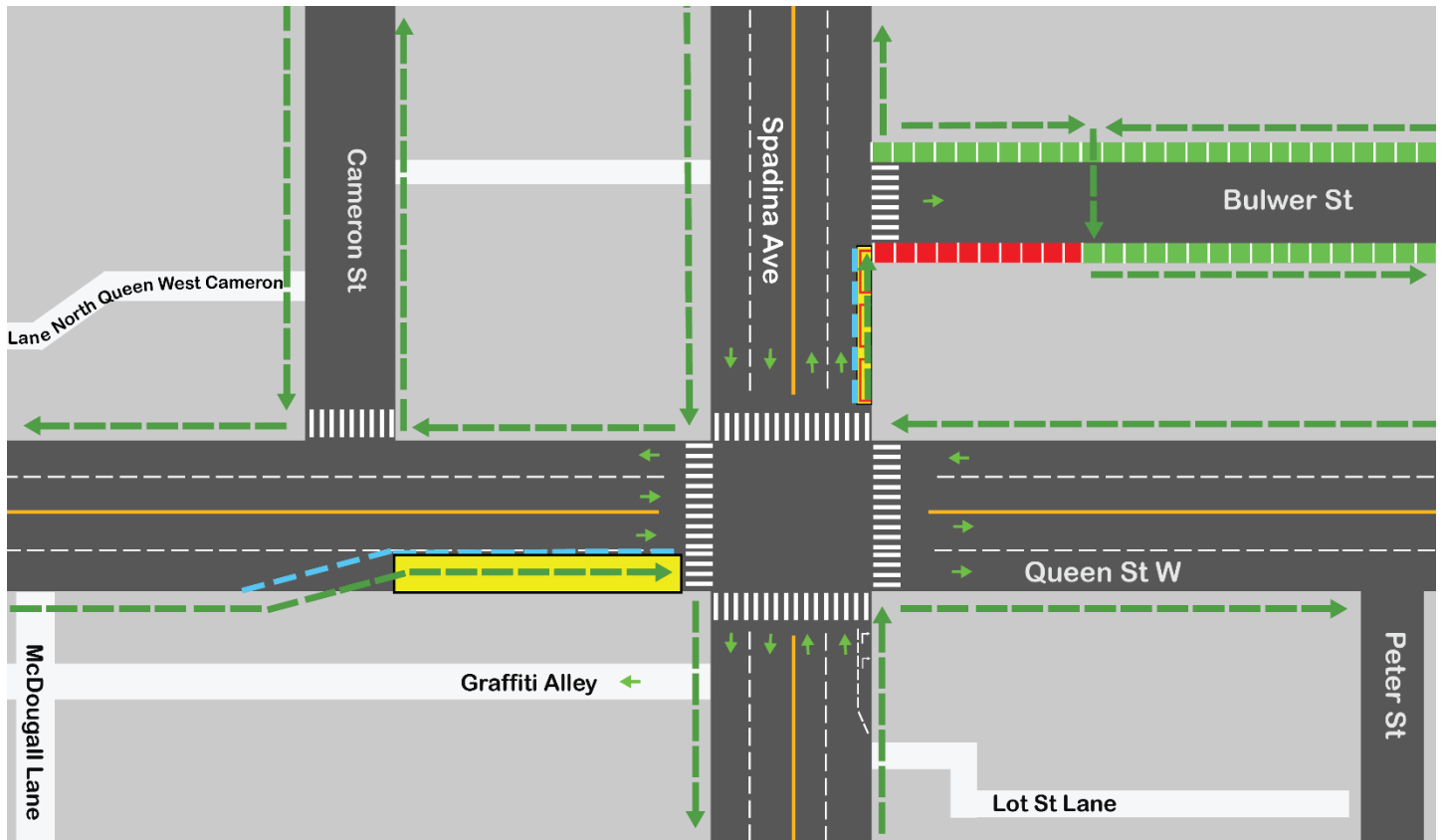

## What is happening:

Crews will install traffic control barriers and signage overnight to prepare for the next phase of work at the future Ontario Line Queen/Spadina station for the north and south entrances. The installation is expected to be completed in one (1) night to prepare for the long-term closures. The metal barriers will serve as the traffic and pedestrian control measures to allow the work to proceed safely.

## Queen St. and Spadina Ave. long term lane closures

### Queen Street

On the south side of Queen St. W., west of Spadina, the sidewalk will be detoured, and the eastbound curb lane will be closed to traffic for up to (1) one month. The curb lane will become a pedestrian passageway. Metal barriers will be in place for safe separation from traffic.

## Please read other side for more information

### Spadina Avenue

The sidewalk on the east side of Spadina north of Queen St. will be detoured and the northbound parking lane will be closed for six (6) months. The parking lane will become a passageway. Metal barriers will be in place for safe separation from traffic.

### Bulwer Street

Bulwer St. will be closed for one night while crews set up signage and barriers. The sidewalk on the south side of Bulwer St. will be detoured and closed for three (3) months. Access in all directions will be maintained, with various lane closures implemented overnight to install a barrier.

### What to expect

- Minimal noise from equipment needed to install the metal barriers.
- Temporary lane and sidewalk closures overnight to install barriers and signage.
- Lane closures on the eastbound curb lane on Queen St W and the parking lane on Spadina Ave, north of Queen St W.
- The lane closures are necessary to allow the safe demolition work taking place at the future Ontario Line subway station locations.
- Work may be delayed or rescheduled due to unforeseen circumstances.
- To read the previous notice about the upcoming land closures and building demolition work please click [here](#).
- For more information about upcoming station work please visit [metrolinx.com/ontarioline](http://metrolinx.com/ontarioline) or sign up for the [Ontario Line e-newsletter](#)

### About the Ontario Line

- 15.6-kilometre subway line that will make it faster and easier to travel within Toronto and beyond.
- 15 stops and more than 40 connections to other transit, including GO train, subway, LRT, streetcar and bus lines.
- Less than 30 minutes from one end of the line to the other.
- 28,000 fewer car trips each day.

#### Contact us:

Call us 24/7 at: 416-202-5100

Write to us at: [ontarioline@metrolinx.com](mailto:ontarioline@metrolinx.com)

Find us on Twitter, Facebook & Instagram: @ontarioline

Visit the website: [www.metrolinx.com/ontarioline](http://www.metrolinx.com/ontarioline)

#### Visit our community office:

770 Queen Street East (near Queen & Broadview)

General hours:

- Mondays, Tuesdays, and Fridays: 9 a.m. to 5 p.m.
- Wednesdays and Thursdays: 10 a.m. to 6 p.m.