

# Long-term lane closures at King St W and Bathurst St.

**Expected start date:** As early as, August 30, 2023

**Planned overnight work hours:** one (1) night, 9 p.m. to 5 a.m.

**Expected duration of lane closures:** six (6) months (north side), one (1) month (south side)

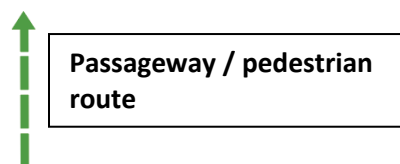
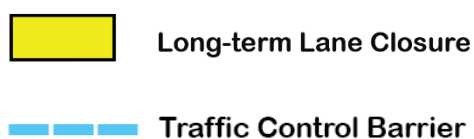
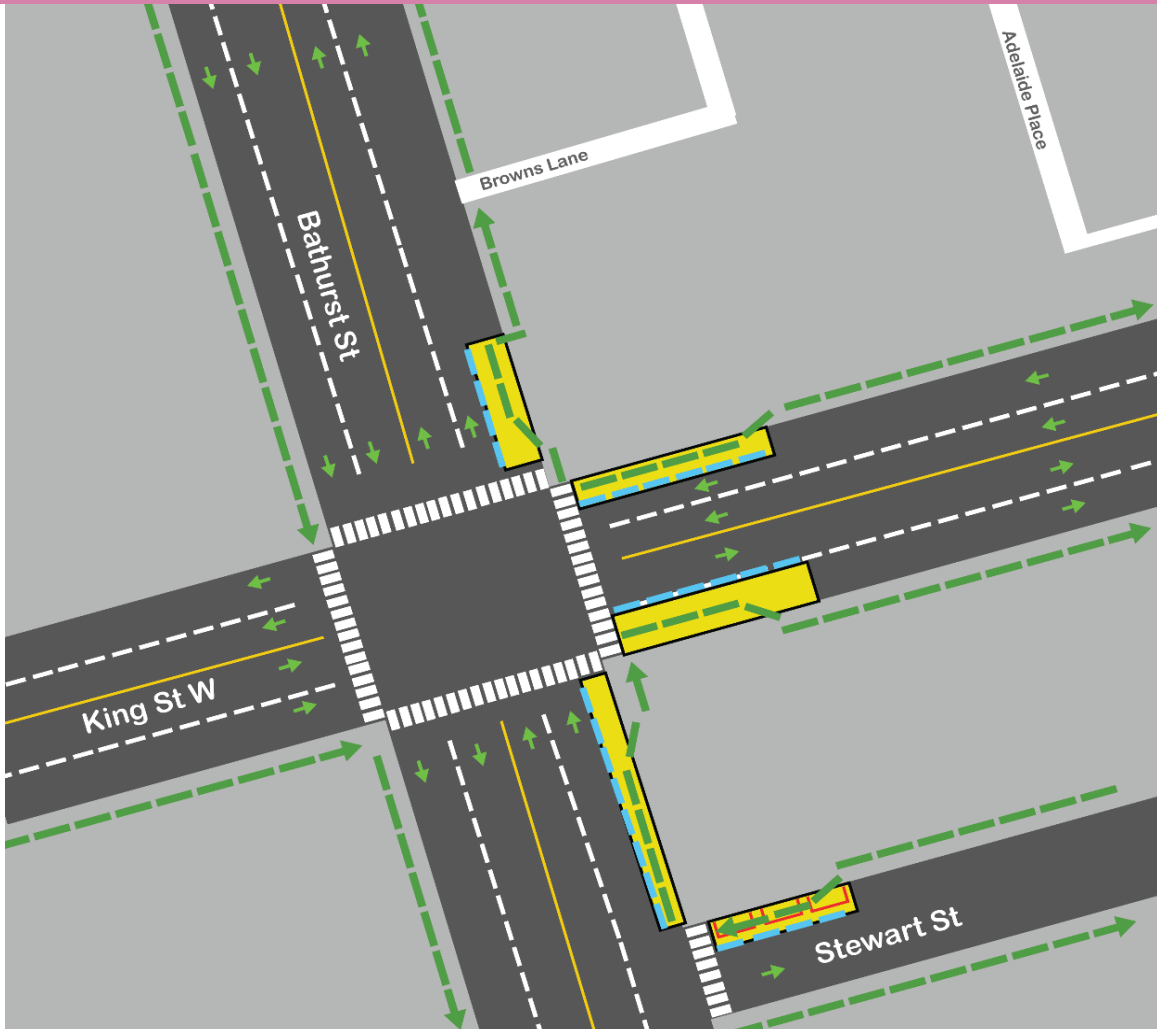

## What is happening:

Crews will be installing traffic barriers and signage to prepare the area for the next phase of work at the future Ontario Line King/Bathurst station. This work is expected to take one (1) night.

Curb lane traffic closures on the north side are expected to be in place for six (6) months. Traffic control measures on the south side of King St. are expected to change in October 2023.

Stewart St. parking lanes will be used as a safe passageway around the site. Metal barriers will be in place to separate traffic lanes from pedestrians.

**Please read other side for more information**

## King St. and Bathurst St. long term lane closures

### Bathurst Street

The northbound curb lane on Bathurst St. from Stewart St. to just north of King St., will be closed to traffic. A passageway will be installed within the curb lane, to allow safe movement around the construction area.

Metal barriers will be installed to keep people away from the traffic lanes on Bathurst St. The pedestrian detour along with traffic control measures are expected to be in place for the next six (6) months. Additional changes on Bathurst St. south of King St. are expected in October 2023.

### King Street - North side

A section of the westbound curb lane will be closed approaching Bathurst St. A passageway will be installed within the curb lane, to allow safe movement around the construction area.

Metal barriers will be installed for safe passage away from the traffic lanes on King St. This is expected to be in place for the next six (6) months.

The westbound TTC streetcar stop has been moved east to avoid the curb lane closure.

### King Street - South side

A section of the eastbound curb lane will be closed just east of Bathurst St. A safe passageway will be installed within the curb lane, to allow safe movement around the construction area.

Metal barriers will be installed to create safe passage away from the traffic lanes. The eastbound streetcar stop has been shifted east. The closure will remain in place until October 2023, when additional changes will be made.

Eastbound and westbound right turn lanes on King St W. will be maintained. Expect some lane closures overnight when the barriers are being installed.

### What to expect

- Noise from equipment needed to install the metal barriers.
- Temporary traffic lane and sidewalk closures overnight during the installation of the metal barriers and traffic control signs.
- The lane closures are necessary to allow the safe demolition work taking place at the future Ontario Line subway station locations.
- Work may be delayed or rescheduled due to unforeseen circumstances.
- To read the previous notice about the upcoming lane closures and building demolition work please click [here](#).
- For more information about upcoming construction work, please visit see [metrolinx.com/ontarioline](http://metrolinx.com/ontarioline) or sign up for the [Ontario Line e-newsletter](#).

### About the Ontario Line

- 15.6-kilometre subway line that will make it faster and easier to travel within Toronto and beyond.
- 15 stops and more than 40 connections to other transit, including GO train, subway, LRT, streetcar and bus lines.
- Less than 30 minutes from one end of the line to the other.
- 28,000 fewer car trips each day.

#### Contact us:

Call us 24/7 at: 416-202-5100

Write to us at: [ontarioline@metrolinx.com](mailto:ontarioline@metrolinx.com)

Find us on Twitter, Facebook & Instagram: @ontarioline

Visit the website: [www.metrolinx.com/ontarioline](http://www.metrolinx.com/ontarioline)

#### Visit our community office:

770 Queen Street East (near Queen & Broadview)

General hours:

- Mondays, Tuesdays, and Fridays: 9 a.m. to 5 p.m.
- Wednesdays and Thursdays: 10 a.m. to 6 p.m.