

# Leaside-Laird CLC

Eglinton Crosstown LRT

September 11, 2023

# LAND ACKNOWLEDGEMENT

Let us take a moment to acknowledge we are on lands that have been, and continue to be, home to many Indigenous Peoples including the Anishnabeg, the Haudenosaunee and the Huron-Wendat peoples.

We are all Treaty people. Many of us have come here as settlers, as immigrants or involuntarily as part of the trans-Atlantic slave trade, in this generation, or generations past.

We acknowledge the historic and continued impacts of colonization and the need to work towards meaningful reconciliation with the original caretakers of this land.

We acknowledge that Metrolinx operates on territories and lands covered by many treaties that affirm and value the rights of Indigenous communities, Nations and Peoples.

We understand the importance of working towards reconciliation with the original caretakers of this land. At Metrolinx, we will conduct business in a manner that is built on a foundation of trust, respect and collaboration.

# Leaside Station

# LEASIDE STATION UPDATE

Activity	Location	Approx. Date & Duration
Station Box, Main and Secondary Entrances Architectural, mechanical, and electrical finishes. Deficiency work and station cleaning.	Beneath Eglinton Avenue East, on the northwest and southeast corner of Bayview Ave and Eglinton Avenue East	Ongoing through Fall 2023
Station Testing and Inspections	Throughout the Station	Ongoing through 2023
Train Testing and Commissioning	Throughout the Station	Ongoing through 2023

# CURRENT TRAFFIC CONFIGURATION

Expected through 2023

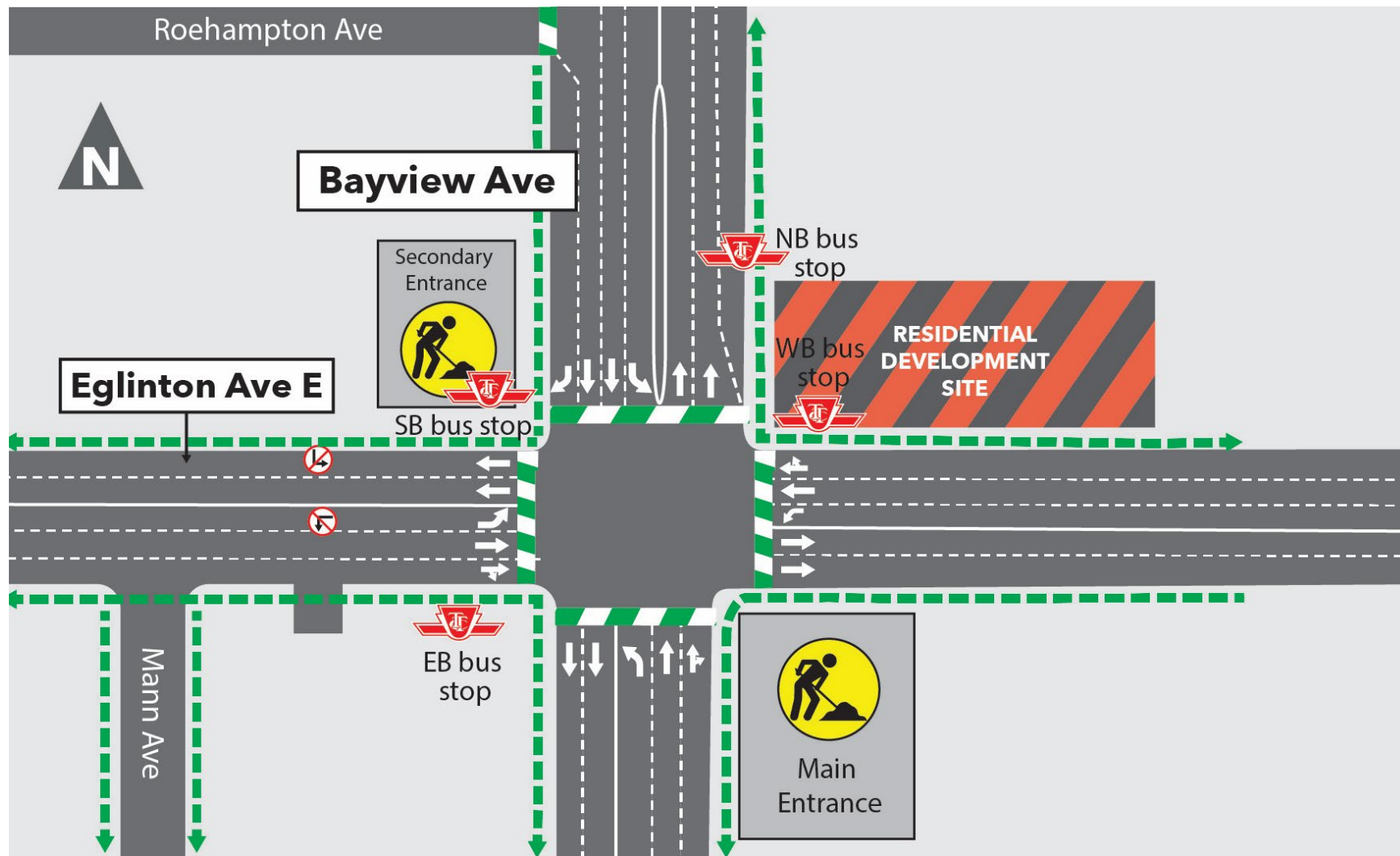

# CONSTRUCTION PROGRESS PHOTOS



CONCOURSE LEVEL



MAIN ENTRANCE

# Laird Station

# LAIRD STATION UPDATE

Activity	Location	Approx. Date & Duration
Station Box, Main and Secondary Entrances Deficiency work and station cleaning.	Beneath Eglinton Avenue East, and on the southwest and southeast corner of Laird Drive and Eglinton Avenue East	Ongoing through 2023
Station Testing and Inspections	Throughout the Station	Ongoing through 2023
Train Testing and Commissioning	Throughout the Station	Ongoing through 2023



# TRAFFIC CONFIGURATION AT LAIRD STATION

Expected through 2023



- Periodic short-term lane closures will be required during this traffic stage to facilitate specific activities
- Fencing will remain in place around the Station Entrances for security purposes

# CONSTRUCTION PROGRESS PHOTOS



MAIN ENTRANCE



PLATFORM LEVEL



## EAST OF LAIRD ONGOING WORKS

- Vehicle and systems testing - Ongoing through 2023
- Landscaping between Brentcliffe Road and Kennedy Road - Ongoing through October 2023
- Multi-use path construction and landscaping restoration works - Ongoing through October 2023
- Noise barrier wall removal - Completed May 2023; Soil nail wall removal - Resuming Fall 2023
- Sidewalk Segment Restoration Works - Numerous locations along Eglinton Avenue East - Ongoing through October 2023
- Architectural and electrical finished - Numerous At-Grade Stops - Ongoing through Fall 2023



# RETAINING WALL LOCATIONS

