

Traffic Configuration Change on Eglinton Avenue East, east of Holly Street

As early as Monday, October 2, 2023

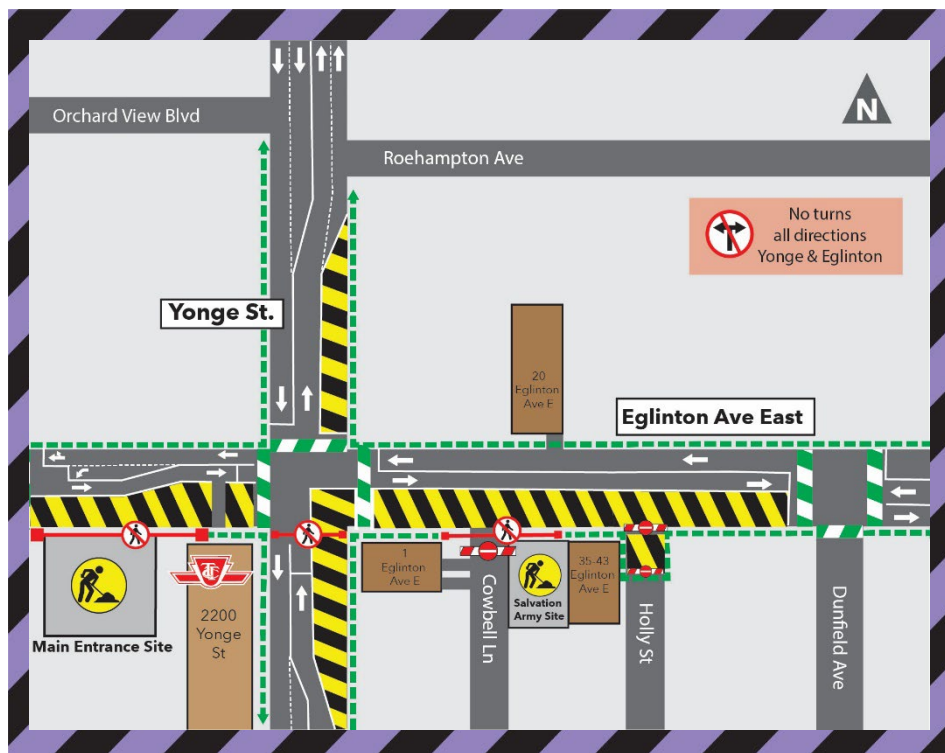

What Work is Taking Place?

As early as Monday, October 2, 2023, a new traffic configuration will be implemented on Eglinton Avenue East, east of Holly Street. Traffic on Eglinton Avenue East will shift to the north side of the road east of Holly Street, and the construction will move to the south side. All other traffic staging, turn restrictions, sidewalk and crosswalk closures will remain in place. Overnight work may be required to facilitate special activities. This traffic configuration is expected to remain in place until approximately early-November 2023. For more information, please review the complete notice below or visit www.metrolinx.com/eglintoncrosstownlrt

What to Expect

Noise from construction activity, including trucks, breaking of concrete and asphalt, utility work, and use of heavy equipment can be expected. Occasionally, use of a hydro-vacuum truck, jackhammer and/or compaction roller will be required. Construction vehicles and trucks will stage within work zones and traffic tapers. Traffic barrels, fencing, and signage will be in place to delineate work zones. Expect delays while travelling through the intersection. Traffic control personnel and/or a Paid Duty Officer will be present, while the traffic changes are being implemented.

HOURS OF WORK

- A new traffic configuration will be implemented as early as Monday, October 2, 2023.
- This configuration will remain in place until approximately early-November 2023.
- Overnight work may be required to implement the traffic changes.
- Overnight work may be required to facilitate special activities.
- This work may be rescheduled or delayed due to inclement weather and/or unforeseen circumstances.

TRAFFIC DETAILS

- Traffic on Eglinton Avenue East will shift to the north side of the road east of Holly Street, and the construction will move to the south side.
- All other traffic staging and turning restriction will remain in place.
- One lane of traffic in each direction will be maintained on Eglinton Avenue East and Yonge Street.

PEDESTRIAN DETAILS

- No changes to the current pedestrian routes are expected as a result of this work.

TRANSIT INFORMATION

- Access to TTC will be maintained at all times.
- Please visit www.ttc.ca for more information.

East Community Office:
Hours of Operation: Monday to Friday, 9:00 a.m. to 5:00 p.m.
Tel: 416-874-5900

West Community Office:
Hours of Operation: Monday to Friday, 9:00 a.m. to 5:00 p.m.
Tel: 416-782-8118

Contact Us:

Write to us at: crosstown@metrolinx.com
Find us on Twitter @CrosstownTO
Visit the website: www.metrolinx.com/eglintoncrosstownlrt