

Lane Reductions and Turn Restrictions at Duplex Avenue and Eglinton Avenue for Utility Works

As early as Tuesday, October 10, 2023

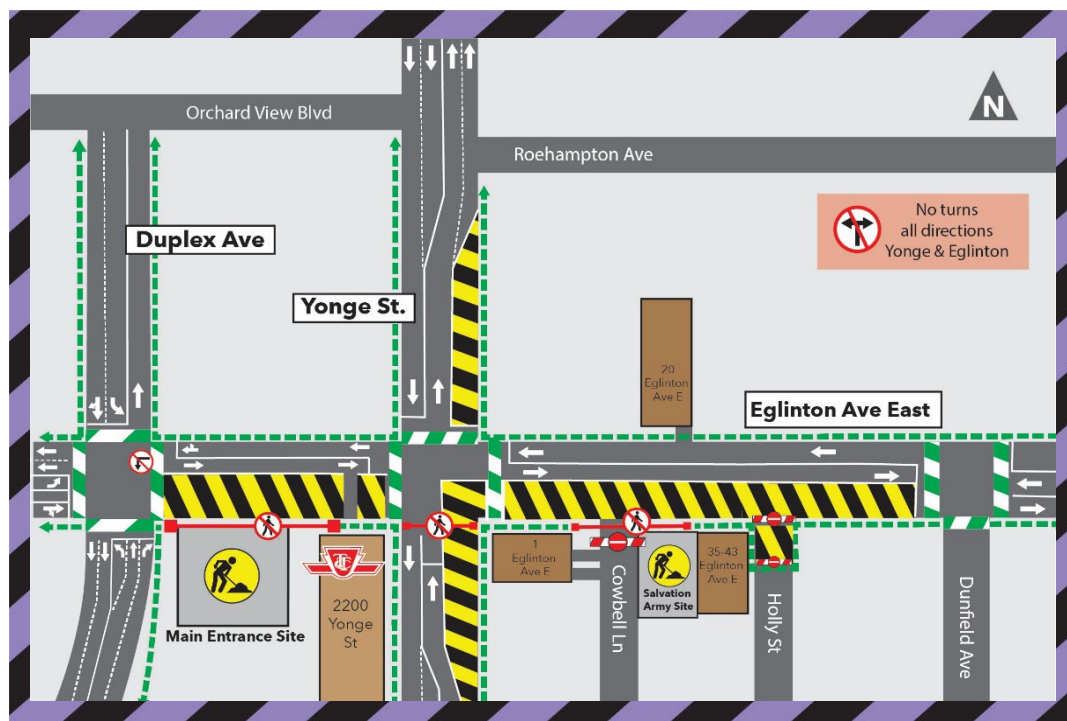

What Work is Taking Place?

As early as Tuesday, October 10, 2023, crews at Eglinton Station will be continuing utility works at Duplex Avenue and Eglinton Avenue. To complete this work safely, westbound traffic will be reduced to one shared through and right turn lane east of Duplex Avenue. The westbound left turn from Eglinton Avenue onto Duplex Avenue will be restricted, with the exception of TTC and emergency vehicles. All other traffic staging, turn restrictions, and sidewalk and crosswalk closures will remain in place. This work is expected to take place for 7 days a week between 7:00 a.m. and 7:00 p.m. for approximately one (1) week. Upon completion of this work, short term lane

reductions may be required to facilitate special activities. Please review the complete notice or visit www.metrolinx.com/eglintoncrosstownlrt for more information.

What to Expect

Noise from construction activity, including trucks, breaking of concrete and asphalt, utility work, and use of heavy equipment can be expected. Construction vehicles and trucks will stage within work zones and traffic tapers. Traffic barrels, fencing, and signage will be in place to delineate work zones. Occasionally, use of a hydro-vacuum truck, jackhammer and/or compaction roller will be required. Expect delays while travelling through the intersection. Traffic control personnel and/or a Paid Duty Officer will be present, while this work takes place. One lane of traffic will be maintained at all times on Eglinton Avenue.

HOURS OF WORK

- As early as Tuesday, October 10, 2023, for approximately one (1) week.
- This work is expected to take place for seven days a week between 7:00 a.m. and 7:00 p.m.
- This work may be rescheduled or delayed due to inclement weather and/or unforeseen circumstances.
- Work may be longer or shorter than expected.

TRAFFIC DETAILS

- Westbound traffic will be reduced to one shared through and right turn lane east of Duplex Avenue.
- The westbound left turn from Eglinton Avenue onto Duplex Avenue will be restricted, with the exception of TTC and emergency vehicles.

PEDESTRIAN DETAILS

- No changes to the current pedestrian routes are expected as a result of this work.

TRANSIT INFORMATION

- Access to TTC will be maintained at all times.
- Please visit www.ttc.ca for more information.

East Community Office:
Hours of Operation: Monday to Friday, 9:00 a.m. to 5:00 p.m.
Tel: 416-874-5900

West Community Office:
Hours of Operation: Monday to Friday, 9:00 a.m. to 5:00 p.m.
Tel: 416-782-8118

Contact Us:

Write to us at: crosstown@metrolinx.com
Find us on Twitter @CrosstownTO
Visit the website: www.metrolinx.com/eglintoncrosstownlrt