

Moss Park Construction Liaison Committee

September 26, 2023 (rescheduled from
September 19, 2023)



Agenda

Welcome (5 minutes)

- Introductions
- Land Acknowledgement
- Housekeeping

Presentation (35 minutes)

- Construction Liaison Committee (CLC)
- Ontario Line Overview
- Moss Park Station
- Ontario Transit Group
- Moss Park Station
 - Archeological Update
 - Construction Update
- Moss Park Signage
- Community Engagement Summary
- Community Benefits & Supports

Feedback and Discussion (50 minutes)



SAFETY

Here are some safety tips from Toronto Public Health:

- Follow the school zones safety traffic rules.
- When possible, park legally on a side street or in school designated areas and walk your child to school to avoid adding to the traffic in front of or near the school.
- Stop at crosswalks and intersections. Allow children and other pedestrians to fully cross the road before continuing on.
- Enter and exit school zones and driveways slowly and carefully. Watch for children on and near the road, particularly in the morning and after school hours.
- Have your child exit the car on the right side nearest to the sidewalk.
- Do not speed.



Source: Toronto Public Health

Construction Liaison Committee (CLC)

Construction Liaison Committees (CLC)

Construction Liaison Committees (CLCs) provide open, two-way communication and sharing of information before and during the construction of the Ontario Line project. The CLC will focus on the impacts, issues and areas of concern for resolution related to the Ontario Line construction within the Moss Park area neighbourhood. The CLC will meet monthly as construction activities get underway.

- CLC frequency is flexible, depending on schedules/availability and critical construction work
- Metrolinx will work with stakeholders to develop meeting agendas
- Meetings will last 60-90 minutes, depending on the agenda
- Metrolinx to chair the CLC with support from the project constructor
- Project constructor will participate and lead the construction updates
- Action items/issues/complaints to be logged for resolution

Community representatives



- Elected officials
- Community groups/residents
- Residents' groups/associations
- Tenant representatives
- BIAs
- Business owners

City of Toronto



- Transit Expansion Division
- Transportation Services
- Other representatives as needed

Project team members



- Metrolinx—representatives from Subways Sponsors Office, Design Division, Community Engagement, Project Teams and Project Constructor.

ONTARIO LINE - WHO DOES WHAT



Manages Province's Alternative Financing and Procurement program and lead the procurement process.

Negotiates Project agreement, which spells out roles and responsibilities of each party.

Oversees execution of Project agreement, provides quality control oversight.

Oversees Transit-Oriented Communities (TOCs) - a Provincial program led by Infrastructure Ontario and/or Metrolinx.



ONTARIO TRANSIT GROUP

Contracted to design, build and deliver the Ontario Line Subway - Southern Civils project.

Designs, constructs and finances Southern Civil, Stations and Tunnel work for 6-kilometre tunnel and associated tunnelling works from Exhibition to Don Yard portal (west of the Don River)

Joint venture between Ferrovial Construction and Vinci Construction Grands Projets (through their subsidiary JANIN ATLAS)



Contribute subject matter expertise regarding City policies, requirements, permits and procedures.

Ensure key City and community interests are noted and addressed through application design reviews and permits.

Work with partners to minimize negative impacts on residents and the environment.

Monitor construction sites for safety and adherence to City standards and bylaws.

TTC

Reviews all traffic plans and makes adjustments to routes and services to mitigate impacts to customers.



Overarching accountability for entire project, strategy and content approvals, building relationships and understanding needs of the community.

Oversight of construction contractors to ensure compliance with contractual obligations, including work schedules, adherence to acceptable noise levels, traffic management plans and permit conditions.

CLC CODE OF CONDUCT



Participate fully, openly, and transparently in discussions, while also creating an environment where all members are encouraged to contribute and share their views.



Participate in a respectful manner towards other CLC members by using appropriate language.



Keep requested agenda and discussion items within the mandate and scope of the Construction Liaison Committee.



Represent their community's diverse perspectives and interests.



Maintain confidentiality of sensitive issues, when requested by participants.



Commit to equity, diversity and inclusion by supporting the participation of the whole community regardless of race, gender, class, sexuality, age or ability.

Ontario Line

Ontario Line

Ontario Line

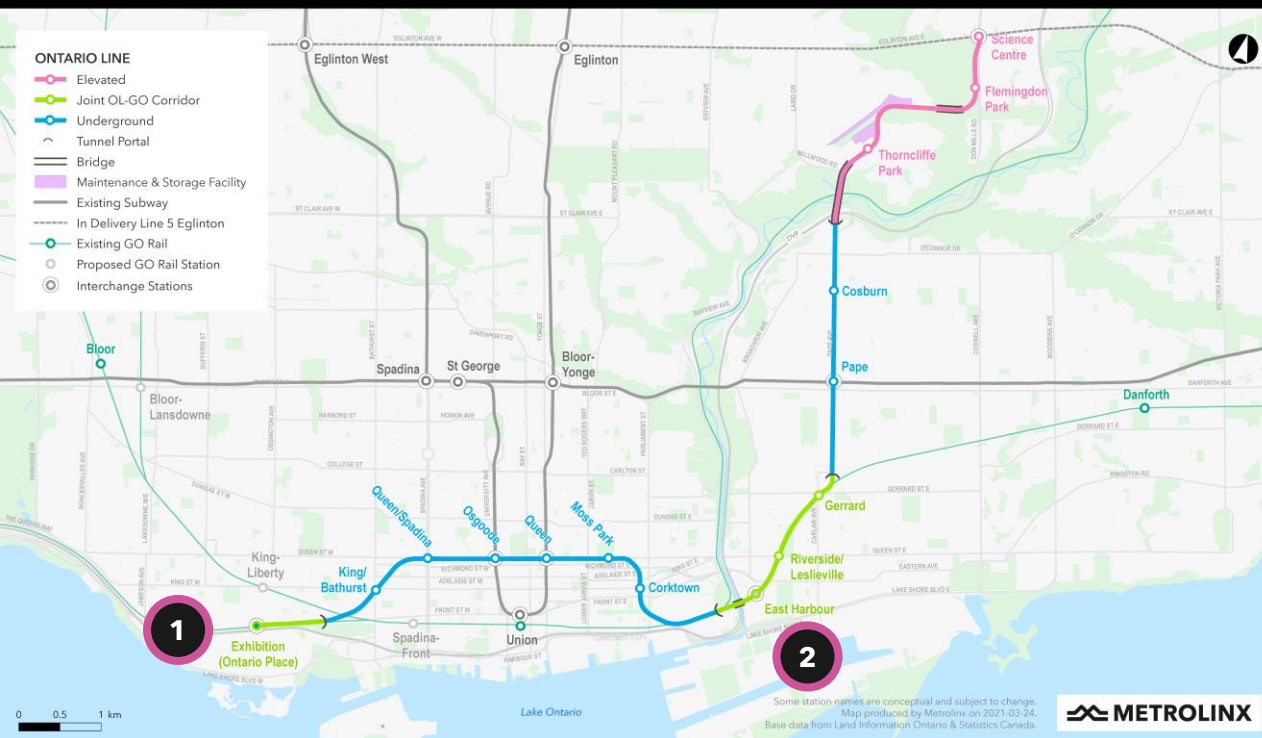

15.6 kilometres long



15 stations



As frequent as every 90 seconds during rush hour



227,500 more people within walking distance to transit



388,000 daily boardings



40+ connections to other transit options



Up to 47,000 more jobs accessible in 45 minutes or less, on average

1 South Alignment of Ontario Line (Exhibition to Corktown/Don Yard)

2 North Alignment of Ontario Line (East Harbour to Science Centre)



Moss Park Station

PROJECT BENEFITS - MOSS PARK STATION

- The Ontario Line station at Moss Park will connect a **dense and fast-growing area** of the city to the subway network. An estimated 7,300 people are expected to use Moss Park Station during the busiest travel hour.
- A new Ontario Line connection in this community will help **relieve congestion** on popular surface routes, like the 75 Sherbourne bus and 501 Queen streetcar, with almost 1,500 customers transferring to and from the Ontario Line every day during the busiest travel hour.
- The station will be within a short **10-minute walk** for more than 23,600 residents, in an area of the city where 4,100 households don't currently own a car.



Designs not final and subject to further approvals and consultations.

Artist's rendering - subject to change

MOSS PARK: STATION AREA MAP

- The **station entrance** placed a few steps away from streetcar stops.
- The station entrance is located on **Sherbourne Street**.

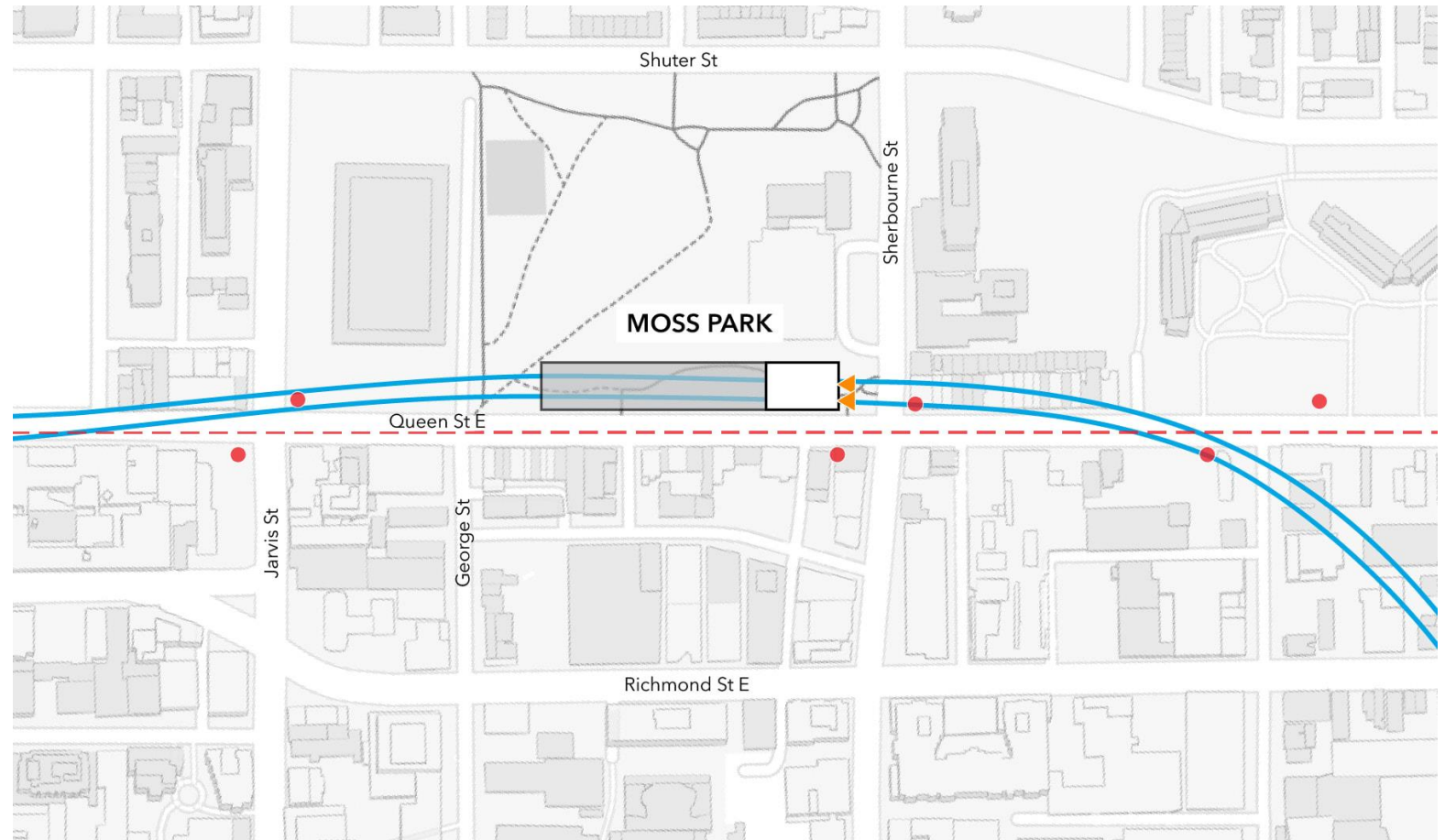

Moss Park Station

- | | | |
|----------------|------------------|--------------------------|
| Tunnelled | Streetcar Stop | Station Building |
| Streetcar Line | Station Entrance | Underground Station Area |

Note: Heritage attributes will be conserved where possible.

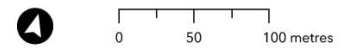

METROLINX

Ontario Transit Group

ABOUT ONTARIO TRANSIT GROUP (OTG)

Ontario Transit Group (OTG) is a joint venture between **Ferrovial Construction** and **Vinci Construction Grands Projets** to design, build and deliver the **southern portion of Ontario Line Subway** - Southern Civil, Stations and Tunnel work. The contract was awarded in November 2022.

Stations:

- **One above-ground station** to be integrated with the existing GO Transit Exhibition Station.
- **Two underground stations** to be integrated with the existing TTC Osgoode and Queen subway stations.
- **Four new underground stations** (King/Bathurst, Queen/Spadina, Moss Park, Corktown).

Tunnel:

- **6-kilometre tunnel** and associated tunnelling works from Exhibition to Don Yard portal (west of the Don River), shown in yellow.



Ontario Line South Civil spans Exhibition to Don Yard portal (west of the Don River), shown in yellow.

Moss Park

Archaeological Update

ARCHAEOLOGY UPDATE

The archaeological field work has been completed and consists of the following activities:

- Mechanical Excavation of Three Trenches (May 2023)
- Mechanical Excavation of the Project Area and Documentation of Archaeological Features (May to August 2023)

The archaeological work has now entered the reporting phase, with the following steps in progress:

- Preliminary Reports for MCM Review (September/October 2023)
- Final Reports will be prepared once all artifacts have been processed and analyzed.



ARCHAEOLOGICAL FINDINGS- QUEEN STREET



Wood lined privy



Crew at work



Overview of basements

ARCHAEOLOGICAL FINDINGS- GEORGE STREET



Warehouse Basement



Crew at work



Possible cistern

Construction Update

CONSTRUCTION ACTIVITY: FALL 2023

- Utilities investigations
- Borehole drilling
- New Moss Park Arena parking area
- Fencing and hoarding installation
- Working platform installation
- Pedestrian scaffolding installation
- Sewer works at Sherbourne Street

TRAFFIC MANAGEMENT

OTG's traffic management plan has been submitted to Metrolinx and is under review. Haul routes are dependent on construction methodology, supplier locations and availability. The most efficient routes are still being considered at this time.

The proposed traffic management plan includes:

- Lane closures and detours will be minimized.
- Some parking will be temporarily closed.
- Flagging operation and paid-duty police officer (PDO) control expected to be implemented to improve the safety of construction traffic ingress and egress to/from site.
- Pedestrians will be detoured during some phases of construction and will have access to dedicated pedestrian tunnels and lanes to ensure safe movement.
- Some street parking will be temporarily closed; new parking lot built for Moss Park Arena.
- There are no expected impacted bicycle parking spaces during construction.

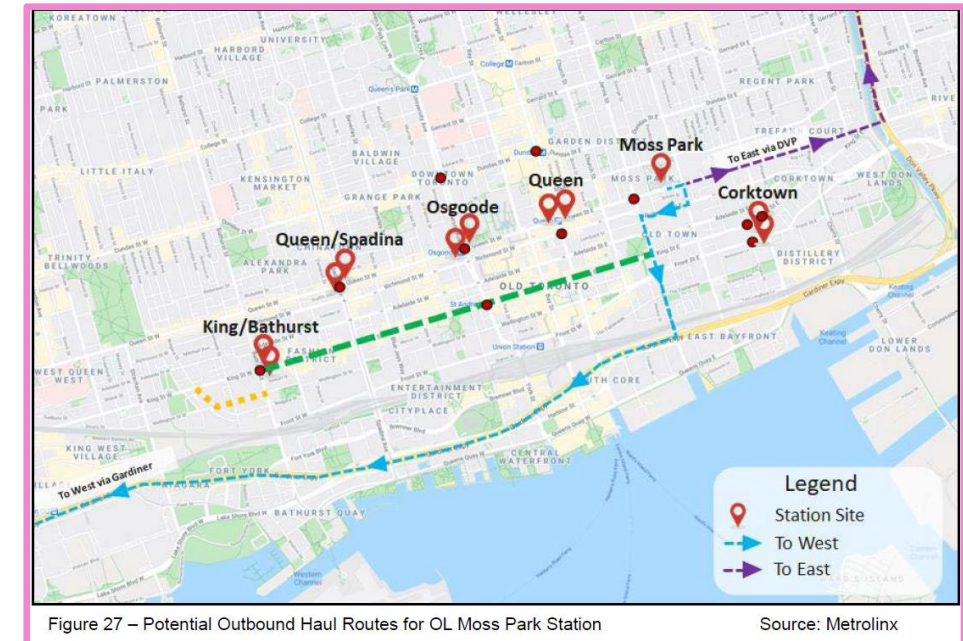

CURRENT ACTIVITY: BOREHOLE DRILLING

Expected start date: As early as September 20, 2023

Expected duration: Up to 4 months

Expected hours of work: 9 p.m. to 6 a.m.*

What is happening?

- Crews will be **drilling a hole** in the ground and **installing vibration monitoring devices**.
- Vibration monitoring devices are installed to **verify underlying soil characteristics**.

What can you expect?

- Nearby residents can expect to **hear some noise** related to the borehole drilling and other equipment.
- The **eastbound curb lane** on Queen Street **will be closed** during the duration of this work.
- Drilling will be intermittent and will not be happening all at once. Crews will be moving from spot to spot.
- After each shift, the holes will be covered and marked for safety until workers return to continue drilling.

**All work may be postponed or rescheduled due to unforeseen circumstances.*

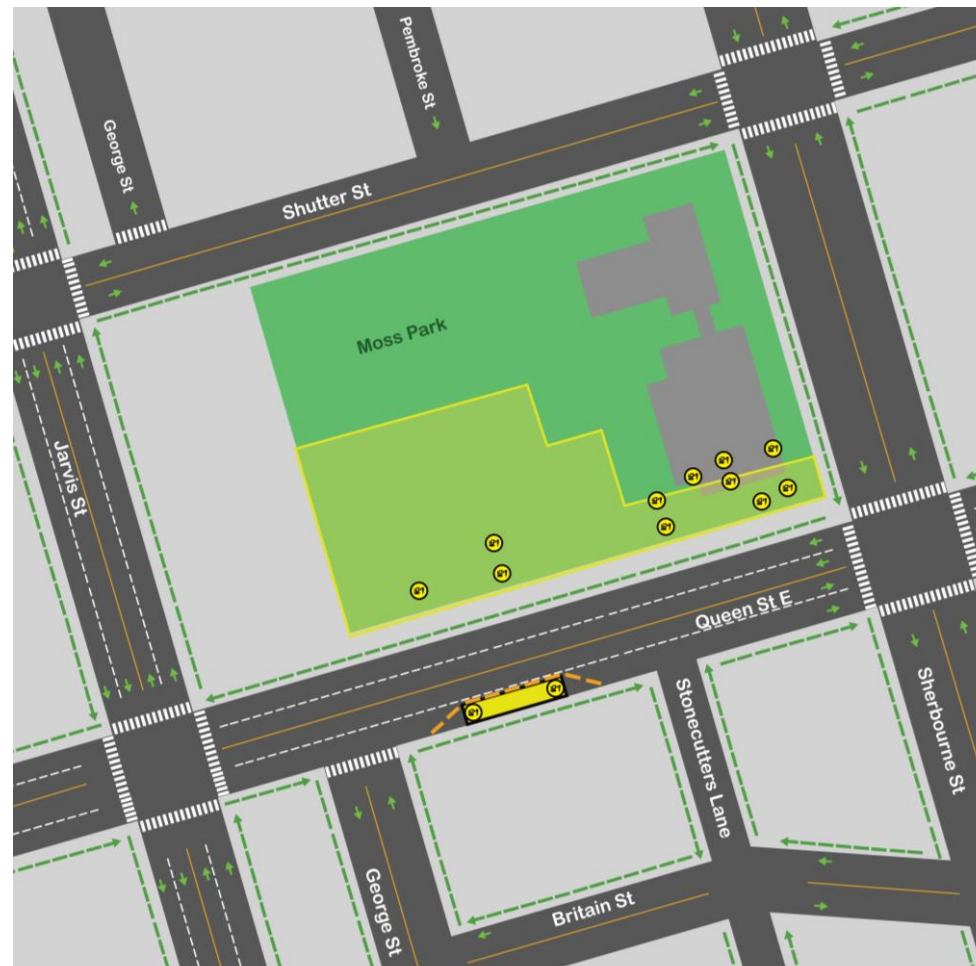

SITE PREPARATION ACTIVITIES

Expected start date: As early as October 2, 2023

Expected duration: Up to 3 months

Expected hours of work: 7 a.m. to 5 p.m.*

What is happening?

- **New Moss Park Arena parking area:** Crews are building a temporary parking lot to allow the community to continue having access to the Moss Park Arena during station construction.
- **Fencing and hoarding installation:** To ensure that the public is protected from upcoming construction within the site, crews will be installing new fencing along the site perimeter, including a pedestrian tunnel along Queen Street East.
- **Working platform installation:** Crews will be installing a platform to ensure equipment used in construction is stable.

What can you expect?

- Nearby residents can expect to see a lot of activity in the park, including the **installation of fencing and hoarding, trucks, general construction equipment and vehicles** including pickup trucks, utility trucks and excavators for this work.
- There is expected to be **some noise related to excavation** during the construction of the new parking lot.
- Upon completion of the new parking lot, the current **Moss Park Arena parking lot will be closed**.
- There will be **on-street parking closures** westbound on Queen Street East.
- Pedestrian and vehicle traffic is expected to be maintained in all directions.

*All work may be postponed or rescheduled due to unforeseen circumstances.

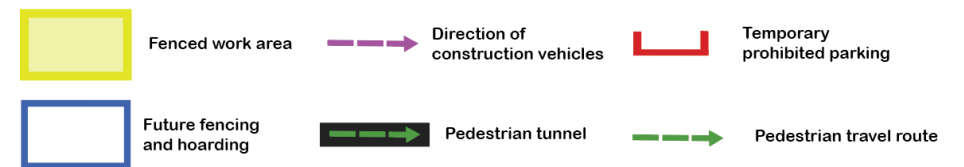

UPCOMING ACTIVITY: PEDESTRIAN SCAFFOLDING INSTALLATION

Expected start date: As early as October 2, 2023

Expected duration: Up to one month

Expected hours of work: 9 p.m. to 6 a.m.*

What is happening?

- To ensure that the public is protected from nearby construction within the site, crews will be **building a tunnel** to cover the pedestrian walkway.

What can you expect?

- The **westbound sidewalk along Queen Street East will be closed** during construction. Pedestrians are advised to follow the signage and use the parking lane as a walkway.
- The **westbound parking lane on Queen Street East will be temporarily closed** during construction and used as a pedestrian walkway.

**All work may be postponed or rescheduled due to unforeseen circumstances.*

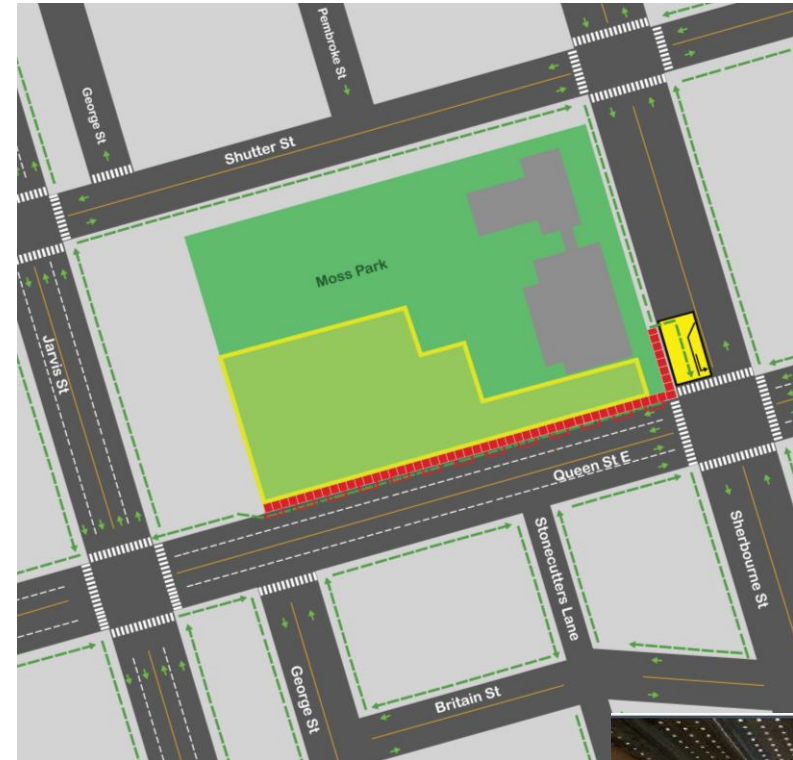

CURRENT ACTIVITY: OVERNIGHT SEWER AND UTILITY SURVEYING

Expected start date: As early as October 21, 2023

Expected duration: Up to 3 weeks

Expected hours of work: 9 p.m. to 5 a.m.*

What is happening?

- Construction crews will be **surveying utilities** and **conducting sewer inspections**.
- Crews will drill into the road to inspect utilities under the roadway. Once complete, the drill areas will be restored.
- Crews will move around within the locations shown on the map. Each site will take one or two nights to complete the work.**
- Equipment such as a saw cutter and a hydrovac truck will be used.

What can you expect?

- The **southbound lane and left turn lane on Sherbourne Street** will be closed and used as a pedestrian walkway. Vehicles traveling southbound will not be able to have access to Queen Street.
- A **lane closure is expected to occur overnight** for one weekend from 7 p.m. to 5 a.m. to limit traffic impacts. Specific details around timing for the overnight closure **will be shared with the community**.
- Residents will hear **noise from work equipment**.

**All work may be postponed or rescheduled due to unforeseen circumstances.*



UPCOMING ACTIVITY: OVERNIGHT SEWER WORKS

Expected start date: As early as October 21, 2023

Expected duration: Up to three weeks with closure expected for one weekend

Expected hours of work: Overnight weekend work from 7 p.m. to 5 a.m. in addition to day work from 7a.m.*

What is happening?

- During the initial sewer works connection, a **lane closure will occur overnight** for one weekend from 7 p.m. to 5 a.m. to limit traffic impacts
- Additional sewer works will also **occur during the day** between 7 a.m. to 5 p.m.

What can you expect?

- The **westbound sidewalk along Queen Street East will be closed** during construction. Pedestrians are advised to follow the signage and use the parking lane as a walkway.
- The **westbound parking lane on Queen Street East will be temporarily closed** during construction and used as a pedestrian walkway.
- The **southbound lane and left turn lane on Sherbourne Street will be closed** and used as a pedestrian walkway. Vehicles traveling southbound will not be able to have access to Queen Street.

**All work may be postponed or rescheduled due to unforeseen circumstances.*



LOOK AHEAD: UPCOMING CONSTRUCTION WORKS

Site building delivery - late 2023

To ensure public protection from vehicle and machinery movement, work crews will have a delivery site for oversized building trailers. Nearby residents can expect **noise related to truck movement and equipment**. Flaggers will be on site to ensure the safety of both pedestrian and vehicular traffic.

Station piling work - late 2023

To prepare for the future excavation of the Moss Park station, a support wall made with long cylinders filled with concrete installed in the ground to support the ground when completing a deep excavation. Flaggers will be on site to ensure the safety of both pedestrian and vehicular traffic while expecting deliveries and machinery movement.

Station excavation work - January 2024

Excavation work will be done to dig for the installation the new station building. Nearby residents can expect to hear **noise related to drilling and other equipment**. Flaggers will be on site to ensure the safety of pedestrians and vehicular traffic.

PREPARATION OF WORKS - PERMISSION TO ENTER NOTICES

For properties in the immediate vicinity of Ontario Line construction, the **Permission to Enter (PTE) process** is used to gain access for a variety of reasons, including carrying out pre-construction surveys or to install various types of monitoring equipment.

Pre-condition surveys **establish and document your property's existing condition** and consists of a visual inspection and documentation of the condition of the interior and exterior of your property, including any visible portion of basement foundation.

The Permission to Enter process is important for the safety of business and homeowners since it allows the project team to **monitor settlement, noise and vibration.**

Depending on design requirements, work related to PTEs at a property could involve any of the following: pre-condition surveys and testing, settlement monitoring and noise and vibration monitoring.

If you have any questions related to PTEs at your property, please direct them to: permissiontoenter@ontransitgroup.ca

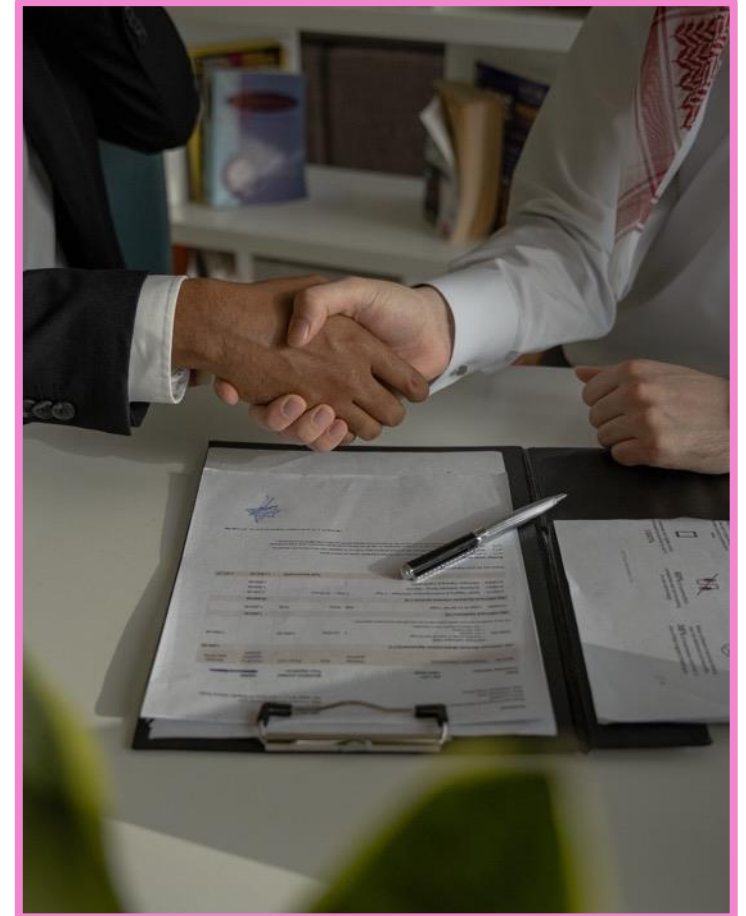

Moss Park Signage

MOSS PARK SIGNAGE

- Temporary signage has been installed on the existing park fencing facing Queen Street East
- The existing fencing will be replaced by plywood construction hoarding
- Once installed, OTG will install signage that provides project information and wayfinding
- Metrolinx is planning to work with the community to gather inputs and feedback into what the community would like to see on the hoarding
- More details, along with a better sense of timing for these discussions, will be shared with the community as things progress



Metrolinx temporary project signage installed along Queen Street East.

Community Engagement: Summary

Community Engagement at Moss Park



Moss Park Station CLC (November 2022)



Meeting with Moss Park Coalition

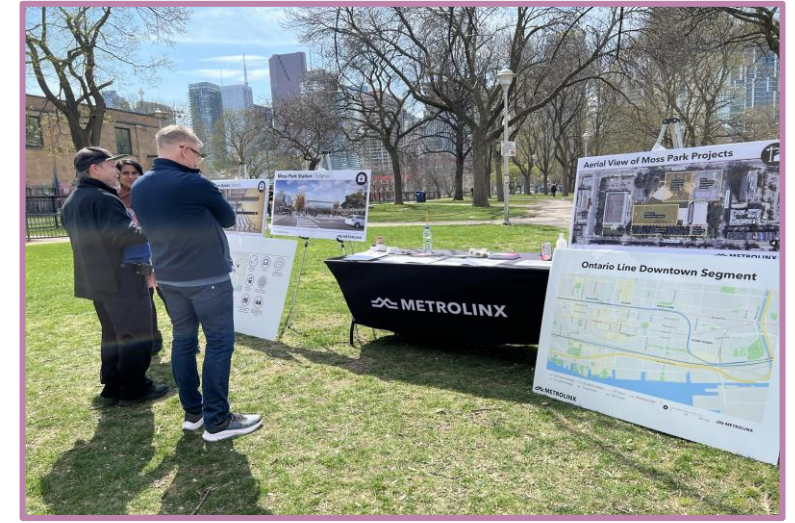

Pop-up with City of Toronto at John Innes (April 2023)



Joined TCHC Special Constables for a Senior's BINGO event



Hosted a public open house at John Innes (November 2022)



Pop-ups at Moss Park Market & TCHC buildings

Community Benefits & Supports

THE 4-PILLAR COMMUNITY BENEFITS & SUPPORTS PROGRAM

Beyond the transit benefits associated with our projects, through implementation of Community Benefits & Supports in all our transit projects, we will leave communities better than we found them. This will be done by engaging with local communities, making improvements to public spaces and providing connections to job opportunities.

This pillar promotes apprenticeship training and workforce development opportunities for local communities and equity seeking groups including 10% hiring targets for BIPOC (Black, Indigenous, People of Colour), women, apprentices and requirements for an anti-racism policy.



Pillar One:
Employment Opportunities



Pillar Two:
Local Business Supports

This pillar builds and fosters relationships with local businesses to minimize and alleviate business disruptions & reduce the economic impacts as a result of construction, for example through shop local initiatives & procurement from local businesses.

4-Pillar Community Benefits & Supports Program

We are working with communities as a connector to the right decision-makers to make improvements to public spaces surrounding transit project construction, where no funding is available.



Pillar Four:
Community Improvement Supports



Pillar Three:
Public Realm Improvements

During the design and development phase of our projects, we are finding ways to leave the surroundings in an improved state when construction of the project creates temporary disruptions.

Feedback and Discussion

Next Steps

MOSS PARK - COMMUNITY OUTREACH

Construction Liaison Committees

- October 12, 2023, November 9, 2023
- CLC meetings: virtual, in-person and hybrid options

Business Community

- Direct business outreach and canvassing

Community Outreach

- Virtual and in-person open houses
- Pop-ups within the community and in residential building lobbies
- In-person and virtual consultation with residences and businesses

Community Notification

- Physical and digital distribution of construction notices
- Canvassing high impact areas
- News and information provided in the Ontario Line newsletter



