

# Construction for Exhibition Station near Pirandello Street

Expected start date: As early as November 7, 2023

Expected completion: Up to May 1, 2024

Hours of work: Weekdays, between 7 a.m. to 5 p.m.

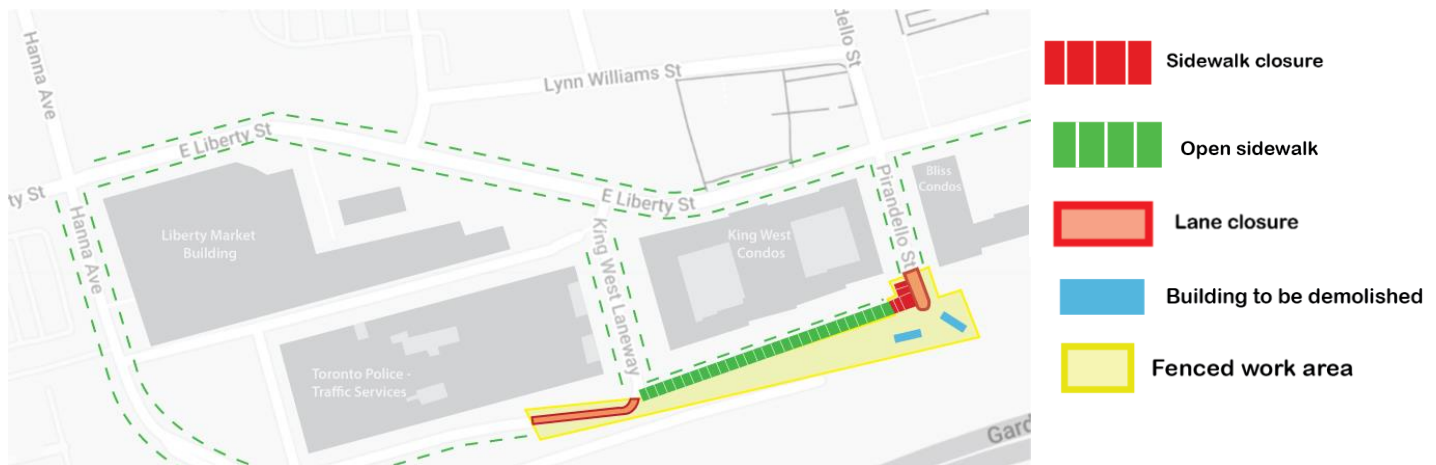

## What is happening?

- In anticipation of future Ontario Line construction at Exhibition, crews will be preparing the site for the next phase of work.
- Expected work in this area includes hydro investigation and relocation, and demolition of existing buildings.

## Construction Details

### 1. Hydro investigations and relocation

- Crews will be relocating underground utility wires between Hanna Ave and Pirandello St, north of the rail corridor. As part of the relocation, a trench will be dug and filled with concrete to make way for new electrical conduits.

### When will work begin and how will it impact me?

- Work will begin as early as November 7, 2023. This work will last up to May 1, 2024.
- Work will take place weekdays between 7 a.m. and 5 p.m. Crews will begin to arrive on site as early as 6 a.m. There is no planned overnight or weekend work.
- Entrances to condo buildings, parking garages, and other services will remain open.
- The south end of Pirandello St and King West Laneway will be closed along with a small section of sidewalk on the west side of Pirandello Street. A pedestrian passageway between Pirandello Street and King West Laneway will be maintained.
- There will be no street parking on the west side of Pirandello Street during this time.

- A portion of the sidewalk connecting Pirandello Street and King West Laneway will be closed for up to 10 weeks. Entrance/exits to condo units along the sidewalk will remain open and accessible through the King West Laneway.
- The east section of the laneway connecting Hanna Avenue and King West Laneway will be closed for up to nine weeks.
- The work area will be fenced off and will be inaccessible to pedestrians.

#### What can I expect?

- Construction vehicles, trucks, and equipment will be visible on site. Necessary equipment and trailers will also be brought into the work area.
- Trucks and other equipment will be using the south end of both Pirandello Street and King West Laneway to enter and exit the work site as needed.
- Noise and vibration associated with construction and related vehicles should be expected.

## 2. Demolition of buildings

- One of the first planned work activities is demolition of two Metrolinx-owned buildings located near the rail corridor.

#### When will work begin and how will it impact me?

- Crews are expected to start as early as November 7, 2023. This work will last for approximately three weeks.
- Work will take place during the day between 7 a.m. to 5 p.m. Crews will begin to arrive on site as early as 6 a.m. There is no planned overnight or weekend work.
- Access to Hanna Avenue south of East Liberty Street will be closed to regular traffic except construction vehicles, trucks and equipment.

#### What can I expect?

- Construction vehicles, trucks and equipment will be visible on site.
- Fencing with filtered fabric will be set up to limit dust and debris from exiting the site.
- Work may be delayed, rescheduled or extended due to weather conditions or unforeseen circumstances.
- All the necessary construction permits have been obtained.
- Visit [metrolinx.com/OntarioLineConstruction](https://metrolinx.com/OntarioLineConstruction) for more information on work happening in your community.

### About the Ontario Line

- 15.6-kilometre subway line that will make it faster and easier to travel within Toronto and beyond.
- 15 stops and more than 40 connections to other transit, including GO train, subway, LRT, streetcar, and bus lines.
- Less than 30 minutes from one end of the line to the other.
- 28,000 fewer cars on the road each day.

#### Contact us:

Call us 24/7 at: [416-202-5100](tel:416-202-5100)

Write to us at: [ontarioline@metrolinx.com](mailto:ontarioline@metrolinx.com)

Find us on Twitter, Facebook, and Instagram: [@ontarioline](https://twitter.com/ontarioline)

Visit the website: [www.metrolinx.com/ontarioline](https://www.metrolinx.com/ontarioline)

#### Visit our community office:

770 Queen Street East (near Queen & Broadview)

General hours:

- Mondays, Tuesdays, and Fridays: 9:00 a.m. to 5:00 p.m.
- Wednesdays and Thursdays: 10:00 a.m. to 6:00 p.m.