

Utility work at Logan Avenue bridge

Expected start date: Late November, 2023

Expected duration: One (1) month

Hours of work: Weekdays Monday - Friday, 7 a.m. - 7 p.m.

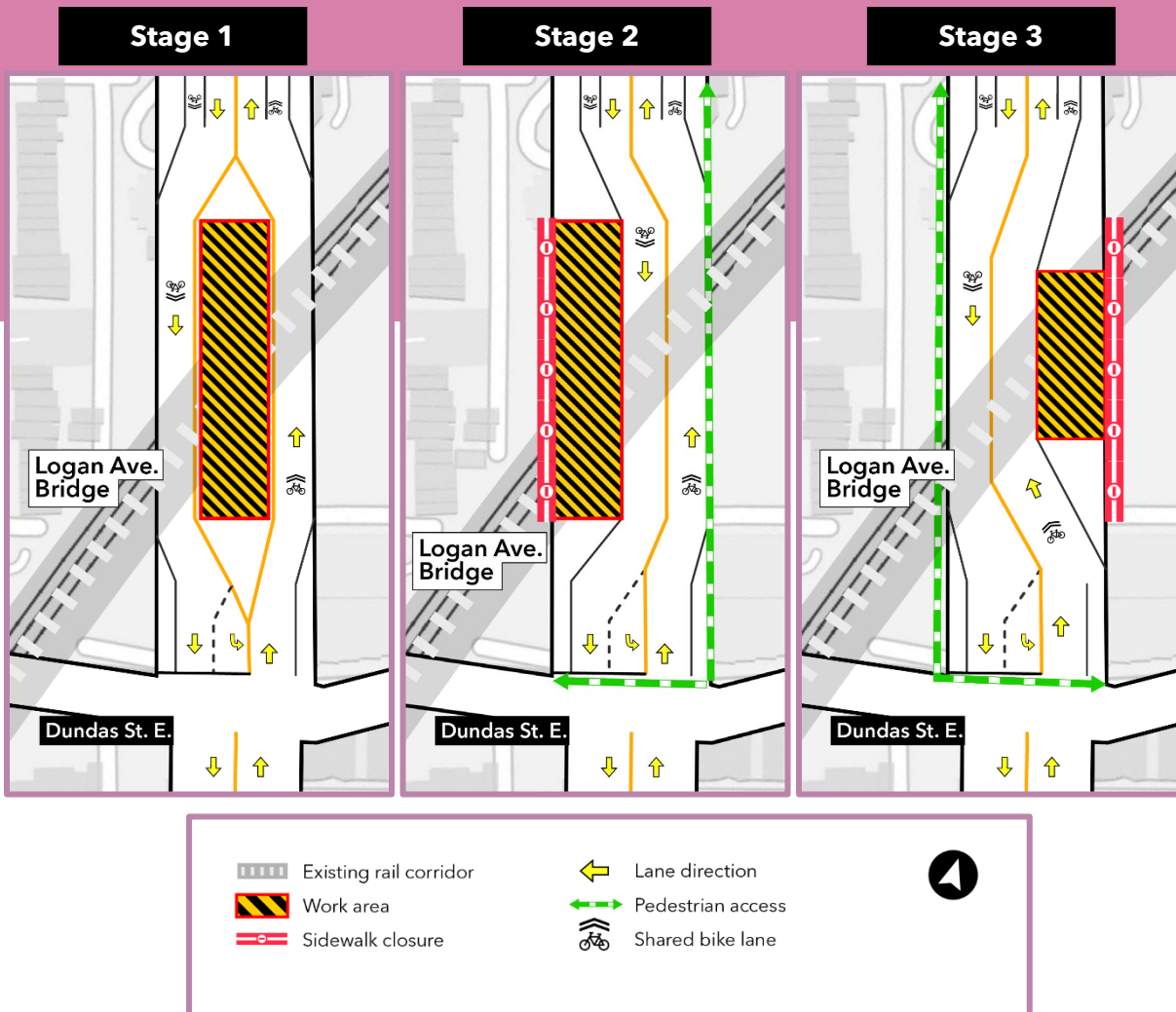

What is happening?

- Starting in late November 2023, a new sewer will be installed beneath the Logan Avenue bridge
- This work will take place between 7 a.m. - 7 p.m. for approximately one month
- Temporary traffic lane and sidewalk closures will be required to complete this work safely. Please review the traffic and pedestrian details section below for specific details.

Parking details

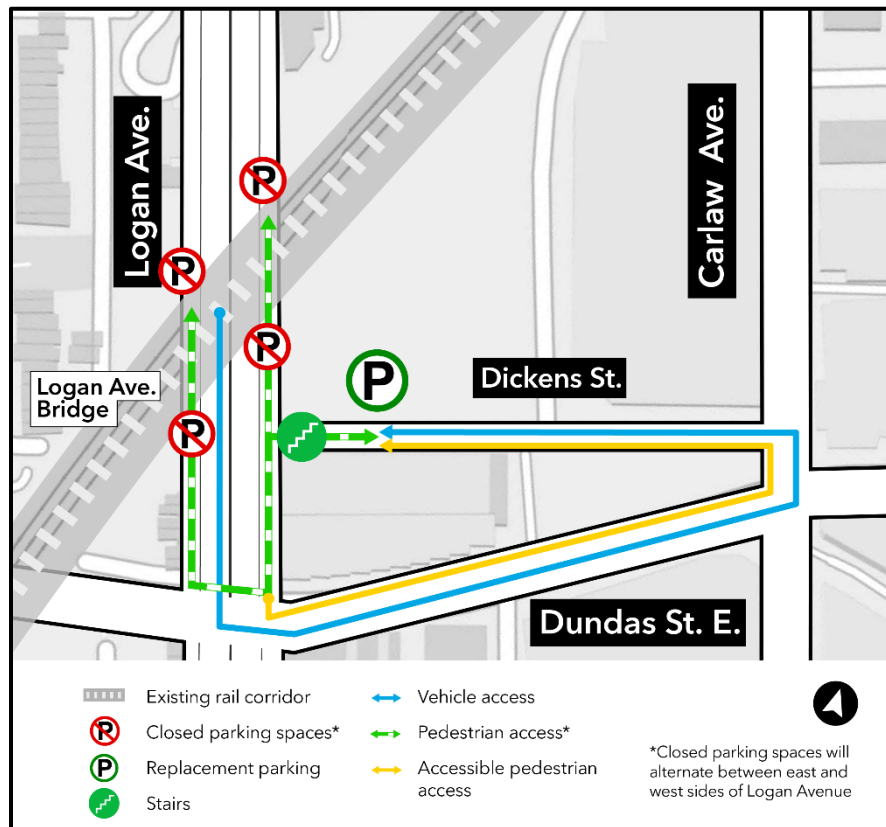

- Approximately sixteen (16) on-street parking spaces will be restricted on either side of the Logan Avenue bridge between Dundas Street East and 444 Logan Avenue.
- Free replacement parking is available for the community at 10 Dickens Street.
- The parking lot at 10 Dickens Street can be accessed by vehicle via Dundas Street East and Carlaw Avenue which also provides accessible pedestrian connection to the parking lot. Pedestrian access to the parking lot is also available via a staircase on the east side of Logan Avenue approximately 50 metres north of Dundas Street East.
- Please refer to the map above for further details on replacement parking routes and parking displacements.

Traffic and pedestrian details

- The bike lanes on the east and west sides of Logan Avenue will be closed.
- Alternating sidewalk closures will be in place on the east and west sides of Logan Avenue under the rail bridge. One sidewalk will remain open at all times. Pedestrians will be directed to use the existing crosswalks at Dundas Street East and First Avenue.
- Northbound and southbound cyclists will need to share the road with vehicles while travelling through this area. Share the road signs will be posted to guide cyclists.

Contact us:

Call us 24/7 at: 416-202-5100

Write to us at: ontarioline@metrolinx.com

Find us on X, Facebook, and Instagram: [@ontarioline](https://www.instagram.com/ontarioline)

Visit the website: www.metrolinx.com/ontarioline

Visit our community office:

770 Queen Street East (near Queen & Broadview)

General hours:

Mondays, Tuesdays, and Fridays: 9:00 a.m. to 5:00 p.m.

Wednesdays and Thursdays: 10:00 a.m. to 6:00 p.m.

Drivers are reminded to slow down and allow cyclists to safely merge into the traffic lane. Do not attempt to pass cyclists.

- Traffic control personnel and/or a paid duty officer will be present to direct traffic and pedestrians.
- Traffic lanes will shift to the east and west sides of the street as work progresses from one end of the bridge to the other.
- One traffic lane in each direction will be maintained on Logan Avenue.

What to expect

- Noise from construction equipment including a hydro-vacuum truck, excavators, loaders, rollers, generators, pumps, and delivery trucks.
- Temporary traffic, pedestrian, and cyclist detours will be in place.
- Parking restrictions on Logan Avenue beneath the rail bridge.
- Advance signage will be in place to direct vehicles, pedestrians, and cyclists.
- Installation of a new 450mm combined sewer on Logan Avenue.
- Traffic barrels, fencing, and barriers will be in place to separate and secure work zones.
- Construction equipment and materials will be properly secured within the work zones.
- Work may be delayed due to weather conditions or unforeseen circumstances.

About the project

- 15.6-kilometre subway line that will make it faster and easier to travel within Toronto and beyond.
- 15 stops and more than 40 connections to other transit, including GO train, subway, LRT, streetcar and bus lines.
- Approximately 30 minutes from one end of the line to the other.
- 28,000 fewer cars on the road each day.

Contact us:

Call us 24/7 at: [416-202-5100](tel:416-202-5100)

Write to us at: ontarioline@metrolinx.com

Find us on X, Facebook, and Instagram: [@ontarioline](#)

Visit the website: www.metrolinx.com/ontarioline

Visit our community office:

770 Queen Street East (near Queen & Broadview)

General hours:

Mondays, Tuesdays, and Fridays: 9:00 a.m. to 5:00 p.m.

Wednesdays and Thursdays: 10:00 a.m. to 6:00 p.m.