

# UPDATE: Overnight sewer and utility surveying near Queen Street West and Spadina Avenue

**Expected Start Date:** As early as February 6<sup>th</sup>, 2024.

**Expected End Date:** April 30<sup>th</sup>, 2024

**Planned work hours:** Overnight between 9 p.m. to 5 a.m.

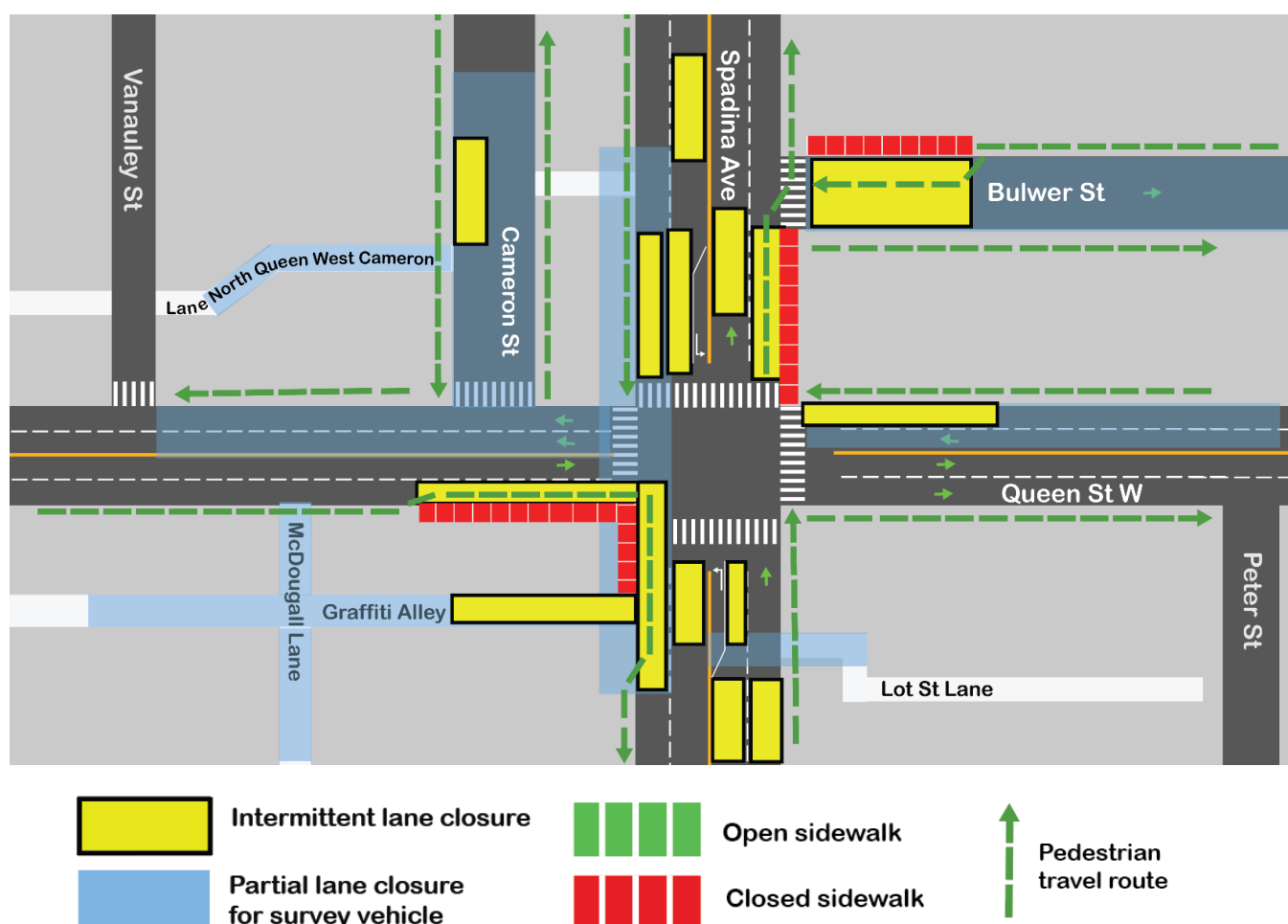

## What is happening?

- Construction crews will continue to survey and monitor utilities and conduct sewer inspections at various points around Queen St W and Spadina Ave as shown in yellow on the map above.
- Crews will rotate between the locations shown on the map during the work period as each site will take one to two nights to complete the work.
- Temporary lane closures are required for crews to safely carry out the survey work.
- The work is done by accessing sewer manholes to assess internal conditions of sewers and cabling before station construction begins.
- Crews will drill into the road to inspect utilities under the roadway. Once complete, the drilled areas will be restored.
- Equipment such as a saw cutter and a hydrovac truck may be used.

## What to expect?

- Work will take place in the overnight period between 9 p.m. to 5 a.m. the next morning.
- Temporary lane restrictions north and southbound on Spadina Ave and Cameron St and east and westbound on Queen St, Graffiti Alley and Bulwer St will be in effect.
- Turn lanes are expected to remain open, and traffic lanes will be maintained in both

directions during the work period.

- All pedestrian access is expected to be maintained in both directions using pedestrian walkways where sidewalks are closed.
- Pedestrian access at Graffiti Alley will also be maintained, flaggers will be present to ensure safety.
- Residents can expect to hear noise from work equipment.
- Barriers will be used to separate the pedestrian passageways from active traffic lanes.
- Work may be postponed or rescheduled due to unforeseen circumstances.
- All the necessary construction permits have been obtained.

### About the Ontario Line

- 15.6-kilometre subway line that will make it faster and easier to travel within Toronto and beyond.
- 15 stops and more than 40 connections to other transit, including GO train, subway, LRT, streetcar and bus lines.
- Less than 30 minutes from one end of the line to the other.
- 28,000 fewer car trips each day.

#### Contact us:

Call us 24/7 at: [416-202-5100](tel:416-202-5100)

Write to us at: [ontarioline@metrolinx.com](mailto:ontarioline@metrolinx.com)

Find us on X, Facebook, and Instagram: [@ontarioline](https://www.instagram.com/ontarioline)

Visit the website: [www.metrolinx.com/ontarioline](http://www.metrolinx.com/ontarioline)

#### Visit our community offices:

770 Queen Street East (near Queen & Broadview)

45 Overlea Blvd (East York Town Centre)

General hours:

- Mondays, Tuesdays, and Fridays: 9:00 a.m. to 5:00 p.m.
- Wednesdays and Thursdays: 10:00 a.m. to 6:00 p.m.