



**The Ontario Line
Lakeshore East Joint Corridor
Early Works
Construction Liaison Committee**

February 15, 2024

LAND ACKNOWLEDGMENT

Treaties and Reserves in the Greater Golden Horseshoe

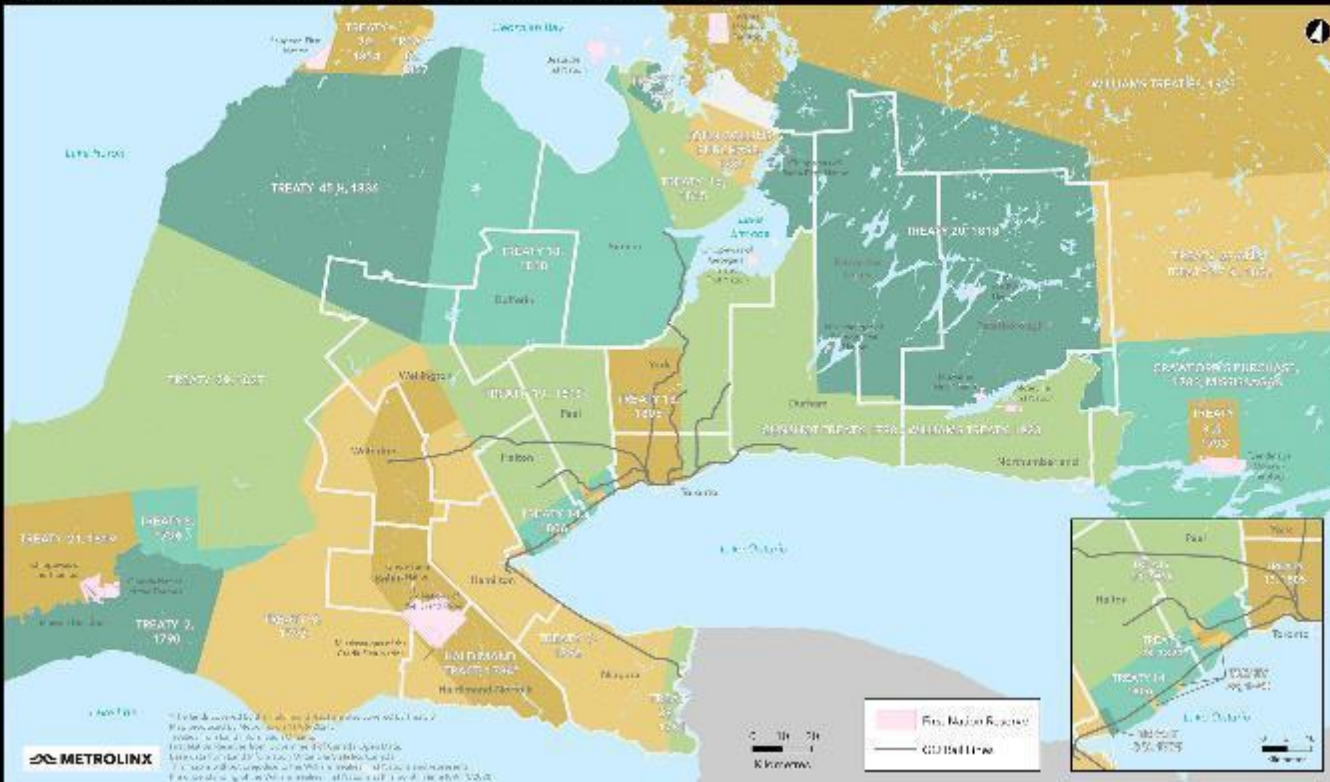

Let us take a moment to acknowledge we are on lands that have been, and continue to be, home to many Indigenous Peoples including the Anishnabeg, the Haudenosaunee and the Huron-Wendat peoples.

We are all Treaty people. Many of us have come here as settlers, as immigrants or involuntarily as part of the trans-Atlantic slave trade, in this generation, or generations past.

We acknowledge the historic and continued impacts of colonization and the need to work towards meaningful reconciliation with the original caretakers of this land.

We acknowledge that Metrolinx operates on territories and lands covered by many treaties that affirm and value the rights of Indigenous communities, Nations and Peoples.

We understand the importance of working towards reconciliation with the original caretakers of this land. At Metrolinx, we will conduct business in a manner that is built on a foundation of trust, respect and collaboration.

Agenda

1. Welcome:

- Land Acknowledgement
- Safety Moment
- Action Items

2. Complaints and Issues Tracker

3. Noise and Vibration Summary- January 2024

4. Construction Update:

- Queen Street East Bridge
- Dundas Street East Bridge
- Logan Avenue Bridge
- In-Corridor Work
- Eastern Avenue Bridge

5. Discussion/Next CLC



Safety Moment - Sun safety during winter

Enjoy those precious sunny days and make sure your skin is well protected

- UV rays that can cause damage to skin are still strong during winter, even on cloudy days.
- Snow on the ground can reflect these rays
- Cover exposed skin with sunscreen that is at least 30SPF
- Weather apps can tell you the current level of UV rays and when they are strongest throughout the day.

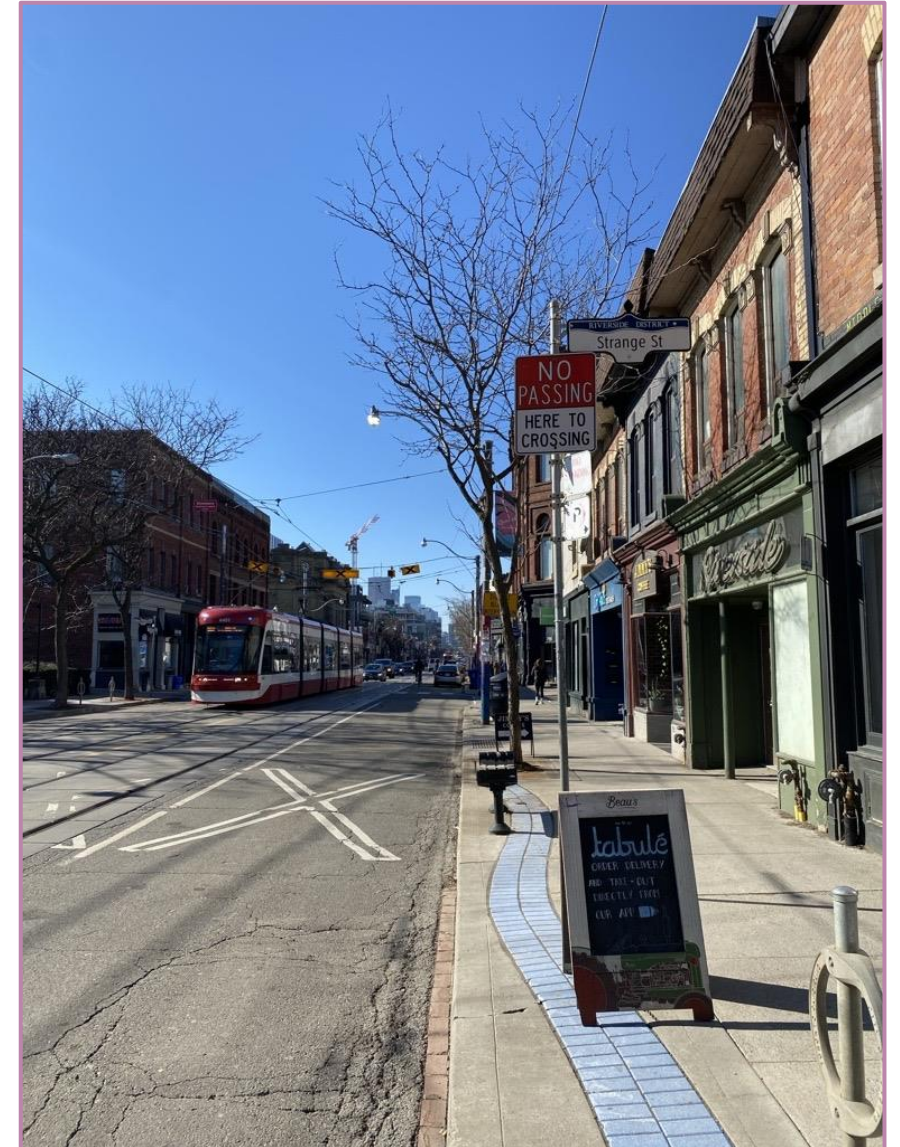

January CLC Action Items

Action	Response	Status
<p>Metrolinx to add a third column to the action items table in the next and all subsequent CLC presentation decks indicating their open/closed status at the time of the meeting.</p>	<p>Metrolinx will add a third column to the action items table to include status of the items.</p>	<p>Completed.</p>
<p>Metrolinx to add ongoing action item of art panels on construction hoarding.</p>	<p>Metrolinx will add Riverside BIA mural to outstanding action items.</p>	<p>Completed.</p>
<p>Metrolinx to seek clarification on the purpose of the contractor's chosen location for the laydown area at the end of First Avenue.</p>	<p>The land at the end of First Ave is required for construction laydown and upcoming access road construction. A privacy screen has been installed on the fencing as a mitigation measure to provide a visual separation between the construction zone and the street. The contractor will use the laneway off Gerrard St E to enter and exit the laydown area. In rare situations where the laneway cannot be used, contractors will only use First Ave during daytime hours. Metrolinx will continue to monitor the situation.</p>	<p>Completed.</p>
<p>Metrolinx to seek clarification on plans to preserve the historic railway station sign next to the west abutment of the Queen bridge.</p>	<p>Property specific mitigation measures will be taken to protect the Heritage Plaque on the west side of the Queen St E bridge. The plaque will be removed and installed in a temporary location - Mx will coordinate the removal and temporary relocation of the plaque with Heritage Toronto. The plaque will then be permanently reinstated in a nearby location once OL construction is finished. Metrolinx will update the CLC once the removal plan for the plaque is confirmed.</p>	<p>Completed.</p>

January CLC Action Items

Action	Response	Status
Metrolinx to inform the Pape-Langley CLC about the Galt Walkway closure next to Gerrard Square.	Metrolinx has issued a construction notice and will install signage to inform residents in the Pape-Langley area of the pathway closure.	Completed.
Mx to take back BIA request to have assistance at pedestrian crossings during sidewalk closures (concerns with student safety)	Metrolinx is reviewing this request and will keep the CLC updated.	Pending.
Metrolinx to confirm timing for tree removals on the west side of the rail corridor at specifically at Mackey Park (Queen - Dundas).	Tree removals on the west side of the rail corridor are expected to begin as early as September 2024.	Completed.
Metrolinx to check for recent updates to share regarding work done in the catchment area of the Eastern Ave.	Metrolinx will continue to update the CLC members on Eastern Ave bridge work.	Completed.
Metrolinx to install signage for pathway closure 2 weeks in advance and look at placing signs at Mrytle St.	Metrolinx will canvass the pathway closure notice two (2) weeks in advance and will have signage installed at least one (1) week in advance of the closure date.	Completed.
DCC/LURA to confirm if TTC OCS poles and pedestrian light poles on Queen St. E. are permanent.	Metrolinx has confirmed with the contractor that the TTC OCS poles are permanent as they have been moved to accommodate future bridge structures. As for the pedestrian light poles, the two directly on the east side of the Queen Street bridge are slated for removal and the pole directly east of McGee Street is staying.	Completed.

January CLC Action Items

Action	Response	Status
Mx to take back request to share 2024 year look ahead with community (Jan - Dec 2024) and to post the lookahead on the website.	Metrolinx is working with the contractors to create a 6-month construction lookahead schedule to share with the community. The plan will include confirmed major work activities that have been tentatively scheduled. The schedule will provide the community with a greater understanding of what activities are to come over the next 6 months but not to have the dates confirmed as they are subject to change. Once this lookahead is created, Metrolinx will look into the feasibility of posting it online. In addition, Dufferin Construction, in collaboration with Metrolinx, will be hosting a public open house at Jimmie Simpson Recreation Centre on Thursday, February 29 to share construction updates and milestones with the community.	Pending.
What is the status on Metrolinx having an Infrastructure Ontario (IO) representative attend these CLC meetings?	Metrolinx will be speaking to IO about having a representative attend one (1) CLC meeting every four (4) months. Update: Metrolinx has reached out to IO and is waiting for their confirmation.	Pending.
What is the status on having the contractor sharing noise and vibration updates?	Metrolinx is actively working on the best way for the contractor to share noise and vibration report summaries and are hoping to have an update before the next CLC meeting on February 15th. Update: Metrolinx will be sharing noise and vibration summary at the February CLC.	Pending.
What actions has the contractor taken to resolve recent complaints regarding vibrations and trucks blocking residents' driveways?	When a vibration complaint is received by a member of the community, Metrolinx checks with environmental specialists on whether there were any exceedances and reports back to the resident. In the instance where an exceedance is captured by the monitor, the environmental specialists advise on mitigation measures the contractor can take to reduce the noise/vibration levels and those measures are adopted.	Completed.

January CLC Action Items

Action	Response	Status
Metrolinx is actively looking at installing a noise and vibration monitor on the south side of the Dundas St E bridge.	Metrolinx is currently in conversation with residents about installing the monitor on their home. Update: Noise and Vibration monitor has been installed on the south side of the Dundas St E bridge.	Pending.
Can business owners along Queen in the first block west of the corridor have vibration/noise monitors installed on their properties?	Metrolinx will investigate the possibility of installing a noise and vibration monitor on business properties within the Riverside BIA catchment area. It should be noted that a monitor is already installed on the same side of the bridge and acoustic engineers are typically able to calculate estimated noise/vibration levels for properties in the nearby radius.	Pending.
Metrolinx is actively working on collaborating with local stakeholders to design a banner to be placed on the hoarding at Jimmie Simpson Park playground.	Metrolinx is continuing to work on this item and will provide updates to the community when milestones are reached.	Pending.

Complaints and Issues Tracker

Complaints and Issues Tracker

Complaint / Issue	Resolution
<p>Noise</p> <ul style="list-style-type: none"> Dundas St Jan 18, 2024 	<ul style="list-style-type: none"> Complaint received about overnight noise from buzz saw. Action: The Contractor confirmed that a noise barrier was being used to cut sound from activity and will continue to use barrier.
<p>Noise</p> <ul style="list-style-type: none"> Dundas St Jan 23, 2024 	<ul style="list-style-type: none"> Complaint received about overnight noise and vibration. Action: The Contractor reviewed the noise and vibration monitoring data during reported times and confirmed there were no exceedances registered.
<p>Noise</p> <ul style="list-style-type: none"> Logan Ave Jan 24, 2024 	<ul style="list-style-type: none"> Complaint received about overnight noise. Action: Resident was spoken to and was provided information on the activities.
<p>Staff Interaction</p> <ul style="list-style-type: none"> Logan Ave Jan 24, 2024 	<ul style="list-style-type: none"> Complaint received about worker behaviour. Action: The Contractor spoke to worker and ensured good neighbour practices were being reinforced.
<p>Bricks</p> <ul style="list-style-type: none"> Queen St E Jan 25, 2024 	<ul style="list-style-type: none"> BIA concerned about unsecured bricks close to construction site Action: Contractors were notified, and bricks were moved immediately.
<p>Signage</p> <ul style="list-style-type: none"> Logan Ave Jan 29, 2024 	<ul style="list-style-type: none"> Inquiry received about placement of traffic and pedestrian signage. Action: Pedestrian detour signs are placed at the nearest crosswalk. The Contractor also ensured no signage was blocking other signs.
<p>Access</p> <ul style="list-style-type: none"> Logan Ave January 30, 2024 	<ul style="list-style-type: none"> Inquiry about garbage collection while curb lane in front of properties is closed for construction. Action: The Contractor confirmed that residents may place their garbage on sidewalk as normal and they will bring it to Dundas for them for pick-up.

Complaints and Issues Tracker

Complaint / Issue	Resolution
<p>Noise</p> <ul style="list-style-type: none">• Paisley Ave• Feb 1, 2024	<ul style="list-style-type: none">• Complaint received about feasibility of noise barriers for outdoor use.• Action: The Contractor has reviewed the noise barriers and updated them with more layers to provide effective noise mitigation. This barrier is used in addition to mobile barriers located closer to activity.
<p>Noise</p> <ul style="list-style-type: none">• Logan Ave• Feb 5, 2024	<ul style="list-style-type: none">• Inquiry received from resident about loud work happening in the morning.• Action: Resident was spoken to and explained the work taking place. A copy of the notice was also provided to resident.

Noise and Vibration Summary- January 2024

Noise and Vibration Monitoring Update

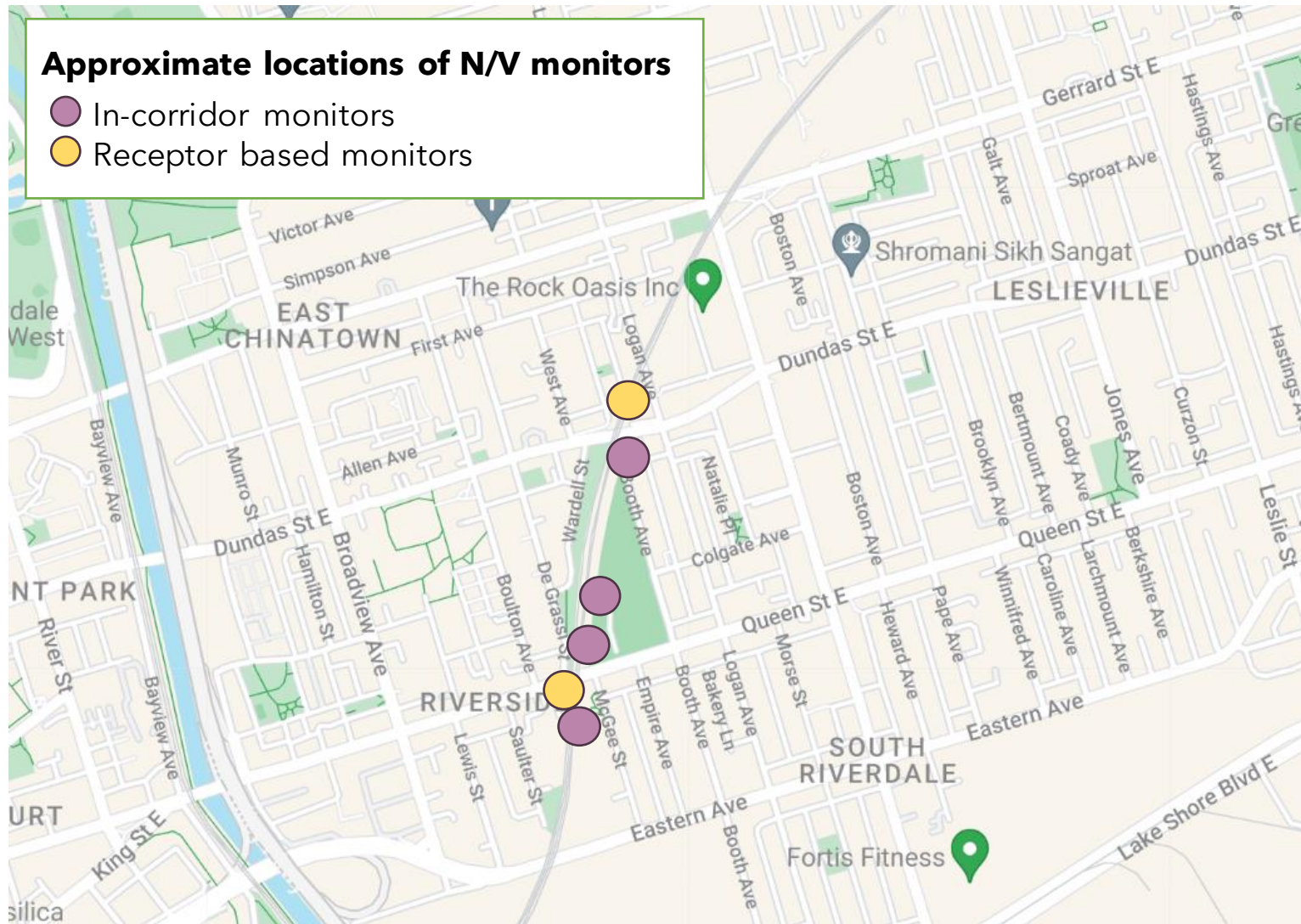

- Most noise and vibration monitoring instruments are located within the rail corridor
- Two monitors are located outside the corridor at residential receptors near Queen St. E. and Logan Ave. bridge
- To date, only one exceedance has been detected at the receptor near Logan Ave. bridge - no exceedances have been detected at the Queen St. E. receptor
- Noise limits are measured at the property boundary
- In-corridor monitors are used to detect the highest construction related noise sources - based on this data
- Metrolinx deploys mitigation measures where practical
- Several nighttime exceedances (above 75 dBA) are detected by in-corridor monitors because the instruments are located so close to the construction activity as well as passing trains

Noise Modelling Case Study

- In response to a complaint received on January 18, 2024, noise modelling was performed to estimate the noise levels at the location where the complaint was registered
- The below table demonstrates how noise from shoring and excavation work was predicted to attenuate from the in-corridor monitor to the receptor

Exceedance Date	Noise location	dBA level at monitoring station	Noise source	Estimated dBA receptor
January 18, 2024	<ul style="list-style-type: none"> • Dundas St. E. bridge south • Receptor is 50m from noise source 	78.3	<ul style="list-style-type: none"> • Mini excavator running during shift • Chainsaw to cut timber, 15-20 seconds at a time to cut timber 	70.3 (below noise limit)

Noise Mitigation Measures

The highest number of noise and vibration complaints has been received from properties within the vicinity of the Dundas St. E. bridge

As such, Metrolinx has installed additional acoustic barriers in this location to mitigate noise disruption

Dufferin Construction also continues to deploy noise barriers directly adjacent to construction equipment wherever possible

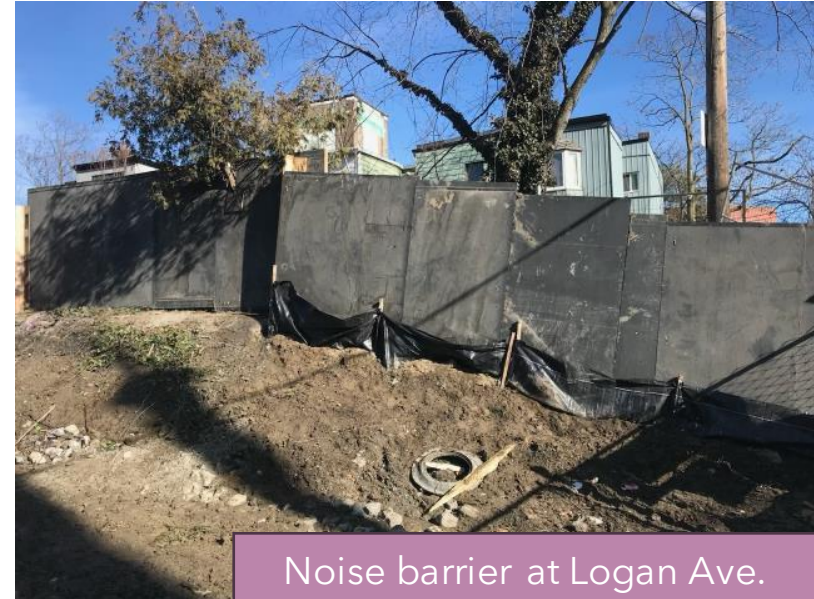

Registered Exceedances at Noise Receptor Locations: January 2024

Date/Time of Exceedances	Detail	Location	Source	Corrective action
January 11 - Nighttime	Noise	Near Logan Ave. bridge	<ul style="list-style-type: none"> Breaking concrete with an excavator 	<ul style="list-style-type: none"> Contractor instructed crews not to perform concrete breaking during the nighttime period

- The above table provides information on noise levels measured over 15-minute intervals (15-minute average).
- Exceedances unrelated to Lakeshore East Joint Corridor construction are not reflected in this table.

Registered Exceedances at In-Corridor Noise Receptor Locations: January 2024

Date/Time of Exceedances	Detail	Location	Source	Corrective action
January 11 - Nighttime	Noise	Within construction site near Queen St. E. and Dundas St. E. bridge	<ul style="list-style-type: none"> Use of dump trucks and heavy equipment. Use of saws to cut wood lagging boards 	<ul style="list-style-type: none"> Installed temporary noise barriers around work area
January 12 - Nighttime	Noise	Within construction site near Queen St. E. and Dundas St. E. bridge.	<ul style="list-style-type: none"> Idling of trucks and use of tonal beepers Use of excavator to break concrete and place materials 	<ul style="list-style-type: none"> Crews instructed not to break concrete overnight Audit was completed to ensure all equipment has broadband back up alarms
January 15 - Nighttime	Noise	Within construction site near Queen St. E. and Dundas St. E. bridge	<ul style="list-style-type: none"> Idling of trucks and equipment Use of excavator performing shoring and lagging work (moving materials). 	<ul style="list-style-type: none"> Review set up and location of noise barriers to ensure optimal placement
January 16 - Nighttime	Noise	Within construction site near Queen St. E. and Dundas St. E. bridge	<ul style="list-style-type: none"> Idling of trucks and equipment Use of excavator and saws performing shoring and lagging work (moving materials) 	<ul style="list-style-type: none"> Temporary barriers to be used where space constraints allow
January 17 - Nighttime	Noise	Within construction site near Queen St. E. and Dundas St. E. bridge	<ul style="list-style-type: none"> Use of excavator and saws performing shoring and lagging work (moving materials) 	<ul style="list-style-type: none"> Review set up and location of noise barriers to ensure optimal placement
January 18 - Nighttime	Noise	Within construction site near Dundas St. E. bridge	<ul style="list-style-type: none"> Use of saws to cut wood lagging boards 	<ul style="list-style-type: none"> Review set up and location of noise mitigation barriers to ensure optimal placement Coordinate 'noisy' operations such that they do not occur simultaneously, where possible.

- The above table provides information on noise levels measured over 15-minute intervals (15-minute average).
- Exceedances unrelated to Lakeshore East Joint Corridor construction are not reflected in this table.

Registered Exceedances at In-Corridor Noise Receptor Locations: January 2024

Date/Time	Detail	Location	Source	Corrective action
January 19 - Nighttime	Noise	Within construction site near Queen St. E. and Dundas St. E. bridge.	<ul style="list-style-type: none"> • Use of tonal backup alarms • Use of saws to cut wood lagging boards • Installing fencing 	<ul style="list-style-type: none"> • Review set up and location of noise mitigation barriers to ensure optimal placement • Coordinate 'noisy' operations such that they do not occur simultaneously, where possible.
January 23 - Nighttime	Noise	Within construction site near Queen St. E.	<ul style="list-style-type: none"> • Use of excavator, loader, drills, and chainsaw to install steel columns and wood lagging boards 	<ul style="list-style-type: none"> • Review set up and location of noise mitigation barriers to ensure optimal placement • Coordinate 'noisy' operations such that they do not occur simultaneously
January 24 - Nighttime	Noise	Within construction site near Queen St. E. and Dundas St. E. bridge	<ul style="list-style-type: none"> • Use of saws to cut wood lagging boards 	<ul style="list-style-type: none"> • Installation of 3m tall noise barrier wall • Coordinate 'noisy' operations such that they do not occur simultaneously, where possible.
January 25 - Daytime	Vibration	Within construction site near Queen St. E	<ul style="list-style-type: none"> • Use of a hydro-vacuum truck 	<ul style="list-style-type: none"> • Project team reviewed exceedance in real time and determined source of the vibration exceedance was detected within the corridor not at a receptor location, therefore, no action was required.

- The above table provides information on noise levels measured over 15-minute intervals (15-minute average).
- Exceedances unrelated to Lakeshore East Joint Corridor construction are not reflected in this table.

Ontario Line Construction Update Lakeshore East Joint Corridor Early Works Construction



Queen Street East Bridge

Queen Street East Bridge: Upcoming Work

Bridge demolition (daytime, weekday):

- Bridge structures (abutments and piers) on the east side of the bridge will be demolished and removed. Broken concrete will be loaded into dump trucks and hauled off site for disposal. Once demolition work is completed, the Contractor will begin to build the new abutments and piers.

Hours of work:

- As early as late February 2024, for approximately six months.
- Monday - Saturday, between 5 a.m. - 7 p.m. (demolition activities will be restricted before 7 a.m.)

What to expect:



- For safety, traffic lanes and sidewalks on Queen St. E. will be closed adjacent to the demolition work zone.
- Noise from construction equipment including excavators, jack-hammers, saws dump trucks, loaders, and skid steerers.



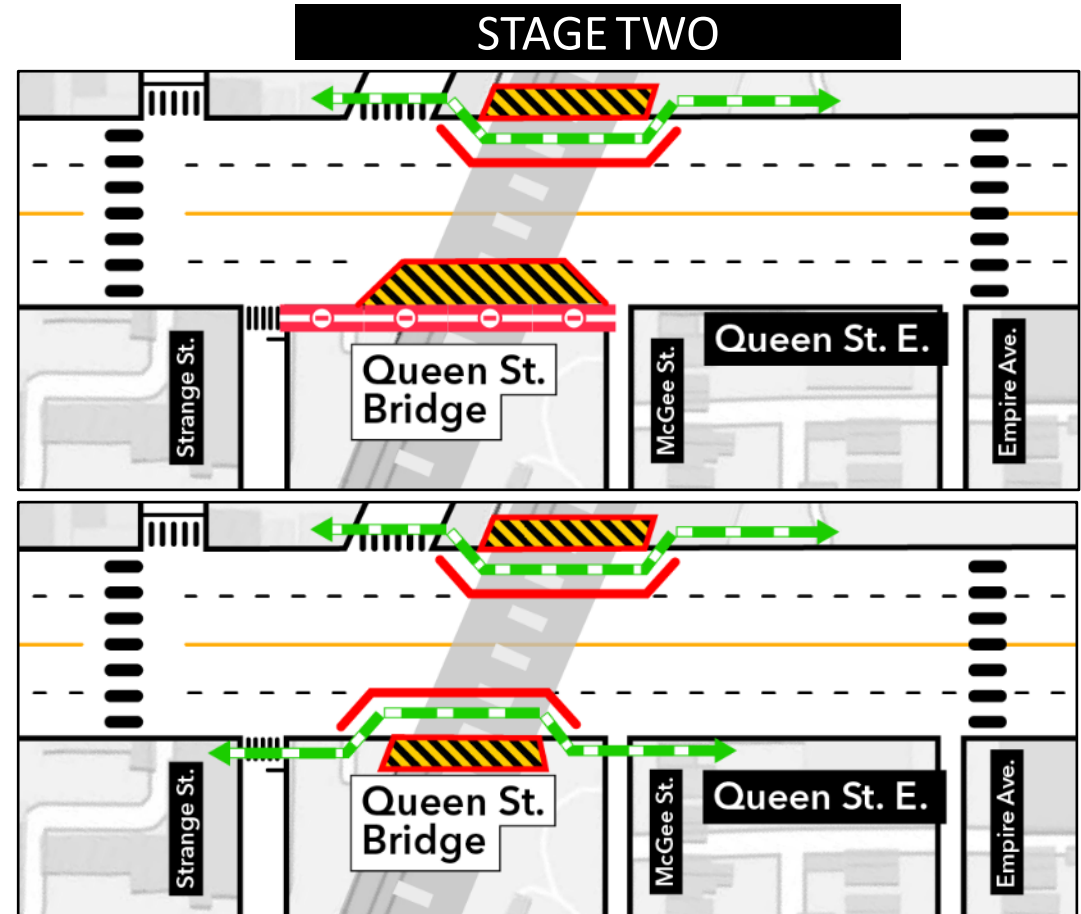
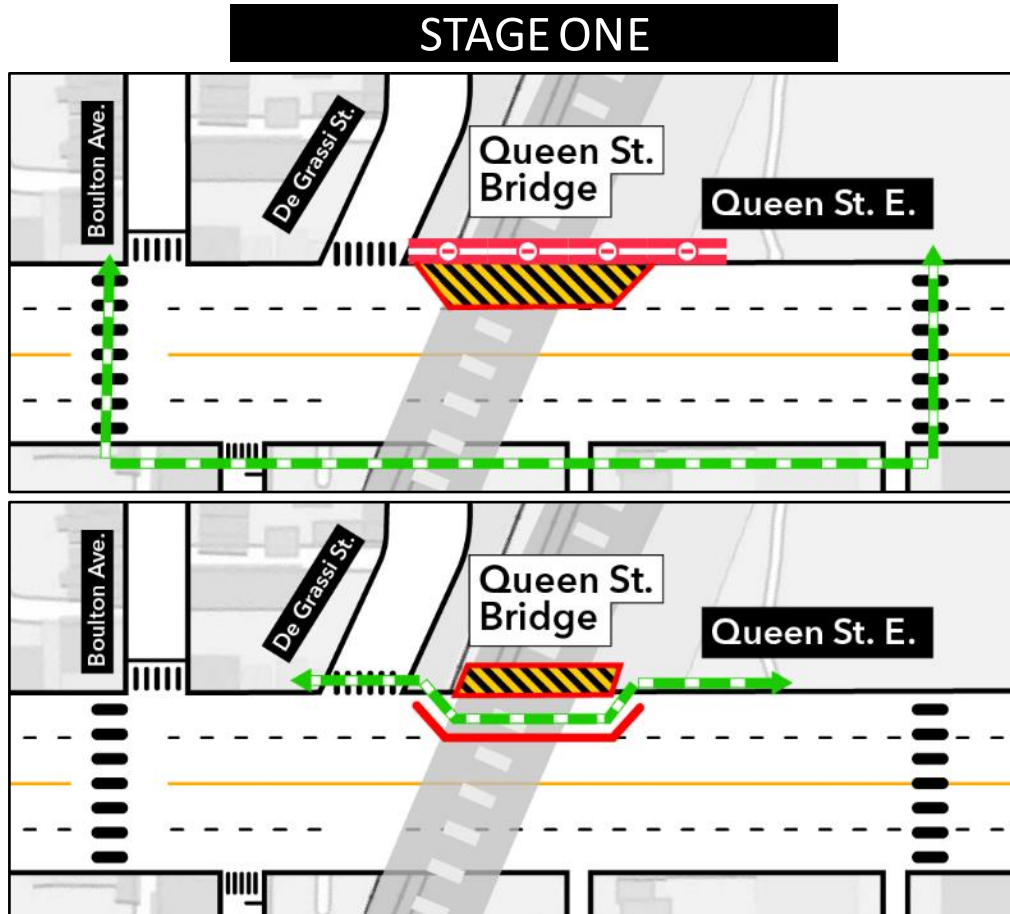

Traffic Configuration: Queen Street East Bridge Demolition Works

Stage one ongoing through early March 2024



-  Existing rail corridor
-  Work area
-  Sidewalk closure

-  Pedestrian access
-  Temporary concrete barrier





Dundas Street East Bridge

Dundas Street East Bridge - Ongoing and Upcoming Work

Centre pier construction (daytime, weekday)

- The existing piers in the centre of the bridge have been removed and construction of the new piers started on Thursday, January 11, 2024.
- A drill rig will be used to dig holes into the ground which will then be filled with rebar and concrete to support the pier footings. The new piers will then be built out of steel and concrete.

Hours of work:

- Ongoing Monday - Friday; 5 a.m. - 7 p.m. (up until 10 p.m. as required)
- **Stage 1:** Ongoing until late February 2024
- **Stage 2:** Beginning in early March and continuing until Spring 2024

What to expect:

- Work zones will be set up beneath the Dundas St. E. bridge to safely complete this work.
- The bike lanes on both sides of the street will remain closed. Eastbound and westbound cyclists will need to share the road with vehicles while travelling underneath the bridge.
- The sidewalk on the south side of Dundas St. E. will be closed during stage one of the work.
- Noise from construction equipment including a drill rig, crane, excavators, trucks, jack hammers, saws and loaders can be expected.

Stage one: Jan 11 - Late Feb 2024

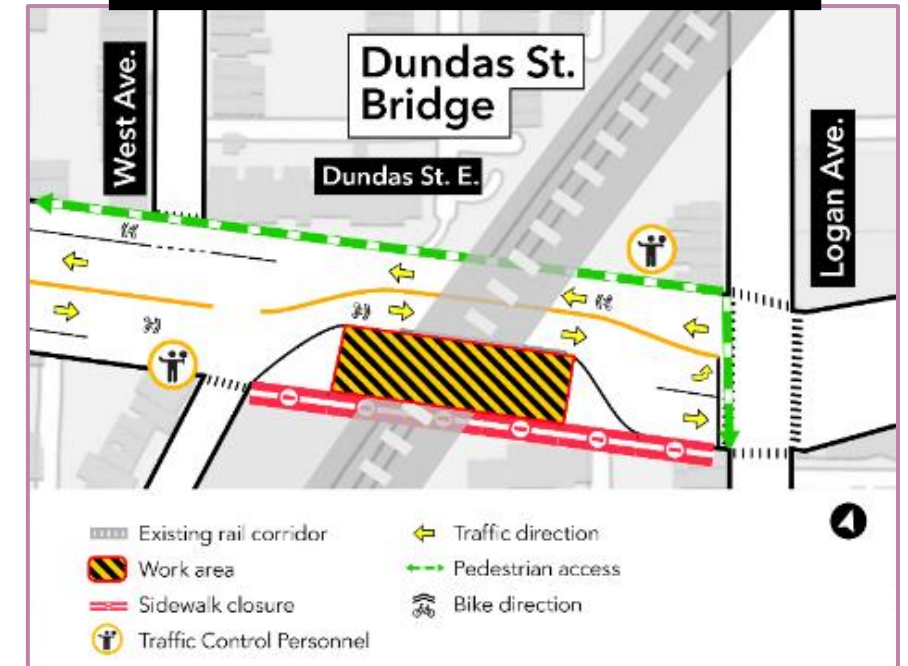

Stage two: Early March - Spring 2024

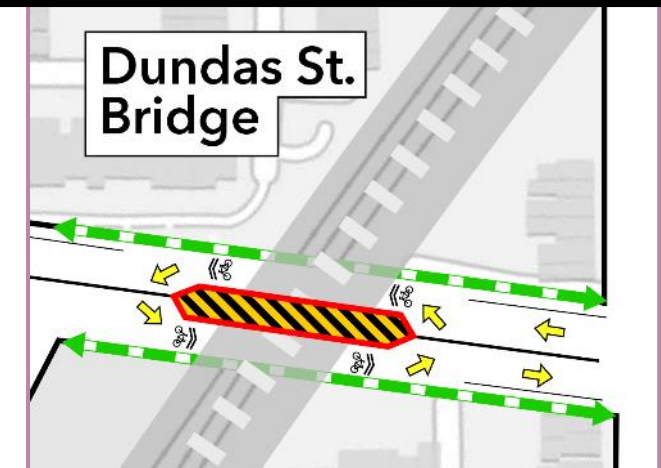

Dundas Street East Road Closure for Abutment Demolition

Dundas St. E. Road Closure (weekend, daytime and overnight)

- Dundas St. E. will be closed between Broadview Ave. and Logan Ave. to demolish a section of the bridge abutments

Hours of work:

- Starting on Friday, March 1 at 9 p.m. until Monday, March 4, 2024, at 5 a.m.
- **No overnight breaking:** Concrete breaking will be restricted during the overnight period (11 p.m. - 7 a.m.)

What to expect:

- **Road closures:** Full closure of Dundas St E between Broadview and Logan Aves. No traffic or pedestrian access will be permitted beneath the Dundas St E bridge.
- Construction activities will include concrete breaking, saw cutting, loading and hauling.
- Noise from construction equipment including saws, excavators, jack hammers, loaders, and dump trucks.
- Paid Duty Officers and traffic control personnel will be present to assist vehicles and pedestrians.
- Traffic barrels, fencing, signage and barriers will be in place to delineate the work zones. Advance signage will be in place to direct traffic and pedestrians.

Upcoming road closures on Dundas St. E. are tentatively scheduled for additional weekends in March to demolish the remaining sections of the bridge abutment. Metrolinx will notify the community once dates for the road closures are confirmed.

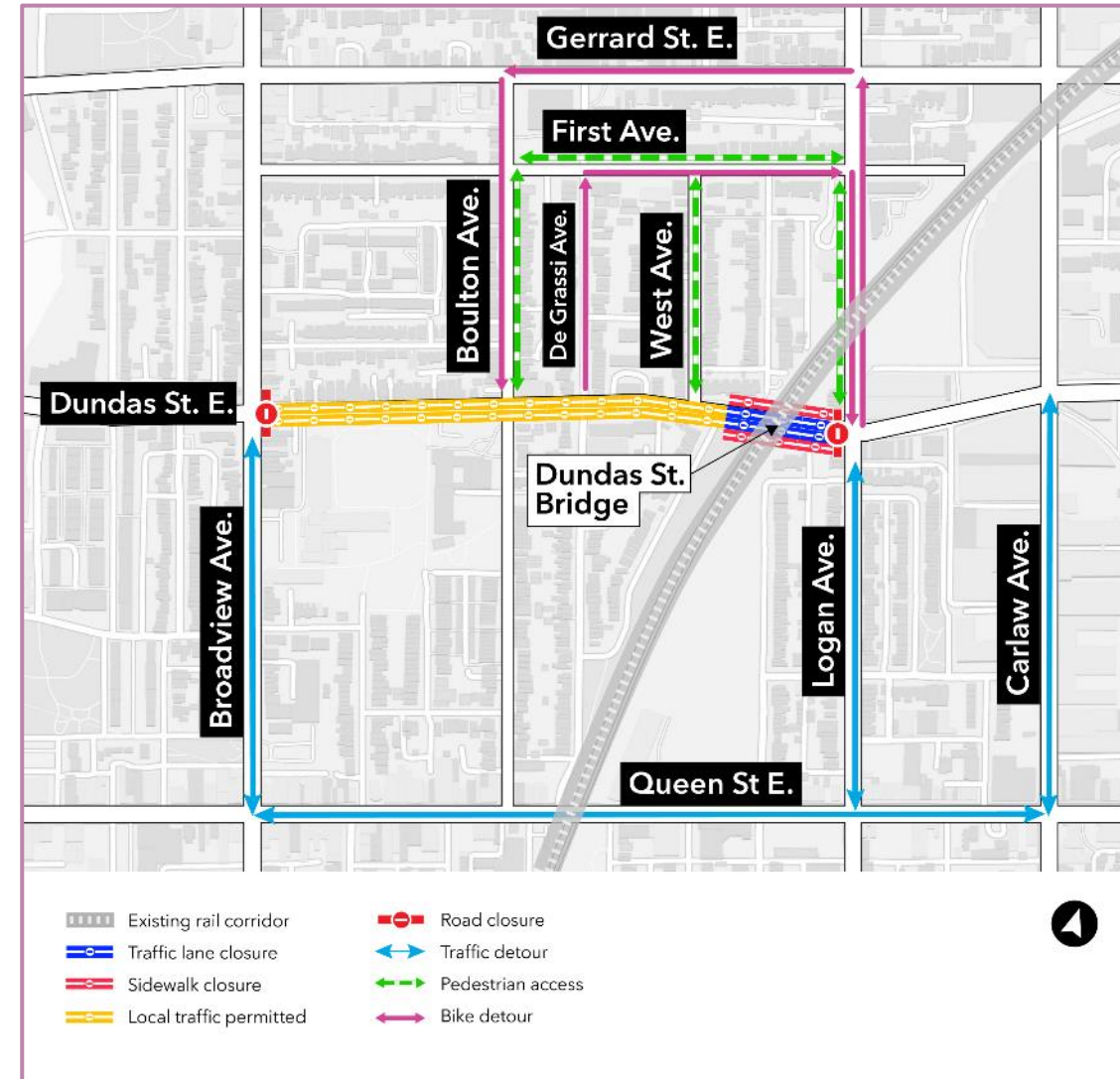

Construction Mitigations: Dundas St. E. Road Closure

- **No overnight breaking:** Concrete breaking will be restricted during the overnight period (11 p.m. – 7 a.m.)
- **Noise barriers:** Noise barriers will be installed between the work site and the residences adjacent to the work.
- **Equipment controls:** Machinery will be equipped with broadband vehicle back-up alarms and baffles to reduce noise from moving equipment and engines.
- **Noise monitoring:** Locating noise monitors closer to residences.
- **Worker parking:** Mandatory worker parking at 10 Dickens St. No worker parking in the neighbourhood.
- **Good neighbour practices:** Reinforcing good neighbour behaviours with the workers before each shift.
- **24-hour hotline:** A 24/7 hotline (416-202-5100) is in place to address noise complaints and other issues.



Logan Avenue Bridge

Sewer Installation on Logan Avenue

- Crews are installing a new sewer beneath the Logan Ave. bridge.
- To minimize traffic impacts, this work will be done in multiple stages.

Hours of work:

- Ongoing until late February 2024
- Partial abutment demolition will begin late February 2024, for approximately two weeks.
- Monday - Friday, between 7 a.m. - 7 p.m.

What to expect:

- The bike lanes on the east and west sides of Logan Ave. will be closed during this work.
- Alternating sidewalk closures on the east and west sides of Logan Ave. under the rail bridge. One sidewalk will remain open at all times. Pedestrians will be directed to use the existing crosswalks at Dundas St. E. and First Ave.
- Traffic lanes will shift to the east and west sides of the street as work progresses from one end of the bridge to the other.
- Noise from construction equipment including hydro-vacuum trucks, excavators, loaders, rollers, generators, pumps, saw-cutters and delivery trucks will be used to complete this work.

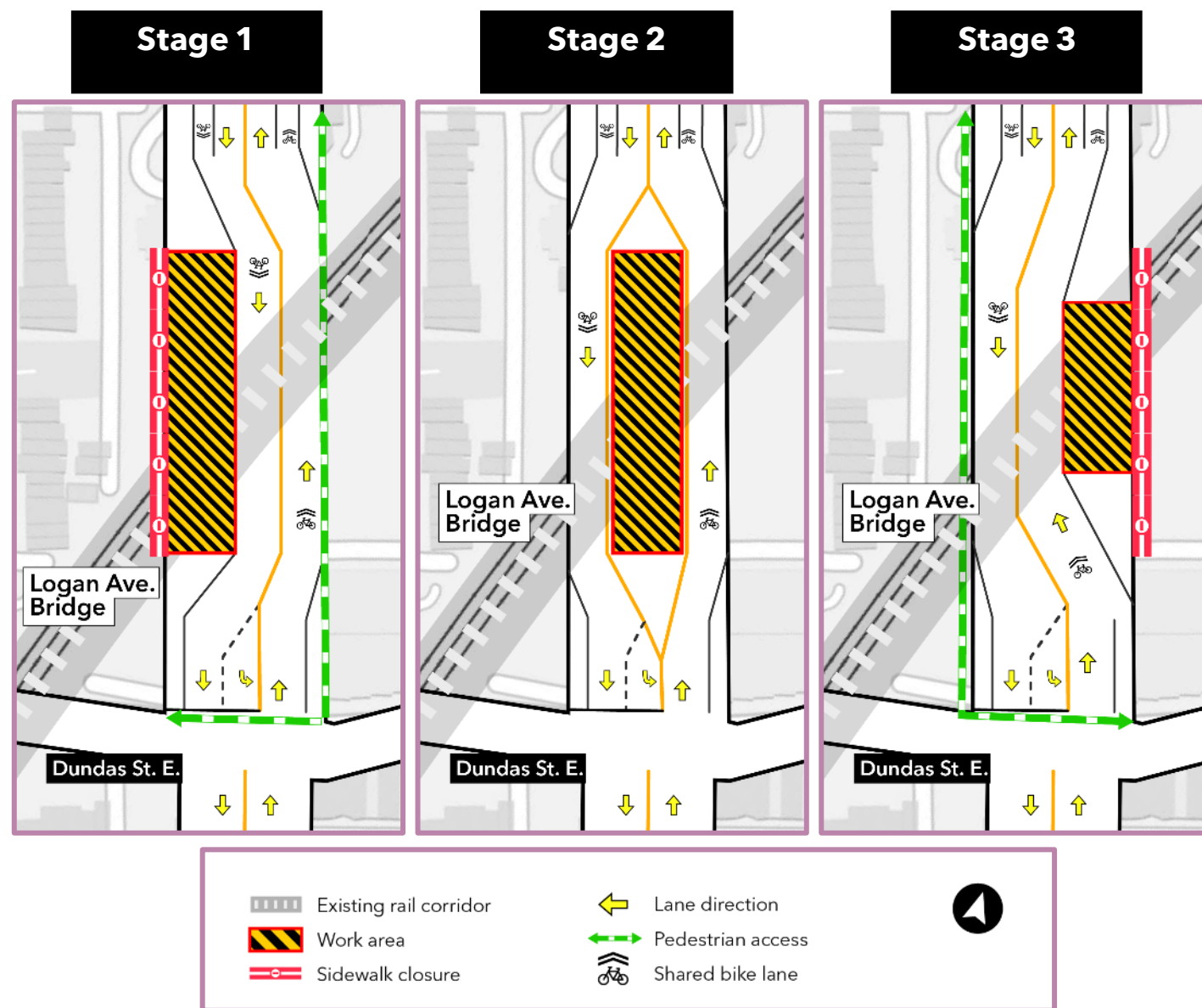

Abutment Demolition and Pier Construction

- The east side of Logan Ave will remain closed after sewer installation to allow for abutment demolition. This is required to prepare for the pier construction.
- Afterwards, a work zone will be installed in the center of the road to build the new piers for the bridge.
- Construction activities will include excavation, drilling, and concrete works.

Hours of work:

- Starting early March 2024 for approximately three months
- Abutment demolition will last for two weeks.
- Monday to Friday, between 7 a.m. - 7 p.m.

What to expect:

- Noise from construction equipment including excavators, trucks, drills, generators, saw-cutters and concrete trucks can be expected.
- Traffic lane reductions and alternating sidewalk closures on Logan Ave.
- Removal of street parking adjacent to the Logan Ave. bridge.

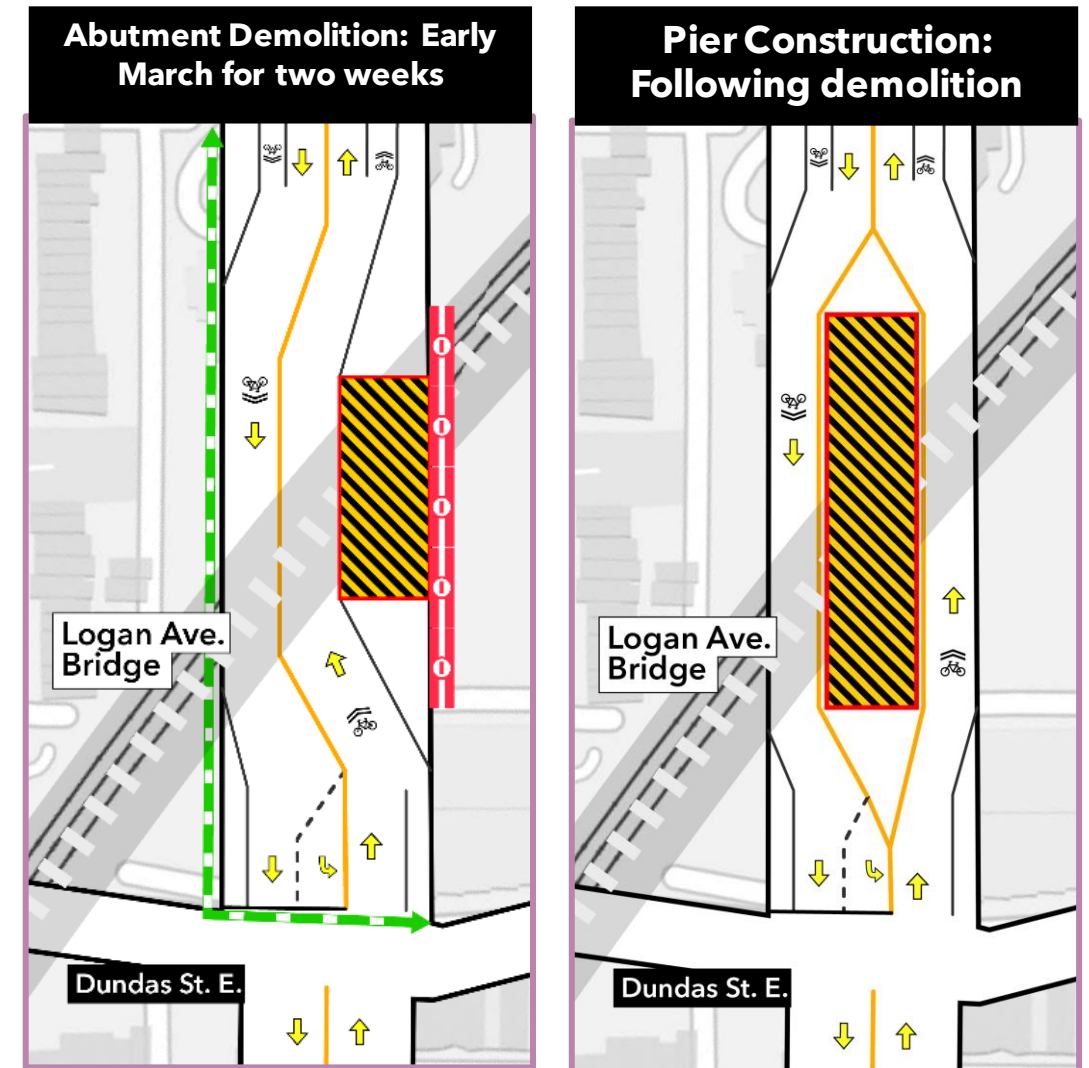

Existing rail corridor	Lane direction
Work area	Pedestrian access
Sidewalk closure	Shared bike lane



In-Corridor Work Update

Activity	Description	Location	Date and times
<p>Retaining Wall and Fence Removals</p>	<p>Removal of existing chain link fences and concrete retaining walls along the east side of the rail corridor.</p> <p>The pathway at Galt Laneway to Gerrard Square will be closed to accommodate this work.</p>	<ul style="list-style-type: none"> • Work completed between Queen St. E. and Logan Ave. • Removals between Gerrard St. E. and Jones Ave. upcoming 	<ul style="list-style-type: none"> • Gerrard St. E. - Jones Ave starting Thursday, February 15, 2024, for approximately two months • Weekdays from 7 a.m. to 7 p.m. • Pathway will be closed as early as Thursday, February 15, 2024, for approximately six months
<p>Excavation and Structural Support Work</p>	<p>Support structures (piles and shoring walls) are being installed throughout the corridor to enable bridge reconstruction and retaining wall and noise barrier installations. Construction activities include excavation, drilling and concrete works.</p>	<ul style="list-style-type: none"> • Throughout the rail corridor between Eastern Ave. - Carlaw Ave. • At Queen St. E., Dundas St. E. and Logan Ave. bridge 	<ul style="list-style-type: none"> • Ongoing until Spring 2024 • Daytime: Monday - Friday from 7 a.m. to 7 p.m. • Overnight: Sunday - Thursday from 8 p.m. to 5 a.m.
<p>Utility Installations</p>	<p>Excavation inside the rail corridor to install an enclosed conduit (raceway) that will protect utilities from external conditions.</p>	<ul style="list-style-type: none"> • Within the rail corridor between Thackeray St. and Jones Ave. 	<ul style="list-style-type: none"> • Starting Tuesday, February 20, 2024, for approximately five weeks • Overnight: Monday - Friday from 8 p.m. to 5 a.m.
<p>Retaining Wall (T-Wall) Construction</p>	<p>Installation of pre-cast concrete block retaining walls from Eastern Ave. to Dundas St. E.</p>	<ul style="list-style-type: none"> • On the east side of the rail corridor from Eastern Ave. - Thackeray St. 	<ul style="list-style-type: none"> • Starting as early as March 2024 for approximately six months.

Retaining Wall and Fence Removals: Gerrard St. E. - Jones Ave.

Starting Thursday, February 15, 2024, for approx. six (6) months

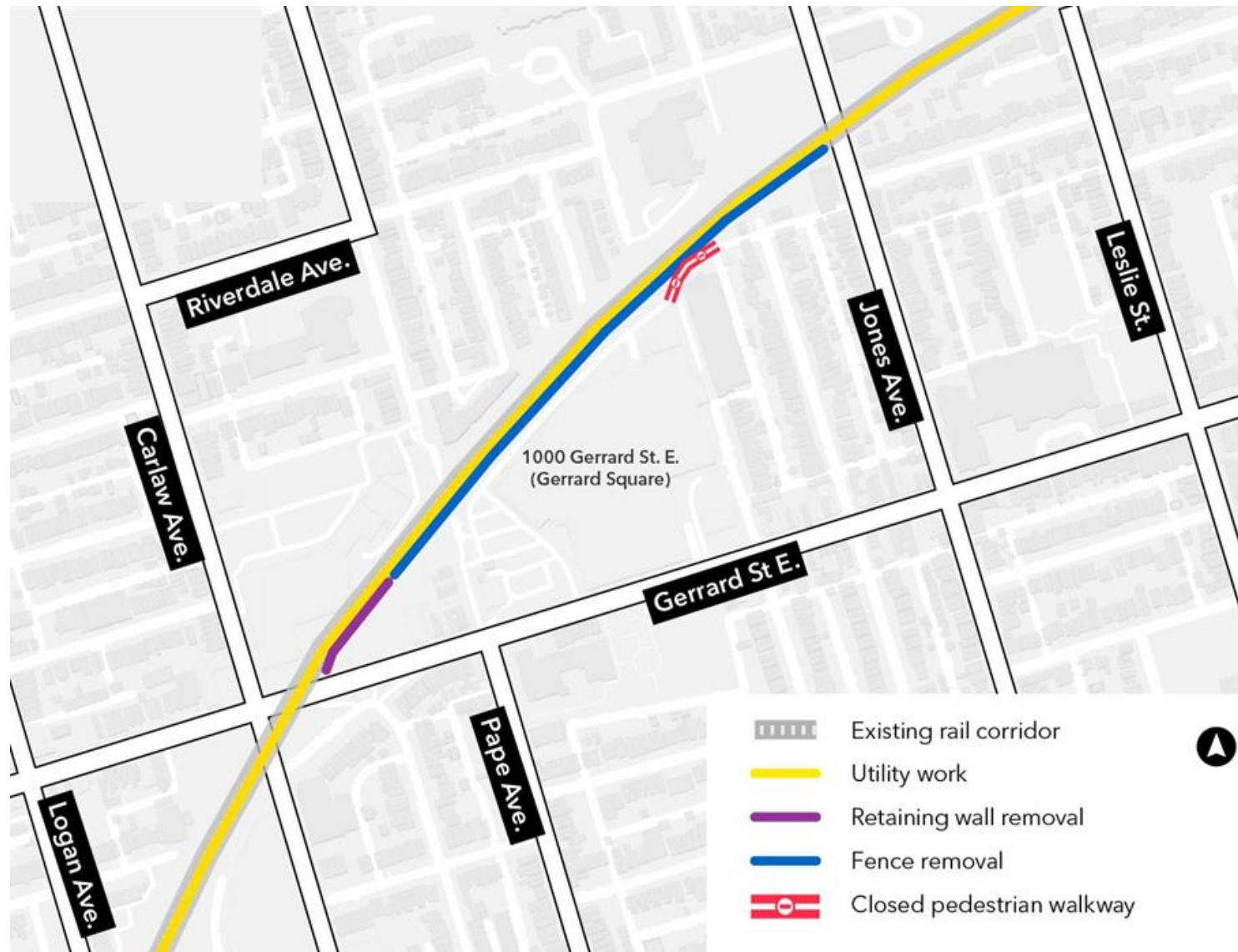

Retaining Wall Construction Update

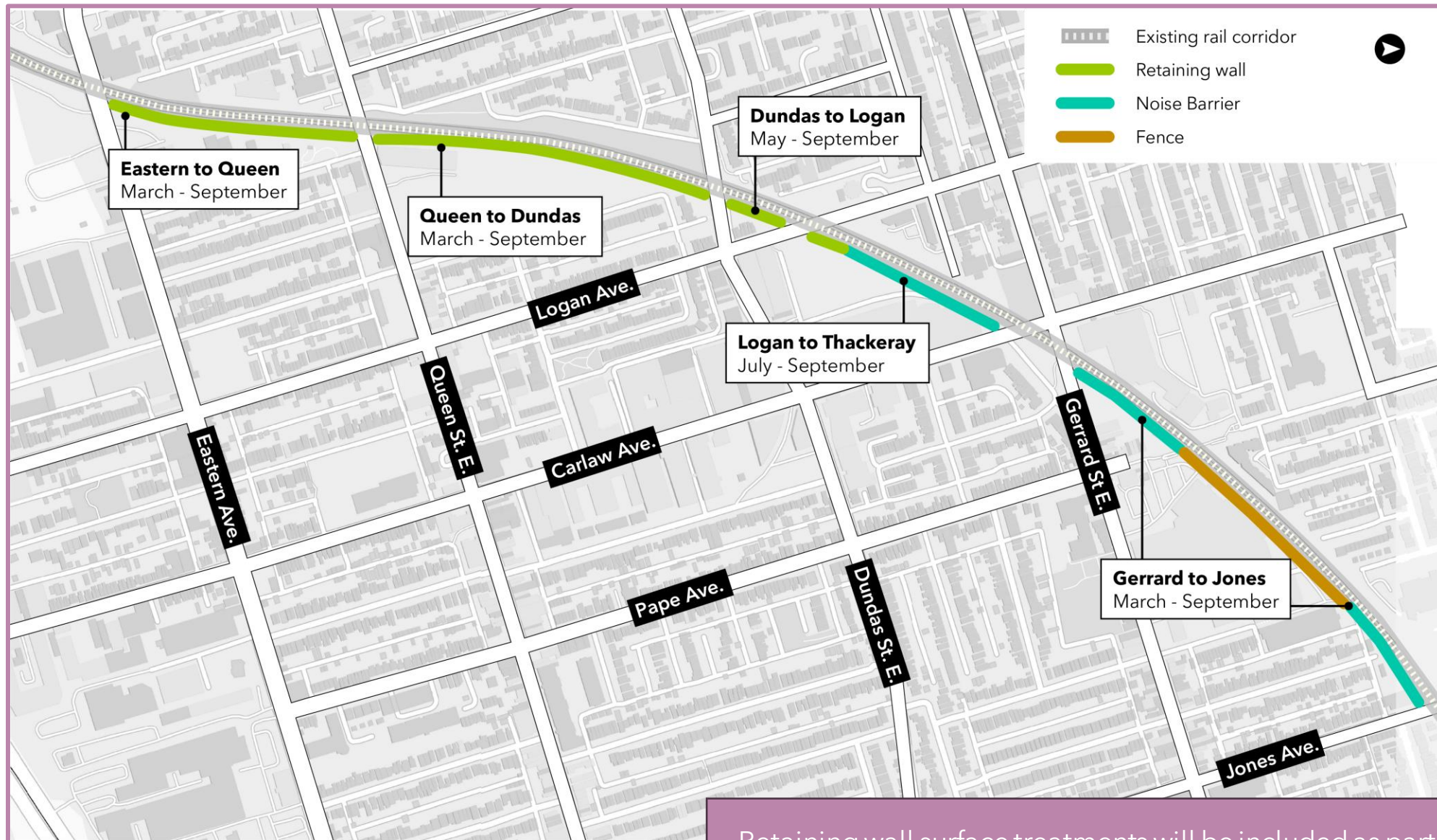

Retaining wall surface treatments will be included as part of this scope.



**Eastern Avenue Bridge
East Harbour Transit Hub**

EAST HARBOUR TRANSIT HUB

EARLY WORKS AND EASTERN AVENUE BRIDGE WORK

- Advanced preparations continue in anticipation of the start of construction in mid-2024*.
- Early Works may include such things as: establishing the work zone, moving equipment, supplies, and other resources, geo-technical investigations, utility daylighting, and track work.
- Early works are an important component of any construction project. These activities set the groundwork for major construction and reduce the risk of delays to the project.
- With the ongoing demolition and reconstruction of the Eastern Avenue Bridge, a series of lane closures on Eastern Avenue, will be in effect starting mid-October 2023 until October 2026*, to create a safe working zone for the crews and vehicle traffic.

•Dates are subject to change

EAST HARBOUR TRANSIT HUB

UPCOMING CONSTRUCTION ACTIVITIES

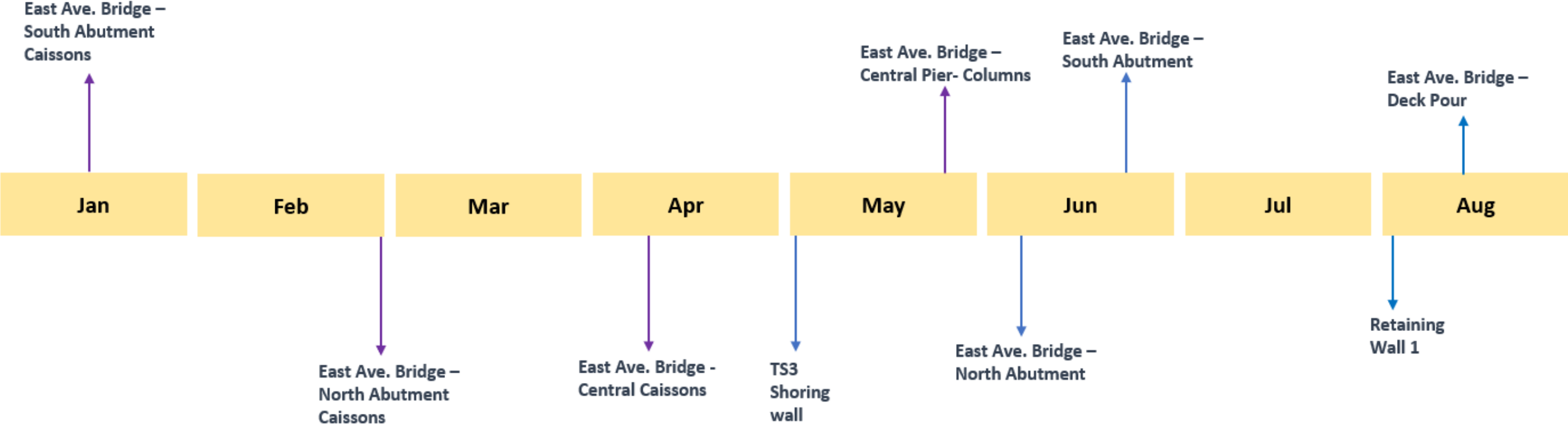

- Dates are subject to change

What's Next and Wrap Up

Upcoming Community Engagement Events

Dufferin Construction and Metrolinx will be holding a public open house to share construction updates, completed milestones, and what to expect in 2024!

- **Date:** Thursday, February 29, 2024
- **Time:** 5:00 p.m.-7:00 p.m.
- **Location:** Multipurpose room at Jimmie Simpson Recreation Center

Ontario Line

Riverside-Leslieville Community Open House

Metrolinx and Dufferin Construction are hosting a community open house on February 29 at the Jimmie Simpson Recreation Centre.

Drop by to learn more about the Ontario Line and construction activities taking place in your community.

 METROLINX

**** Next CLC will be held on March 21, 2024****

Contact Us

Metrolinx will keep the community, residents and businesses informed by providing project updates, seeking input and feedback, and addressing questions and concerns effectively and quickly.

Stay connected:

Ontario Line e-newsletter @ [Metrolinx.com/OntarioLine](https://www.metrolinx.com/OntarioLine)

Questions or comments:

OntarioLine@metrolinx.com

24/7 call # 416-202-5100

Follow us on social media:

Twitter / Facebook / Instagram @ OntarioLine



Ontario Line Community Office 770 Queen Street East

Questions and Answers



Appendix

CLC Code of Conduct



Participate fully, openly, and transparently in discussions, while also creating an environment where all members are encouraged to contribute and share their views.



Participate in a respectful manner towards other CLC members by using appropriate language.



Keep requested agenda and discussion items within the **mandate and scope** of the **Construction Liaison Committee**.

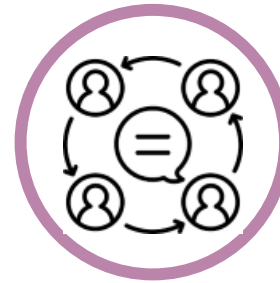

Represent their community's diverse perspectives and interests.



Maintain confidentiality of sensitive issues, when requested by participants.



Commit to equity, diversity and inclusion by supporting the participation of the whole community regardless of race, gender, class, sexuality, age or ability.

Summary of Lakeshore East Joint Corridor Early Works

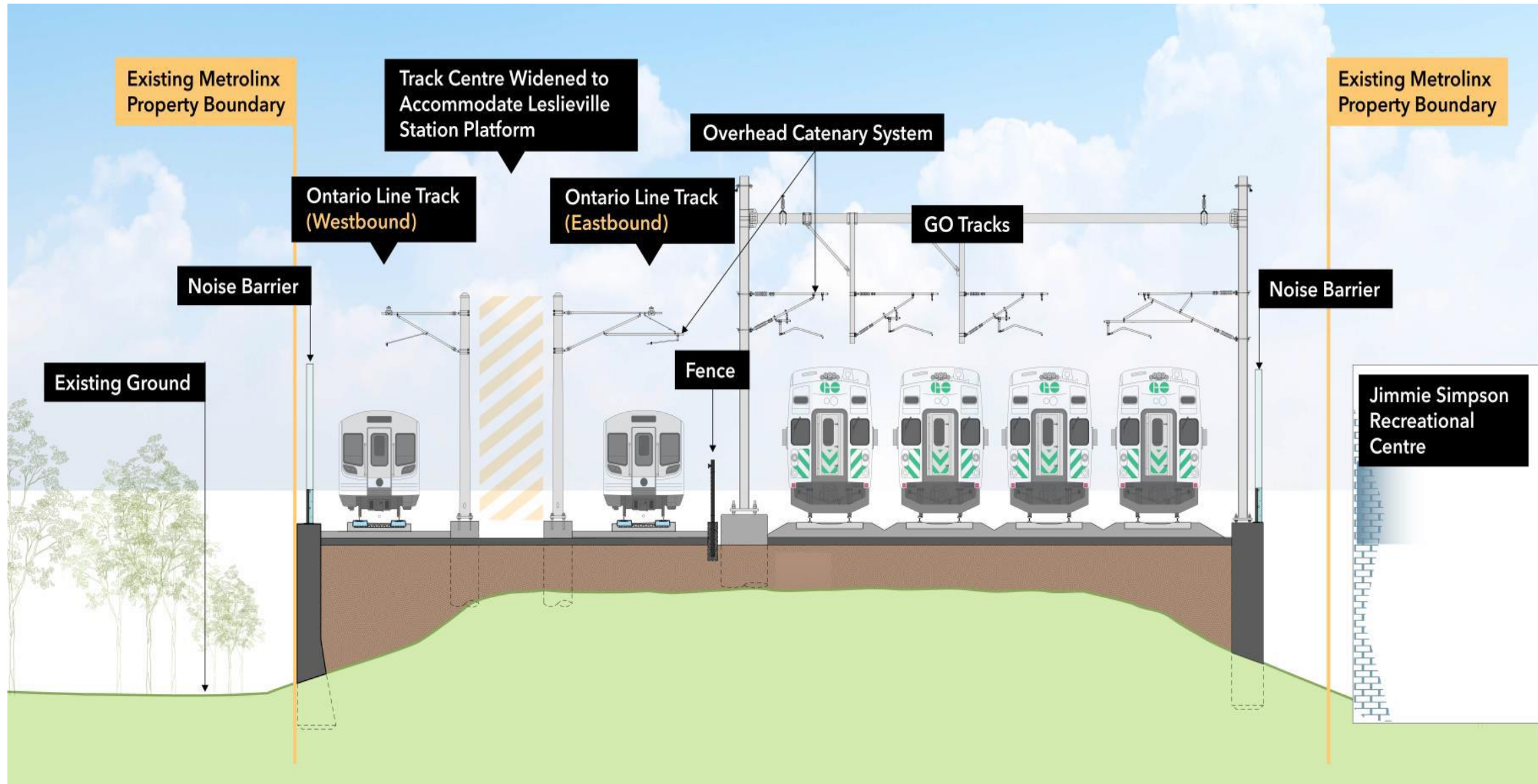

Construction Liaison Committees (CLC)

Construction Liaison Committees (CLCs) provide open, two-way communication and sharing of information before and during the construction of the Ontario Line project. The CLC will focus on the impacts, issues and areas of concern for resolution related to the Ontario Line construction within the Leslieville/Riverside neighbourhoods. The full Terms of Reference will be shared with the CLC via email.

- The CLC will meet regularly as construction activities get underway
- CLC frequency is flexible, depending on schedules/availability and critical construction work
- Metrolinx will work with stakeholders to develop meeting agendas
- Meetings will last 60-90 minutes, depending on the agenda
- Metrolinx to chair the CLC with support from the project contractor
- Project contractor will participate and lead the construction updates
- Action items/issues/complaints to be logged for resolution

Construction Liaison Committee (CLC)

Community representatives



- Elected officials
- Community groups/residents
- Residents' groups/associations
- Tenant representatives
- BIAs
- Business owners

City of Toronto



Project team members



- Metrolinx—representatives from Subways Sponsors Office, Design Division, Community Engagement, Project Teams and Contractor/Project Co.

Who Does What?



A division of CRH Canada Group Inc.

Responsible for construction delivery, establishing the construction schedule, determining construction plans and the care and control of construction sites.



Contribute subject matter expertise regarding City polices, requirements, permits and procedures.

Ensure key City and community interests are noted and addressed through application design reviews and permits.

Work with partners to minimize negative impacts on residents and the environment.

Monitor construction sites for safety and adherence to City standards and bylaws.



Overarching accountability for entire project, strategy and content approvals, building relationships and understanding needs of the community.

Oversight of construction contractors to ensure compliance with contractual obligations, including work schedules, adherence to acceptable noise levels, traffic management plans and permit conditions.

Construction Liaison Committee Members



Community Members

- Riverside BIA
- Leslieville BIA
- WoodGreen Community Services
- Lakeshore East Community Advisory Committee
 - Shelley Kline
 - Tony Whitaker
- Rosemary Waterston (resident)
- Catherine Riddell (resident)
- Stephen Davies (resident)
- Fontbonne Ministries
- Saulter Street Brewery
- Bonjour Brioche Bakery
- Tabule Restaurant
- Jimmie Simpson Recreation Centre (City of Toronto)

Elected Officials (or designate)

- MP Julie Dabrusin
- MPP Peter Tabuns
- Councillor Paula Fletcher



- Transit Expansion Division
- Parks, Forestry and Recreation
- Transportation Services



- Ontario Line Community Engagement
 - Mark Clancy
 - Katiana Moussa
 - Louis Vattr
- Dufferin Construction
- Project Sponsor
- Capital Projects Group
- Traffic and Transportation
- Other project teams as required

Impact Levels

Major Impact



Includes:

- Major intersection work
- Overnight work
- Transit impacts
- Road closures
- Public parking displacement

Medium Impact



Includes:

- Paving
- Long term traffic lane closures
- Work affecting access to private driveways

Minor Impact



Includes:

- Short-term traffic lane closures
- Temporary pedestrian detours

Summary of Lakeshore East Joint Corridor Early Works



Lakeshore East Joint Corridor Early Works Scope of Work Summary



Future station



Utility relocations along Queen Street, Dundas Street, Logan Avenue and the surrounding side streets.



Upgrade to the rail corridor, including excavation of the existing embankment, installation of new drainage infrastructure, installation of pre-cast concrete retaining walls and backfill of the corridor.



Removal of existing and construction of new GO Bridges at Queen Street East, Dundas Street East and Logan Avenue. Construction of two new Ontario Line bridges at Dundas and Logan.



Realignment of the existing GO tracks, construction of a fourth GO track, and preparation works for eastbound and westbound Ontario Line tracks.



Construction of noise barrier walls to mitigate the impact of the railway on adjacent properties.



Construction of retaining walls for construction of the future Ontario Line stations: Riverdale-Leslieville station and Gerrard station.

Overview | Bridges Redevelopment

