

# Monitoring device installations: Queen Street West (daytime)

**Expected start date:** As early as February 22, 2024

**Duration:** Up to two (2) months

**Hours of work:** Weekdays (Monday to Friday), from 7:00 a.m. to 7:00 p.m.

## Map of work area:

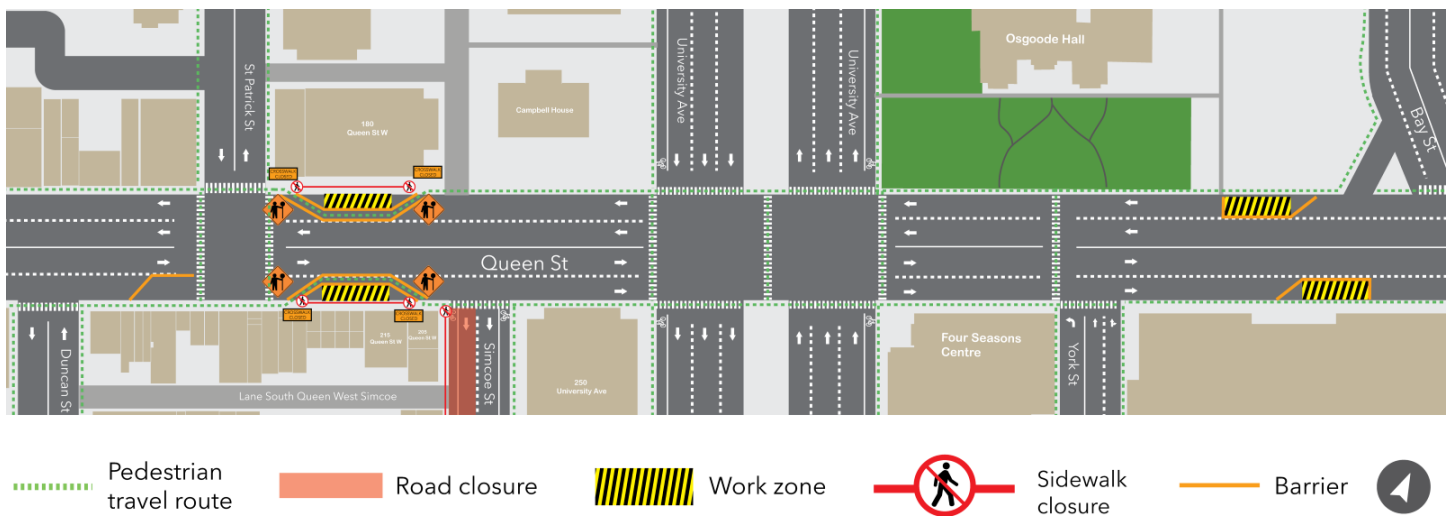

## What is happening?

- Crews are conducting investigative utility works and drilling (in the area shown in yellow on the map above) on Queen Street.
- Work crews will install and perform maintenance on an underground monitoring device.
- For investigative works, drilling is necessary to test and visualize the utilities and ground conditions under the street for future construction of the Ontario Line subway tunnels at Osgoode Station.

## What to expect

- The work is scheduled to be extended until the end of April 2024.
- Work will take place during the day on weekdays, between 7:00 a.m. to 7:00 p.m. Crews are expected to be onsite prior to 7:00 a.m. to set up equipment.
- Community members can expect to hear noise from work equipment, specifically hydrovac trucks and saw cutting tools, as required.
- Crews will take measures to minimize noise impacts wherever possible.
- Closure for work is temporary and intermittent: area will only be closed while crews are surveying the specific area. The area will be returned to public use upon completion of the monitoring device installation.

## Queen Street West intermittent partial closure (as noted in the map above):

- Work will be intermittent, moving between work zones as required.
- The westbound curb lane and eastbound curb lane on Queen Street West will be closed during active work in each area.
- The pedestrian walkway and workzone will be protected by barriers to ensure safety access for pedestrians along the work area.
- Flag-persons will be present to guide traffic at each side of the work zone area.
- Signage will be posted advising of the lane road and sidewalk restrictions.

**Note:** Access may resume prior to 7:00 p.m. if works are completed ahead of schedule.

- After each work shift, each area will be securely covered and marked for safety until workers return or the work is complete.
- The areas will be returned to public use upon completion of the monitoring device installation.
- All the necessary construction permits have been obtained.
- Work may be postponed or rescheduled due to unforeseen circumstances.
- For more information about upcoming station work please see [metrolinx.com/Ontarioline](https://metrolinx.com/Ontarioline) or sign up for the e-newsletter.

---

## About the Ontario Line

- 15.6-kilometre subway line that will make it faster and easier to travel within Toronto and beyond.
- 15 stops and more than 40 connections to other transit, including GO train, subway, LRT, streetcar and bus lines.
- Less than 30 minutes from one end of the line to the other.
- 28,000 fewer car trips each day.

### Contact us:

Call us 24/7 at: [416-202-5100](tel:416-202-5100)

Write to us at: [ontarioline@metrolinx.com](mailto:ontarioline@metrolinx.com)

Find us on X, Facebook, and Instagram: [@ontarioline](https://www.instagram.com/ontarioline)

Visit the website: [www.metrolinx.com/ontarioline](https://www.metrolinx.com/ontarioline)

### Visit our community office:

770 Queen Street East (near Queen & Broadview)

General hours:

- Mondays, Tuesdays, and Fridays: 9:00 a.m. to 5:00 p.m.
- Wednesdays and Thursdays: 10:00 a.m. to 6:00 p.m.

Disponible en français sur demande. Si vous êtes intéressé, veuillez envoyer un courriel à [ontarioline@metrolinx.com](mailto:ontarioline@metrolinx.com).