

Leaside-Laird CLC

Eglinton Crosstown LRT

November 13, 2023

LAND ACKNOWLEDGEMENT

Let us take a moment to acknowledge we are on lands that have been, and continue to be, home to many Indigenous Peoples including the Anishnabeg, the Haudenosaunee and the Huron-Wendat peoples.

We are all Treaty people. Many of us have come here as settlers, as immigrants or involuntarily as part of the trans-Atlantic slave trade, in this generation, or generations past.

We acknowledge the historic and continued impacts of colonization and the need to work towards meaningful reconciliation with the original caretakers of this land.

We acknowledge that Metrolinx operates on territories and lands covered by many treaties that affirm and value the rights of Indigenous communities, Nations and Peoples.

We understand the importance of working towards reconciliation with the original caretakers of this land. At Metrolinx, we will conduct business in a manner that is built on a foundation of trust, respect and collaboration.

Leaside Station

LEASIDE STATION UPDATE

Activity	Location	Approx. Date & Duration
Station Box, Main and Secondary Entrances Architectural, mechanical, and electrical deficiency work and station cleaning.	Beneath Eglinton Avenue East, on the northwest and southeast corner of Bayview Ave and Eglinton Avenue East	Ongoing through fall 2023
Station Testing and Inspections	Throughout the Station	Ongoing through 2023
Train Testing and Commissioning	Throughout the Station	Ongoing through 2023

CURRENT TRAFFIC CONFIGURATION

Expected through 2023

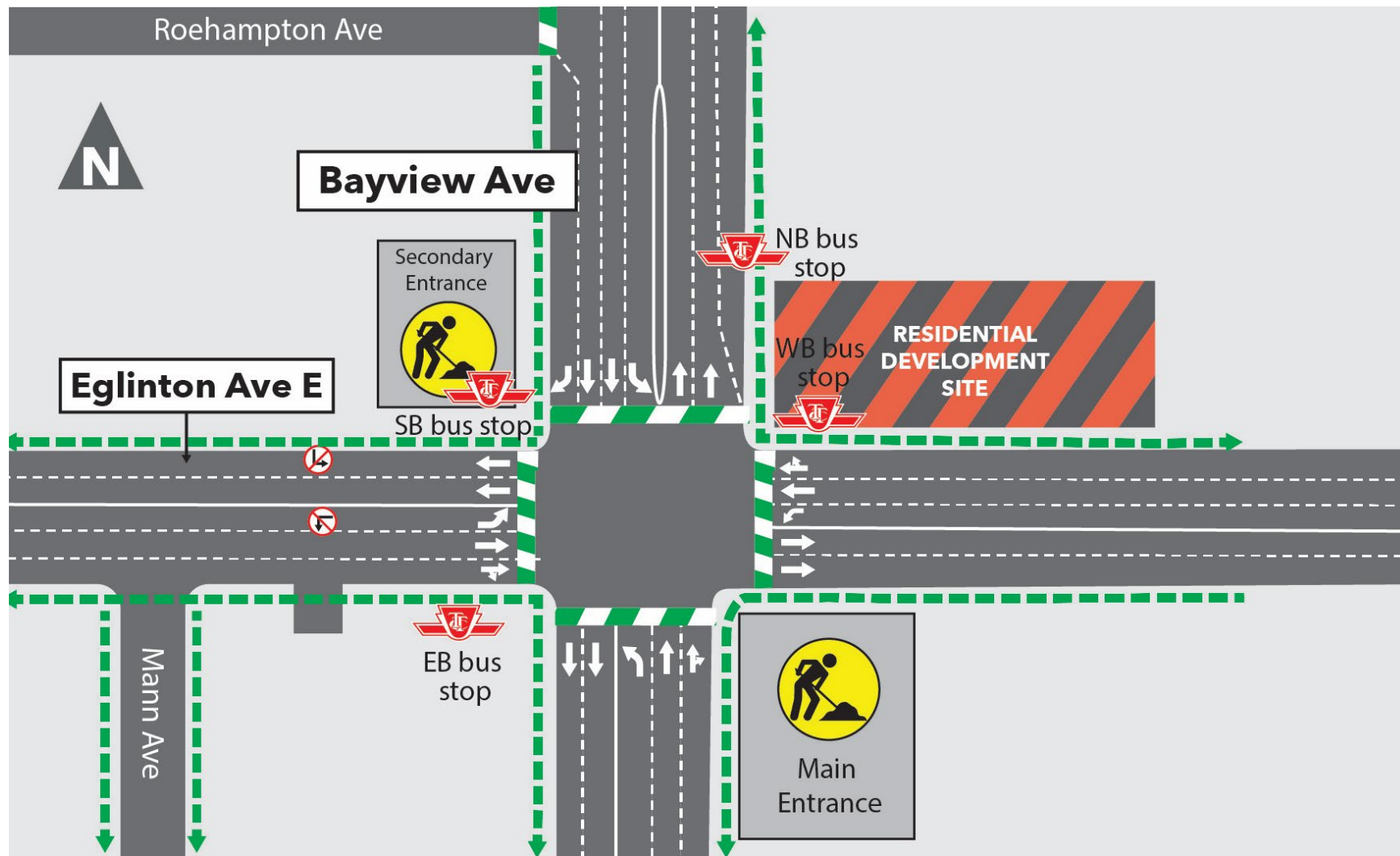

CONSTRUCTION PROGRESS PHOTOS



FIRE STOPPING ONGOING



PRESTO VENDING MACHINE
INSTALLATION - COMPLETED

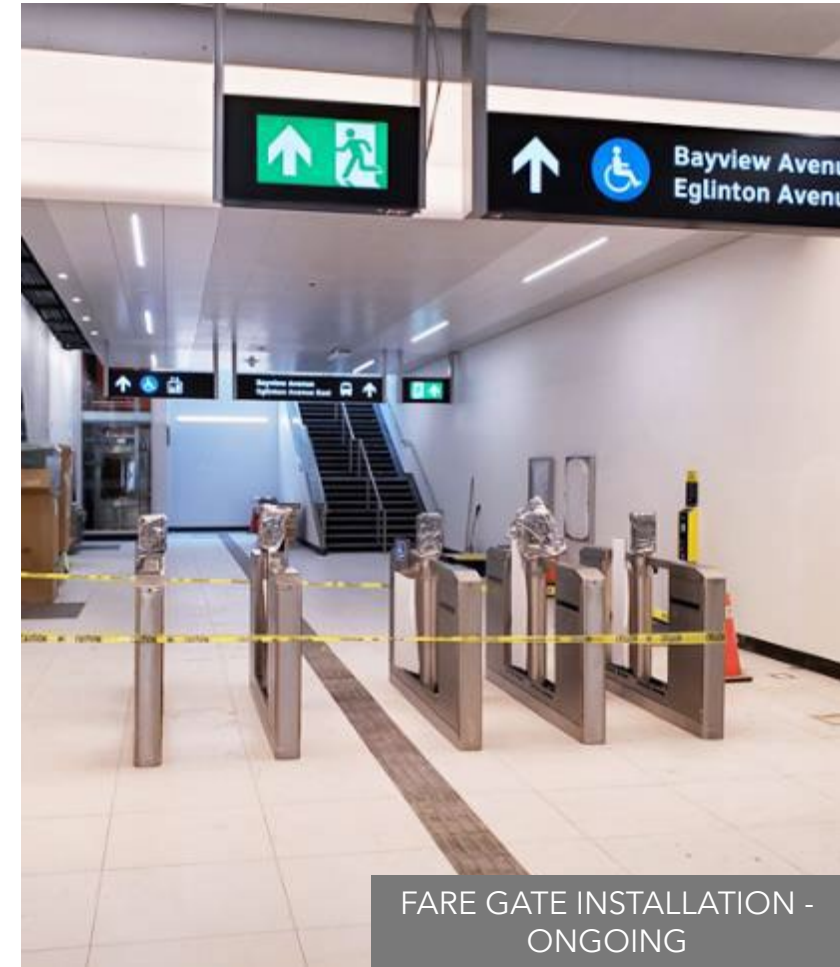

FARE GATE INSTALLATION -
ONGOING

CONSTRUCTION PROGRESS PHOTOS

HARDSCAPE COMPLETED



DEFICIENCY ADDRESSED



PAVER INSTALLATION COMPLETED

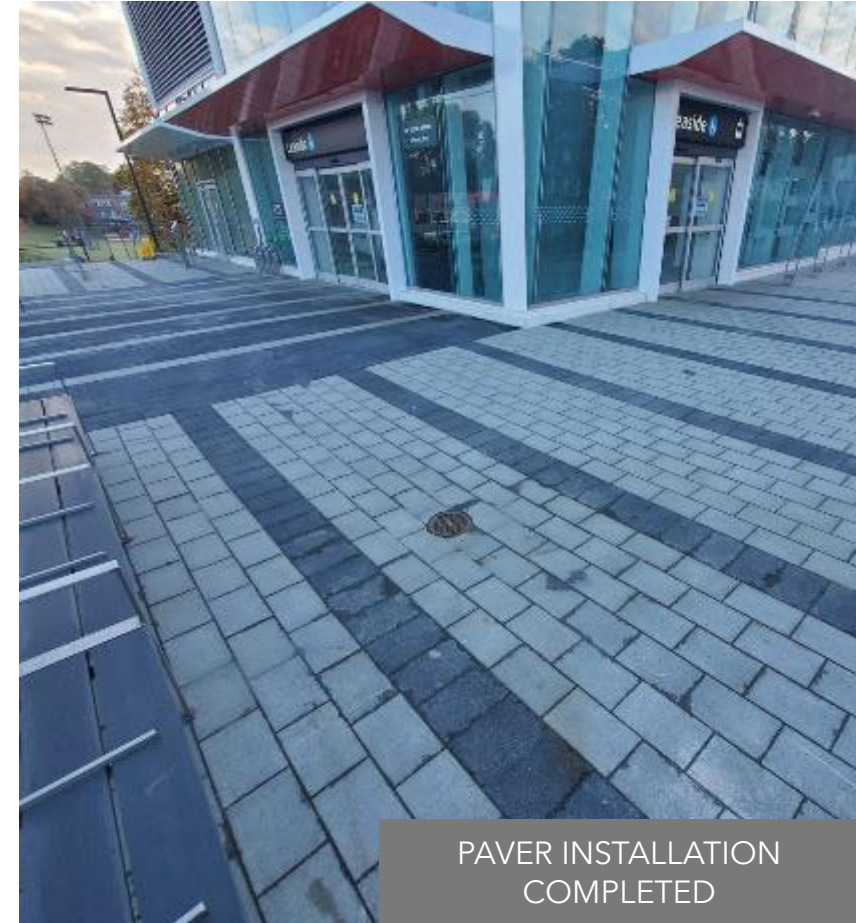

Laird Station

LAIRD STATION UPDATE

Activity	Location	Approx. Date & Duration
Station Box, Main and Secondary Entrances Architectural, mechanical, and electrical deficiency work and station cleaning.	Beneath Eglinton Avenue East, and on the southwest and southeast corner of Laird Drive and Eglinton Avenue East	Ongoing through fall 2023
Station Testing and Inspections	Throughout the Station	Ongoing through 2023
Train Testing and Commissioning	Throughout the Station	Ongoing through 2023

TRAFFIC CONFIGURATION AT LAIRD STATION

Expected through 2023



- Periodic short-term lane closures will be required during this traffic stage to facilitate specific activities
- Fencing will remain in place around the Station Entrances for security purposes

CONSTRUCTION PROGRESS PHOTOS



ROAD RESTORATION -
COMPLETED

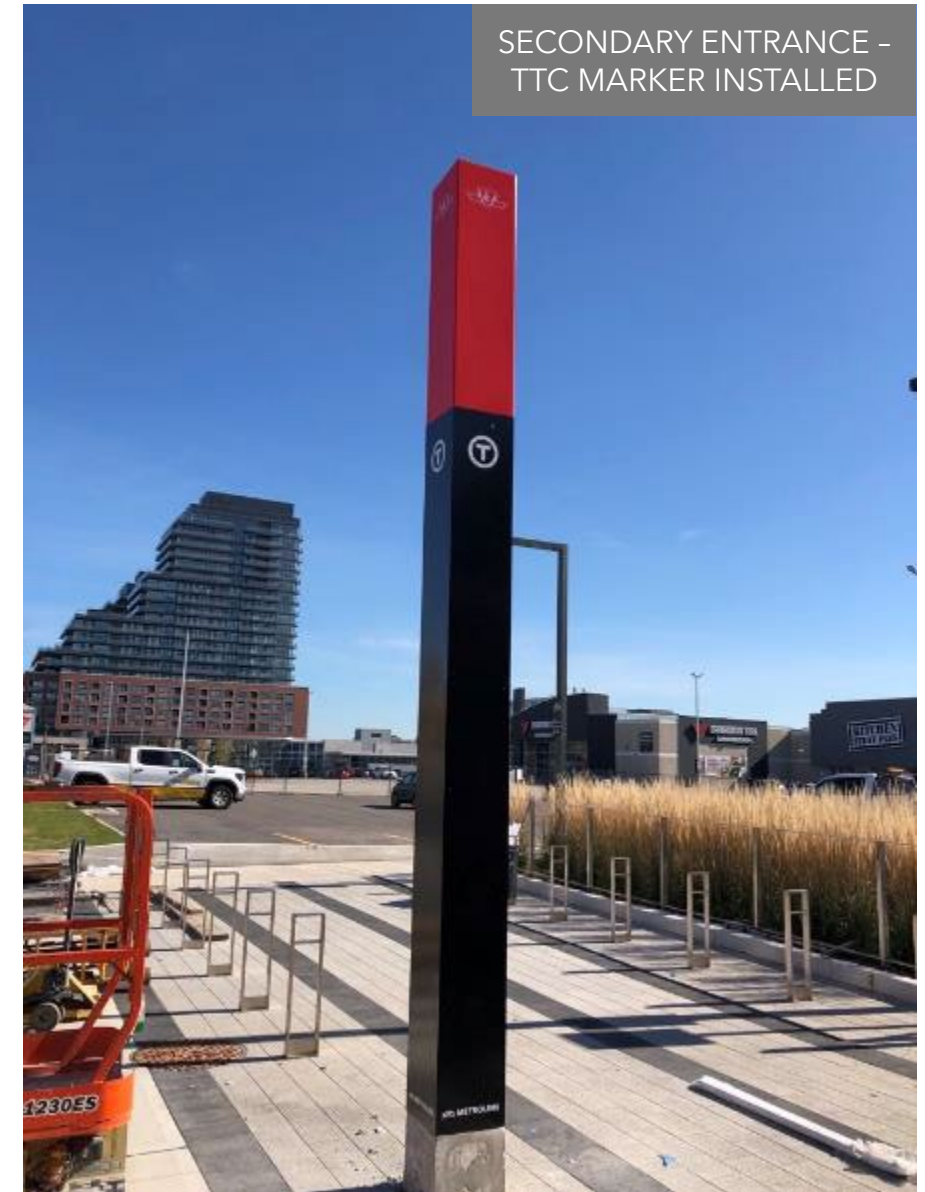

SECONDARY ENTRANCE -
TTC MARKER INSTALLED

CONSTRUCTION PROGRESS PHOTOS

HOUSEKEEPING AT
CONCOURSE LEVEL



TAGGING UTILITIES IN
THE BACK OF HOUSE



HOUSEKEEPING IN THE
BACK OF HOUSE



EAST OF LAIRD ONGOING WORKS

- Vehicle and systems testing - Ongoing through 2023
- Landscaping between Brentcliffe Road and Kennedy Road - Ongoing through fall 2023
- Multi-use path construction and landscaping restoration works - Ongoing through fall 2023
- Sidewalk Segment Restoration Works - Numerous locations along Eglinton Avenue East - Ongoing through fall 2023
- Architectural and electrical finished - Numerous At-Grade Stops - Ongoing through fall 2023



TTC MARKER INSTALLED



EAST PORTAL BACKFILLING



SIDEWALK RESTORATION

EAST OF LAIRD ONGOING WORKS



RETAINING WALL LOCATIONS

