

Barrier removal and reinstallation at Queen St W and Spadina Ave

Expected start date:

- South entrance: As early as the evening of Monday April 1, 2024

Expected duration: Approximately two weeks.

Hours of work:

- Weekdays, 9:00 p.m. to 5:00 a.m., Sunday April 7, 9:00 p.m. to 5:00 a.m., additional shifts will be added if required

Future South entrance: Map of work area

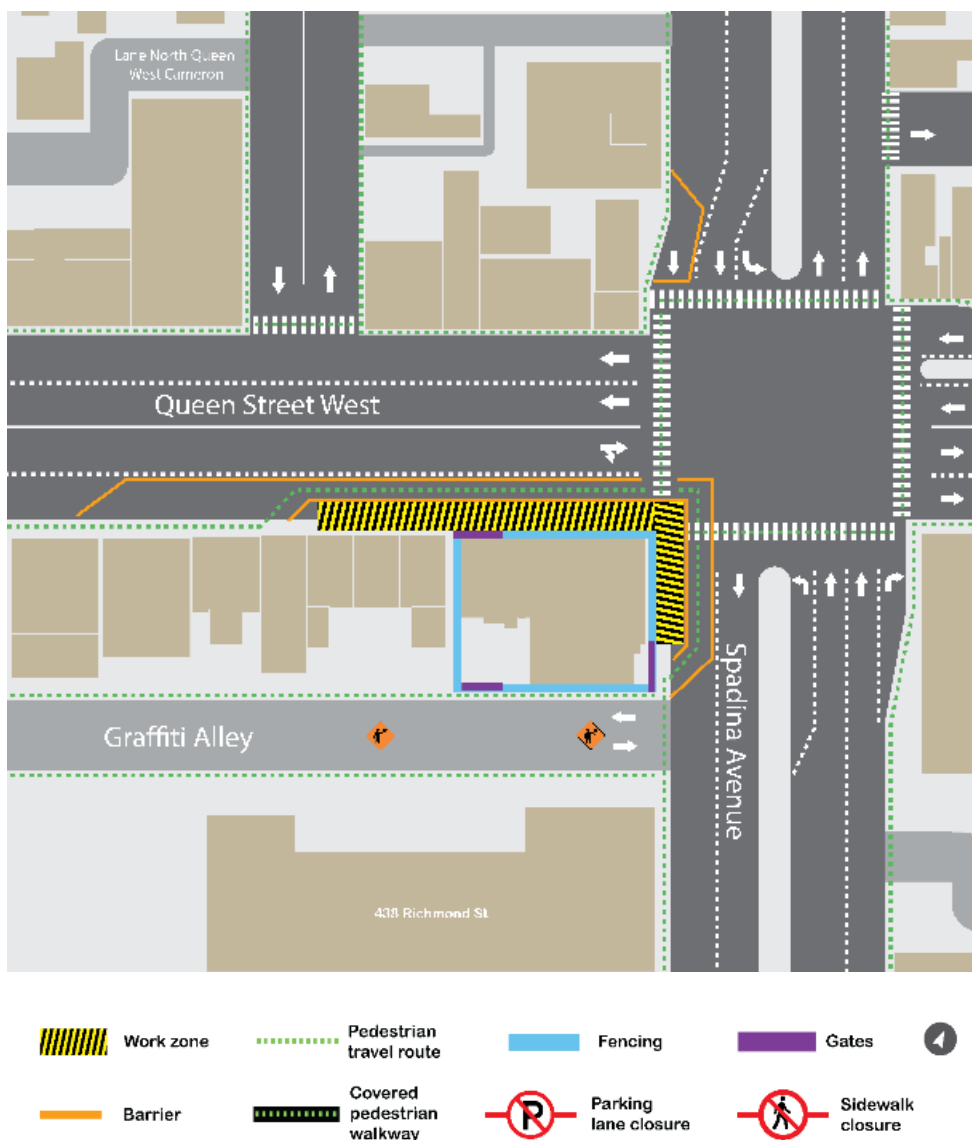

What is happening?

- To prepare for construction of the future Ontario Line subway at Queen and Spadina, construction crews will be installing plywood fencing, also known as hoarding, around the future South and future North station sites, to protect the public from the work zone.
- Existing covered pedestrian walkways on Queen Street West and Spadina Avenue will be reconfigured and replaced at both sites, in preparation for the next phase on construction.
- Plywood hoarding is a safety measure to ensure the protection of the public during construction. It also helps with the transfer of noise from the site to the neighbourhood.

What can I expect?

- At the future South station site, crews completed the installation of hoarding around the south and west areas of the site. Works will now shift to replace the north and east portions of the hoarding. Beginning at 9:00 p.m. on Sunday March 31 a crew will set up on the south side of Queen Street West to dismantle and remove existing scaffolding and replace it with the new setup.
- On Queen Street West and Spadina Avenue, lane restrictions will be in place while crews are working in the area, as highlighted in the map above.
- Beginning at 9:00 p.m. on Sunday April 7 a crew will occupy a lane on Spadina Avenue to begin to dismantle the hoarding along this street as in the map above.
- Pedestrian access through the area is expected to be maintained during all phases of work, as indicated on the map above. Upon completion, covered pedestrian walkways will reopen at both station sites on Queen Street West and Spadina Avenue.
- There are no expected impacts to transit services, and access to local residential and commercial units will be maintained.
- Community members will see trucks delivering plywood hoarding materials, and crews working to install the walls. Some noise may occur from construction equipment, including front-end loaders, trucks, and hammers.
- All the necessary construction permits have been obtained.
- Work may be postponed, rescheduled, dates changed, or hours added due to unforeseen circumstances.
- For more information about upcoming station work please see metrolinx.com/Ontarioline or sign up for the e-newsletter.

About the Ontario Line

- 15.6-kilometre subway line that will make it faster and easier to travel within Toronto and beyond.
- 15 stops and more than 40 connections to other transit, including GO train, subway, LRT, streetcar and bus lines.
- Less than 30 minutes from one end of the line to the other.
- 28,000 fewer car trips each day.

Contact us:

Call us 24/7 at: [416-202-5100](tel:416-202-5100)

Write to us at: ontarioline@metrolinx.com

Find us on X, Facebook, and Instagram: [@ontarioline](https://www.instagram.com/ontarioline)

Visit the website: www.metrolinx.com/ontarioline

Visit our community office:

770 Queen Street East (near Queen & Broadview)

45 Overlea Blvd (East York Town Centre)

General hours:

- Mondays, Tuesdays, and Fridays: 9:00 a.m. to 5:00 p.m.
- Wednesdays and Thursdays: 10:00 a.m. to 6:00 p.m.