

Ontario Line

Queen - Spadina

Construction Liaison Committee

April 2, 2024

 **METROLINX**



Agenda

Welcome

- Introduction
- Land Acknowledgment
- Safety Moment
- Previous Action Items

Presentation

- Construction Update
- Upcoming works
- Hoarding Installation

Q/A and Discussion



Land Acknowledgment

Let us take a moment to acknowledge we are on lands that have been, and continue to be, home to many Indigenous Peoples including the Anishnabeg, the Haudenosaunee and the Huron-Wendat peoples.

We are all Treaty people. Many of us have come here as settlers, as immigrants or involuntarily as part of the trans-Atlantic slave trade, in this generation, or generations past.

We acknowledge the historic and continued impacts of colonization and the need to work towards meaningful reconciliation with the original caretakers of this land.

We acknowledge that Metrolinx operates on territories and lands covered by many treaties that affirm and value the rights of Indigenous communities, Nations and Peoples.

We understand the importance of working towards reconciliation with the original caretakers of this land. At Metrolinx, we will conduct business in a manner that is built on a foundation of trust, respect and collaboration.



Safety Moment

Commute Safely on Transit

Whether you're taking the subway or the GO Train, safety is paramount.

Here are quick tips for a safer rail commute:

1. **Mind the gap:** Watch your step and be mindful of the gap between the platform and the train.
2. **Hold on:** Always grip handrails or grab bars while the train is moving to prevent falls.
3. **Stay alert:** Be aware of your surroundings and report any suspicious activity or items to transit staff.
4. **Respect personal space:** Avoid crowding fellow passengers and keep bags clear of walkways to prevent accidents.
5. **Watch your step:** Be cautious when boarding or exiting, especially in adverse weather or low-light conditions.
6. **Know your route:** Familiarize yourself with the rail system's map and schedule to navigate confidently and avoid delays.



PREVIOUS CLC ACTION ITEMS

Action	Response	Status
OTG and Metrolinx to share dates on hoarding plan and dates with CLC members.	Metrolinx has published Notice regarding hoarding installation	Completed
Metrolinx to share any updates on managing traffic around Queen/Spadina by utilizing Westbound lane	Issue to be raised with the Traffic Services team for discussion and review	In progress

Construction Update

FUTURE NORTH STATION ENTRANCE

Recently completed works

- Demolition and installation of heritage retention towers at the future North site is now complete

Work in progress + upcoming soon

- Piling work started week of March 18th on the North Site; work expected through end June
- Replacement of existing hoarding/fencing with permanent, plywood hoarding underway; work expected through end of April
 - Work on Queen Street West and Spadina Avenue expected to start mid-April, overnight



FUTURE NORTH ENTRANCE - SITE LAYOUT

Site configuration during hoarding installation

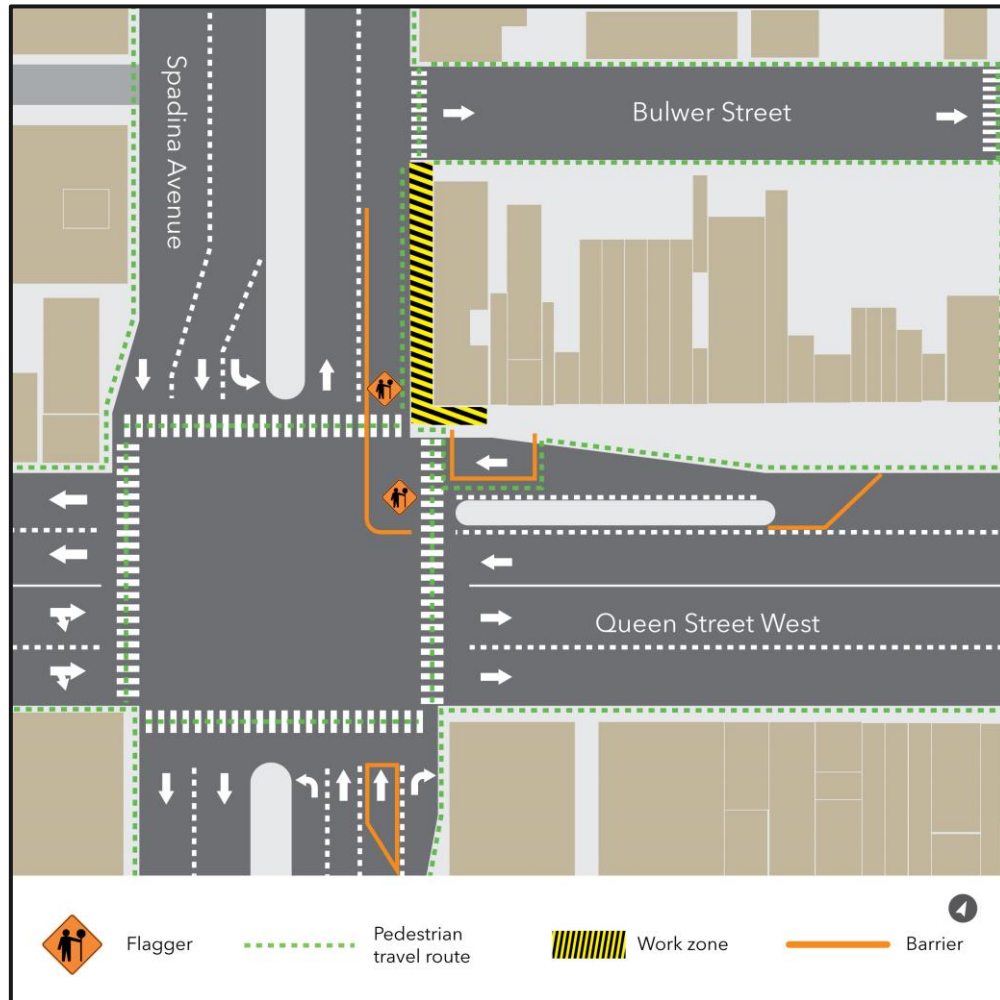

Expected long-term site layout + truck route

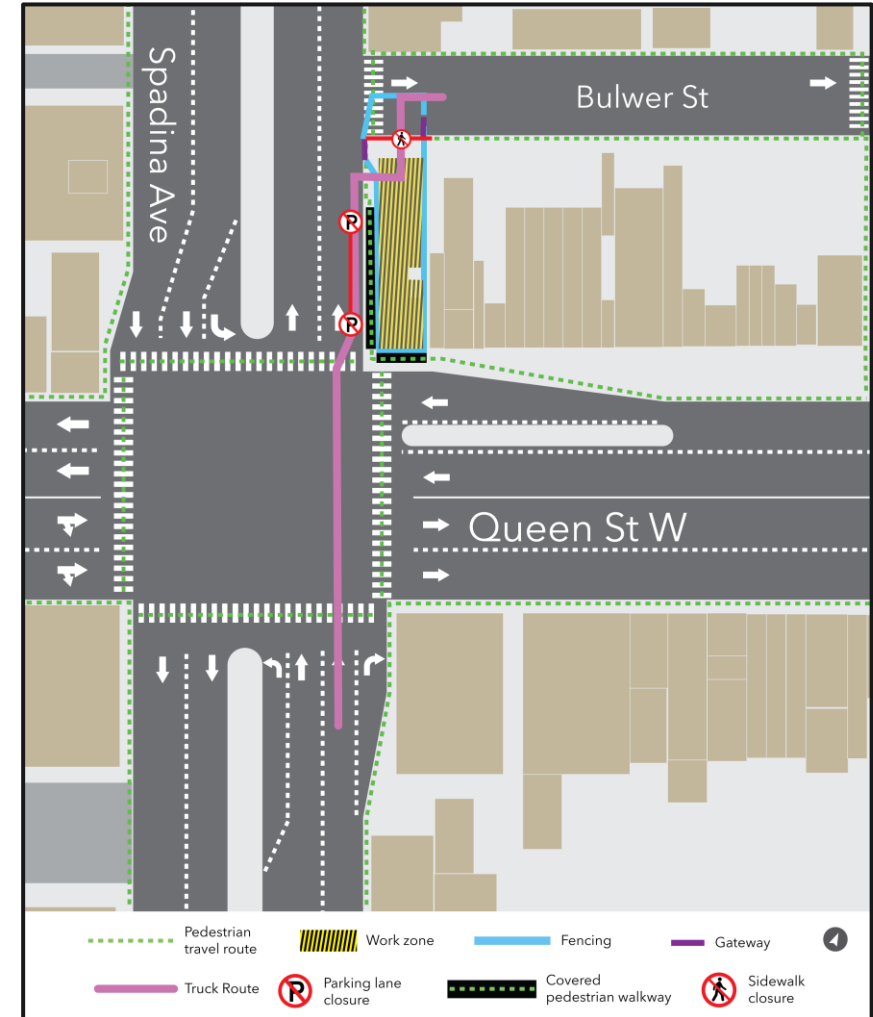

FUTURE SOUTH STATION ENTRANCE

Current work

- Piling works underway; work expected through mid-June
 - Second piling machine added week of March 18th
- Replacement of existing hoarding/fencing with permanent, plywood hoarding underway; work expected through end of April
 - Installation in Graffiti Alley and West side of site complete
 - Installation on Queen Street West and Spadina Avenue weekdays, overnight (7 p.m. – 5 a.m.) underway, expected to take approximately one week



FUTURE SOUTH ENTRANCE - SITE LAYOUT

Site configuration during hoarding installation

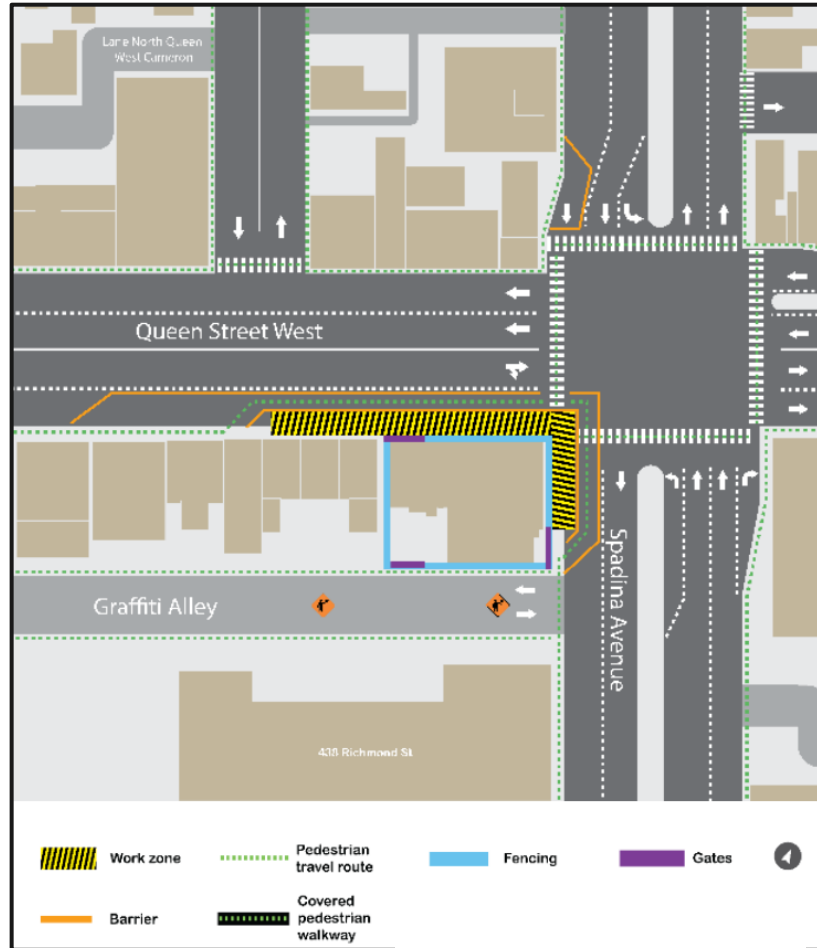

Expected long-term site layout + truck route

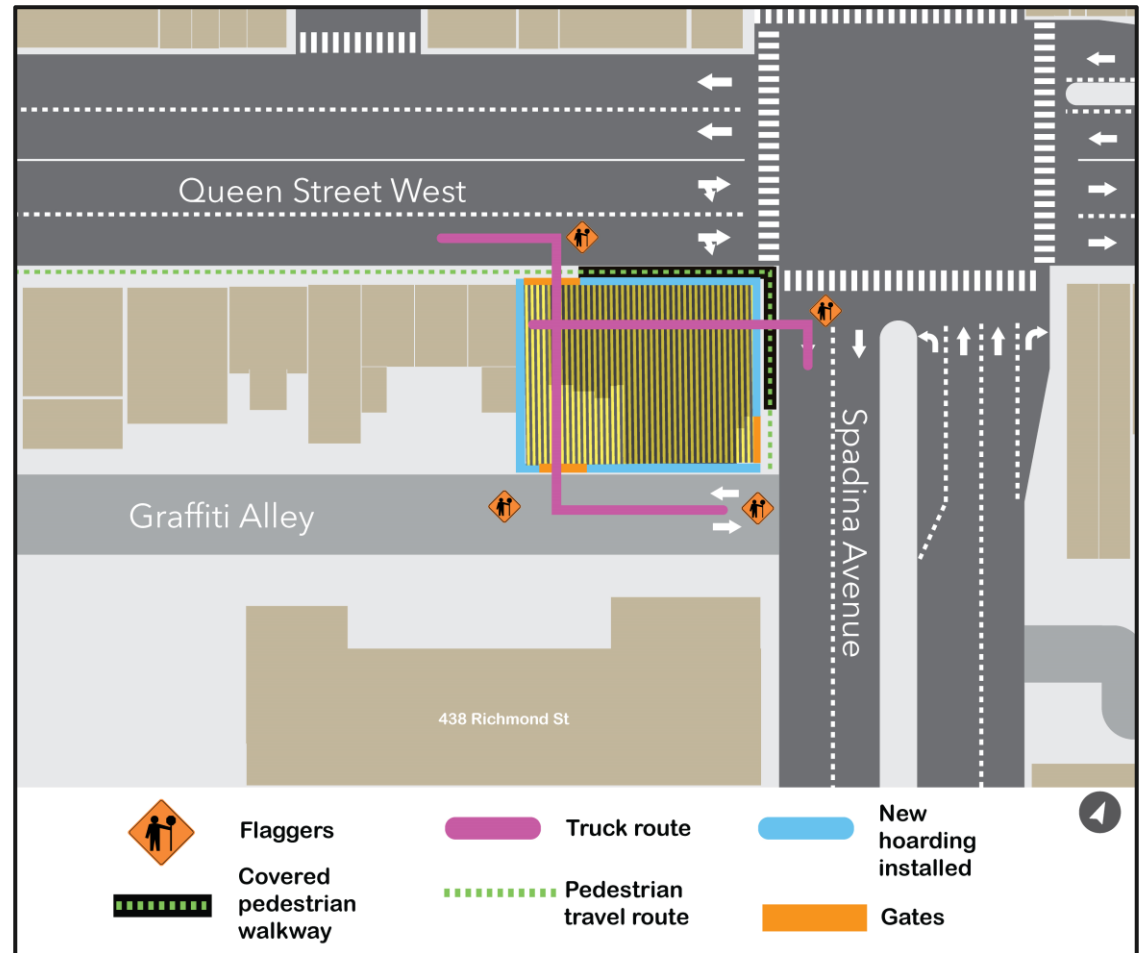

WORK IN PROGRESS: PHOTOS



View of piling works in progress (North and South)

WORK IN PROGRESS: PHOTOS



Interior view of works in progress at the North site

2024 CONSTRUCTION LOOK-AHEAD

Queen-Spadina			
Time	Activity	Location	Details & Purpose
Spring / Summer 2024	Piling	North and South station entrances	Piling to ensure structural support for the future station shafts, expected to be completed in Summer 2024
Spring 2024	Hoarding Reconfiguration + Installation	North and South station entrances	Hoarding to ensure site safety, expected to be completed in late Spring 2024
Summer 2024	Signage Installation - Phase	North and South station entrances	Installation of Phase 1 marketing signage expected to be completed by Summer 2024
Fall 2024 to 2025	Excavation	North and South station entrances	Initiate excavation of shafts to the station level, to provide connection with future station platforms

Estimated station substantial completion date: 2030

**dates subject to change based on unforeseen circumstances

Discussion

Community Engagement

Staying connected during construction

Construction notices and updates

- Prepared and distributed prior to new / impactful construction works; contact us to be added to the distribution list.

Monthly CLC meetings

- Regular committee meetings to discuss upcoming works and share information.
- Next meeting: May 7, 2024 (to be scheduled during daytime hours)

In-person and virtual consultation with residences and businesses

- Our door is open: share any feedback and concerns with us.

News, progress and information shared in the Ontario Line newsletter

- Sign up for regular updates and information.

We are here for you

Metrolinx will keep the community, residents and businesses informed by providing project updates, seeking input and feedback, while addressing questions and concerns effectively and quickly.

Connect with us:

Bradley Naismith, Advisor, Community Engagement

Email OntarioLine@metrolinx.com

Telephone 24/7 @ 416-202-5100

Ontario Line e-newsletter @ Metrolinx.com/OntarioLine

Follow us on social media:

X / Facebook / Instagram @OntarioLine



Paste the QR Code of Metrolinx
e-newsletter subscription

