

# Demolition and reconstruction work at the Queen Street East bridge

**Expected start date:** Monday, April 29, 2024

**Expected duration:** Six (6) months

**Hours of work:** Monday - Saturday, from 5 a.m. - 7 p.m.

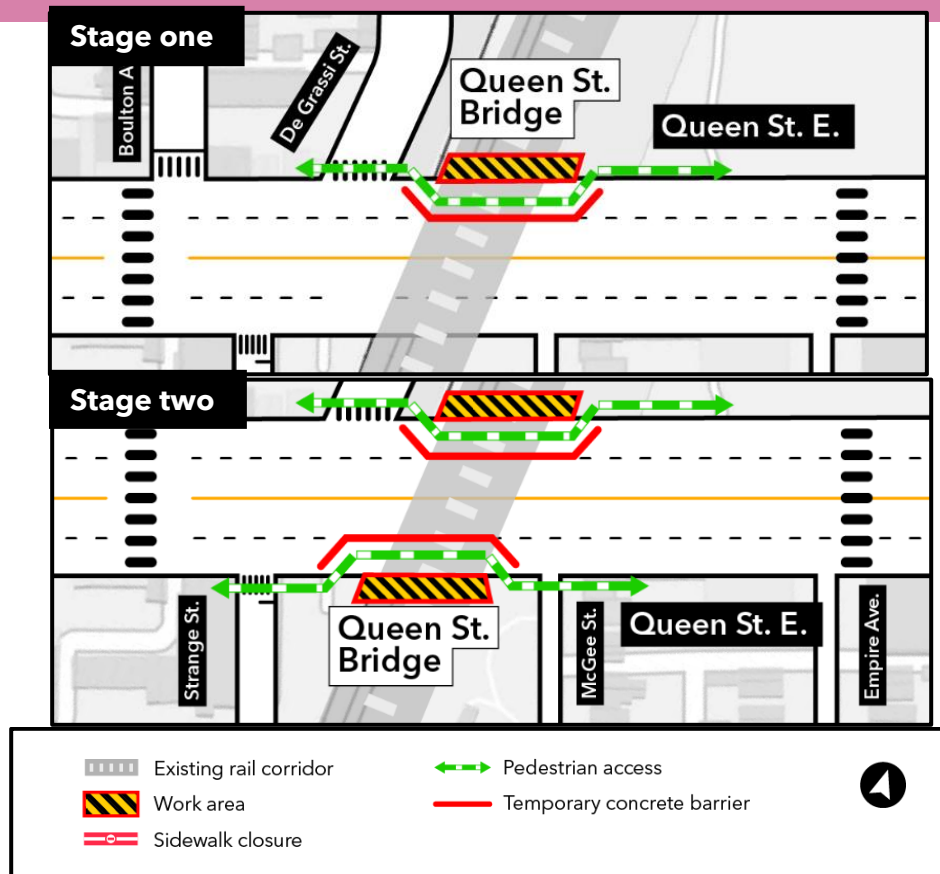

## What is happening?

- Starting Monday, April 29, 2024, the piers and abutments at the Queen St. E. bridge will be demolished. Once the demolition work is completed, new bridge abutments will be built.
- Construction will take place in two stages; work will start on the north side of Queen St. E. and then shift onto the south side of the road.
- This work will take place Monday - Saturday, between 5 a.m. - 7 p.m. for approximately six months. Periodically, work may be required to continue until 10 p.m. to complete critical activities.
- Traffic lane and pedestrian closures will be required to complete this work safely. Please review the complete notice below for specific details.

## Traffic and pedestrian details

- Traffic may be stopped for short durations during lifting operations or to facilitate the safe entry/egress of construction equipment.
- Crews may alternate between the two stages as required to allow for the safe continuation of the work.

### Stage one

- Westbound traffic on Queen St. E. will be reduced to one lane.
- For safety, the sidewalk on the north side of Queen St. E. will be closed periodically while demolition activities are taking place.
- When possible, temporary walkways will be established to provide pedestrian access around the work zone. **One sidewalk will remain open at all times.**

### Stage two

- Both eastbound and westbound traffic on Queen St. E. will be reduced to one lane.
- For safety, the sidewalk on the south side of Queen St. E. will be closed periodically while demolition activities are taking place.
- When possible, temporary walkways will be established to provide pedestrian access around the work zone. **One sidewalk will remain open at all times.**

## What to expect

- The piers and abutments on the east side of the Queen St. E. bridge will be removed and new abutments will be built.
- To complete this work safely, work zones will be set up beneath the Queen St. E. bridge.
- Drill rigs will be used to dig holes into the ground which will then be filled with steel and concrete to form the foundation for the new abutment. A crane will be used to set up the drill rig.
- Construction activities will include saw cutting, concrete breaking, piling, drilling, rebar installation, formwork installations, and concrete pours.
- Noise from construction equipment including concrete pumps, excavators, cranes, and delivery trucks, can be expected
- Noise mitigation measures, including temporary noise barriers and noise reducing equipment, will be implemented as required.
- Clear signage will be in place to direct vehicles and pedestrians.
- Traffic barrels, fencing, and barriers will be in place to separate and secure work zones.
- Construction equipment and materials will be properly secured within the work zones.
- Traffic markings will be removed and painted on the roadway as required to guide motorists and cyclists.
- Work may be delayed due to weather conditions or unforeseen circumstances.

## About the project

- 15.6-kilometre subway line that will make it faster and easier to travel within Toronto and beyond.
- 15 stops and more than 40 connections to other transit, including GO train, subway, LRT, streetcar and bus lines.
- Approximately 30 minutes from one end of the line to the other.
- 28,000 fewer cars on the road each day.

### Contact us:

Call us 24/7 at: [416-202-5100](tel:416-202-5100)

Write to us at: [ontarioline@metrolinx.com](mailto:ontarioline@metrolinx.com)

Find us on Twitter, Facebook, and

Instagram: [@ontarioline](https://www.instagram.com/ontarioline)

Visit the website:

[www.metrolinx.com/ontarioline](http://www.metrolinx.com/ontarioline)

### Visit our community offices:

**770 Queen Street East (near Queen & Broadview)**

General hours:

Mondays, Tuesdays, and Fridays: 9:00 a.m. to 5:00 p.m.

Wednesdays and Thursdays: 10:00 a.m. to 6:00 p.m.

### Thorncliffe Park:

East York Town Centre

45 Overlea Blvd., Toronto, ON M4H 1C3  
Unit 153 (across from the Rogers store)

General hours:

Monday – Friday, 9 a.m. – 5 p.m.