

# Overhead platform and power substation installation at Spadina Avenue

**Expected start date:** As early as June 15, 2024

**Expected duration:** End of July 2024

**Hours of work:** Weekdays, 7:00 a.m. to 5:00 p.m.

## Map of work area:

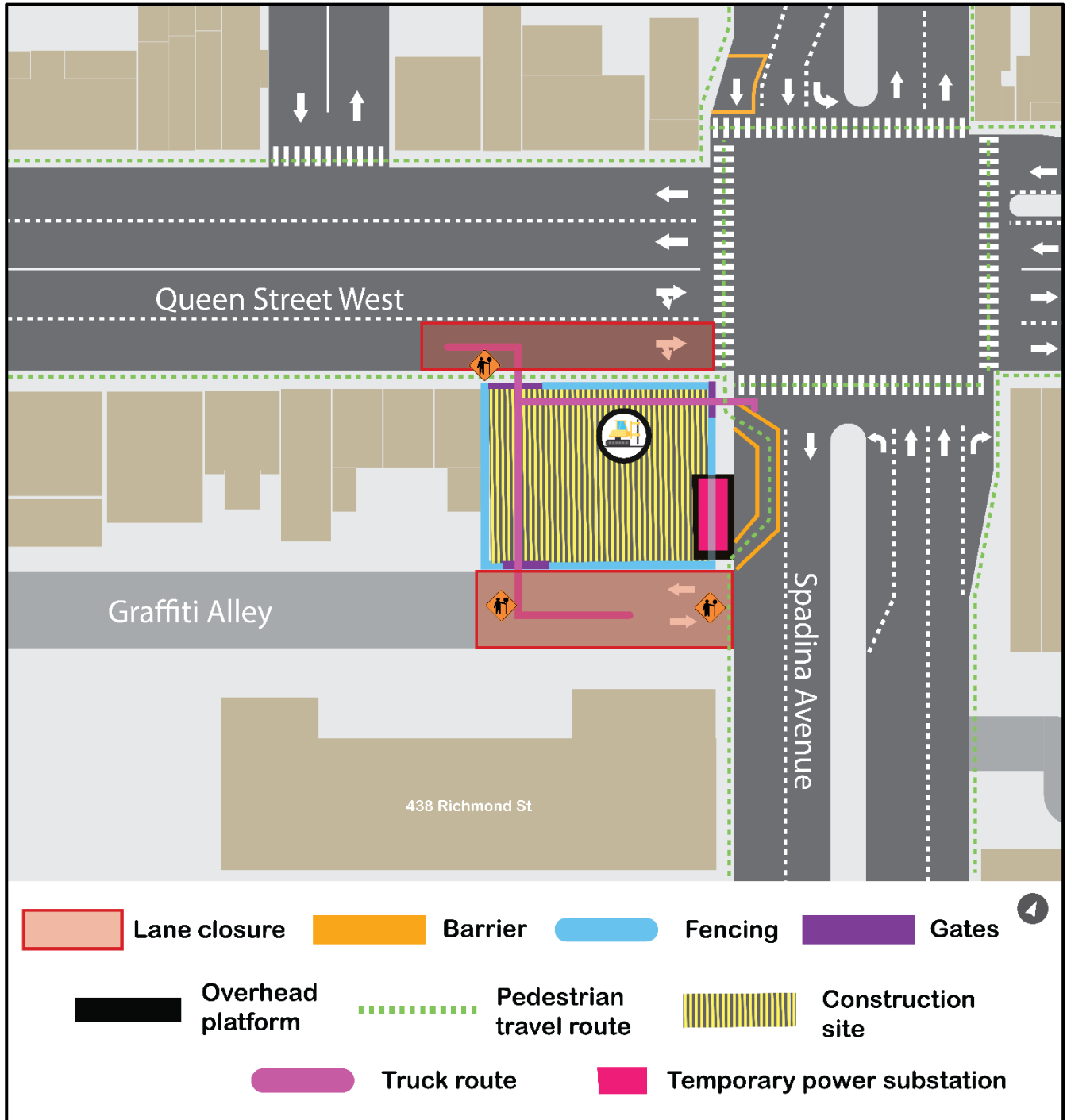

---

## What is happening?

- To prepare for construction of the future Ontario Line subway at Queen and Spadina, construction crews will be installing an overhead protection platform on Spadina Avenue at the future South station site, to house a temporary power substation to provide power for future station construction activities.
- This work is expected to start as early as **June 15, 2024**, and is expected to take up to six weeks to complete this installation.
- Crews are expected to work weekdays from 7:00 a.m. to 5:00 p.m. No overnight or weekend work is currently scheduled. Additional hours of work may be required.

---

## What can I expect?

- The southbound curb lane of Spadina Avenue from Queen St to Graffiti Alley will be closed during the platform elevation. The platform elevation is expected to take up to 5 days. This lane will be open to traffic outside of working hours.
- A pedestrian detour route will be active on Spadina Ave; this detour will be marked by barriers to protect the public from work activity and vehicle traffic.
- Pedestrian access through the area is expected to be maintained during this period, as indicated on the map above. Upon completion, covered pedestrian walkways will reopen.
- Flag persons will be on site to direct traffic during work hours.
- There are no expected impacts to transit services, and access to local residential and commercial units will be maintained.
- During construction, community members will see trucks delivering materials, and crews working to install the elevated platform. Some noise may occur from construction equipment, including front-end loaders used to pick up and move materials, trucks and hammers.
- All the necessary construction permits have been obtained.
- Work may be postponed, rescheduled, dates changed, or hours added due to unforeseen circumstances.
- For more information about upcoming station work please see [metrolinx.com/Ontarioline](https://metrolinx.com/Ontarioline) or sign up for the e-newsletter.

---

## About the Ontario Line

- 15.6-kilometre subway line that will make it faster and easier to travel within Toronto and beyond.
- 15 stops and more than 40 connections to other transit, including GO train, subway, LRT, streetcar and bus lines.
- Less than 30 minutes from one end of the line to the other.
- 28,000 fewer car trips each day.

### Contact us:

Call us 24/7 at: [416-202-5100](tel:416-202-5100)

Write to us at: [ontarioline@metrolinx.com](mailto:ontarioline@metrolinx.com)

Find us on X, Facebook, and Instagram: [@ontarioline](https://www.instagram.com/ontarioline)

Visit the website: [www.metrolinx.com/ontarioline](https://www.metrolinx.com/ontarioline)

### Visit our community offices:

**770 Queen Street East (near Queen & Broadview)**

General hours:

Mondays, Tuesdays, and Fridays: 9:00 a.m. to 5:00 p.m.

Wednesdays and Thursdays: 10:00 a.m. to 6:00 p.m.

### Thornccliffe Park:

East York Town Centre

45 Overlea Blvd., Toronto, ON M4H 1C3  
Unit 153 (across from the Rogers store)

General hours:

Monday - Friday, 9 a.m. - 5 p.m.