

Updated: Cowbell Lane Closure Extended for Restoration Works and Deliveries

Through until approximately late-September 2024

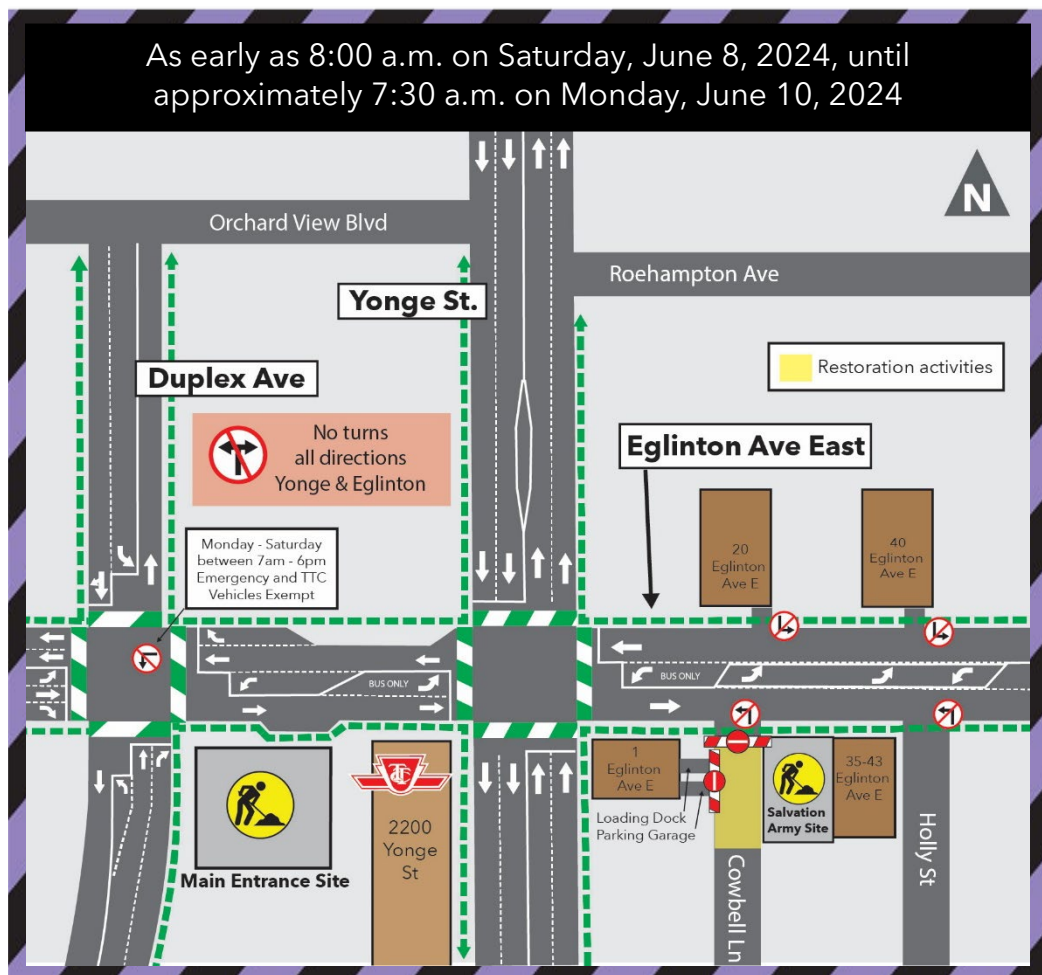

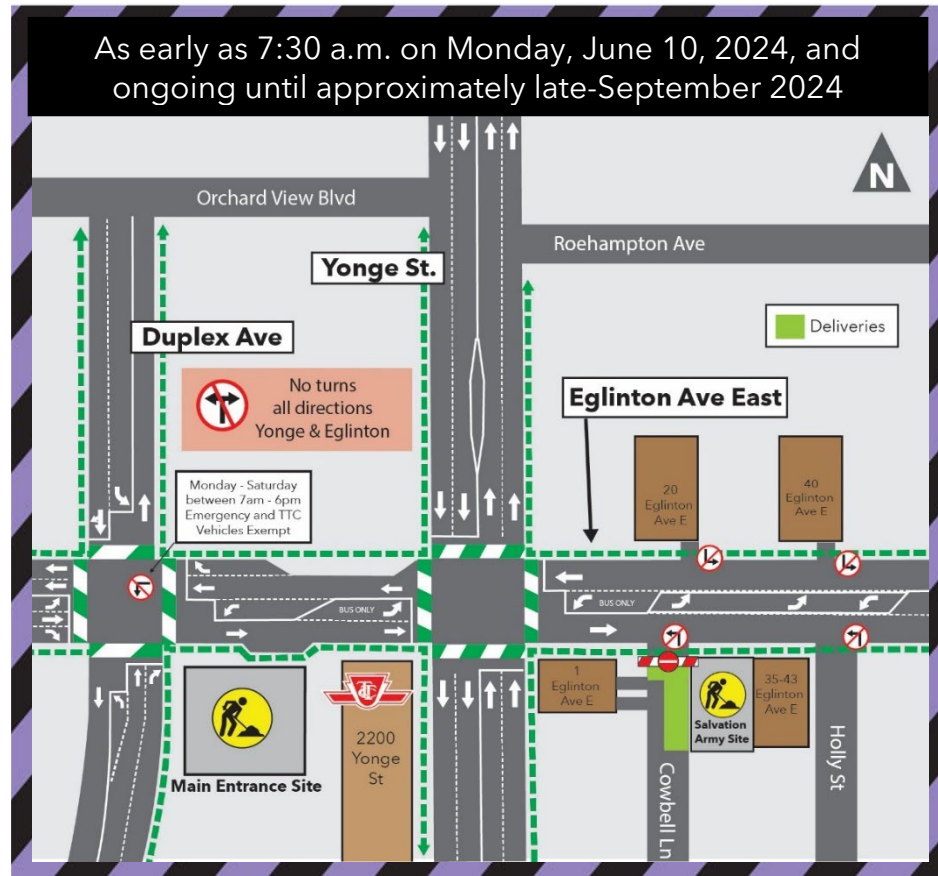

What Work is Taking Place?

Access to Cowbell Lane from Eglinton Avenue East will remain restricted as crews continue with restoration works and deliveries. **Access to the parking garage and loading dock at 1A Eglinton Avenue East will be restricted from 8:00 a.m. on Saturday, June 8, 2024, until approximately 7:30 a.m. on Monday, June 10, 2024, to facilitate restoration activities. Upon completion of this work, access to Cowbell Lane from Eglinton Avenue East will remain restricted until approximately late-September 2024, to facilitate deliveries for construction at The Salvation Army site.** Noise from restoration activity including concrete breaking, truck staging, and use of a hydro-vacuum truck can be expected. One lane of traffic in each direction will be maintained at all times on Eglinton Avenue East. Short-term periodic lane reductions may be required on Eglinton Avenue East to facilitate special activities and deliveries following the completion of this work.

What to Expect

Access to the parking garage and loading dock at 1A Eglinton Avenue East will be restricted from 8:00 a.m. on Saturday, June 8, 2024, until approximately 7:30 a.m. on Monday, June 10, 2024, to facilitate restoration activities. Upon completion of this work, access to Cowbell Lane from Eglinton

Avenue East will remain restricted until approximately late-September 2024, to facilitate deliveries for construction at The Salvation Army site. Noise from construction activity including concrete breaking, truck staging, and use of a hydro-vacuum truck can be expected. One lane of traffic in each direction will be maintained at all times on Eglinton Avenue East. Short-term periodic lane reductions may be required on Eglinton Avenue East to facilitate special activities and deliveries following the completion of this work.

HOURS OF WORK

- Access to the parking garage and loading dock at 1A Eglinton Avenue East will be restricted from 8:00 a.m. on Saturday, June 8, 2024, until approximately 7:30 a.m. on Monday, June 10, 2024.
- Access to Cowbell Lane will remain restricted through until approximately late-September 2024.
- Construction activities are expected to take place seven days a week between 7:00 a.m. and 7:00 p.m.
- Work may be rescheduled due to inclement weather or unforeseen circumstances.
- Work may be longer or shorter than expected.

TRAFFIC DETAILS

- Access to the parking garage and loading dock at 1A Eglinton Avenue East will be restricted from 8:00 a.m. on Saturday, June 8, 2024, until approximately 7:30 a.m. on Monday, June 10, 2024.
- Access to Cowbell Lane from Eglinton Avenue East will remain restricted until approximately late-September 2024.

PEDESTRIAN DETAILS

- No changes to the current pedestrian routes are expected as a result of this work.

TRANSIT INFORMATION

- Access to TTC will be maintained at all times.
- Please visit www.ttc.ca for more information.

Contact our East Community Office:
Hours of Operation: Monday to Friday, 9:00 a.m. to 5:00 p.m.
Tel: 416-482-7411

Contact our West Community Office:
Hours of Operation: Monday to Friday, 9:00 a.m. to 5:00 p.m.
Tel: 416-782-8118

Contact Us:

Write to us at: crosstown@metrolinx.com

Find us on Twitter @CrosstownTO

Visit the website: www.metrolinx.com/eglintoncrosstownlrt

Disponible en français.