

UPDATED: Pile Drilling at Queen St West and Spadina Ave

Expected start date: As early as January 15, 2024

Hours of work:

- North site: Weekdays from 7:00 a.m. to 11:00 p.m.; Saturdays from 7:00 a.m. to 5:00 p.m.
- **South site:** Weekdays from 7:00 a.m. to 7:00 p.m.; **Saturdays from 7:00 a.m. to 5:00 p.m.**

Expected completion: End of June 2024

What is piling?

- Crews will be drilling to install structural walls - also known as secant pile walls - to support the underground excavation of the Ontario Line station at Queen Street West and Spadina Avenue.
- A secant pile wall is a type of retaining wall used to secure the soil and ensure water tightness prior to excavation.
- The process consists of drilling a series of holes and filling them with concrete to create overlapping (secant) piles that form a continuous structural wall.
- Some of the piles are further reinforced with steel beams.
- This work is performed prior to excavation to prevent ground settlement.
- Work will begin first on the future south station site, before moving to the future north station site.



Pile drilling rig shown above

What to expect

- Work is expected to take place at the North site weekdays between 7:00 a.m. to 11:00 p.m., as well as Saturdays from 7:00 a.m. to 5:00 p.m. Work at the south site is expected to take place weekdays between 7:00 a.m. to 7:00 p.m. as well as **Saturdays from 7:00 a.m. to 5:00 p.m.**
- Noise from equipment drilling piles, removing spoils and concrete work is expected.
- Residents will see drilling machines, cranes, excavators, concrete pumps, and concrete trucks on-site during this phase of work.
- Several trucks will be entering and leaving worksites daily, following a specified route.
- Work will be phased, beginning first at the future south site, followed by the north site.
- Lane closures will be in place to ensure safety for the community and workers on-site and will remain in place for the duration of the work period.
- To reduce impacts to residents and businesses in the area, mitigations will be in place including noise and vibration monitoring, daytime work hours and site hoarding.
- Work may be postponed or rescheduled due to unforeseen circumstances. Additional hours of work may be required, including weekends.

Pedestrian Access and Truck Routing at the South Site (Queen Street West, Graffiti Alley, Spadina Avenue) Mid-January 2024 to end of April 2024

- The eastbound curb lane at Queen Street West will be closed to facilitate truck access and staging.
- Piles at the south end of the site are at the property limit of Graffiti Alley. In order to maintain site safety, the Graffiti Alley is expected to be closed for the duration of this work.
- Trucks will enter on Queen Street West (eastbound) and exit on Spadina Avenue (southbound).

- Flaggers will be present to ensure pedestrian safety and direct truck traffic.

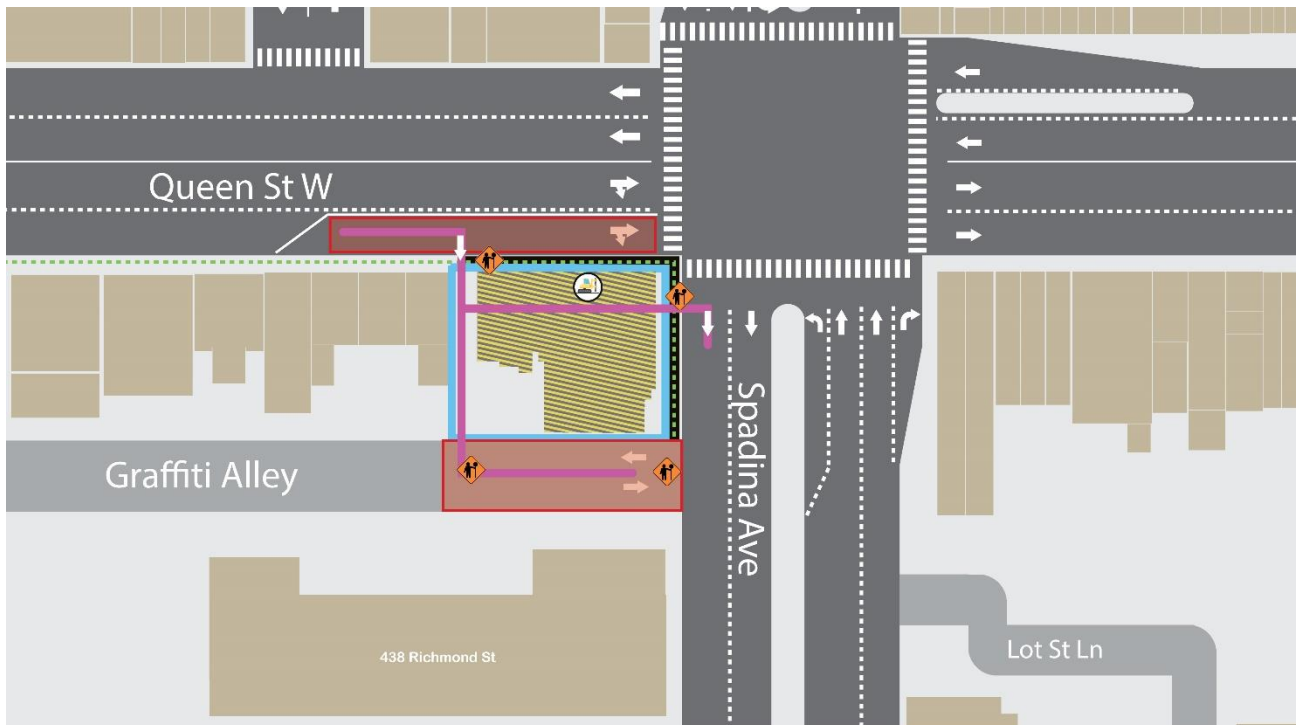

Lane closure
 Truck route
 Fencing
 Pedestrian travel route
 Covered pedestrian walkway

 Piling machine
 4

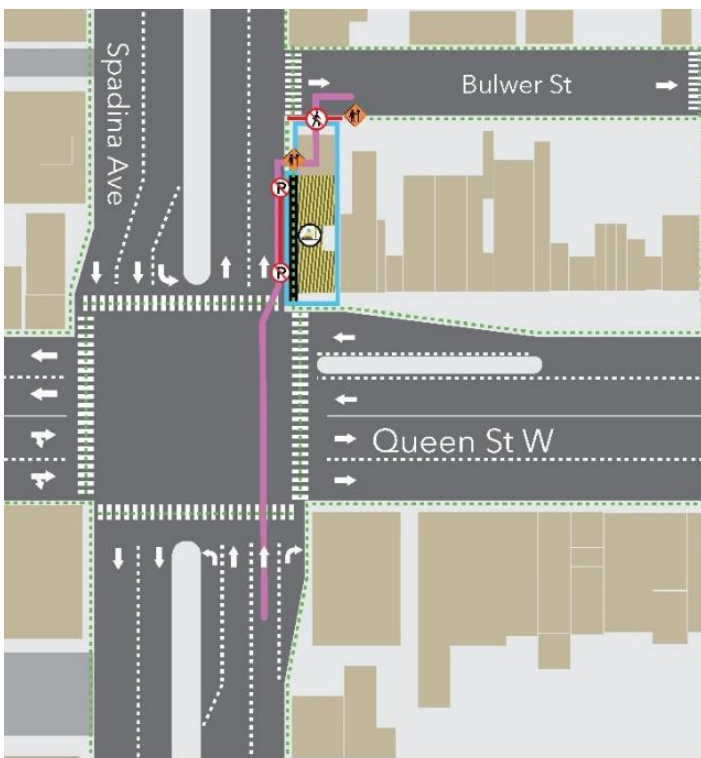

**North Site - (Queen Street West, Spadina Avenue, Bulwer Street)
March 2024 - June 2024**

- The parking lane on the east side of Spadina Avenue (northbound) will remain closed.
- Trucks will enter the site from Spadina Avenue (northbound) and will exit to Bulwer Street.
- Pedestrian access north on Spadina Avenue will be maintained. Once the heritage façade retention towers are installed, a pedestrian tunnel will be provided under a scaffold.
- The sidewalk on the south side of Bulwer Street will continue to be partially closed.
- Flaggers will still be present to ensure pedestrian safety and direct truck traffic.

Pedestrian travel route
 Work zone
 Fencing
 Truck route

 Piling machine

 Parking lane closure
 Covered pedestrian walkway

 Sidewalk closure
 4

About the Ontario Line

- 15.6-kilometre subway line that will make it faster and easier to travel within Toronto and beyond.
- 15 stops and more than 40 connections to other transit, including GO train, subway, LRT, streetcar, and bus lines.
- Less than 30 minutes from one end of the line to the other.
- 28,000 fewer car trips each day.

Contact us:

Call us 24/7 at: [416-202-5100](tel:416-202-5100)
 Write to us at: ontarioline@metrolinx.com
 Find us on X, Facebook, and Instagram: [@ontarioline](https://www.instagram.com/ontarioline)
 Visit the website: www.metrolinx.com/ontarioline

Visit our community offices:

770 Queen Street East (near Queen & Broadview)
 General hours:
 Mondays, Tuesdays, and Fridays: 9:00 a.m. to 5:00 p.m.
 Wednesdays and Thursdays: 10:00 a.m. to 6:00 p.m.

Thorncliffe Park:

East York Town Centre
 45 Overlea Blvd., Toronto, ON M4H 1C3
 Unit 153 (across from the Rogers store)
 General hours:
 Monday - Friday, 9 a.m. - 5 p.m.