

Station Excavation at Moss Park

Expected start date: As early as July 18, 2024

Hours of work: Weekdays from 7:00 a.m. to 7:00 p.m.

Expected completion: End of July 2025

JOIN US FOR A MOSS PARK VIRTUAL OPEN HOUSE ON JUNE 13, 2024

For more information about the Ontario Line construction happening at Moss Park, Metrolinx and its Ontario Line constructor, Ontario Transit Group, welcome you to a Virtual Open House on June 13, 2024, from 7:00 p.m. to 8:00 p.m. ET.

Please register at metrolinx.com/ontarioline and click on **Events** for details or scan the QR to the right:



What is station excavation?

Crews will be removing soil and bedrock to a depth of 30m in the shaft, where the tunnel boring machine will go, to prepare for installation of the station, tunneling and machinery support systems for the future Ontario Line station at Moss Park.



Image used is for illustrative purposes only.

What to expect

- Work is expected to take place weekdays between 7:00 a.m. and 7:00 p.m.
- Additional work hours may be required to allow teams to complete consecutive works.
- Working hours are not expected to extend beyond 11:00 p.m.
- Residents will see cranes, excavators, dozers and dump trucks on-site during this phase of work.
- Increased truck traffic entering and leaving worksites daily, following a specified route (refer to graphic below). No impacts to sidewalks or lanes anticipated.
- Access to the arena parking lot will be maintained.
- There will be construction noise from the use of excavators and dozers for the removal of spoils.
- To reduce impacts to residents and businesses in the area, mitigations are in place including air quality, noise and vibration monitoring, site hoarding, additional paved areas, sprinkler systems and mud mats for dust suppression, and no overnight works. *Mitigation efforts vary from site to site.
- Noise and vibration produced by the excavators, will lessen as equipment digs down deeper.

Truck routing

Truck routing is illustrated in purple:

To maintain site safety, the east access point at Queen Street East and Sherbourne Street and the southwest access point on Queen Street East and George Street will be staffed by traffic control persons. This will enable pedestrians to safely pass and trucks to enter the site or merge into traffic when exiting the site.

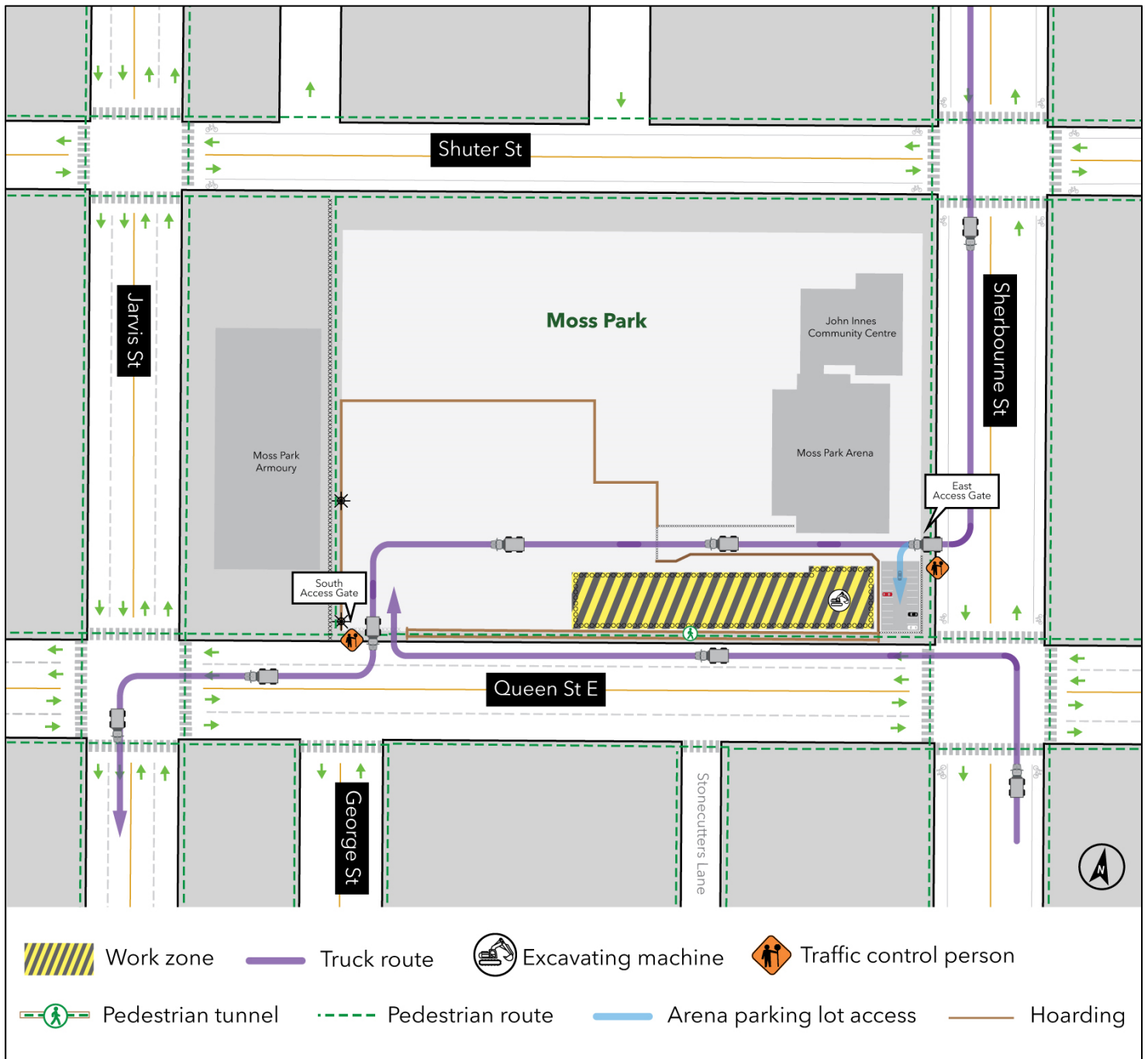

About the Ontario Line

- 15.6-kilometre subway line that will make it faster and easier to travel within Toronto and beyond.
- 15 stops and more than 40 connections to other transit, including GO train, subway, LRT, streetcar, and bus lines.
- Less than 30 minutes from one end of the line to the other.
- 28,000 fewer car trips each day.

Contact us:

Call us 24/7 at: [416-202-5100](tel:416-202-5100)

Write to us at: ontarioline@metrolinx.com

Find us on X, Facebook, and Instagram:

[@ontarioline](#)

Visit the website:

www.metrolinx.com/ontarioline

Visit our community offices:

770 Queen Street East (near Queen & Broadview)

General hours:

Mondays, Tuesdays, and Fridays: 9:00 a.m. to 5:00 p.m.

Wednesdays and Thursdays: 10:00 a.m. to 6:00 p.m.

Thornclyffe Park:

East York Town Centre
45 Overlea Blvd., Toronto, ON M4H 1C3
Unit 153 (across from the Rogers store)

General hours:

Monday – Friday, 9 a.m. – 5 p.m.