

# Toronto Hydro Trenching and Duct Bank Installation

**Expected start date:** As early as July 2, 2024

**Expected duration:** Approximately two (2) months

**Hours of work:** Weekdays, 7 a.m. to 11 p.m., Weekends 9 a.m. to 7 p.m.

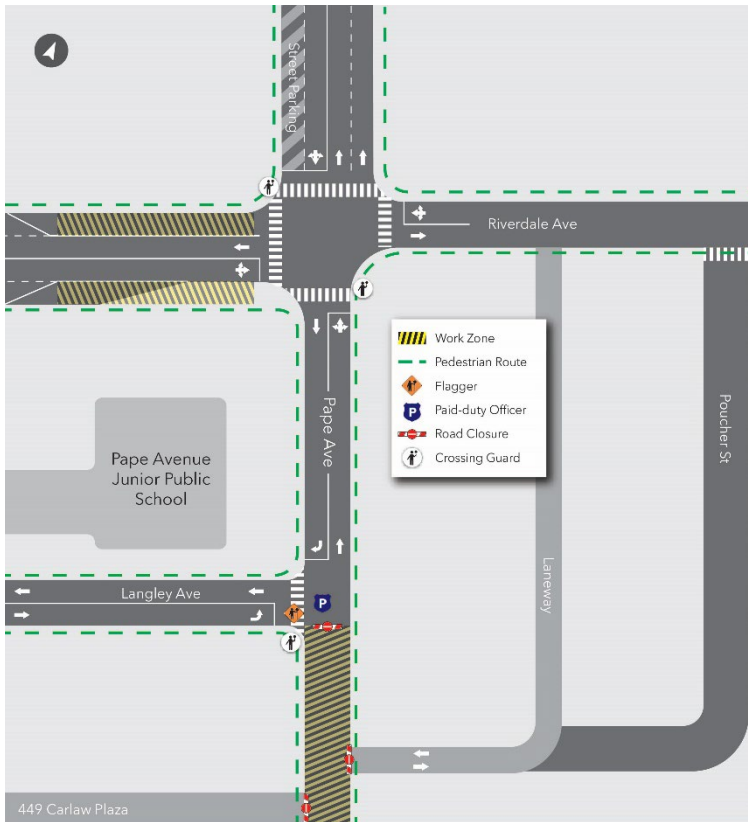

Figure 1: Stage 1

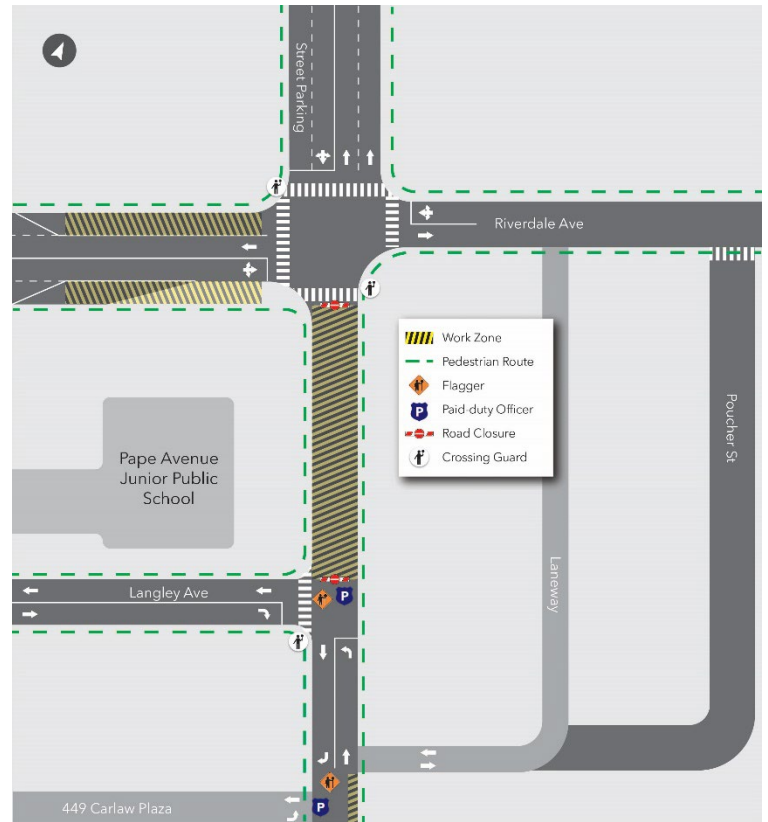

Figure 2: Stage 2

## What is happening?

- As part of Toronto Hydro's utility relocation works along Pape Avenue from Riverdale Avenue to south of Langley Avenue, crews will begin trenching to allow for duct bank installation along the east side of Pape Avenue.
- Work will be complete through two stages:
  - Stage 1 [Figure 1]: Pape Avenue from the entrance of the 449 Carlaw Avenue Plaza to Langley Avenue
  - Stage 2 [Figure 2]: Pape Avenue from Langley Avenue to Riverdale Avenue.
- While trenching will take place on the eastern half of the road, the entire road must be closed to allow for safe operation of construction equipment and to maintain safe conditions for workers and the public.
- This work will take approximately two months to complete.

## What to expect:

### Construction

- Work will involve the use of excavators and a hydrovac truck. This is a requirement to safely protect existing utility infrastructure.
- Concrete trucks will be used to pour concrete for the duct banks being installed below the street surface.
- Residents and businesses in the area may hear noise caused by work equipment. Crews will take measures to minimize noise impacts wherever possible.

- Work may be delayed due to weather conditions or unforeseen circumstances.

## Traffic and Pedestrian Details

- During the first stage vehicular access will be closed between the 449 Carlaw plaza and Langley Avenue on Pape Avenue.
  - Vehicles in the plaza may exit the plaza using the Carlaw Avenue exit.
- During the second stage, vehicular access will be closed between Langley Avenue and Riverdale Avenue on Pape Avenue.
  - Vehicles coming east on Langley must turn south, and may exit via either the plaza or Poucher Street.
- Vehicles coming north on Pape must turn west onto Langley Avenue.
- **During the second stage, the pick-up drop-off zone on Pape Avenue will be closed. Metrolinx is coordinating with Pape Children's House to arrange an alternative location, which will be communicated to parents in advance of this stage.**
- Pedestrian routes will remain open around the work zone.
- Fencing will be erected to separate work zones from the public.
- Access to residences will always be maintained.

## Safety

- Paid duty officers and/or traffic control personnel will be on-site managing traffic and pedestrian flow.
- Signage will be posted around the site to direct pedestrians.
- Equipment may be left on site but will be properly secured and stored to ensure safety.
- Emergency medical services and garbage disposal services will be allowed to progress through the closure areas when required.
- Dust will be mitigated by misting, sweeping and/or the use of a hydrovac truck.
- After-hours security will be onsite between 7 p.m. and 7 a.m. to ensure equipment and materials are not tampered with.

### Contact us:

Call us 24/7 at: [416-202-5100](tel:416-202-5100)

Write to us at: [ontarioline@metrolinx.com](mailto:ontarioline@metrolinx.com)

Find us on Twitter, Facebook, and Instagram: [@ontarioline](https://www.instagram.com/ontarioline)

Visit the website: [www.metrolinx.com/ontarioline](http://www.metrolinx.com/ontarioline)

### Visit our community offices:

#### Riverside:

770 Queen St. E, Toronto, ON, M4M 1H4

General hours:

- Mondays, Tuesdays and Fridays: 9 a.m. to 5 p.m.
- Wednesdays and Thursdays: 10 a.m. to 6 p.m.

#### Thornccliffe Park:

East York Town Centre

45 Overlea Blvd., Toronto, ON M4H 1C3

Unit 153 (across from the Rogers store)

General hours

- Monday to Friday: 9 a.m. to 5 p.m.