

# Update: Full Closure of Pape Avenue between Riverdale Avenue and Langley Avenue

**Expected start date:** As early as July 15, 2024

**Expected duration:** Approximately six (6) weeks

**Hours of work:** Weekdays, 7 a.m. to 11 p.m., Weekends 9 a.m. to 7 p.m.

## What is happening?

- To allow for Toronto Hydro's utility relocation works along Pape Avenue to be carried out safely, crews will be closing Pape Avenue to vehicle traffic between Langley Avenue and Riverdale Avenue.
  - This closure will be put into effect as early as July 15, and will last for approximately six weeks.

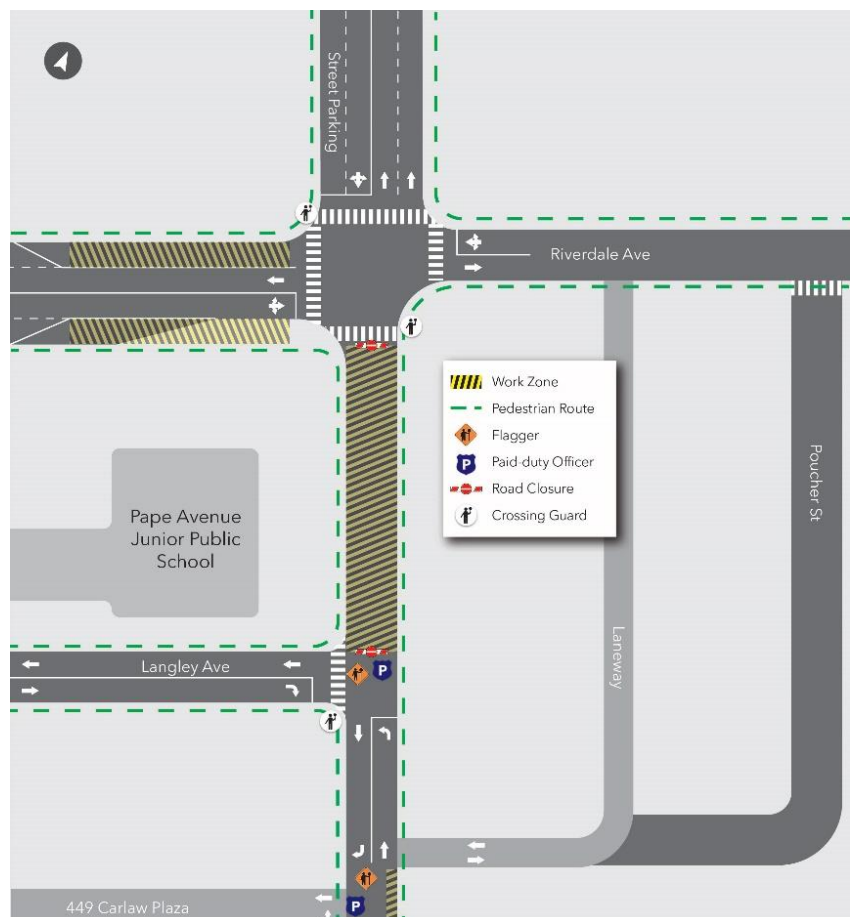

## What to expect:

### Construction

- Work will involve the use of excavators and a hydrovac truck. This is a requirement to safely protect existing utility infrastructure.
- Concrete trucks will be used to pour concrete for the duct banks being installed below the street surface.
- Residents and businesses in the area may hear noise caused by work equipment. Crews will take measures to minimize noise impacts wherever possible.
- Work may be delayed due to weather conditions or unforeseen circumstances.

### Traffic and Pedestrian Details

- During the closure, vehicular access will be restricted on Pape Avenue between Langley Avenue and Riverdale Avenue.
  - Vehicles travelling east on Langley Avenue must turn right (south) onto Pape Avenue and may exit via the plaza or the laneway east of Pape Avenue.
  - Vehicles coming north on Pape Avenue must turn left (west) onto Langley Avenue.

- **With the start of the closure, the pick-up drop-off [PUDO] zone on Pape Avenue will be closed. Metrolinx is relocating the pick-up drop-off zone to Langley Avenue and coordinating with Pape Children’s House.**
- The Riverdale pick-up drop-off will be in place for the subsequent sewer relocation work happening this fall. Metrolinx will coordinate with the TDSB to communicate this shift to parents in advance of the 2024-2025 school year.
- Pedestrian routes will remain open around the work zone.
- Fencing will be erected to separate work zones from the public.
- Access to residences will always be maintained.

## Safety

- Paid duty officers and/or traffic control personnel will be on-site managing traffic and pedestrian flow.
- Signage will be posted around the site to direct pedestrians.
- Equipment may be left on site but will be properly secured and stored to ensure safety.
- Emergency medical services and garbage disposal services will be allowed to progress through the closure areas when required.
- Dust will be mitigated by misting, sweeping and/or the use of a hydrovac truck. After-hours security will be onsite between 7 p.m. and 7 a.m. to ensure equipment and materials are not tampered with.

### Contact us:

Call us 24/7 at: [416-202-5100](tel:416-202-5100)

Write to us at: [ontarioline@metrolinx.com](mailto:ontarioline@metrolinx.com)

Find us on Twitter, Facebook, and Instagram: [@ontarioline](#)

Visit the website: [www.metrolinx.com/ontarioline](http://www.metrolinx.com/ontarioline)

### Visit our community offices:

#### Riverside:

770 Queen St. E, Toronto, ON, M4M 1H4

General hours:

- Mondays, Tuesdays and Fridays: 9 a.m. to 5 p.m.
- Wednesdays and Thursdays: 10 a.m. to 6 p.m.

#### Thornccliffe Park:

East York Town Centre

45 Overlea Blvd., Toronto, ON M4H 1C3

Unit 153 (across from the Rogers store)

General hours

- Monday to Friday: 9 a.m. to 5 p.m.