

Update: Overhead platform and power substation installation at Spadina Avenue

Expected start date: As early as July 11, 2024

Expected duration: As early as August 2024

Hours of work: Weekdays, **Daytime** 7:00 a.m. to 5:00 p.m. and **Nighttime** 7:00 p.m. to 5:00 a.m.

Map of work area:

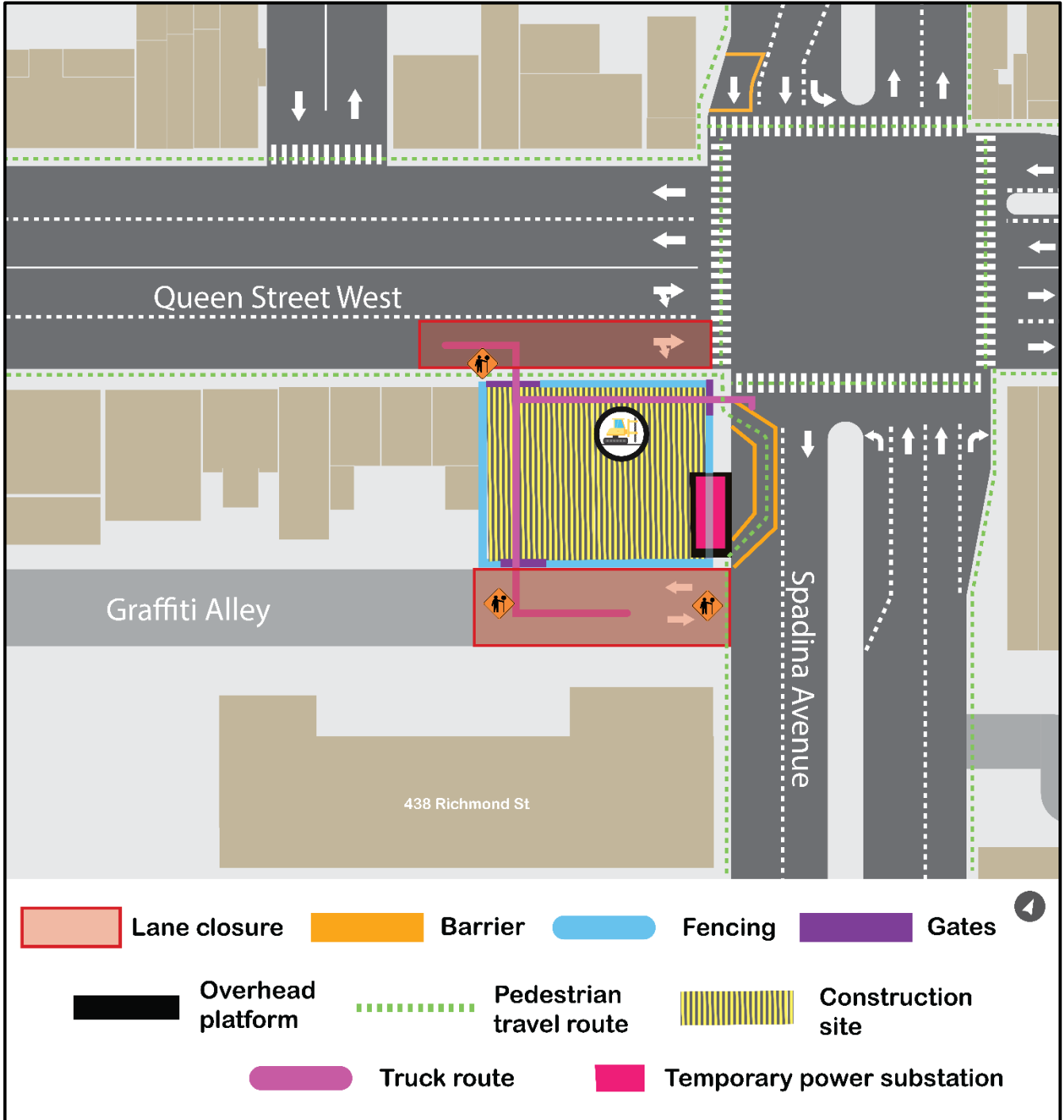

What is happening?

- To prepare for construction of the future Ontario Line subway at Queen and Spadina, construction crews will be installing an overhead protection platform on Spadina Avenue at the future South station site, to house a temporary power substation to provide power for future station construction activities.

What can I expect?

- Due to permit expectations from the City of Toronto, this work has been postponed and is expected to start **as early as July 11, 2024**, for up to 4 weeks to complete this installation.
- Crews are expected to work weekdays **daytime from 7:00 a.m. to 5:00 p.m. and nighttime from 7:00 p.m. to 5:00 a.m.** Additional hours of work may be required.
- During the elevation of the platform which will take only few days, up to 5 days. The southbound curb lane of Spadina Avenue will be closed only during the elevation of the platform. The elevation of the platform is expected to take up to 5 days. For this work, the barriers will be moved, and lane will reopen to traffic outside of working hours.
- Pedestrians will detour on to Spadina Avenue; this detour will be marked by barriers to protect the public from work activity and the road.
- Pedestrian access through the area is expected to be maintained during all phases of work, as indicated on the map above. Upon completion, covered pedestrian walkways will reopen.
- Flag-persons will be in place on to direct traffic.
- There are no expected impacts to transit services, and access to local residential and commercial units will be maintained.
- During construction, community members will see trucks delivering materials, and crews working to install the elevated platform. Some noise may occur from construction equipment, including front-end loaders used to pick up and move materials, trucks and hammers.
- All the necessary construction permits have been obtained.
- Work may be postponed, rescheduled, dates changed, or hours added due to unforeseen circumstances.
- For more information about upcoming station work please see metrolinx.com/Ontarioline or sign up for the e-newsletter.

About the Ontario Line

- 15.6-kilometre subway line that will make it faster and easier to travel within Toronto and beyond.
- 15 stops and more than 40 connections to other transit, including GO train, subway, LRT, streetcar and bus lines.
- Less than 30 minutes from one end of the line to the other.
- 28,000 fewer car trips each day.

Contact us:

Call us 24/7 at: [416-202-5100](tel:416-202-5100)

Write to us at: ontarioline@metrolinx.com

Find us on X, Facebook, and Instagram: [@ontarioline](https://www.instagram.com/ontarioline)

Visit the website: www.metrolinx.com/ontarioline

Visit our community offices:

770 Queen Street East (near Queen & Broadview)

General hours:

Mondays, Tuesdays, and Fridays: 9:00 a.m. to 5:00 p.m.

Wednesdays and Thursdays: 10:00 a.m. to 6:00 p.m.

Thorncliffe Park:

East York Town Centre

45 Overlea Blvd., Toronto, ON M4H 1C3
Unit 153 (across from the Rogers store)

General hours:

Monday - Friday, 9 a.m. - 5 p.m.