

Monitoring device installations on King West Laneway

Expected start date: As early as August 5, 2024.

Duration: Until August 15, 2024

Hours of work: Weekdays (Monday-Friday), 7 a.m. to 7 p.m.

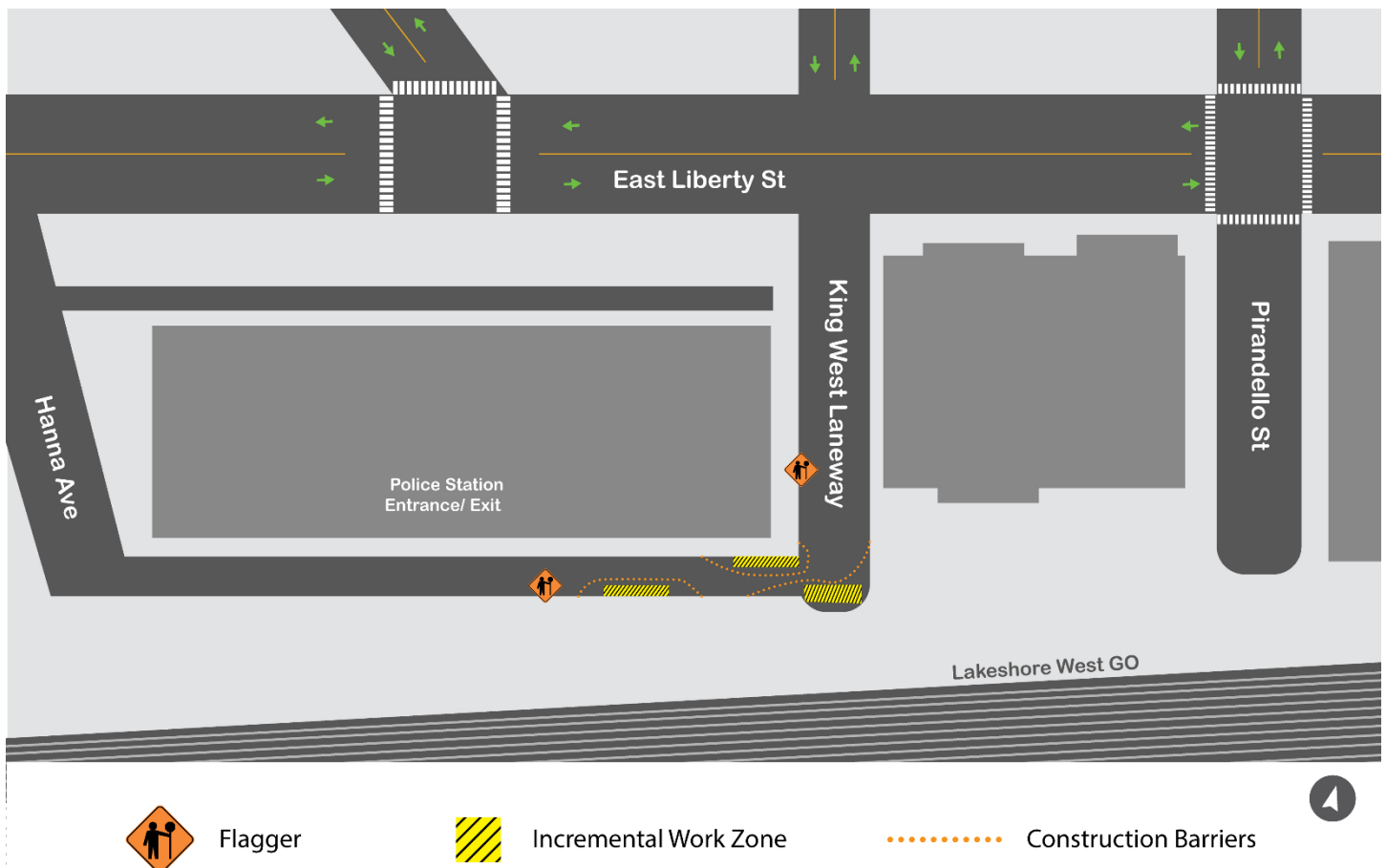

What is happening?

- Construction crews will be installing three different monitoring devices in the areas shown in yellow on the map above, on King West Laneway south of the Toronto Police Traffic Services building in Liberty Village.
- Over the course of 2 weeks, installations will happen individually, with the laneway being reduced to accommodate work, one section at a time.
- Once a monitoring device is installed, work crews will re-open the lane and move to the next location.
- Crews will complete different individual segments of work, moving within the various locations identified on the map.
- Construction pylons will be used to create visible barriers on King West Laneway, around work zones.
- For investigative works, drilling is necessary to test and visualize the utilities and ground conditions under the street for future construction of the Ontario Line delivery to Exhibition Station.

What to expect

- The work is scheduled to begin as early as August 5, 2024, and anticipated to be completed by August 15, 2024.
- Work will take place during weekdays, (Monday-Friday), between 7 a.m. and 7 p.m.
- Crews are expected to be onsite prior to 7 a.m. to set up equipment.
- Area residents and businesses can expect to hear noise from work equipment, specifically hydrovac trucks and saw cutting tools as required. Crews will take measures to minimize noise impacts wherever possible.
- All closures for work are temporary and intermittent; areas will only be closed while crews are surveying the specific areas. The areas will be returned to public use upon completion of the monitoring device installation.

About the Ontario Line

- 15.6-kilometre subway line that will make it faster and easier to travel within Toronto and beyond.
- 15 stops and more than 40 connections to other transit, including GO train, subway, LRT, streetcar, and bus lines.
- Less than 30 minutes from one end of the line to the other.
- 28,000 fewer car trips each day.

Contact us:

Call us 24/7 at: [416-202-5100](tel:416-202-5100)

Write to us at: ontarioline@metrolinx.com

Find us on X, Facebook, and Instagram: [@ontarioline](https://www.instagram.com/ontarioline)

Visit the website: www.metrolinx.com/ontarioline

Visit our community offices:

770 Queen Street East (near Queen & Broadview)

General hours:

Mondays, Tuesdays, and Fridays: 9:00 a.m. to 5:00 p.m.

Wednesdays and Thursdays: 10:00 a.m. to 6:00 p.m.

Thorncliffe Park:

East York Town Centre

45 Overlea Blvd., Toronto, ON M4H 1C3
Unit 153 (across from the Rogers store)

General hours:

Monday – Friday, 9 a.m. – 5 p.m.