

EXTENDED: Toronto Hydro Duct Bank Installation Pape Avenue between Riverdale and Langley

Start Date: July 15, 2024

Expected Completion: **NOTE: Work has been extended until late September 2024**

Hours of work: Weekdays, 7 a.m. to 11 p.m., Weekends 9 a.m. to 7 p.m.

What is happening?

- Since July 15, Toronto Hydro crews have been working to install duct banks under Pape Avenue between Riverdale and Langley.
- **Due to unforeseen conditions, this work has been extended from its original completion date of late August until late September.**
- During the extended duration, crews will open the west side of Pape to northbound traffic whenever possible. The lane will have to be closed intermittently to accommodate work activities.

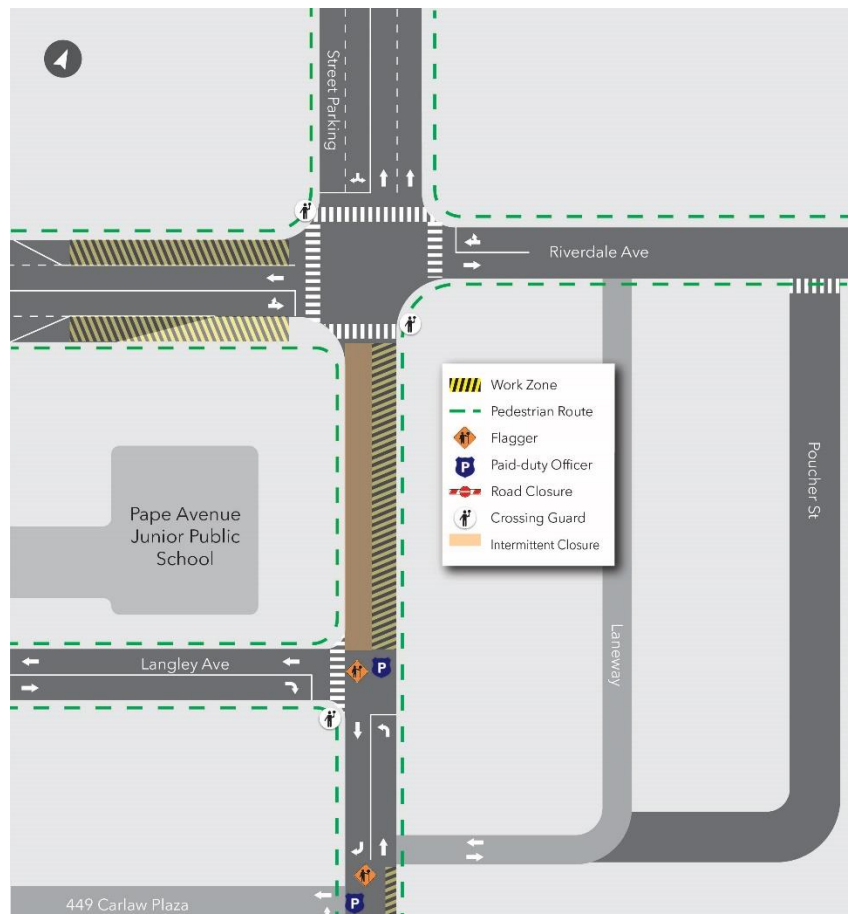

What to expect:

Construction

- Work will involve the use of excavators and a hydrovac truck. This is a requirement to safely protect existing utility infrastructure.
- Concrete trucks will be used to pour concrete for the duct banks being installed below the street surface.
- Residents and businesses in the area may hear noise caused by work equipment. Crews will take measures to minimize noise impacts wherever possible.
- Work may be delayed due to weather conditions or unforeseen circumstances.

Traffic and Pedestrian Details

- During the closure, vehicular access will be restricted on Pape Avenue between Langley Avenue and Riverdale Avenue.
- Vehicles travelling east on Langley Avenue must turn right (south) onto Pape Avenue and may exit via the plaza or the laneway east of Pape Avenue.
- Vehicles coming north on Pape Avenue must turn left (west) onto Langley Avenue.

- **The school pick-up drop-off (PUDO) zone on Pape Avenue is closed. A new Riverdale Avenue PUDO will be open for September 3. In addition to on-street signage, Metrolinx is coordinating with the TDSB to communicate this shift to parents in advance of the school year.**
 - See graphic below for a depiction of the Riverdale pick-up drop-off.
- Pedestrian routes will remain open around the work zone.
- Fencing will be erected to separate work zones from the public.
- Access to residences will always be maintained.

Safety

- Paid duty officers and/or traffic control personnel will be on-site managing traffic and pedestrian flow.
- Signage will be posted around the site to direct pedestrians.
- Equipment may be left on site but will be properly secured and stored to ensure safety.
- Emergency medical services and garbage disposal services will be allowed to progress through the closure areas when required.
- Dust will be mitigated by misting, sweeping and/or the use of a hydrovac truck. After-hours security will be onsite between 7 p.m. and 7 a.m. to ensure equipment and materials are not tampered with.

Riverdale Pick-up Drop-off (PUDO)

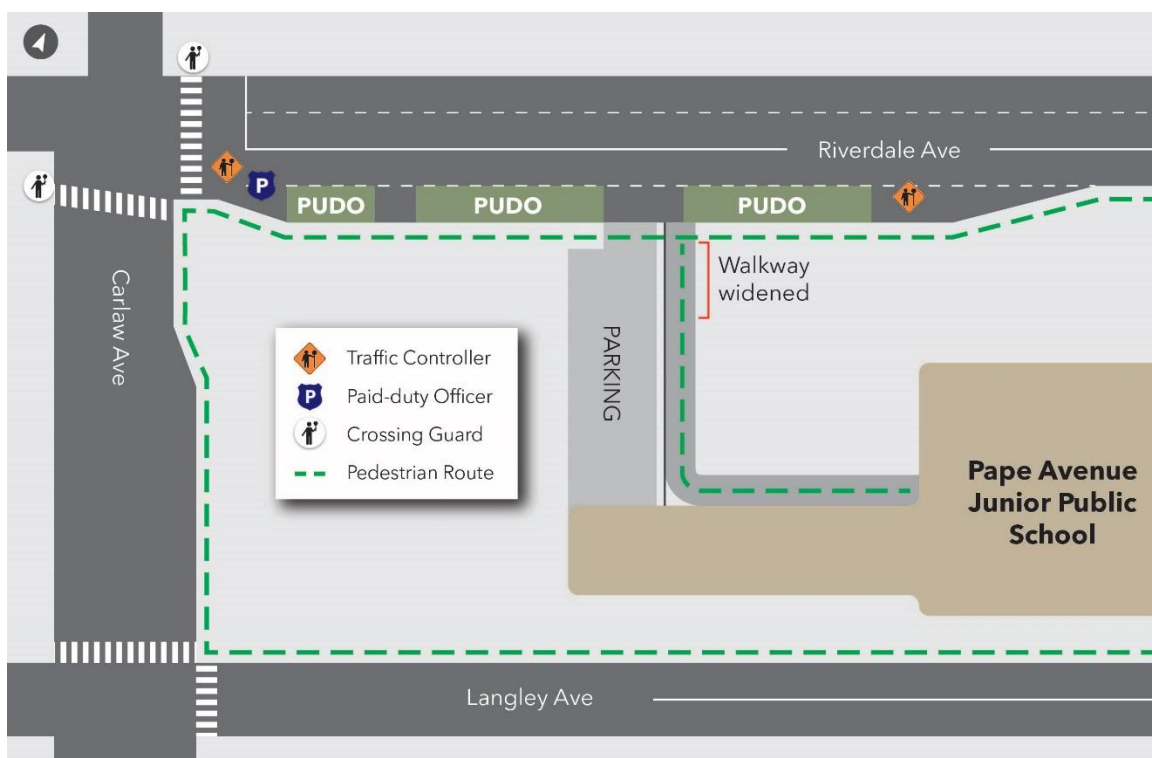

Contact us:

Call us 24/7 at: [416-202-5100](tel:416-202-5100)

Write to us at: ontarioline@metrolinx.com

Find us on Twitter, Facebook, and Instagram: [@ontarioline](https://www.instagram.com/ontarioline)

Visit the website: www.metrolinx.com/ontarioline

Visit our community offices:

Riverside:

770 Queen St. E, Toronto, ON, M4M 1H4

General hours:

- Mondays, Tuesdays and Fridays: 9 a.m. to 5 p.m.
- Wednesdays and Thursdays: 10 a.m. to 6 p.m.

Thornccliffe Park:

East York Town Centre

45 Overlea Blvd., Toronto, ON M4H 1C3

Unit 153 (across from the Rogers store)

General hours

- Monday to Friday: 9 a.m. to 5 p.m.