

Ontario Line

Osgoode CLC Meeting

September 24, 2024



Agenda*

Welcome (5 minutes)

- Introduction
- Land acknowledgement (by Campbell House Museum)
- Action items

Presentation (30 minutes)

- York Street trackwork
- Construction updates
- Look ahead
- Community artwork program updates

Feedback and Discussion (15 minutes)

** An in-person CLC may follow a different order than a virtual CLC agenda.*



AUGUST CLC ACTION ITEMS

	ACTION ITEM	RESPONSE	STATUS
1	Metrolinx to check the York Street track work construction area.	Area was reviewed.	Complete
2	OTG check about Ground Monitoring Point at Campbell House Museum.	Monitoring point installation in progress	In progress
3	Metrolinx and OTG to share update on the Community Artwork survey responses at the next CLC meeting.	Initial survey results shared to be shared with CLC members at September meeting.	Complete

York Street Trackwork



York Street Trackwork - Construction Update

- Crews have mobilized into the final phase of work to complete the overhead wiring necessary for the operation of the 501 Queen streetcar detour.
- TTC crews will be working day and night shifts, including weekends as needed.
- The traffic configuration on Queen Street will shift as required but there will always be one lane westbound accessible for vehicles travelling westbound.
- This phase of work is expected to take 3-4 weeks to complete. Once this work is done, TTC will begin their final inspection and run a test streetcar.
- One lane northbound on York Street will be maintained. No left turns from Queen Street West onto York Street will be permitted. No left turns from York Street onto Queen Street West will be permitted.
- No right turns from the northbound lane of University Avenue onto Queen Street West will be permitted.

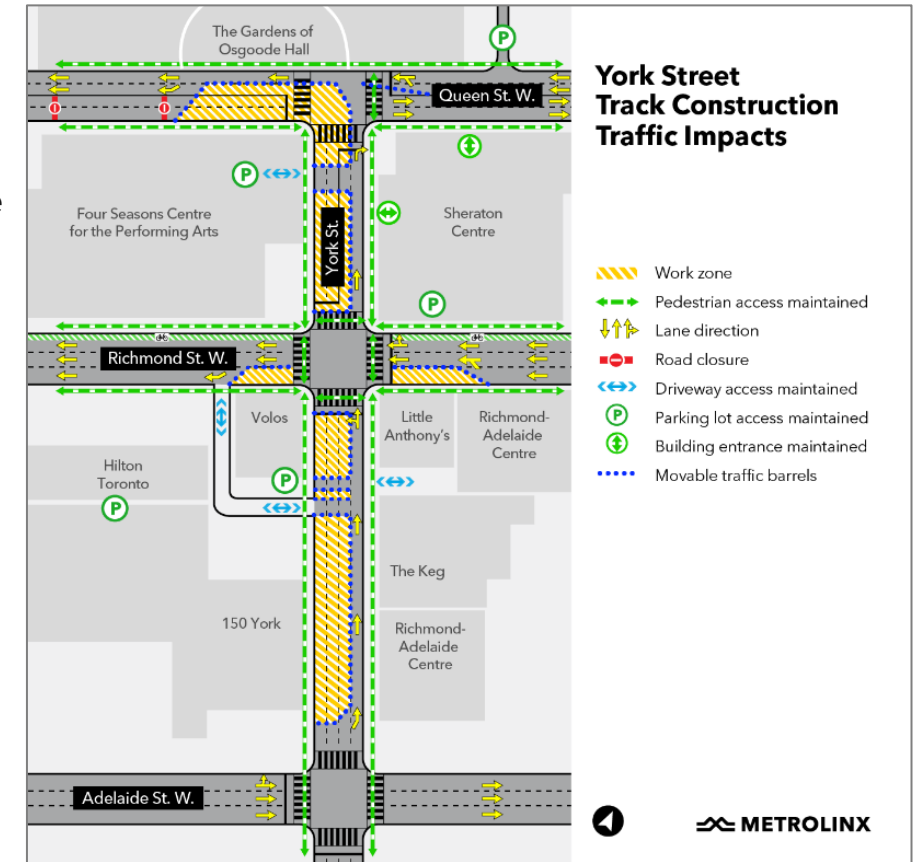



Construction Updates - OTG

Construction Update: Osgoode South

Future South station entrance

- Preparation activities for excavation continue
- Capping beam work now complete
- Acoustic shelter installation starting, beginning with foundation and concrete works



Construction Update: Osgoode South

Temporary weekend closures of Simcoe Street for crane installation work

- Crews will install a crane to support work at the South site. To do so safely, Simcoe Street will be closed from Queen Street West to the laneway directly south of the intersection.
- The closure will take place over three consecutive weekends, starting as early as Friday evening at **6:00 p.m. until Monday at 6:00 a.m.**
 - **September 27th, 28th and 29th**
 - **October 4th, 5th and 6th**
 - **October 11th, 12th and 13th**
- Pedestrian access will be maintained on the east side of Simcoe Street and on the south side of Queen Street West, with assistance from a flag person.
- Bike lane on Simcoe Street will be closed for the first two weekends, reopening for the third weekend of work.

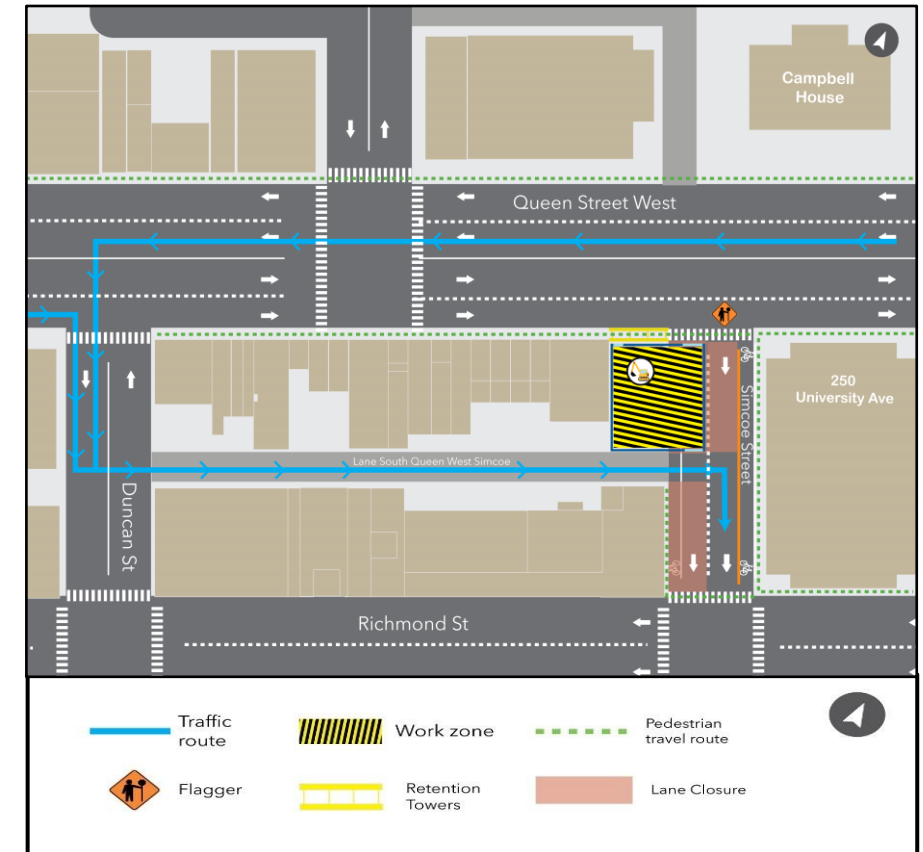

Map of the traffic road detour during the Simcoe Street Closure.

Construction Update: Osgoode North

Future North station entrance

- Piling and scaffolding work is ongoing at the future North station entrance site. Work is taking place overnight (7:00 p.m. to 7:00 a.m.) and is expected to be completed in late December 2024.
- TTC staircase demolition underway
- Utilities investigation and monitoring points installation



Piling at the North site

Construction Look Ahead

Timing	Activity	Location	Details & Purpose
Fall 2024	Ground Monitoring Point Installations + Investigations	Various	Additional ground monitoring devices installed at multiple sites throughout the Osgoode neighbourhood
Fall 2024	Excavation Preparations (including crane installation, acoustic shelter)	South site	Installation of crane for excavation and building to mitigate the impacts of noise, dirt, dust from the construction site
Late summer 2024 - spring 2025	Piling	North site	Install foundations to support future excavation of site.
Fall 2024 - spring 2025	Excavation	South site	Initiate excavation of shaft to the station level, to provide connection with future station platforms.

**All construction timelines estimated and subject to change.*

MINIMIZING IMPACTS TO THE COMMUNITY

To reduce impacts to residents and businesses in the area, mitigations will be in place including:

- Air quality monitoring to track airborne emissions to ensure that construction activities don't impact the quality of the environment.
- Continuous loop truck routes where possible, reducing need for trucks to reverse using back-up alarms.
- Street sweepers and wheel cleaning as needed to ensure soil and sediment is kept off city streets and sidewalks.
- Expanded paving of frequently used areas within the site minimizes the amount of loose soil that can be disturbed by vehicle traffic further reducing dust emissions.



Example of street sweeper

MINIMIZING IMPACTS TO THE COMMUNITY

- **Predicting noise and vibration levels** utilizing modeling and assessing against baseline conditions, in order to identify impacts and planned mitigations (e.g., hoarding and acoustic shelter).
- **Monitoring noise and vibration levels utilizing** sound meters and real-time monitoring systems, to track and control noise and vibration emissions to help minimize disturbances to the community and ensure project regulations compliance; devices are placed on neighbouring buildings within the project zone of influence.
 - Devices generate real-time alerts to allow team to monitor, track and act if needed.
 - When it comes to vibration, devices monitor potential structural impact of vibrations; personal thresholds for perception of vibrations can vary.
- **Site hoarding** to help reduce noise.
- **Acoustic shelter** to reduce noise impact of construction activities, where site working hours and footprint facilitates use.



Examples of noise monitoring devices in use.

KEEPING YOUR COMMUNITY CLEAN

Dust suppression will be **effectively managed** through the use of the following **mitigations** at site:

- **Mud Mats** provide a stable and supportive surface for over soft or unstable ground preventing vehicles and heavy equipment from sinking and reducing the amount of mud created with more frequent passage.
- **Water Suppression** assists by regularly moistening exposed soils and debris preventing dust particles from becoming airborne.
- **Acoustic Shelter** is being built at the South site to contain dirt and debris within the site.



Example of a mud mat



Example of dampening soils to suppress dust

Community Artwork: Report Summary

Community Artwork Program

A survey was conducted via SurveyMonkey was launched from July 27 to August 23, 2024, to collect community feedback regarding the selection of artwork themes for their respective neighborhoods.

Survey promotion took place at CLC meetings, social media like Instagram and LinkedIn posts, Breakfast Television, CityNews and CityNews 680, as well as door to door canvassing.



Most requested themes:

- 40.01% History
 - Historic buildings
- 31.82% Neighbourhood Attributes
 - Diversity, arts, culture

Next Steps:

- Collaborating with Metrolinx to determine partners
- Once selected, working with partners to advance artwork designs and production

Community Artwork Program

Program timeline

Timing	Activity	Details & Purpose
July - August 2024	Capturing Community Feedback	Survey to capture public feedback; survey promoted via on-the-ground marketing and CLC engagement. Survey responses being reviewed in real-time to start to identify potential partners and direction for artwork.
September 2024	Analysis and Reporting	Analysis of results by area and reporting; feedback to be shared with CLC groups in September 2024 to inform what we heard and share direction forward.
October - December 2024	Development and delivery of art	Work with artists / partners to develop and delivery artwork; timelines will vary by site and may change depending on the complexity and medium of artwork selected. Additional information on intended timelines to be shared with communities upon finalization of partners.

Community Engagement

Metrolinx will keep the community, residents and businesses informed by providing project updates, seeking input and feedback, while addressing questions and concerns effectively and quickly.

Next CLC meeting: October 23, 2024 (virtual)

Connect with us:

- Julia Orsini, Community Engagement Advisor
- Ross Andersen, Senior Advisor, Community Engagement

Email OntarioLine@metrolinx.com

Telephone 24/7 @ 416-202-5100

Ontario Line e-newsletter @ [Metrolinx.com/OntarioLine](https://metrolinx.com/OntarioLine)

Follow us on social media:

Twitter / Facebook / Instagram @OntarioLine



Our Community Office at 770 Queen Street East, which is the closest office to the Osgoode Station.