

Upcoming Geotechnical and Utilities Work on Pape Avenue and Surrounding Streets

Fall 2024 and Winter 2025

Hours of work: Monday to Friday: 7 a.m. – 7 p.m.

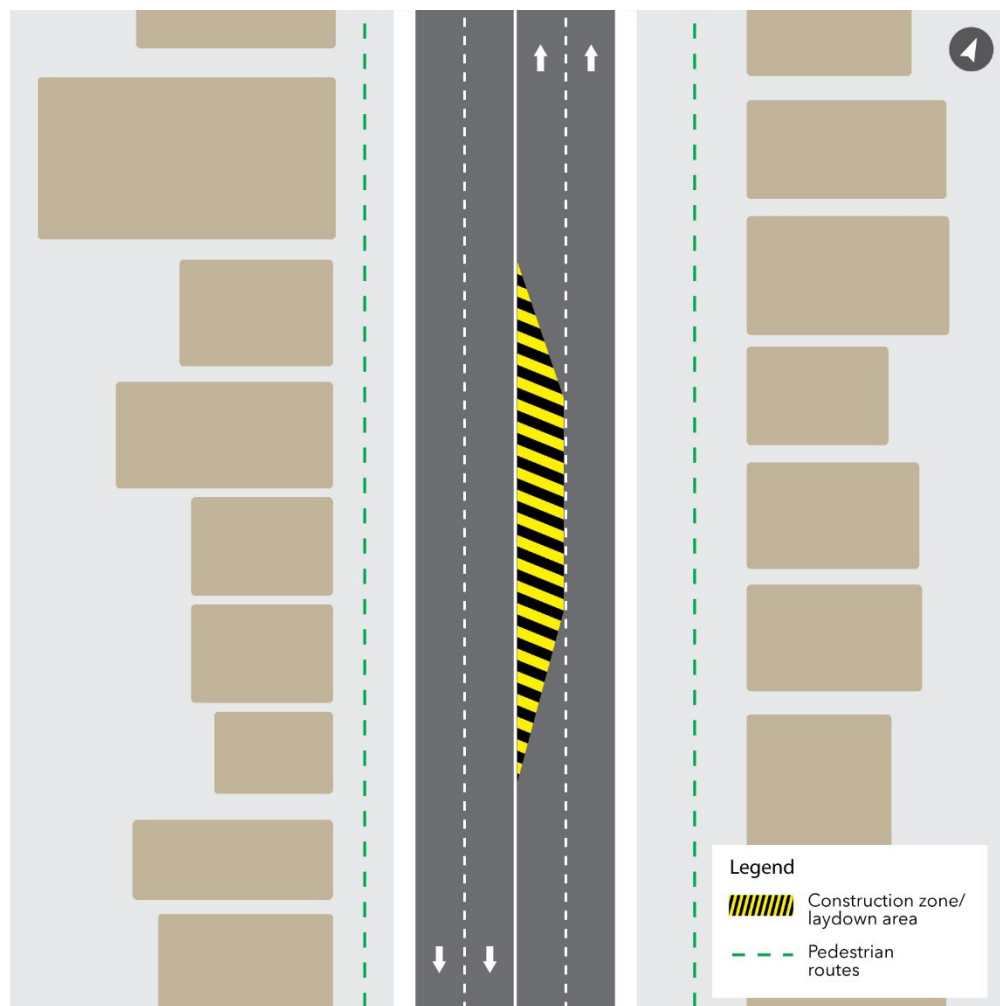

Figure 1: Typical four-lane road occupancy for subsurface utility investigations

What is happening?

- To enable future construction activities for the Pape Tunnel and Underground Stations (PTUS) portion of the Ontario Line project, the following investigations will take place in the upcoming months, through to spring of 2025.

Geotechnical Investigations (As early as the week of November 25, 2024):

- Crews will be conducting geotechnical investigations along Pape Avenue and surrounding streets from Langley Avenue in the south to O'Connor Drive in the north. The locations are within the road and sidewalk or on Metrolinx-owned properties.
- The investigations consist of drilling boreholes and installing monitoring wells. Geotechnical investigations are essential to understand soil and rock properties, minimize construction risk and protect nearby buildings and infrastructure.

Subsurface Utilities Investigations (As early as the week of November 25, 2024):

- Crews will be conducting underground utility mapping along Pape Avenue and the surrounding streets. The investigations will take place within the road and sidewalk.
- The investigations will use locating tools, measuring tools and global positioning tools (GPS) to identify underground utilities. Underground utilities will be marked using temporary spray paint and chalk.
- Utilities investigations are essential to understand the location and position of utilities that exist near the future Ontario Line tunnel alignment.

What to expect

Geotechnical and Subsurface Utilities Investigations:

- Drilling and excavation equipment, such as drill rigs and water hauling, hydrovac, concrete, and coring trucks will be on site.
- During the vertical drilling phase, noise, dust, and vibration from construction equipment is expected.
- Lane and sidewalk closures are planned. Lane and sidewalk closures will only affect one direction at a time. Vehicular access to residential and commercial driveways will be maintained. Some on-street parking spaces will be affected during working hours.
- Noise and vibration monitors will be in place. These devices will help us identify any issues early and take corrective actions as needed.
- TTC bus and streetcar service will be maintained throughout the work.
- Signage and safety barriers will be in place to delineate work zones.
- Work will take place during the day, from 7 a.m. to 7 p.m.
- Timing of construction is subject to weather conditions and construction constraints.
- Paid duty officers and/or traffic control personnel will be on-site managing traffic and pedestrian flow.
- Signage will be posted around the site to direct pedestrians.
- Equipment may be left on site but will be properly secured and stored to ensure safety.
- Dust will be mitigated by misting, sweeping and/or the use of a hydrovac truck.

We will continue to assess impacts and provide neighbourhood notices in advance of any work to keep you up to date and informed. For more information about upcoming work, please see metrolinx.com/ontarioline or sign up for the e-newsletter.

About the Project

- 15.6-kilometre subway line that will make it faster and easier to travel within Toronto and beyond.
- 15 stops and more than 40 connections to other transit, including GO train, subway, LRT, streetcar, and bus lines.
- Less than 30 minutes from one end of the line to the other.
- 28,000 fewer cars on the road each day.

Contact us:

Call us 24/7 at: [416-202-5100](tel:416-202-5100)

Write to us at: ontarioline@metrolinx.com

Find us on Twitter, Facebook, and Instagram: [@ontarioline](#)

Visit the website: www.metrolinx.com/ontarioline

Visit our community offices:

Riverside:

770 Queen St. E, Toronto, ON, M4M 1H4

General hours:

- Mondays, Tuesdays and Fridays: 9 a.m. to 5 p.m.
- Wednesdays and Thursdays: 10 a.m. to 6 p.m.

Thornccliffe Park:

East York Town Centre

45 Overlea Blvd., Toronto, ON M4H 1C3

Unit 153 (across from the Rogers store)

General hours:

- Monday to Friday: 9 a.m. to 5 p.m.

Disponible en français sur demande. Si vous êtes intéressé, veuillez envoyer un courriel à ontarioline@metrolinx.com.