

# Lakeshore East Rail Corridor: Weekly In-Corridor Work Update

Update for the weeks of: Saturday, November 23 - Saturday, December 7, 2024

**Hours of work:**

- Daytime: Monday- Friday, with occasional weekend work, from 7 a.m.- 7 p.m.
- Overnight: Monday - Sunday from 8 p.m.- 5 a.m. (nights of work depend on activity - further details below).

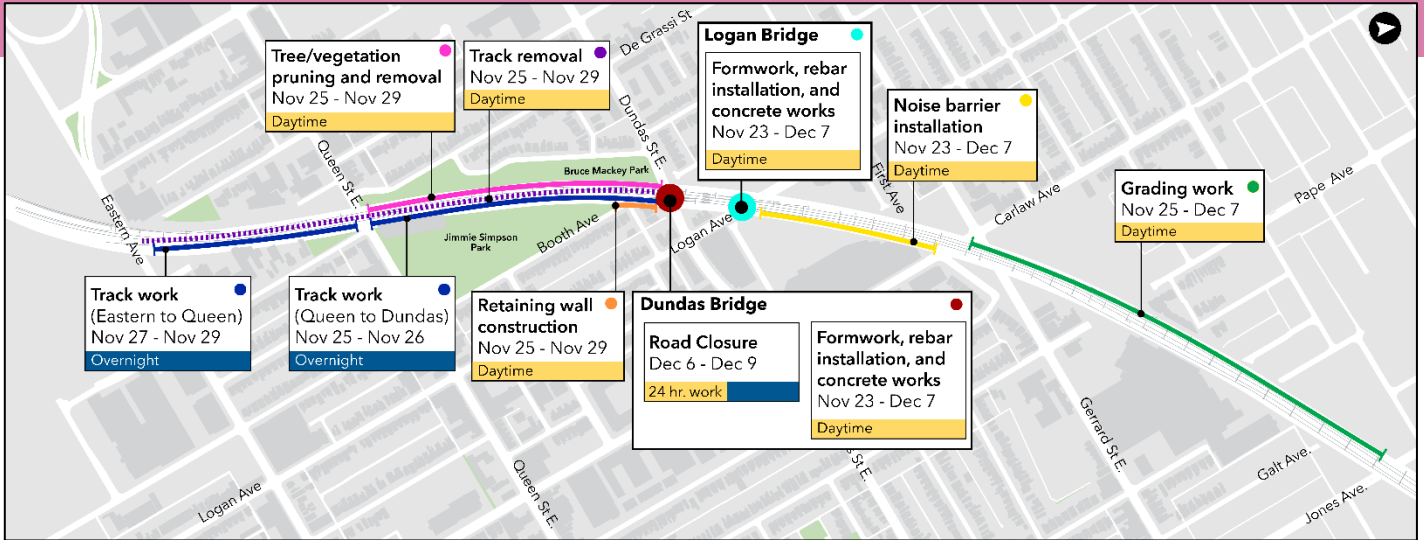

**This notice provides an update on the work happening in the rail corridor over the next two (2) weeks. It is updated every Friday.**

**What is happening?**

Construction work is underway in the Lakeshore East rail corridor to prepare for the future Ontario Line. This notice provides a progress update on the works taking place in the rail corridor. **Certain construction activities may cause noise and vibration at nearby properties. For further details, please carefully review the information provided in the table below.**

Overnight Work (Monday - Sundays, 8 p.m. - 5 a.m.)		
Date	Location	Activity
<ul style="list-style-type: none"> <li>Monday November 25 - Friday November 29, 2024</li> </ul>	<p><b>Mon Nov 25 - Tues Nov 26:</b> Within the rail corridor between Queen St. E. and Dundas St. E.</p> <p><b>Wed Nov 27 - Fri Nov 29:</b> Within the rail corridor between Eastern Ave. and Queen St. E.</p>	<p><b>NEW ACTIVITY: Track work</b> Welding track ties and installing track protection barriers. This work is taking place on the live tracks and therefore must take place at night to maintain GO train service.</p>
<ul style="list-style-type: none"> <li>Friday, December 6 at 8 p.m. until Monday, December 9, 2024, at 6 a.m.</li> </ul>	<p>Dundas St. E. between Broadview Ave. and Logan Ave.</p>	<p><b>Dundas Road Closure</b> Dundas St. E. will be closed underneath the rail bridge to install girders (steel beams) for the new bridge.</p>

Daytime/Evening Work Monday- Friday, with some weekend work as noted below, from 7 a.m.- 7 p.m.		
Date	Location	Activity
<ul style="list-style-type: none"> <li>Saturday November 23 - Saturday December 7, 2024</li> </ul>	<p>Dundas and Logan bridges</p>	<p><b>Formwork, rebar installation, and concrete works</b></p> <ul style="list-style-type: none"> <li>• Sat Nov 23 and Sun Nov 24 there will be formwork and steel installations at Dundas and Logan bridges</li> <li>• The sidewalk on the east side of Dundas St. E. will be closed on Wed Nov 27 to complete a concrete pour</li> </ul>
<ul style="list-style-type: none"> <li>Monday November 25 - Friday November 29, 2024</li> </ul>	<p>Booth Ave. and Paisley Ave.</p>	<p><b>Retaining wall construction</b> Placing concrete blocks, backfilling, and compaction work *Residents in nearby properties may feel vibrations during compaction work; noise and</p>

		vibration monitoring is in place to ensure regulatory limits are maintained.
● Saturday November 23 - Saturday December 7, 2024	Within the rail corridor between Logan Ave. and Carlaw Ave.	<b>Noise barrier installation</b> Drilling foundations, grading, and installing noise barrier panels.
● Monday November 25 - Friday November 29, 2024	Within the rail corridor between Eastern Ave. and Dundas St. E.	<b>Track Removals</b> Cutting tracks with rail saws, disassembling rail, loading cut rail into bins, and hauling materials off site.
● Monday November 25 - Friday November 29, 2024	On the north side of the rail corridor between Queen St. and Dundas St. E.	<b>Tree/Vegetation Pruning and Removals</b> Removing and pruning trees and vegetation <u>with the Lakeshore East rail corridor</u> . Work will start at Eastern Ave. and progress towards Dundas St. E.
● Monday November 25 - Saturday December 7, 2024	Within the rail corridor between Carlaw Ave. and Jones Ave.	<b>Grading work</b> Leveling and laying track ballast and granular material

### What to Expect

- Overnight work is required to complete activities that construction crews cannot do safely while trains are active and running in the corridor.
- Excavators, trucks, compactors, loaders, skid steers, and mobile cranes will be used to complete daytime work activities.
- Residents in nearby properties may experience noise and vibration from the work; monitoring is in place to ensure levels stay within acceptable limits.
- Various mitigation measures will be implanted to reduce disruption.
- Overnight site lighting will be positioned downward into the rail corridor and away from residential properties.
- Construction equipment and materials will be secured within the work zones.
- Work may be rescheduled due to inclement weather and/or unforeseen circumstances.
- Work locations are subject to change and may vary based on site conditions and/or schedule requirements.

### About the project

- 15.6-kilometre subway line that will make it faster and easier to travel within Toronto and beyond.
- 15 stops and more than 40 connections to other transit, including GO train, subway, LRT, streetcar and bus lines.
- Approximately 30 minutes from one end of the line to the other.
- 28,000 fewer cars on the road each day.

#### Contact us:

Call us 24/7 at: [416-202-5100](tel:416-202-5100)  
Write to us at: [ontarioline@metrolinx.com](mailto:ontarioline@metrolinx.com)  
Find us on Twitter, Facebook, and Instagram: [@ontarioline](https://www.instagram.com/ontarioline)  
Visit the website: [www.metrolinx.com/ontarioline](http://www.metrolinx.com/ontarioline)

#### Visit our community offices:

**770 Queen Street East (near Queen & Broadview)**  
General hours:  
Mondays, Tuesdays, and Fridays: 9:00 a.m. to 5:00 p.m.  
Wednesdays: 1:00 p.m. to 6:00 p.m.  
Thursdays: 10:00 a.m. to 6:00 p.m.

#### Thorncliffe Park:

East York Town Centre  
45 Overlea Blvd., Toronto, ON M4H 1C3  
Unit 153 (across from the Rogers store)  
General hours:  
Monday - Friday, 9 a.m. - 5 p.m.