

# Watermain Valve Installation at Leaside Park Drive and Overlea Boulevard with Temporary Water Shut-Off

**Expected Work Period:** 7:00am on Wednesday, December 11, 2024 through 6:30am on Thursday, December 12, 2024

**Water Shut-Off Window:** 11:00pm on Wednesday, December 11, 2024 overnight to 6:30am on Thursday, December 12, 2024

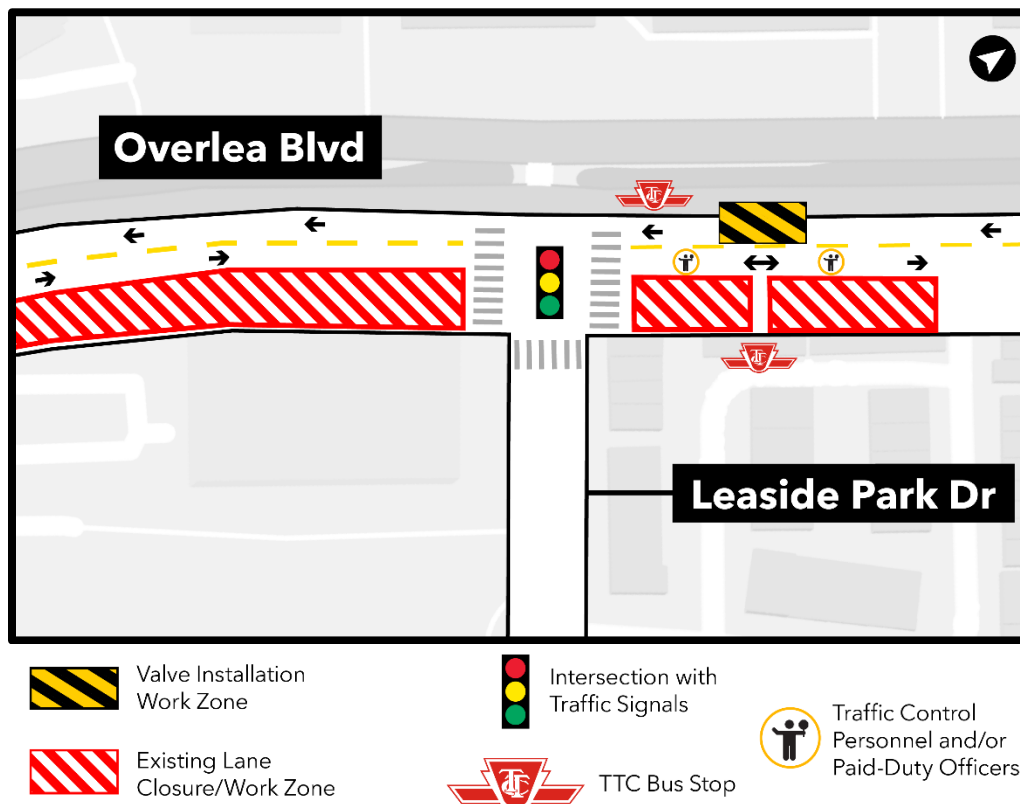

***Prior to the temporary water shut-off, those living or working in the impacted properties should store water for their use overnight.***

## Impacted Properties

The following properties will specifically be impacted by the temporary water shut-off. Water service will be interrupted at approximately 11:00pm and will be restored by 6:30am.

- 1 and 5 Leaside Park Drive
- Leaside Park Drive townhouse complex
- 11 and 21 Redway Road
- 1-3 Banigan Drive
- 1 Laird Drive
- 2, 4-8 and 14-16 Overlea Boulevard
- 1070, 1073, 1075, 1080, 1100 Millwood Road

## What is happening?

- To prepare water utility infrastructure for future stages of Ontario Line construction, crews will be installing gate valves on the watermain that runs underneath Overlea Boulevard at Leaside Park Drive.
- To safely put the new valves into service, water will be temporarily shut off overnight at nearby properties that are supplied by the watermain.
- The temporary interruption to water service will begin at approximately 11:00pm on Wednesday, December 11 and end by 6:30am on Thursday, December 12. Please plan accordingly.

## What to expect

- The curbside lane on the north side of Overlea Boulevard will be closed for portions of the work period in order to install the gate valves on the watermain under the roadway. During these times, drivers may be asked to briefly queue while traffic in the opposite direction is allowed through the open lane. Please follow all directions of all traffic control personnel and paid-duty officers and drive with care through the work zone.
- The sidewalk on the north side of Overlea Boulevard may be intermittently closed. Detour signage will be in place when the sidewalk is closed.
- Impacts to TTC bus service are not anticipated.
- Construction equipment and materials will be properly secured within the work zones.
- Work will be conducted using hydro-vacuum trucks, excavators, trucks, and other equipment.
- Noise, vibration, and air quality/dust impacts from the equipment listed are expected to be minimal and will be actively monitored and mitigated as needed.
- This work is being carried out in close collaboration with Toronto Water, and all required permits have been obtained from the City of Toronto for this work.
- This work may be delayed due to weather conditions and/or unforeseen circumstances.

## About the Ontario Line

- 15.6-kilometre subway line that will make it faster and easier to travel within Toronto and beyond.
- 15 stops and more than 40 connections to other transit, including GO train, subway, LRT, streetcar, and bus lines.
- Less than 30 minutes from one end of the line to the other.
- 28,000 fewer cars on the road each day.

### Contact us:

Call us 24/7 at:

Write to us at: [ontarioline@metrolinx.com](mailto:ontarioline@metrolinx.com)

Find us on X(Twitter), Facebook, and Instagram:

[@ontarioline](#)

Visit the website: [www.metrolinx.com/ontarioline](http://www.metrolinx.com/ontarioline)

### Visit our community offices:

#### Riverside:

770 Queen St. E, Toronto, ON, M4M 1H4

General hours:

- Mondays, Tuesdays and Fridays: 9 a.m. to 5 p.m.
- Wednesdays and Thursdays: 10 a.m. to 6 p.m.

#### Thornccliffe Park:

East York Town Centre

45 Overlea Blvd., Toronto, ON, M4H 1C3

Unit 153 (across from the Rogers store)

General hours

- Monday to Friday: 9 a.m. to 5 p.m.

Disponibile en français sur demande. Si vous êtes intéressé, veuillez envoyer un courriel à [ontarioline@metrolinx.com](mailto:ontarioline@metrolinx.com)