

# Tower crane delivery and installation at Moss Park

**Expected delivery:** As early as January 13, 2025

**Hours of work:** 7:00 a.m. to 7:00 p.m.

## Map of work area:

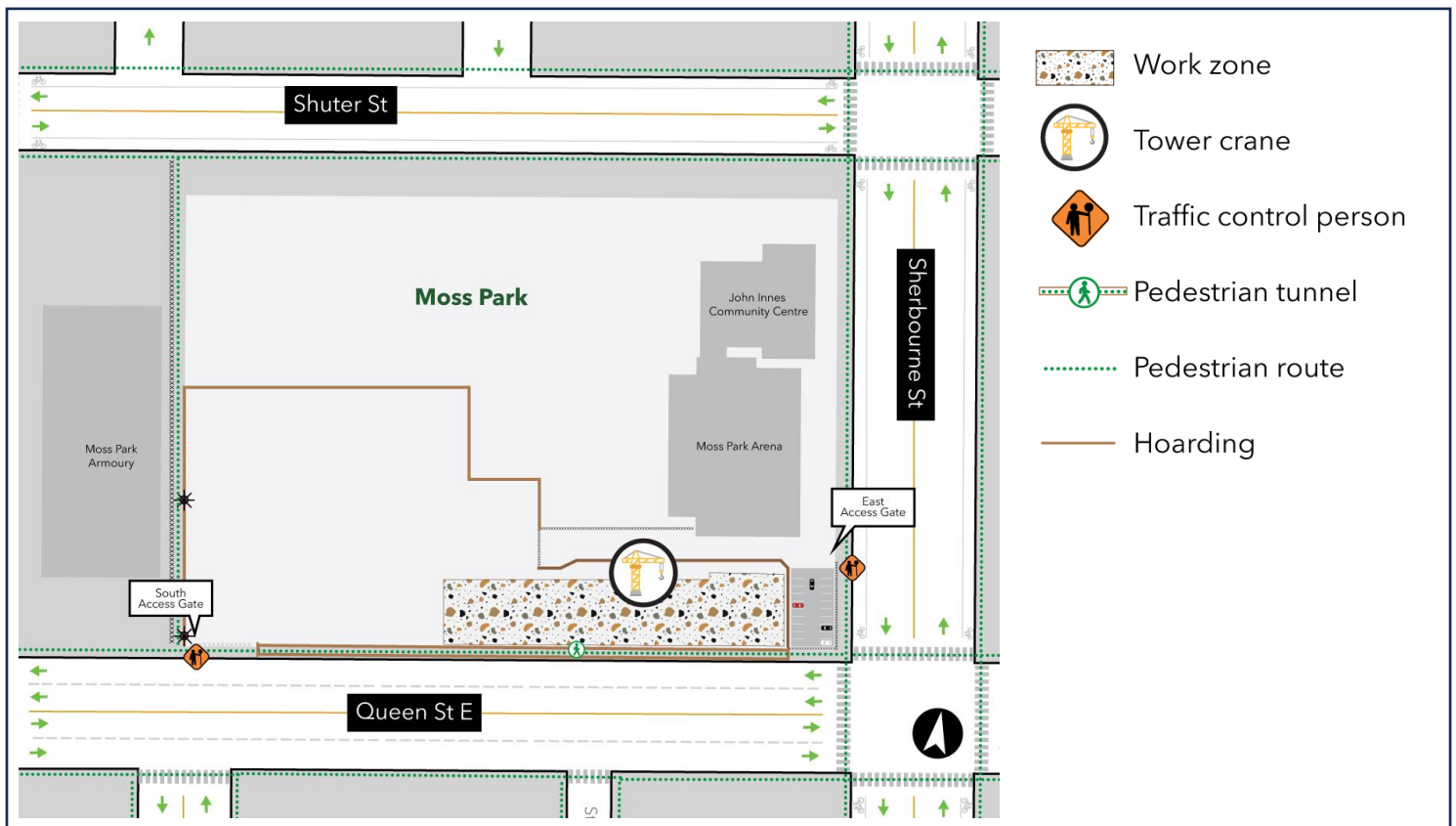

## What is happening?

As part of ongoing construction of the Ontario Line and the future Moss Park station, crews will be delivering and installing a tower crane to support construction at the future Moss Park station.

Several flat bed trucks will deliver the tower and mast components of the crane in pieces to Moss Park. Following delivery, crews will assemble the crane onsite; this may take several days. The delivery requires traffic controls and an escort vehicle to guide the flatbed trucks to the site and to maintain safe operations and passage for vehicles and pedestrians on Queen Street East.

The delivery of the tower crane to Moss Park is anticipated as early as Friday, January 13, 2025, with installation on-site to follow. Crews will take measures to minimize noise impacts wherever possible.

The tower crane is expected to be operational as early as mid-January, 2025 (after assembly period).

Daily inspections will be carried out to ensure the stability and integrity of the crane. The tower crane will remain on site for the duration of the station construction.

---

## What to expect

- Tower crane will be delivered to the future Moss Park station as early as Friday, January 13<sup>th</sup>, 2024.
- This operation will be supported by an escort vehicle and traffic control persons who will guide pedestrians and cyclists safely.
- Assembly and installation of tower crane components, including the operator cab and mast will be completed entirely within the site.
- Tower crane will be tested and commissioned prior to usage.
- Daily inspections will be carried out to ensure the safe operation of the tower crane.
- Work may be postponed or rescheduled due to unforeseen circumstances.
- All necessary construction permits have been obtained.
- For more information about upcoming station work please see [metrolinx.com/Ontarioline](https://www.metrolinx.com/Ontarioline) or sign up for the e-newsletter.

---

## About the Ontario Line

- 15.6-kilometre subway line that will make it faster and easier to travel within Toronto and beyond.
- 15 stops and more than 40 connections to other transit, including GO train, subway, LRT, streetcar, and bus lines.
- Less than 30 minutes from one end of the line to the other.
- 28,000 fewer cars on the road each day.

### Contact us:

Call us 24/7 at: [416-202-5100](tel:416-202-5100)

Write to us at:

[ontarioline@metrolinx.com](mailto:ontarioline@metrolinx.com)

Find us on X, Facebook, and Instagram:

[@ontarioline](https://www.instagram.com/ontarioline)

Visit the website:

[www.metrolinx.com/ontarioline](https://www.metrolinx.com/ontarioline)

### Visit our community offices:

#### 770 Queen Street East (near Queen & Broadview)

General hours:

Mondays, Tuesdays, and Fridays: 9:00 a.m. to 5:00 p.m.

Wednesdays: 1:00 p.m. to 6:00 p.m.

Thursdays: 10:00 a.m. to 6:00 p.m.

#### Thorncliffe Park:

East York Town Centre

45 Overlea Blvd., Toronto, ON M4H 1C3

Unit 153 (across from the Rogers store)

General hours:

Monday - Friday, 9 a.m. - 5 p.m.