

Construction sewer connection work on Berkeley Street

Expected start date: As early as January 27, 2025

Expected duration: Five (5) days

Hours of work: 7:00 a.m. to 7:00 p.m. (weekdays, Monday to Friday)

Map of work area:

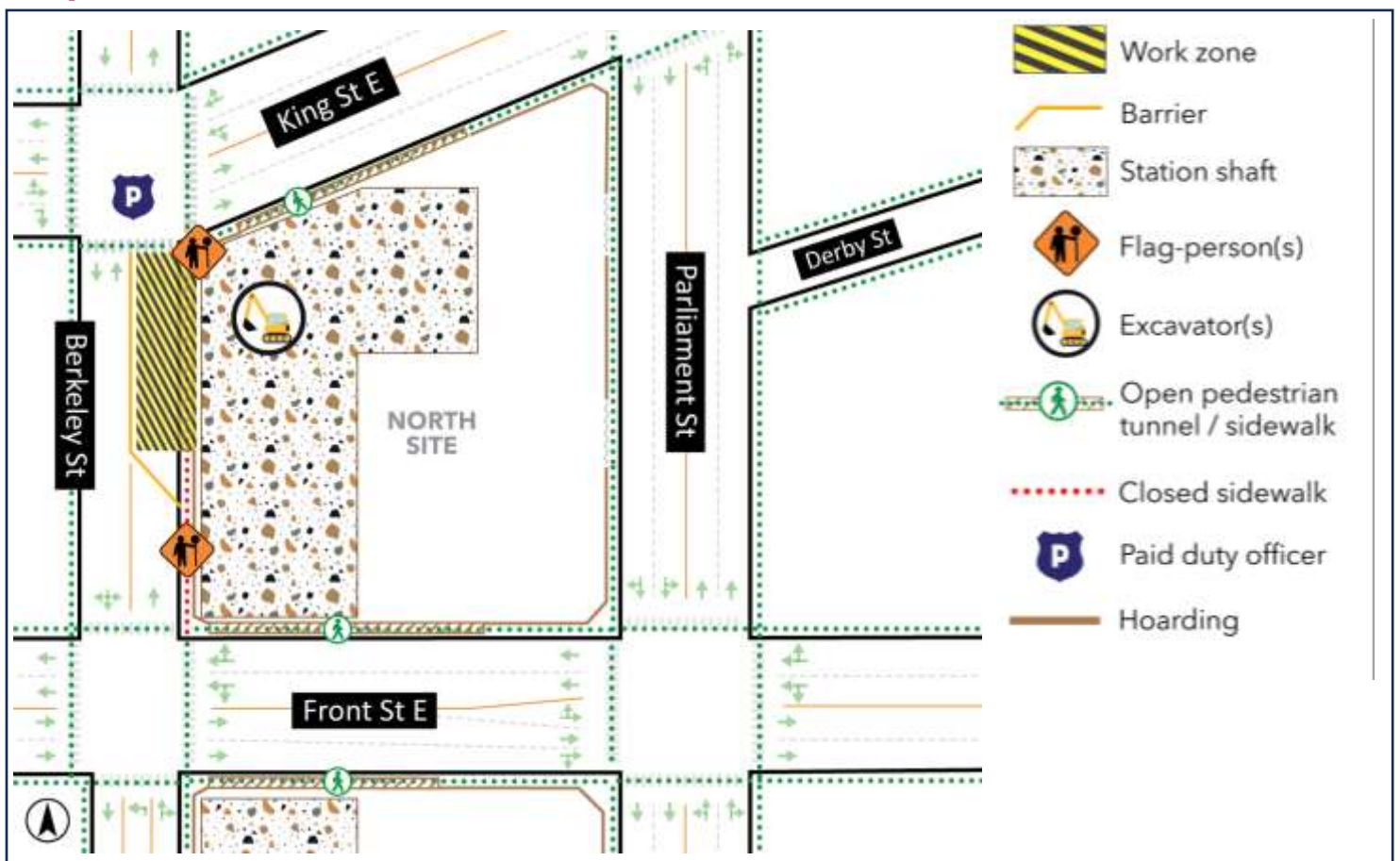

What is happening?

As part of ongoing construction of the Ontario Line and the future station site at the Corktown sites, crews will be connecting below-ground sewer infrastructure.

The work will be carried out over a five-day period and will require a temporary lane closure in the on Berkeley Street and a pedestrian sidewalk detour during the work period.

What to expect

- Temporary full closure of the northbound traffic lane on Berkeley Street northbound, and the east sidewalk on Berkeley Street between Front Street East and King Street East **for five (5) days starting Monday January 27 to Friday, January 31, 2025, between 7:00 a.m. to 7:00 p.m.**
- Paid duty officers and traffic flag-persons will assist with pedestrian, cyclist and vehicular traffic, with two-way traffic maintained at all times.
- The northbound lane and east sidewalk will be fully accessible between 7:00 p.m. and 7:00 a.m.
- Crews are expected to be on-site prior to 7:00 a.m. to set-up equipment.
- Residents will see equipment moving around the work zone and hear construction noise from various machinery including saw cutting equipment and hydrovac trucks required to carry out exposure of underground utilities.
- To reduce the impact to residents and businesses in the area, mitigation measures have been put into place, which include water suppression, noise and vibration monitoring, no overnight work.
- Signage will be in place to assist transit users, pedestrians and traffic through the work zones.
- Work may be postponed or rescheduled due to unforeseen circumstances.
- Additional work hours may be required to allow teams to complete consecutive works.
- All necessary construction permits have been obtained.
- For more information about upcoming station work please see [metrolinx.com/Ontarioline](https://www.metrolinx.com/Ontarioline) or sign up for the e-newsletter.

About the Ontario Line

- 15.6-kilometre subway line that will make it faster and easier to travel within Toronto and beyond.
- 15 stops and more than 40 connections to other transit, including GO train, subway, LRT, streetcar, and bus lines.
- Less than 30 minutes from one end of the line to the other.
- 28,000 fewer cars on the road each day.

Contact us:

Call us 24/7 at: [416-202-5100](tel:416-202-5100)

Write to us at:

ontarioline@metrolinx.com

Find us on X, Facebook, and Instagram:

[@ontarioline](https://www.instagram.com/ontarioline)

Visit the website:

www.metrolinx.com/ontarioline

Visit our community offices:

770 Queen Street East (near Queen & Broadview)

General hours:

Mondays, Tuesdays, and Fridays: 9:00 a.m. to 5:00 p.m.

Wednesdays: 1:00 p.m. to 6:00 p.m.

Thursdays: 10:00 a.m. to 6:00 p.m.

Thorncliffe Park:

East York Town Centre

45 Overlea Blvd., Toronto, ON M4H 1C3

Unit 153 (across from the Rogers store)

General hours:

Monday – Friday, 9 a.m. – 5 p.m.