

**POINT RAIL MACHINING SEQUENCE**

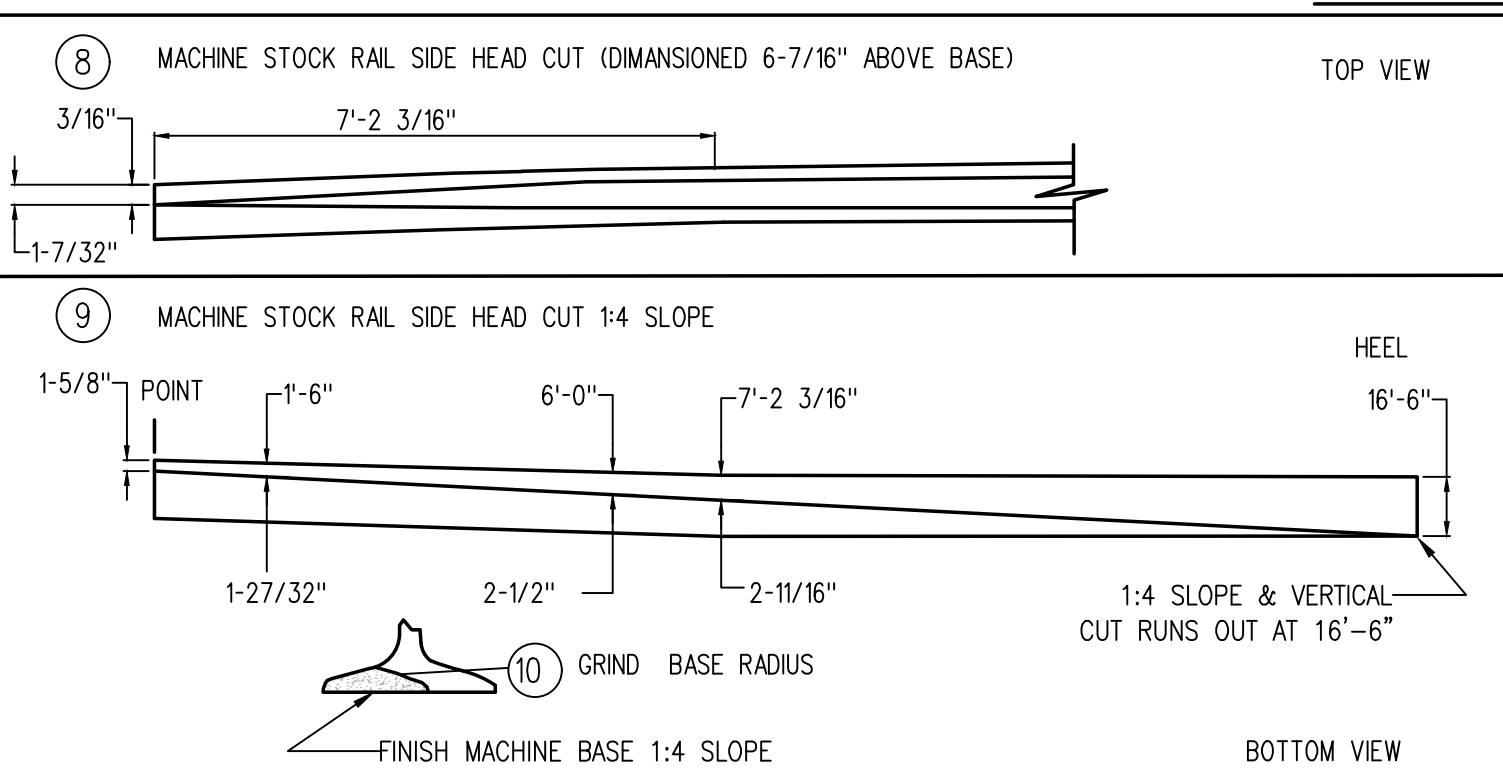

- ⑪ GRIND KNIFE EDGE AT POINT, SEE SECTIONS A-A TO E-E AND RADIUS HEAD CUTS
- ⑫ ASSEMBLE BOLTS, CLIPS, STOPS & TAG AS PER GTS-383
- ⑬ REALIGN OR STRAIGHTEN POINT FROM MACHINE WARP-CHECK FOR 1-1/2" BEND

**LEFT HAND POINT**

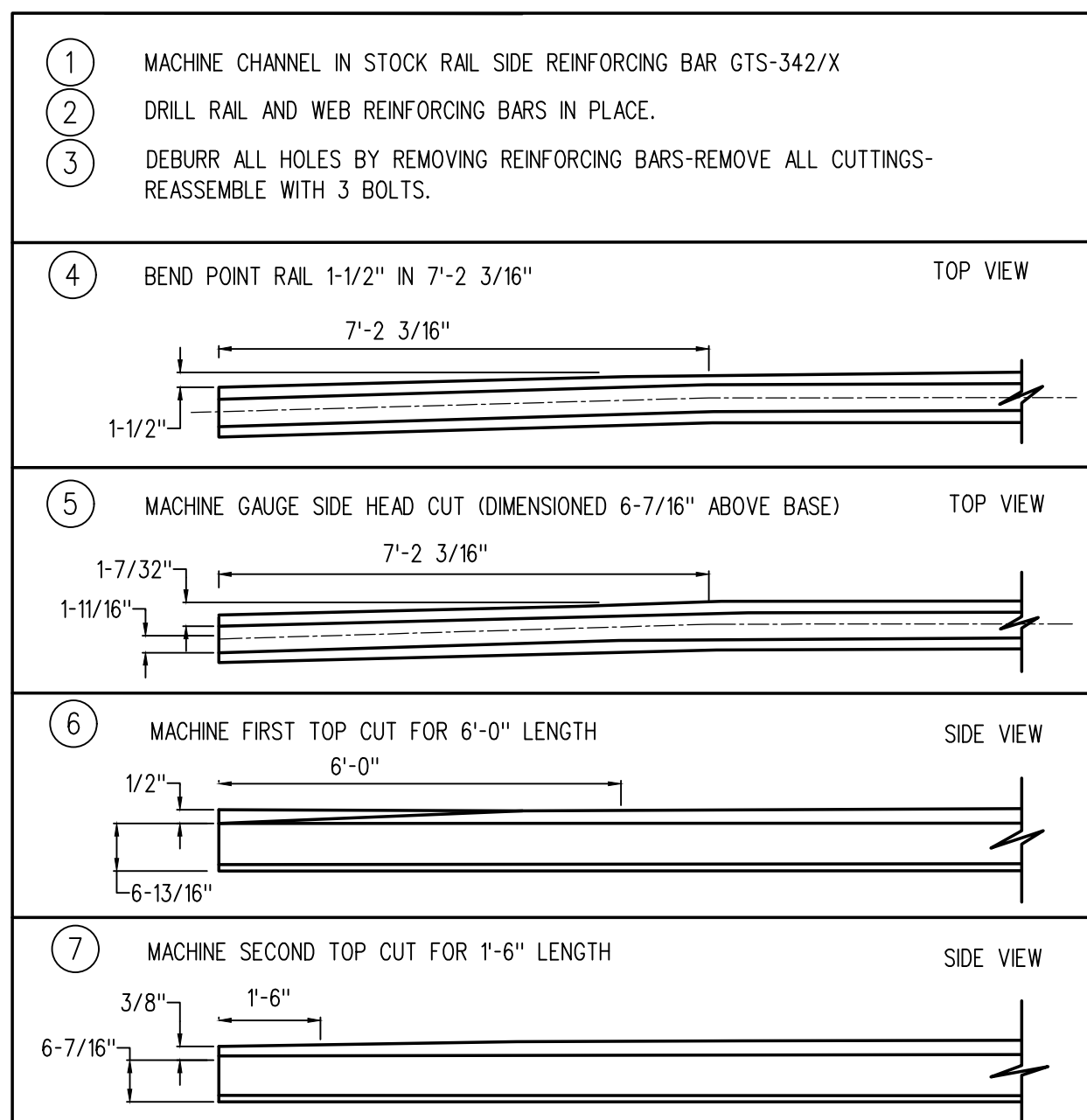
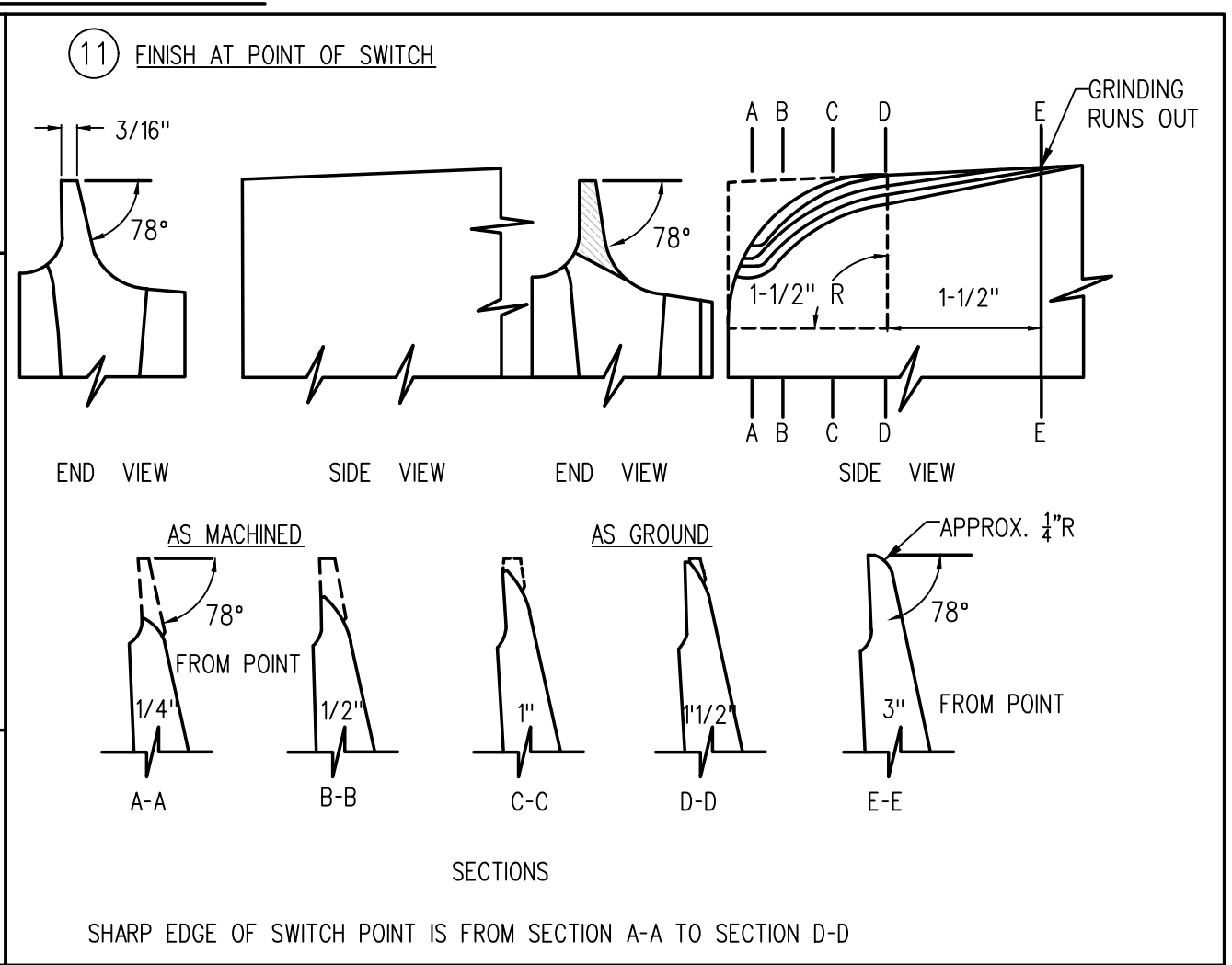

**NOTES:**

- 1- THE MACHINING DETAILS ON THIS DRAWING ARE FOR LEFT HAND SAMSON POINT RAIL ONLY, RIGHT HAND POINTS ARE MACHINED TO OPPOSITE HAND.
- 2- THIS IS A MACHINING DRAWING FOR SAMSON POINT RAIL-FOR ASSEMBLY SEE GTS-363 A/B 16'-6" POINT RAIL FOR POWER/MANUAL OPERATED
- 3- ALL HOLES ARE TO BE DRILLED: THE USE OF ACETYLENE TORCH OR OTHER BURNING METHOD FOR THE MAKING OF HOLES OR CUTTING IN THE MANUFACTURE OF POINTS IS ABSOLUTELY PROHIBITED.

**MATERIAL:**

RAIL: UNLESS SPECIFIED OTHERWISE POINT RAILS SHALL BE ONLY No1 RAILS (WITH "A" RAILS ELIMINATED) IN ACCORDANCE WITH SPECIFICATION 12.3 LATEST ISSUE. (HEEL OF POINT TO BE HARDENED).

REINFORCING BARS: SEE GTS-342 X

**SECTIONS OF MACHINED LEFT HAND POINT**

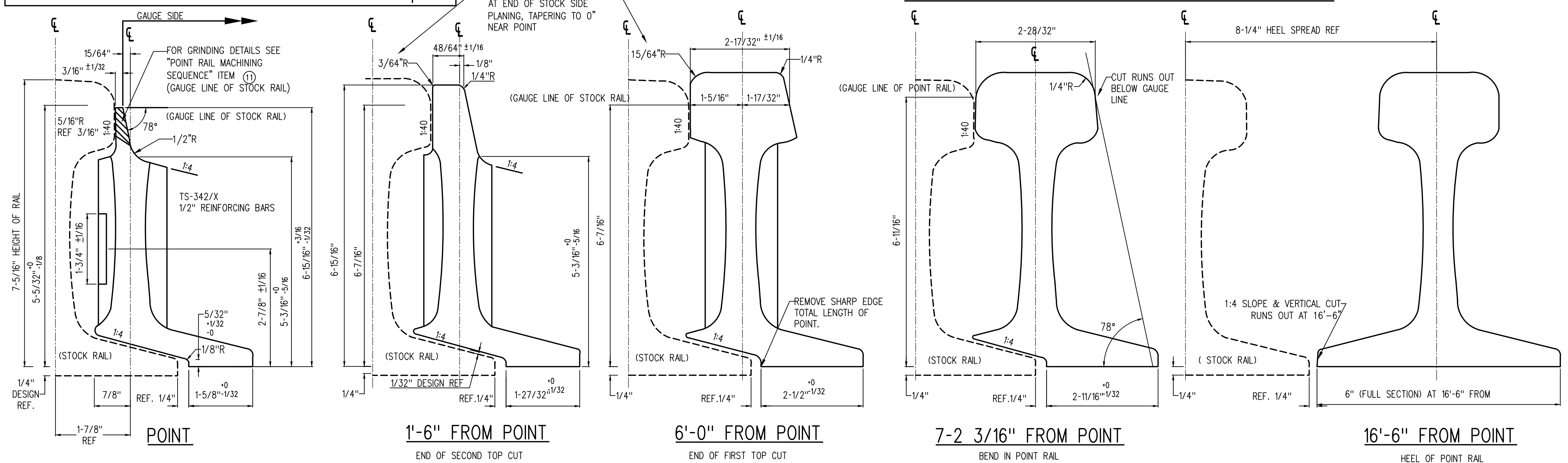

**METRIC CONVERSION: 1 inch=25.4mm, 1 foot=304.8mm**

No.	Date	Revision	By	Approved
1	18/07/27	ADDED IMPERIAL TO METRIC CONVERSION NOTE		

Standard / **MACHINING DETAILS-UNIFORM RISER DESIGN**  
**16'-6" POINT RAIL**  
 FOR MANUAL & POWER OPERATED 136LB. R.E. RAIL

Drawn MG Checked GGS Approved *[Signature]*  
 VP Engineering & Asset Management



Date DEC 15, 2017 Plan Number GTS-0417 Rev 1