

SIGN BLANKS

LOCATION

PRIVATE CROSSING SIGNS ARE REQUIRED (AS AUTHORIZED BY THE PROPER AUTHORITY) ON A FARM OR PRIVATE CROSSING WHERE A ROAD OR PASSAGE FOR USE BY VEHICLES AND/OR PEDESTRIANS CROSSES A RAILWAY TRACK AT GRADE FOR THE PRIVATE AND EXCLUSIVE USE BY A PARTICULAR PERSON, PERSONS OR PARTY AS OPPOSED TO USE BY THE GENERAL PUBLIC.

PRIVATE CROSSING SIGNS ARE TO BE LOCATED ON THE RIGHT HAND SIDE OF EACH APPROACH AND NOT LESS THAN 10 FEET AND NOT MORE THAN 15 FEET FROM GAUGE SIDE OF THE NEAREST RAIL WITH EDGE OF THE SIGN NOT LESS THAN 6 FEET NOR MORE THAN 15 FEET FROM THE EDGE OF THE TRAVELLED PORTION; THE SIGN SHALL NOT BE LESS 5 FEET NOR MORE THAN 6 FEET ABOVE THE TRAVELLED PORTION, THE SAID DISTANCES TO BE MEASURED TO THE LOWEST PART OF THE SIGN. THE SIGN SHALL BE LOCATED SO AS TO BE CLEARLY VISIBLE TO APPROACHING PEDESTRIANS OR VEHICLES.

NOTES :

GENERAL :

1. WHEN REQUISITIONING SIGNS, QUANTITY, STOCK NUMBER AND CHARACTERISTICS (WHEN REQUIRED) MUST BE INDICATED ON REQUISITION. HARDWARE MUST ALSO BE ORDERED ACCORDING TO ILLUSTRATIONS SHOWING THE NUMBER OF BOLT HOLES PER SIGN.
2. FULL SIZE SIGN TEMPLATES AVAILABLE UPON REQUEST.

MATERIALS:

1. SIGN BLANKS TO BE ALUMINUM SHEET, ALLOY 3003, H14 (12 GA.) MILL FINISH.
2. BACKGROUND (TOP) MATTE VINYL BLACK (BOTTOM) REFLECTIVE SILVER.
3. LETTERS: (TOP) SILK SCREENED WHITE OR VINYL SHEETING (BOTTOM) SILK SCREENED BLACK OR VINYL SHEETING.
4. VINYL SHEETING MUST CONFORM TO THE LATEST ISSUE OF CANADIAN GENERAL STANDARDS BOARD (CGSB) STANDARD 62-GP- 11 M, LEVEL 1 MATERIAL.
5. VINYL SHEETING MUST CONFORM TO THE LATEST ISSUE OF CANADIAN GENERAL STANDARDS BOARD (CGSB) STANDARD 62-GP- 3M MATERIAL.

MANUFACTURING :

1. UNLESS OTHERWISE STATED, COLOR SHEETING AND SYMBOLS ARE APPLIED ON ONE SIDE ONLY.
2. ALL DIMENSIONS ARE IN INCHES.
3. ALL HOLES TO BE PUNCHED OR DRILLED.
4. ALUMINUM UNPAINTED SURFACE MUST BE THOROUGHLY DEGREASED, ETCHED, AND RINSED.
5. SHEETING TO BE APPLIED DIRECTLY TO THE PREPARED ALUMINUM SURFACE.

ERECTION :

1. UNLESS OTHERWISE INDICATED IN THE DESCRIPTION OF LOCATING AND ERECTING REMARKS:
 - A.- ALL SIGNS SHALL BE ERECTED AT RIGHT ANGLES TO TRACK WHICH THEY GOVERN.
 - B.- WHEN ERECTING SIGNS ON TWO (OR MORE) TRACKS AND EACH TRACK HAS DOUBLE DIRECTION TRAFFIC, SIGNS ARE TO LOCATED ON THE FIELD SIDE OF EACH EXTREME OUTSIDE TRACK.
 - C.- ALL SIGNS SHALL BE ERECTED 10 TO 25 FEET FROM THE GAUGE SIDE OF THE NEAREST RAIL TO THE RIGHT OF THE TRACK AS VIEWED FROM AN APPROACHING TRAIN. IN RESTRICTED SIDE CLEARANCE AREAS, THE MINIMUM DISTANCE OF 6 FEET FROM GAUGE SIDE OF THE NEAREST RAIL TO ANY PORTION OF THE SIGN MUST BE MET WITH CONSIDERATION GIVEN TO CURVED AND SUPERELEVATED FEATURES.
 - D.- ALL SIGNS SHALL BE AT A MINIMUM OF 8 FEET FROM TOP OF RAIL TO THE CENTRE LINE OF THE LOWEST SIGN ON THE POST.
 - E.- ALL SIGNS SHALL BE MOUNTED ON THE STANDARD " U " POST FOR TRACK SIGNS, UNLESS OTHERWISE SPECIFIED.
 - F.- ALL POSTS MUST PENETRATE GROUND A MINIMUM OF 4 FEET.
2. ALL SIGNS SHALL BE LOCATED AND ERECTED IN A MANNER THAT WILL AFFORD THE MOST ADVANTAGEOUS VIEW FROM AN APPROACHING TRAIN.

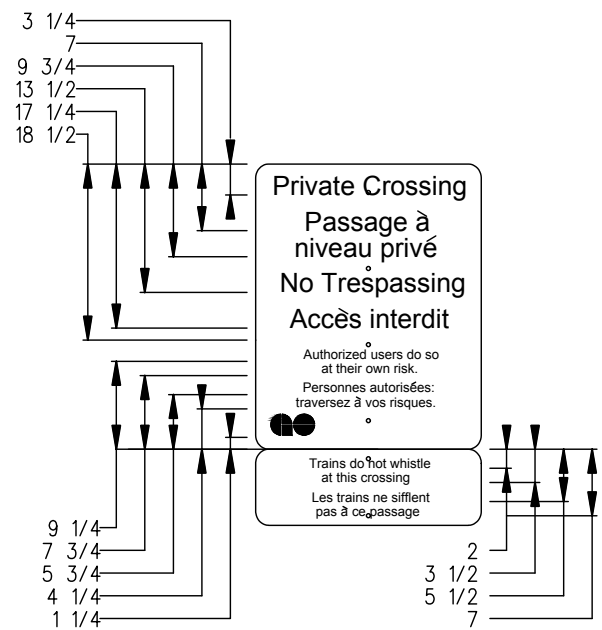

FOR ALL PROVINCES EXCEPT QUÉBEC
PRIVATE CROSSING SIGN

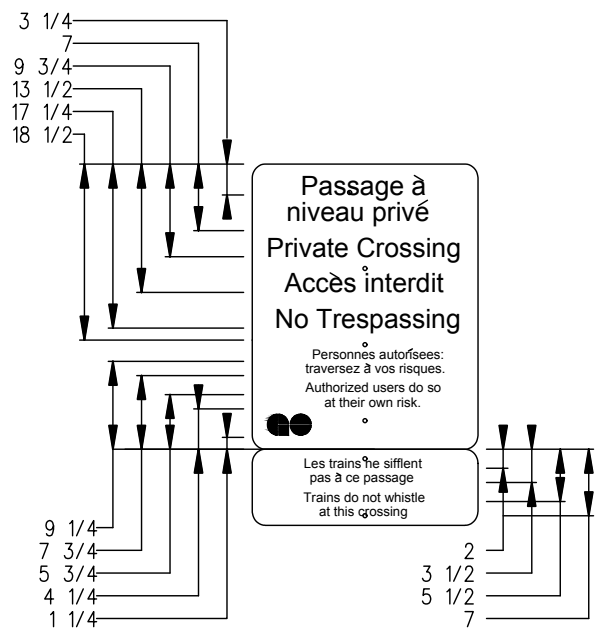

FOR QUÉBEC ONLY
PRIVATE CROSSING SIGN

TRAINS DO NOT WHISTLE SIGN

HEIGHT OF LETTERS: (TOP) 2
(BOTTOM) 1
LETTERS TO BE OF "STANDARD MEDIUM" ALPHABET.

TRAINS DO NOT WHISTLE SIGN

HEIGHT OF LETTERS: (TOP) 2
(BOTTOM) 1
LETTERS TO BE OF "STANDARD MEDIUM" ALPHABET.

MANUFACTURING DETAILS

ITEM NO.	DESCRIPTION	PLAN NUMBER
1	KIT SIGN MOUNTING ASSEMBLY SIGN (STATE TYPE AND STOCK NUMBER)	GTS-0720
2	" U " POST FOR TRACK SIGNS	GTS-0719
3	BLOCK FILLER FOR POST (CAST OR FORMED)	GTS-0719
4	FIBRE WASHER 3/8 I.D. x 5/8 O.D. x 1/16 THICK	---
5	3/8 DIA.-16 UNC RD. CAP SCREW 2-1/2 LG. C/W SQ. NUT	---
6	SPRING WASHER HELICAL FOR 3/8 CAP SCREW, PLATED	---
7	PLATE WASHER 7/16 I.D. x 1 O.D. x 5/64 THICK, PLATED	---

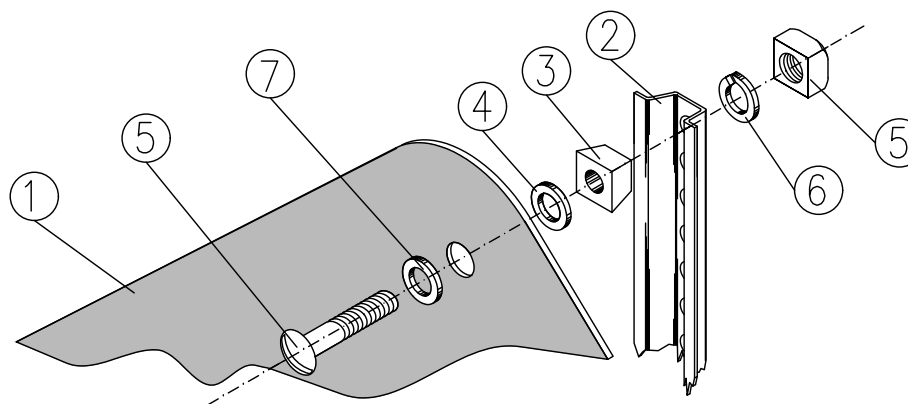

METRIC CONVERSION: 1 inch=25.4mm, 1 foot=304.8mm

No.	Date	Revision	By Approved
1	18/07/27	ADDED IMPERIAL TO METRIC CONVERSION NOTE	

Standard/ **SIGNS**

Drawn MG Checked GGS Approved *[Signature]*
VP Engineering & Asset Management



Date SEPT 15/2017 Plan Number GTS-0720 Rev 1