

SIGN BLANKS

MANUFACTURING DETAILS

LOCATION

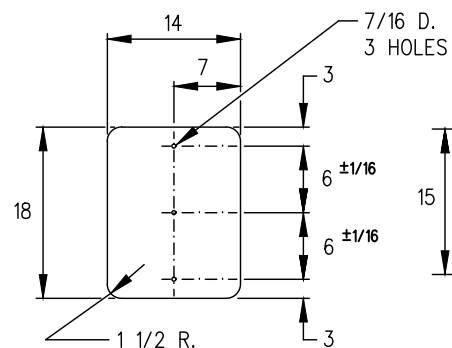

RECTANGLE
(14 X 18)
WT.: 1.99 LB.

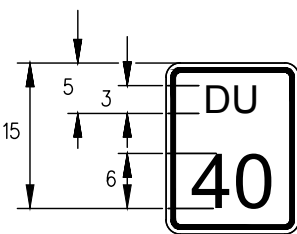

BACKGROUND: REFLECTIVE YELLOW
NUMBERS & LETTERS: SILK SCREENED
BLACK OR VINYL SHEETING

DESIGNATED UNIT
ZONE SPEED SIGN
TYPE 5

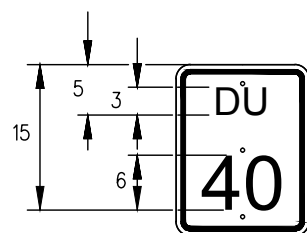

BACKGROUND: REFLECTIVE SILVER
NUMBERS & LETTERS: SILK SCREENED
BLACK OR VINYL SHEETING

DESIGNATED UNIT
ADVANCE SPEED RESTRICTION SIGN
TYPE 11

DU ZONE SPEED SIGNS WILL BE PLACED BELOW REGULAR ZONE SPEED SIGN ON SAME POST AT THE BEGINNING OF SPEED ZONES, EXCEPT WHEN THERE IS A REDUCTION IN SPEED FROM THE PREVIOUS ZONE, AND THEN THE SPEED SIGNS WILL BE PLACED AS FOLLOWS:

- 3000 YARDS IN ADVANCE OF SPEED RESTRICTION POINT ON SUBDIVISIONS OF MAXIMUM FREIGHT TRAIN SPEED OF 45 MPH OR MORE.
 - 2000 YARDS IN ADVANCE OF SPEED RESTRICTION POINT ON SUBDIVISION OF MAXIMUM FREIGHT TRAIN SPEED OF 40 MPH OR LESS.
- SIGN WILL NOT BE PLACED:
- IN TERMINALS
 - ON SUBDIVISIONS WHICH HAVE ONE SPEED ZONE.
 - ON SUBDIVISIONS WITH A MAXIMUM SPEED OF 30 MPH OR LESS.

ADVANCE SPEED RESTRICTION SIGNS WILL BE PLACED BELOW REGULAR ZONE SPEED SIGN ON SAME POST AT THE BEGINNING OF SPEED ZONES AS FOLLOWS:

- 3000 YARDS IN ADVANCE OF SPEED RESTRICTION POINT ON SUBDIVISIONS OF MAXIMUM FREIGHT TRAIN SPEED OF 45 MPH OR MORE.
- 2000 YARDS IN ADVANCE OF SPEED RESTRICTION POINT ON SUBDIVISIONS OF MAXIMUM FREIGHT TRAIN SPEED OF 40 MPH OR LESS.

NOTES :

GENERAL :

1. WHEN REQUISITIONING SIGNS, QUANTITY, STOCK NUMBER AND CHARACTERISTICS (WHEN REQUIRED) MUST BE INDICATED ON REQUISITION. HARDWARE MUST ALSO BE ORDERED ACCORDING TO ILLUSTRATIONS SHOWING THE NUMBER OF BOLT HOLES PER SIGN.
2. FULL SIZE SIGN TEMPLATES AVAILABLE UPON REQUEST.

MATERIALS:

1. SIGN BLANKS TO BE ALUMINUM SHEET, ALLOY 3003, H14 (12 GA.) MILL FINISH.
2. REFLECTIVE SHEETING MUST CONFORM TO THE LATEST ISSUE OF CANADIAN GENERAL STANDARDS BOARD (CGSB) STANDARD 62-GP-11 M, LEVEL 1 MATERIAL.
3. VINYL SHEETING MUST CONFORM TO THE LATEST ISSUE OF CANADIAN GENERAL STANDARDS BOARD (CGSB) STANDARD 62-GP- 3M MATERIAL.

MANUFACTURING :

1. UNLESS OTHERWISE STATED, COLOR SHEETING AND SYMBOLS ARE APPLIED ON ONE SIDE ONLY.
2. ALL DIMENSIONS ARE IN INCHES.
3. ALL HOLES TO BE PUNCHED OR DRILLED.
4. ALUMINUM UNPAINTED SURFACE MUST BE THOROUGHLY DEGREASED, ETCHED, AND RINSED.
5. SHEETING TO BE APPLIED DIRECTLY TO THE PREPARED ALUMINUM SURFACE.

ERECTION :

1. UNLESS OTHERWISE INDICATED IN THE DESCRIPTION OF LOCATING AND ERECTING REMARKS:
 - A.- ALL SIGNS SHALL BE ERECTED AT RIGHT ANGLES TO TRACK WHICH THEY GOVERN.
 - B.- WHEN ERECTING SIGNS ON TWO (OR MORE) TRACKS AND EACH TRACK HAS DOUBLE DIRECTION TRAFFIC, SIGNS ARE TO LOCATED ON THE FIELD SIDE OF EACH EXTREME OUTSIDE TRACK.
 - C.- ALL SIGNS SHALL BE ERECTED 10 TO 25 FEET FROM THE GAUGE SIDE OF THE NEAREST RAIL TO THE RIGHT OF THE TRACK AS VIEWED FROM AN APPROACHING TRAIN. IN RESTRICTED SIDE CLEARANCE AREAS, THE MINIMUM DISTANCE OF 6 FEET FROM GAUGE SIDE OF THE NEAREST RAIL TO ANY PORTION OF THE SIGN MUST BE MET WITH CONSIDERATION GIVEN TO CURVED AND SUPERELEVATED FEATURES.
 - D.- ALL SIGNS SHALL BE AT A MINIMUM OF 8 FEET FROM TOP OF RAIL TO THE CENTRE LINE OF THE LOWEST SIGN ON THE POST.
 - E.- ALL SIGNS SHALL BE MOUNTED ON THE STANDARD " U " POST FOR TRACK SIGNS, UNLESS OTHERWISE SPECIFIED.
 - F.- ALL POSTS MUST PENETRATE GROUND A MINIMUM OF 4 FEET.
2. ALL SIGNS SHALL BE LOCATED AND ERECTED IN A MANNER THAT WILL AFFORD THE MOST ADVANTAGEOUS VIEW FROM AN APPROACHING TRAIN.

| ITEM NO. | DESCRIPTION | PLAN NUMBER |
|----------|--|-------------|
| 1 | SIGN (STATE TYPE AND STOCK NUMBER) | GTS-0720 |
| 2 | " U " POST FOR TRACK SIGNS | GTS-0719 |
| 3 | BLOCK FILLER FOR POST (CAST OR FORMED) | GTS-0719 |
| 4 | FIBRE WASHER 3/8 I.D. x 5/8 O.D. x 1/16 THICK | — |
| 5 | 3/8 DIA.-16 UNC RD. CAP SCREW 2-1/2 LG. C/W SQ. NUT | — |
| 6 | SPRING WASHER HELICAL FOR 3/8 CAP SCREW, PLATED | — |
| 7 | PLATE WASHER 7/16 I.D. x 1 O.D. x 5/64 THICK, PLATED | — |

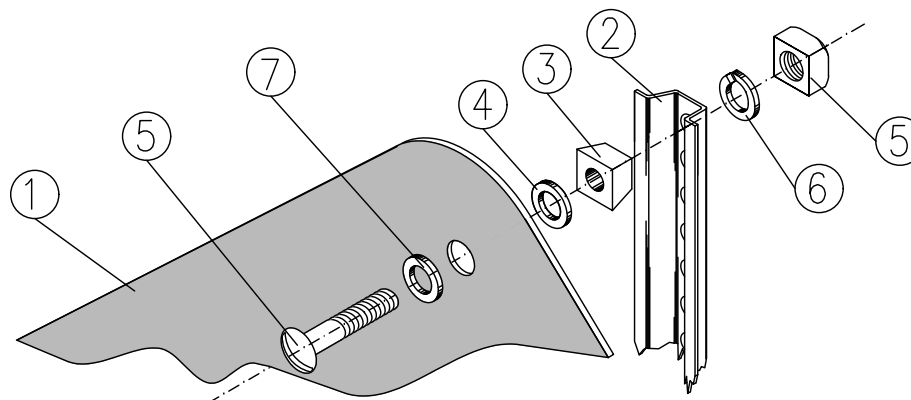

METRIC CONVERSION: 1 inch=25.4mm, 1 foot=304.8mm

| No. | Date | Revision | By | Approved |
|-----|----------|--|----|----------|
| 1 | 18/07/27 | ADDED IMPERIAL TO METRIC CONVERSION NOTE | | |

Standard / **SIGNS**

Drawn MG Checked GGS Approved *[Signature]*
VP Engineering & Asset Management



Date SEPT 15/2017 Plan Number GTS-0720 Rev 1