

**END CASTING**  
(RIGHT HAND ILLUSTRATED)

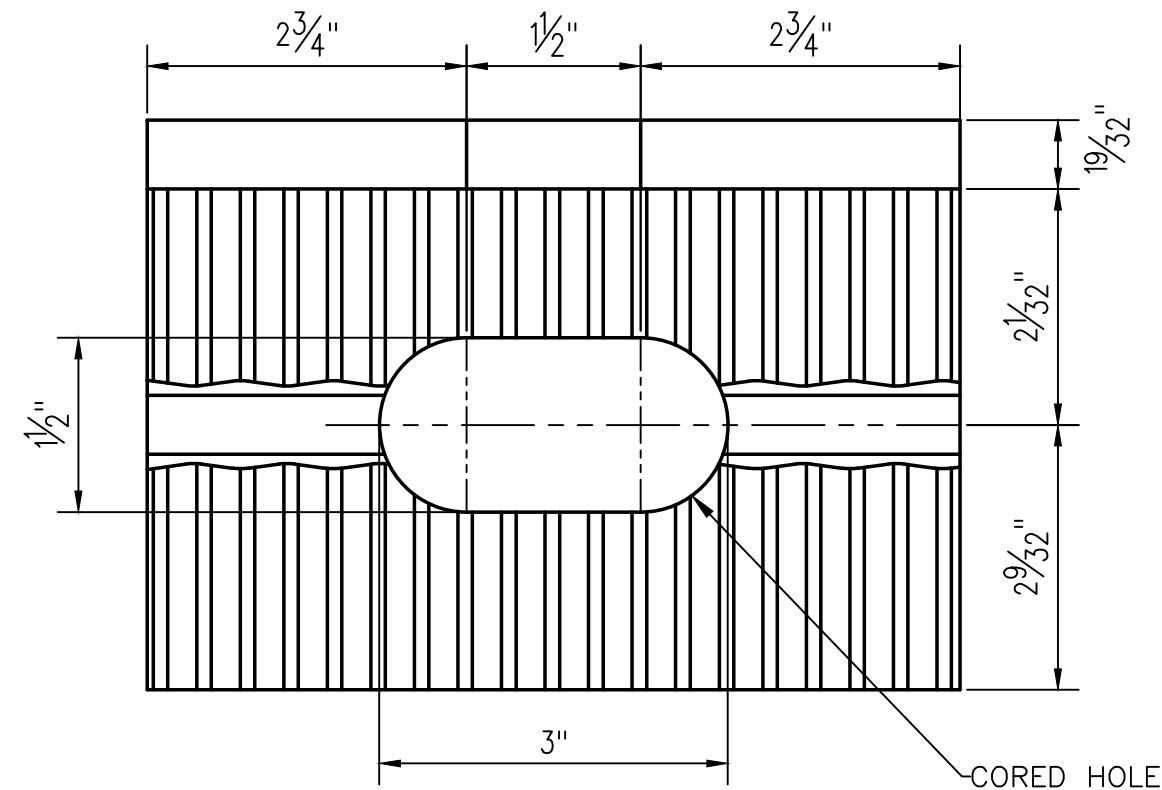
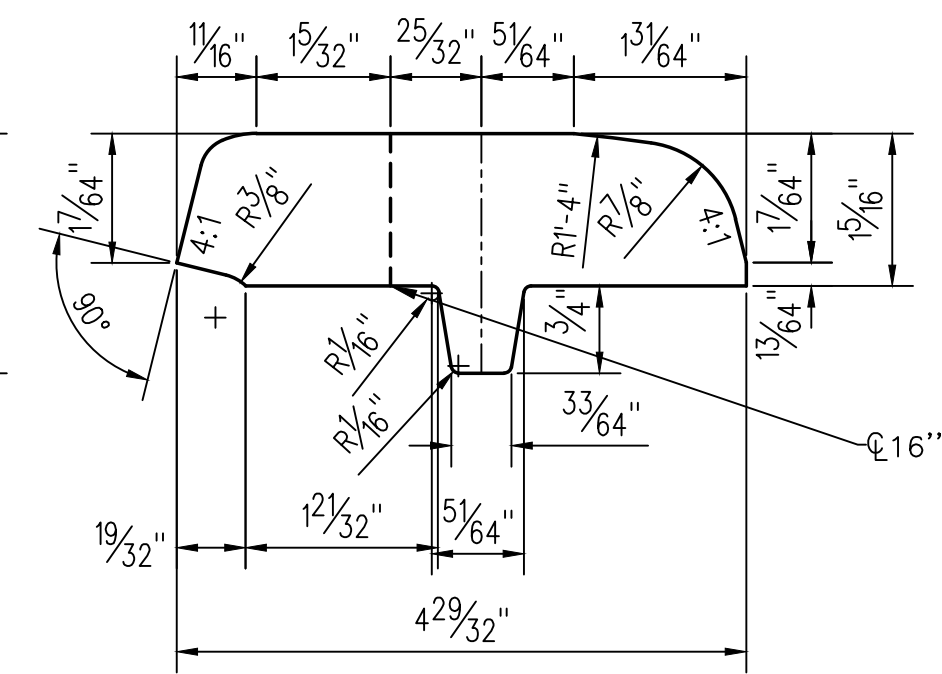
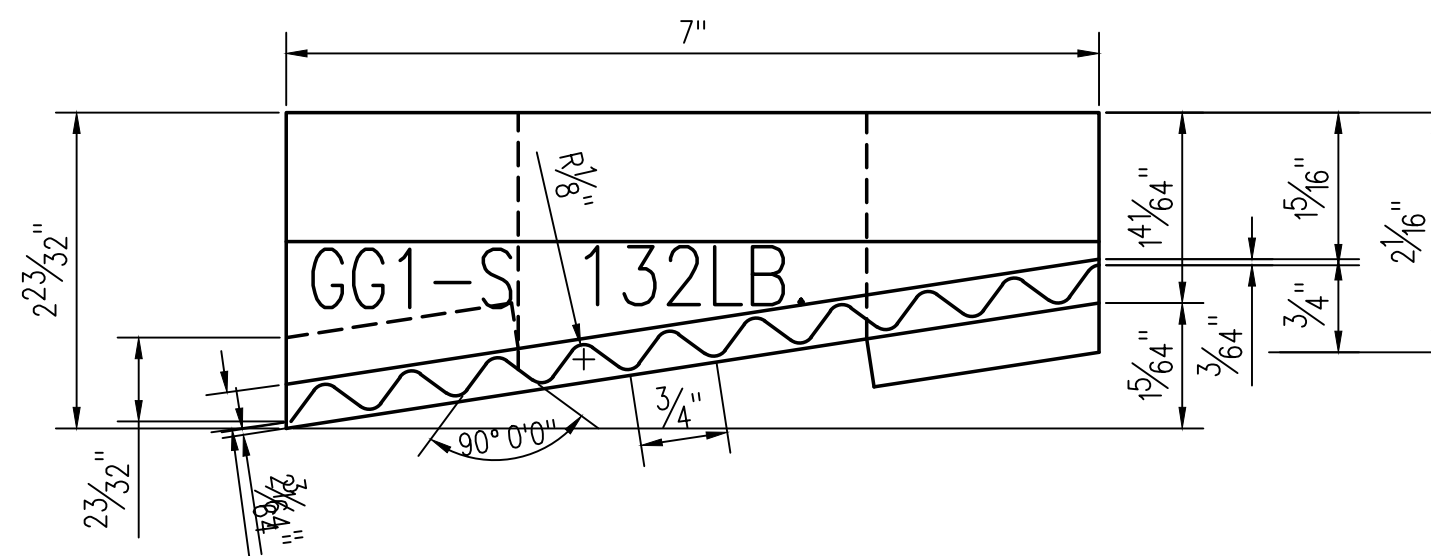
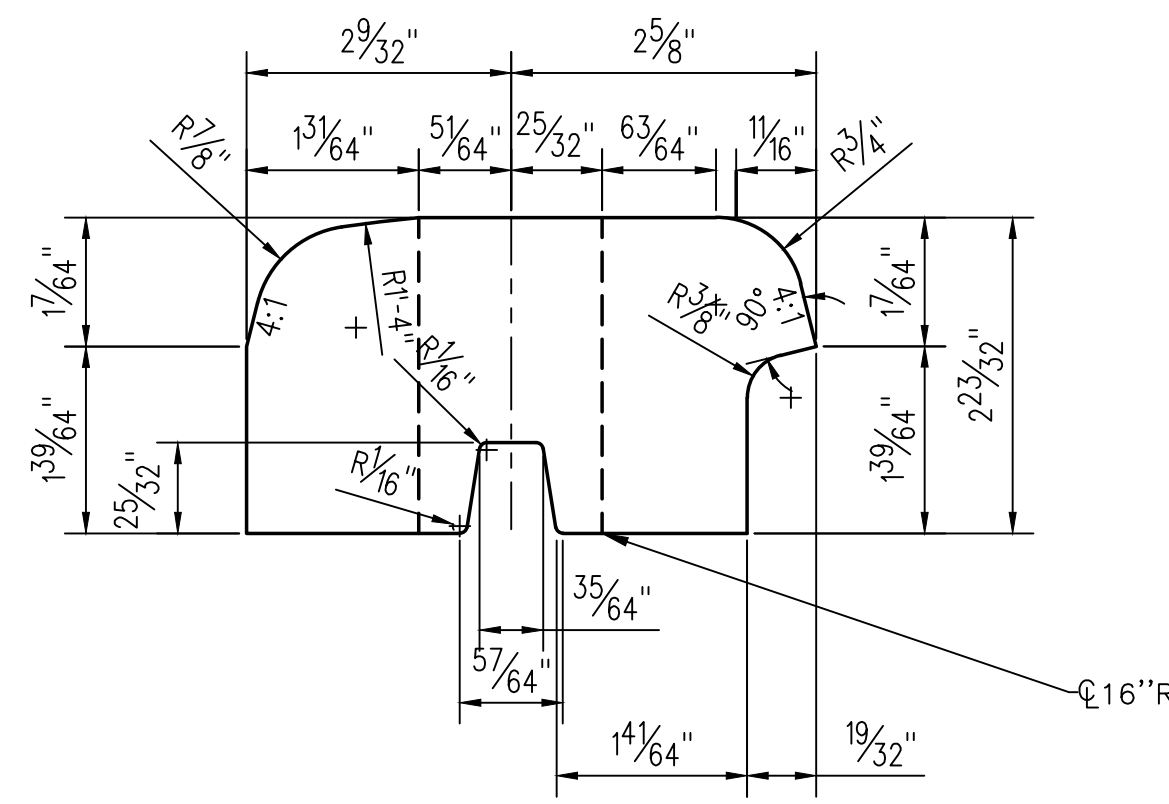

**ADJUSTABLE BLOCK (EACH)**

**NOTES:**

- END CASTINGS SHALL BE MADE RIGHT AND RIGHT HAND.
- 1/2" MIN. IDENTIFICATION CHARACTERS RAISED 1/32" TO BE CAST ON EACH END CASTING AND ADJUSTABLE BLOCK, AS SHOWN.
- DIMENSIONS ARE FOR FINISHED CASTINGS. PROPER ALLOWANCE MUST BE MADE FOR SHRINKAGE WHEN MAKING PATTERNS.
- \*"FINISHED SURFACES BETWEEN MARKS.

**MATERIAL:**

- END CASTINGS AND ADJUSTABLE BLOCKS SHALL BE OF CAST STEEL OR MALLEABLE IRON MADE IN ACCORDANCE WITH THE LATEST REVISION OF A.S.T.M. STANDARD SPECIFICATION FOR MILD-TO MEDIUM-STRENGTH CARBON-STEEL CASTINGS FOR GENERAL APPLICATION NO. A27 GRADE N2 OR THE LATEST REVISION OF A.S.T.M. STANDARD SPECIFICATION FOR MALLEABLE CASTINGS NO. A47 GRADE 32510.

**METRIC CONVERSION: 1 inch=25.4mm, 1 foot=304.8mm**

1	18/07/27	ADDED IMPERIAL TO METRIC CONVERSION NOTE	
No.	Date	Revision	By Approved
Standard/		<b>CASTING</b>	
		<b>FOR 132LB. R.E. GUARD RAIL</b>	
Drawn	MG	Checked	GGG
Approved		VP Engineering & Asset Management	
Date	DEC 15, 2017	Plan Number	GTS-0848
Rev	1		
REFERENCE: TS-848		Sheet 1 OF 1	



**METROLINX**