

BOLTLESS GUARD RAIL
(LEFT HAND ASSEMBLY - LEFT HAND TURNOUT SHOWN)

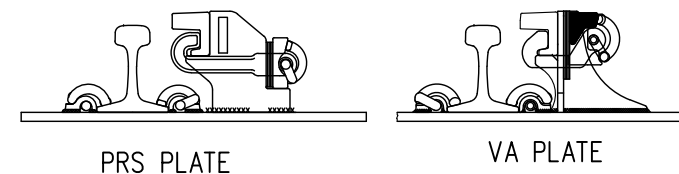

HARDWARE ASSEMBLY

BOLTLESS GUARDRAIL ASSEMBLIES ARE MANUFACTURED BY MORE THAN ONE SUPPLIER. WHILE COMPLETE HARDWARE ASSEMBLIES (BOTH THE PLATE AND FASTENING COMPONENTS) ARE INTERCHANGEABLE BETWEEN GUARD RAIL ASSEMBLIES PRODUCED BY EITHER MANUFACTURER, THE INDIVIDUAL FASTENING HARDWARE IS NOT INTERCHANGEABLE BETWEEN DIFFERENT STYLES OF PLATES.

REPLACEMENT COMPONENTS:

VA PLATES

STANDARD PLATE, 1361b MARK: VA-790
STANDARD PLATE, 1151b MARK: VA-823
FASTENING KIT FOR VA PLATES:

PRS PLATES

STANDARD PLATE, 1361b MARK: PRS
STANDARD PLATE, 1151b MARK: PRS-115
FASTENING KIT FOR PRS PLATES:

FASTENING KITS INCLUDE THE BLOCK, CLAMP, CLIP AND SHIMS REQUIRED TO AFFIX THE WEAR BAR TO THE APPROPRIATE BOLTLESS GUARD RAIL PLATE.

GENERAL

PANDROL CLIP: (2 PER PLATE)
Ss5 TIE SCREW: (5 PER PLATE)

NOTES

- ALL GUARD RAIL ASSEMBLIES COME COMPLETE WITH BRACE PLATES, WEAR BARS, SHIMS, BOLTS, NUTS, WASHERS, PANDROL CLIPS, Ss5 SCREWS.
- THESE ASSEMBLIES FORM A PART OF THE GUARD RAIL PACKS SHOWN ON STANDARD TURNOUT PLANS.

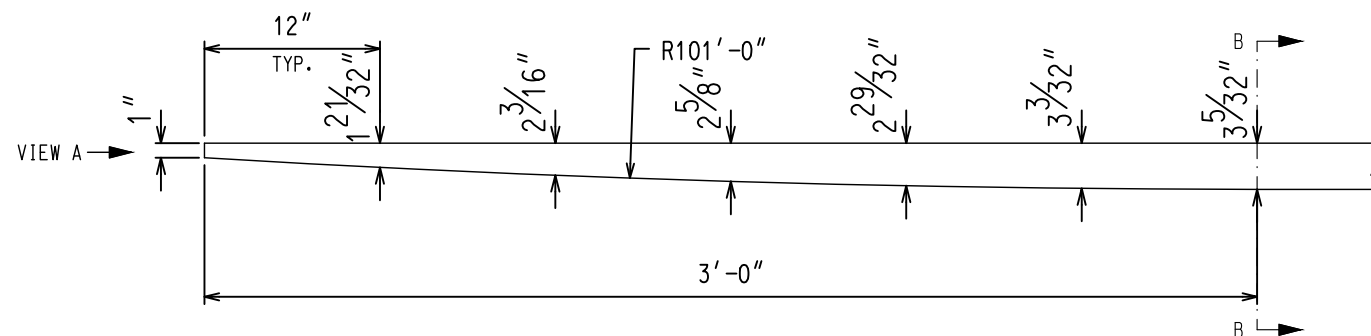
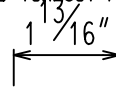

FLARE MACHINING DETAIL

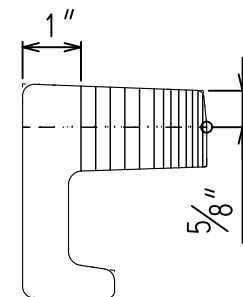

VIEW "A"

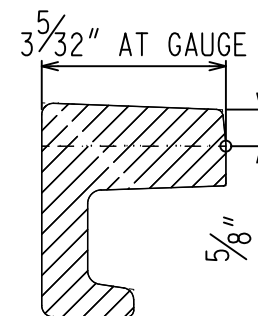

SECTION B-B

METRIC CONVERSION: 1 inch=25.4mm, 1 foot=304.8mm

No.	Date	Revision	By Approved
1	18/07/27	ADDED IMPERIAL TO METRIC CONVERSION NOTE	

Standard / **BOLTLESS GUARD RAIL ASSEMBLY**

Drawn PCV Checked DL Approved *[Signature]*
VP Engineering & Asset Management



METROLINX

Date SEPT 15/2017 Plan Number GTS-1123 Rev 1

REFERENCE: TS-1123_R2

Sheet 1 OF 1