

PANDROL RAIL CLIP
TYPE PR 609

FOR SPLICE BAR INSTALLATIONS

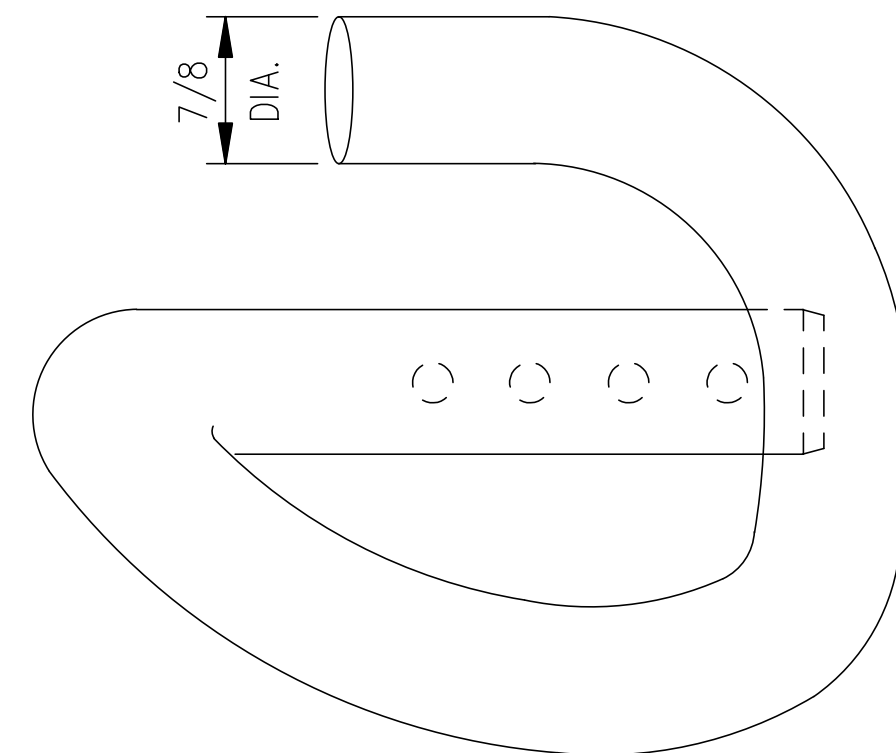
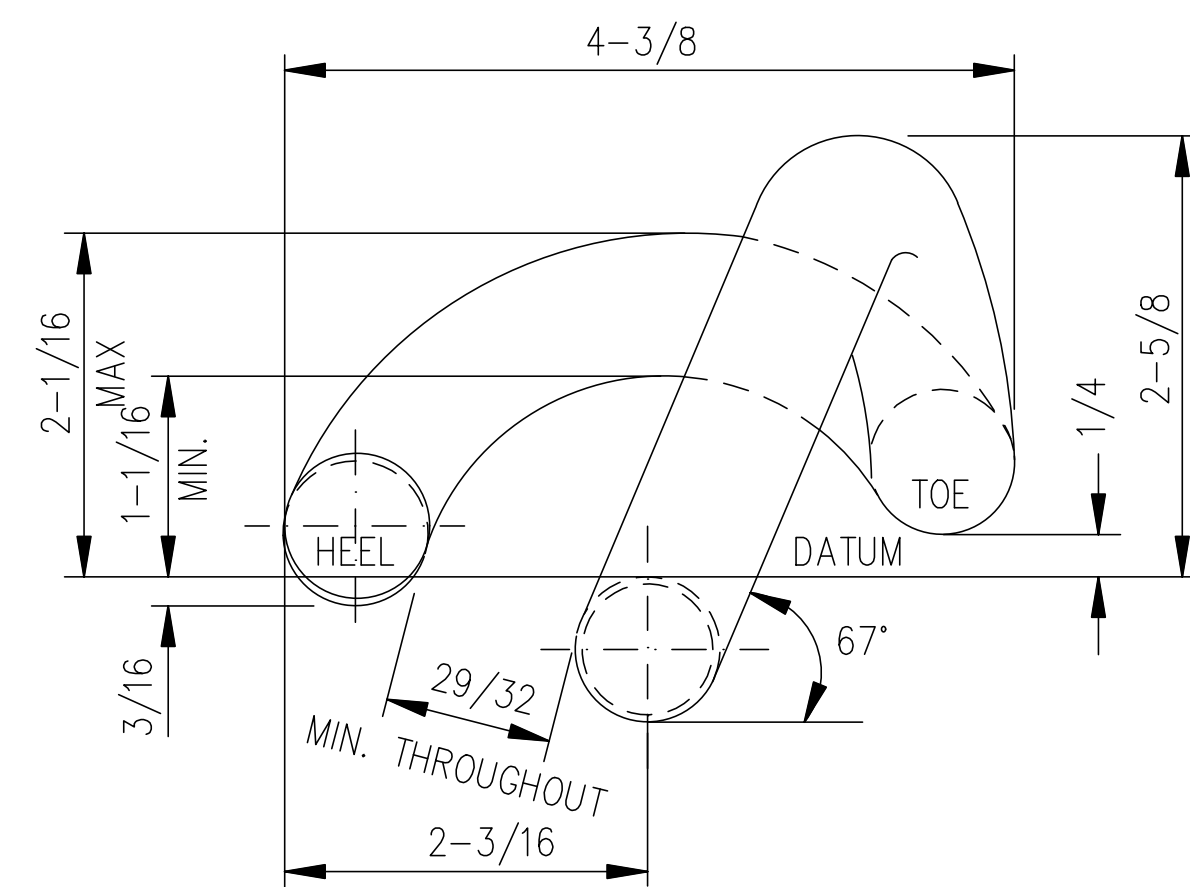
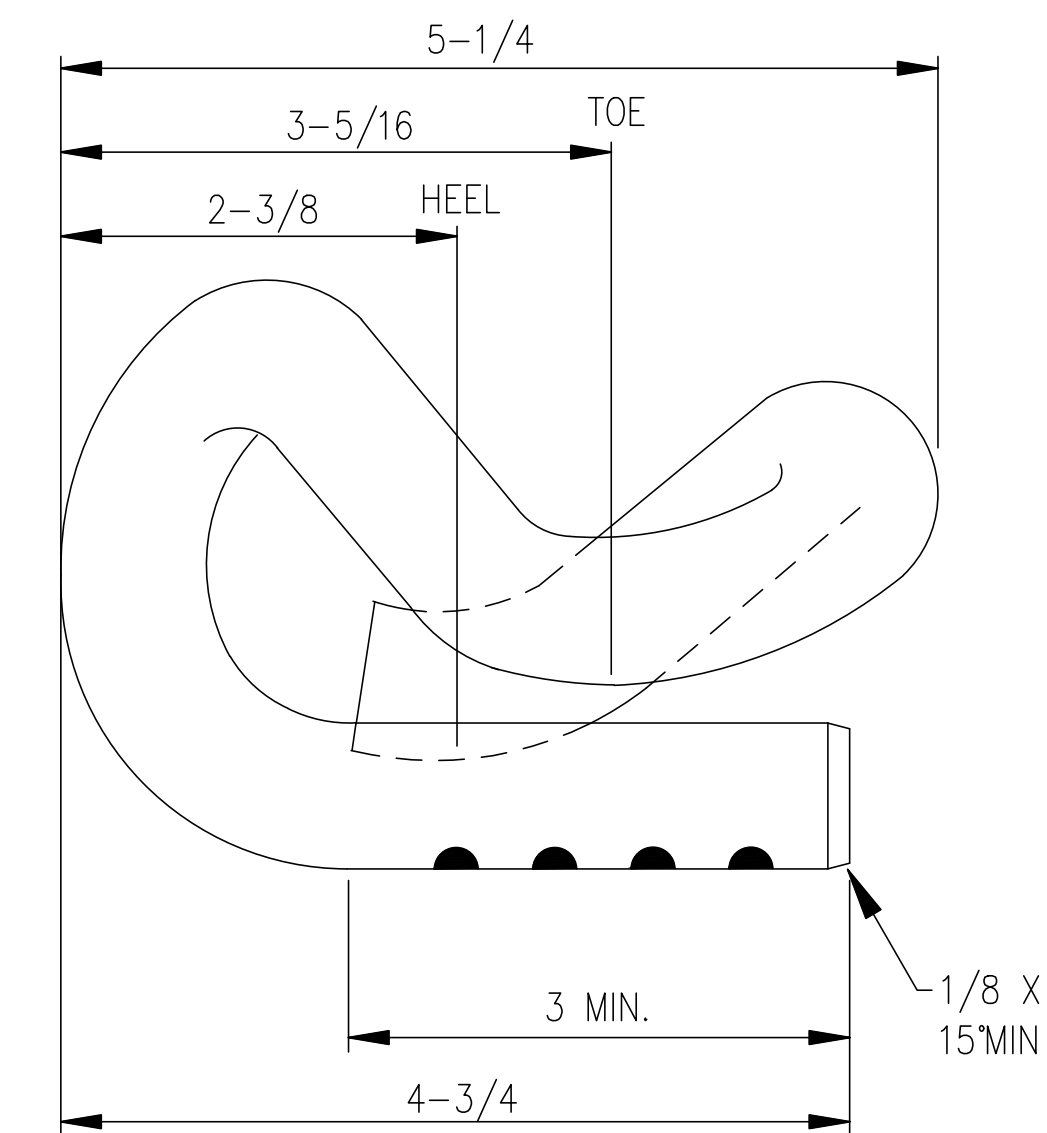

PANDROL RAIL CLIP
TYPE PR 633

FOR ZERO LONGITUDINAL RESTRAINT SYSTEM

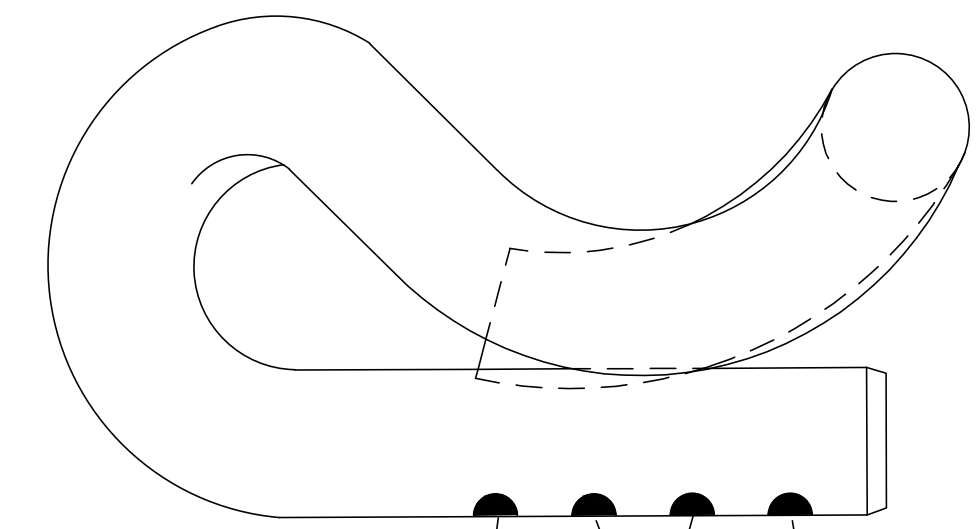

YEAR CODE			STAMP CODE	COUNTRY CODE
W = 2001	B = 2011	L = 2021	GM	A = U.K.
X = 2002	C = 2012	M = 2022		G = CANADA
Y = 2003	D = 2013	N = 2023		D = USA
Z = 2004	E = 2014	P = 2024		F = BRAZIL
5 = 2005	F = 2015	Q = 2025		H = SOUTH AFRICA
6 = 2006	G = 2016	R = 2026		
7 = 2007	H = 2017	S = 2027		
8 = 2008	I = 2018	T = 2028		
9 = 2009	J = 2019	U = 2029		
A = 2010	K = 2020	V = 2030		

EXAMPLE: 6GMG DESIGNATES A PR-609 CLIP (GM) MADE IN CANADA (G) IN 2006 (6).

PANDROL "PR" TYPE CLIPS			
CLIP TYPE.	COLOUR CODING	STAMP CODE	WEIGHT (LBS.)
PR 609	YELLOW	GM	2.70
PR 631A	AS MADE	GF	2.73

STAMPING DETAILS

NOTES:

1. ALL DIMENSIONS ARE IN INCHES.
2. MATERIAL: HEAT TREATED STEEL, 7/8" DIAMETER FOR PR 633.
3. LEGACY e2009L CLIPS ARE ACCEPTABLE FOR USE ON CONCRETE TIES ONLY.

METRIC CONVERSION: 1 inch=25.4mm, 1 foot=304.8mm

No.	Date	Revision	By	Approved
2	23/10/31	UPDATED STAMPING DETAILS		
1	18/07/27	ADDED IMPERIAL TO METRIC CONVERSION NOTE		

Standard/	PANDROL RAIL CLIPS		
Drawn NA	Checked SJ	Approved	VP Engineering & Asset Management - Track



Date OCTOBER 31/2023 Plan Number GTS-1322 Rev 2

REFERENCE: TS-1322_SH2_R2 Sheet 2 OF 3