

Holes punched to suit rail weight & insulation requirements

No.	'e' TYPE ASSEMBLY COMPONENTS	PART No.
1	'e' TYPE RAIL CLIP	'e' CLIP
2	NARSTCO CAST HOOK-IN SHOULDER (10mm)	4020
3	NARSTCO CAST HOOK-IN SHOULDER (10mm)	4010
4	INSULATOR	
5	RAIL PAD	

**Section Properties**

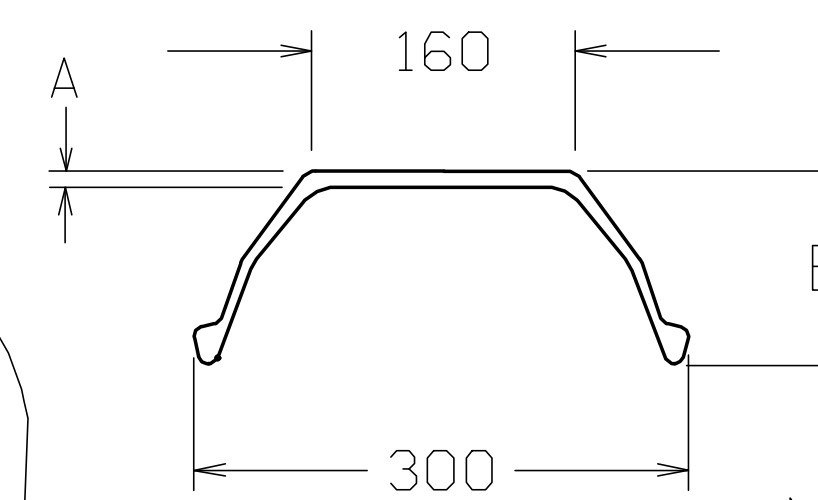

Section:	H10
Dimension 'A' mm	10
Dimension 'B' mm	118
Weight of tie - kg / lb	81.8/180
Weight of bar - kg/m	30.8
Yield strength - MPa (min)	345
Section moduli - Z Top*10 <sup>3</sup> mm <sup>3</sup>	153
- Z Bot*10 <sup>3</sup> mm <sup>3</sup>	79.7



Stamp Detail

NOTE:

\* Rail seat area canted to specification i.e. 1:20, 1:30, 1:40

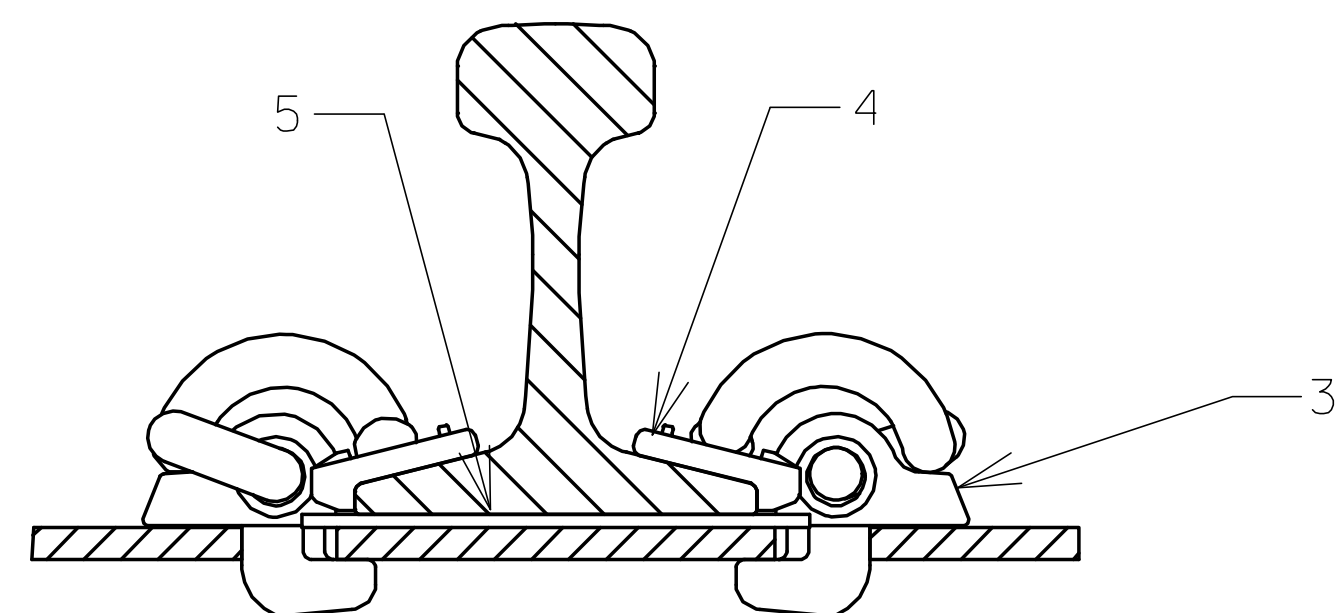

Typical Insulated Rail Assembly

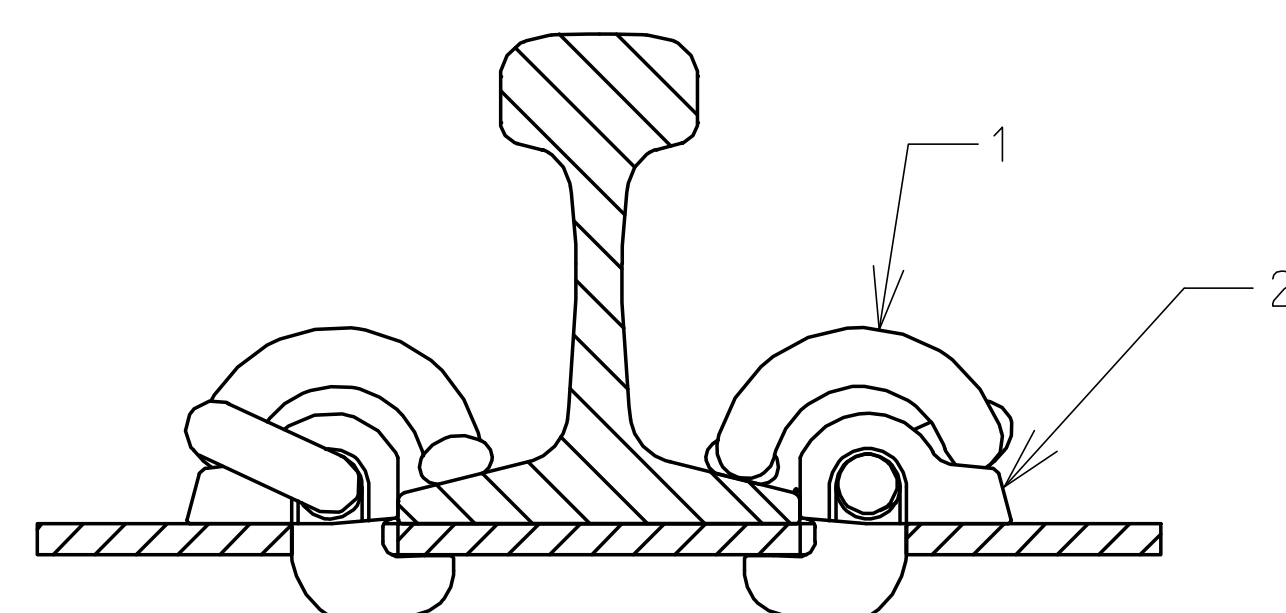

Typical Uninsulated Rail Assembly

**METRIC CONVERSION: 1 inch=25.4mm, 1 foot=304.8mm**

0	18/08/31	REVISED PDF VERSION ESTABLISHED	
No.	Date	Revision	By Approved
Standard/		H10 STEEL TIE FOR INSULATED AND NINSULATED APPLICATIONS WITH 'e' CLIP FASTENING SYSTEM AND 190mm DEEP SPADE	
Drawn	MG	Checked	GGS
Approved		VP Engineering & Asset Management	
Date		Plan Number	Rev
AUG 31, 2017		GTS-2102	0
REFERENCE:			Sheet 1 OF 1



**METROLINX**