

Microtunnelling launch shaft construction on Riverdale Avenue west of Pape Avenue

Expected start date: As early as February 18, 2025

Expected duration: Three (3) months

Hours of work: Weekdays, 7:00 a.m. to 7:00 p.m.

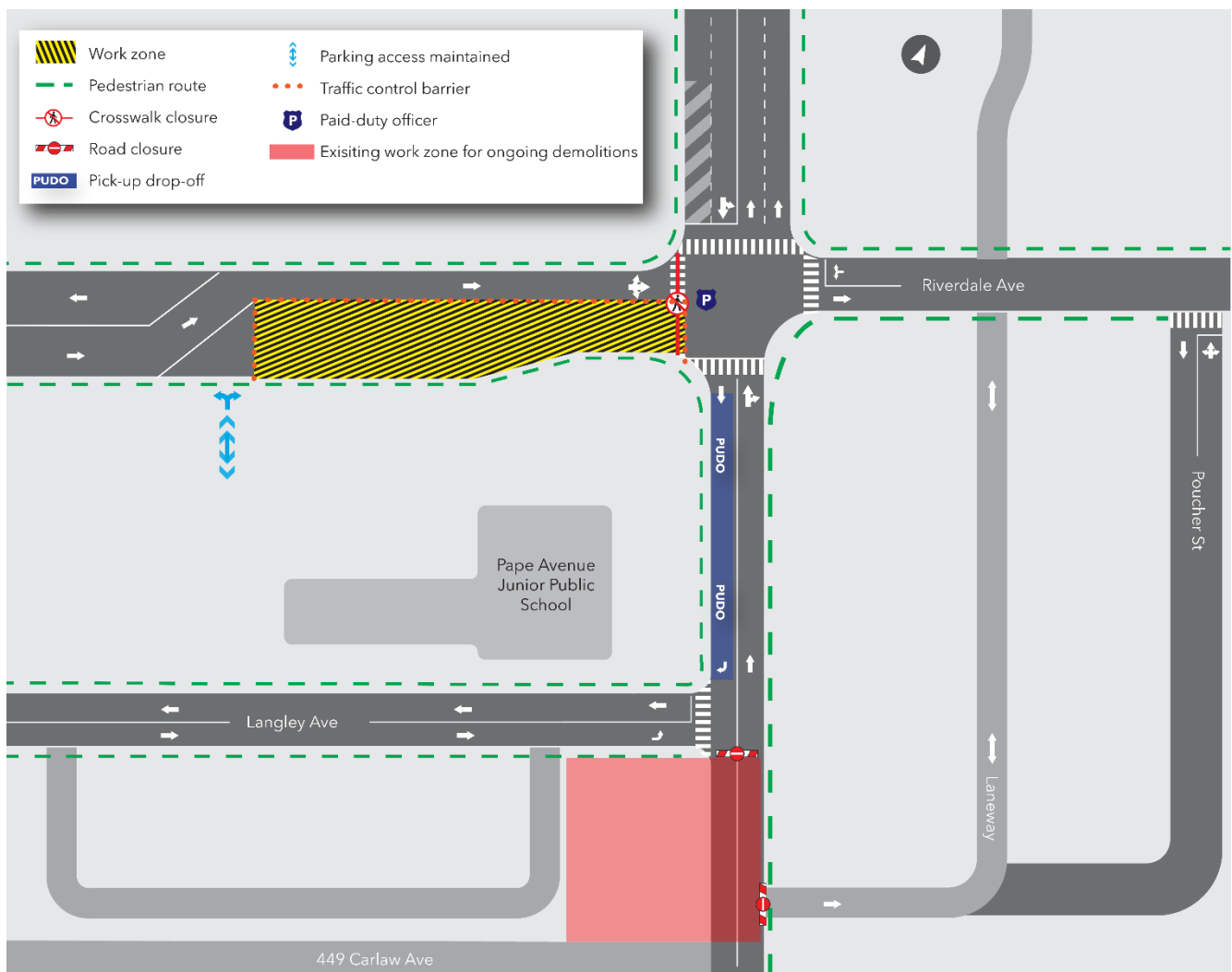

What is happening?

- To accommodate the future construction of the Gerrard tunnel portal and the tunnel boring machine, the storm sewer under Pape Avenue will be relocated to the west of Pape Avenue, under the eastern portion of the Pape Avenue Junior Public School yard.
 - The new storm sewer will be constructed using a microtunnel boring machine.
 - Construction of the launch shaft is expected to be completed in three (3) months.
 - Storm sewer relocation work is expected to be completed in nine (9) months.
 - There will be a partial closure west of the Pape-Riverdale intersection for the construction of the launch shaft.

What to expect:

Construction

- Microtunnelling requires the construction of a launch shaft on Riverdale Avenue. This is the shaft from which the microtunnel boring machine will be launched and operated.
 - After the launch shaft is built, the microtunnel plant will be set up.
- The shaft will be approximately eight (8) metres deep when finished. The site around the shaft will be fenced and secured for the safety of the public.
- Work will involve the use of construction equipment such as excavators, hydrovacs, a pilling rig and a generator. Residents in the area will hear noise from construction equipment. Crews will take measures to minimize noise impacts wherever possible.
- Work may be delayed due to weather conditions or unforeseen circumstances.

Pedestrian and Traffic Details

- The traffic on Riverdale Avenue west of the Pape-Riverdale intersection will be reduced to a single one-way eastbound lane. Westbound traffic will not be permitted.
- The north-south cross walk on the west side of the Pape-Riverdale intersection will be closed to pedestrians.
- The Pape Avenue Junior Public School pick-up drop-off (PUDO) will be relocated to the west side of Pape Avenue.
 - A separate notice about the change to the PUDO will be shared directly with the school board and parents.
- Pape Avenue south of Langley Avenue will be closed to vehicular traffic due to ongoing demolitions. (Visit metrolinx.com/ontarioline to view previous construction notices)
 - Vehicles travelling south on Pape Avenue must turn right onto Langley Avenue.
 - Vehicles travelling east on Langley Avenue must turn left onto Pape Avenue.
 - The pedestrian bridge will remain accessible via the east sidewalk on Pape Avenue.
- Paid-duty officers and traffic control personnel will be present on site to direct vehicles and pedestrians. Two (2) City of Toronto crossing guards will be present to direct pedestrians.
- Given the westbound lane closure at Pape-Riverdale, the TTC will be required to temporarily detour the 72 Pape bus southbound via Dingwall to Carlaw. 72 Pape northbound routing will not be affected. For TTC routing details please visit: www.ttc.ca

Safety

- Equipment may be left on site but will be properly secured and stored to ensure safety.
- After-hours security will be on site between 7:00 p.m. and 7:00 a.m. to ensure equipment and materials are not tampered with.

Contact us:

Call us 24/7 at: [416-202-5100](tel:416-202-5100)
Write to us at: ontarioline@metrolinx.com
Find us on Twitter, Facebook, and Instagram: [@ontarioline](https://www.instagram.com/ontarioline)
Visit the website: www.metrolinx.com/ontarioline

Visit our community offices:

Riverside:
770 Queen St. E, Toronto, ON, M4M 1H4

General hours:

- Mondays, Tuesdays and Fridays: 9 a.m. to 5 p.m.
- Wednesdays and Thursdays: 10 a.m. to 6 p.m.

Thorncliffe Park:

East York Town Centre
45 Overlea Blvd., Toronto, ON M4H 1C3
Unit 153 (across from the Rogers store)

General hours:

- Monday to Friday: 9 a.m. to 5 p.m.