

Utility Works on Bayview Avenue and Eglinton Avenue East

As early as Monday, February 3, 2025

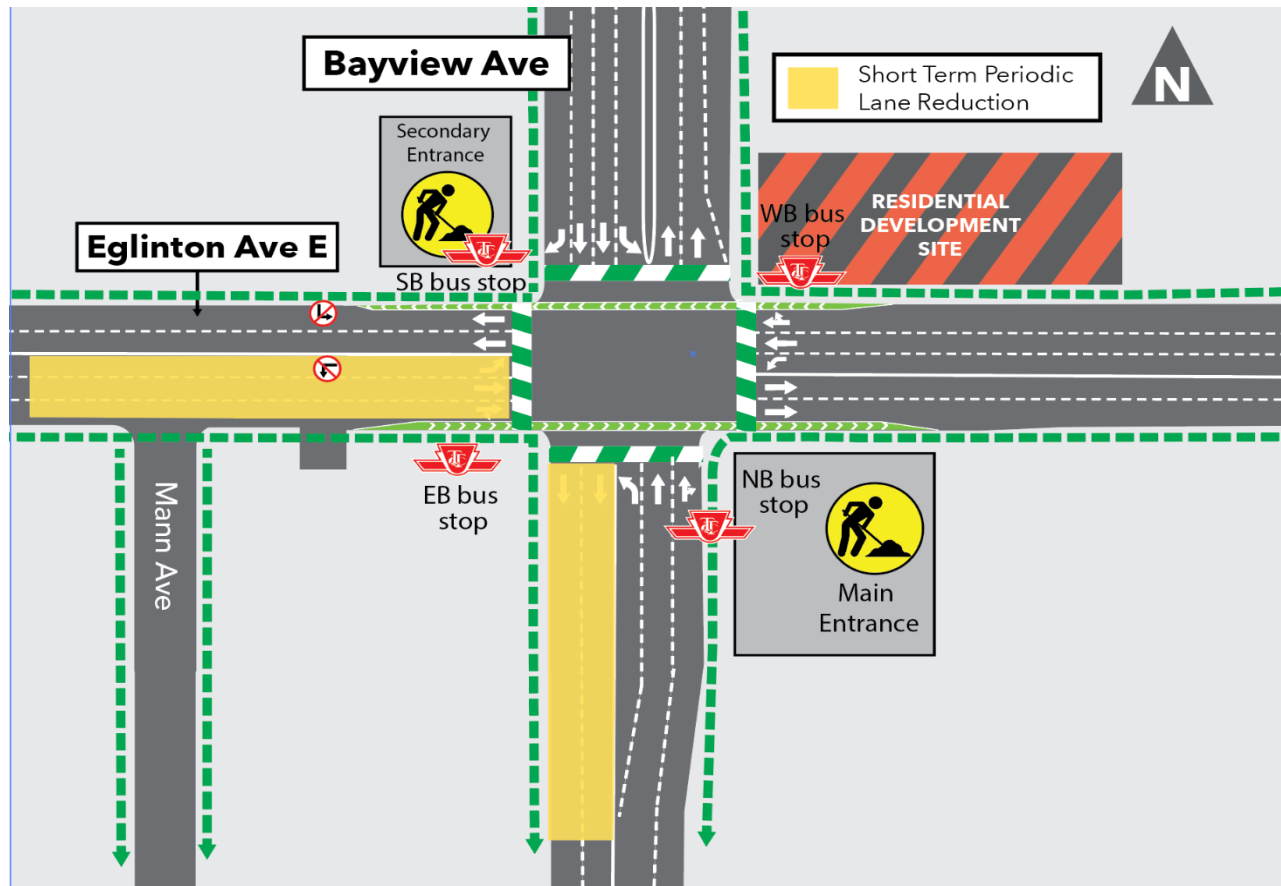

Project Overview

Metrolinx's Eglinton Crosstown LRT will be a new 19-kilometre light rail transit line in midtown Toronto. With 25 stations and stops along the dedicated route, getting across town will be up to 60% faster than before. The Crosstown will link to 54 bus routes, three TTC subway stations and

GO lines, providing important transit connections to get people to where they need to go faster than ever before.

What You Need to Know

As early as Monday, February 3, 2025, crews at Leaside Station will be performing utility works on Eglinton Avenue East and Bayview Avenue. To facilitate this work safely, short term periodic rolling lane closures will be required in the eastbound lanes on Eglinton Avenue East, west of Bayview Avenue. In addition, short term periodic rolling lane closures will be required in the southbound lanes on Bayview Avenue, south of Eglinton Avenue East. One lane of traffic in each direction will remain in place at all times. Pedestrians will be safely rerouted around the work zones. This work is expected to take place on Monday - Friday between 7:00 a.m. and 5:00 p.m. for approximately two (2) days. Upon completion of this work, short term lane reductions may be required to facilitate special activities.

WHAT TO EXPECT

- Crews will be performing utility works on Eglinton Avenue East and Bayview Avenue.
- Noise from construction activity can be expected.

HOURS OF WORK

- As early as Monday, February 3, 2025, for approximately two (2) days.
- This work is expected to take place from Monday - Friday between approximately 7:00 a.m. and 5:00 p.m.
- Work may be rescheduled due to inclement weather and/or unforeseen circumstances.
- This work may be longer or shorter than expected.

TRAFFIC DETAILS

- Short term periodic rolling lane closures will be required in the eastbound lanes on Eglinton Avenue East, west of Bayview Avenue.
- Short term periodic rolling lane closures will be required in the southbound lanes on Bayview Avenue, south of Eglinton Avenue East.
- One lane of traffic will remain in place at all times.

PEDESTRIAN DETAILS

- Pedestrian will be safely rerouted around the work zones.

TRANSIT INFORMATION

- Access to TTC will be maintained at all times.
- Please visit www.ttc.ca for more information.

Visit Our East Community Office:

Address: Unit 153, 45 Overlea Blvd., East York Town Centre
Hours of Operation: Monday to Friday, 9:00 a.m. to 5:00 p.m.
Tel: 416-482-7411

Visit Our West Community Office:

Address: 1848 Eglinton Avenue West (at Dufferin Street)
Hours of Operation: Monday to Friday, 9:00 a.m. to 5:00 p.m.
Tel: 416-782-8118

Contact Us:

- ✉ Write to us at: crosstown@metrolinx.com
- 🐦 Find us on Twitter @CrosstownTO
- 🌐 Visit the website: www.metrolinx.com/eglintoncrosstownlr