

# Temporary overnight lane closures on Yonge Street

**Expected start date:** As early as February 6, 2025

**Duration:** Through February 28, 2025

**Hours of work:** Overnight, starting at 7:00 p.m. until 5:00 a.m.

## Maps of Work Areas

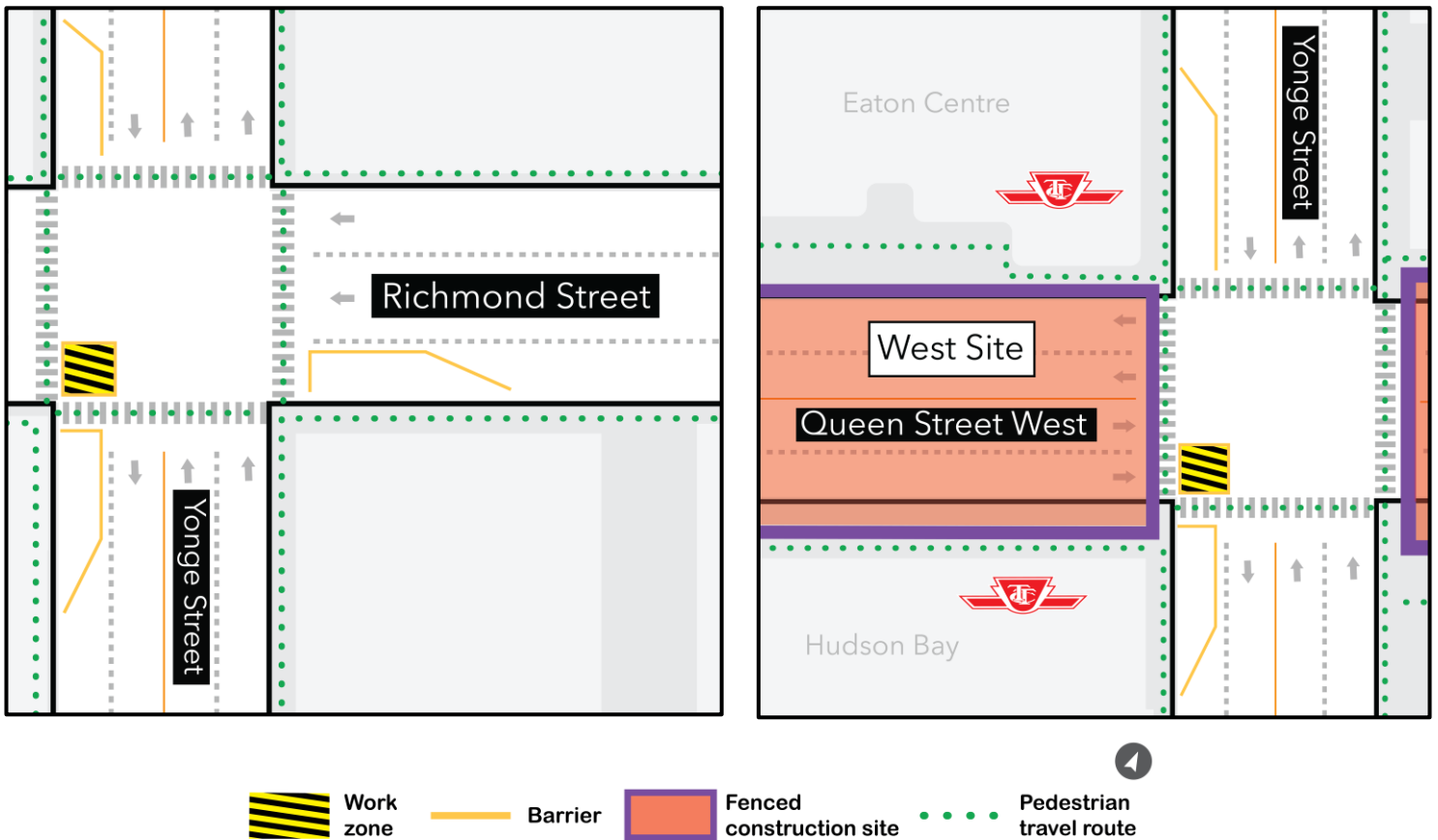

## What is happening?

To enable ongoing construction of the Ontario Line at Queen Station, utilities work to activate and energize new hydro cables must be performed near the work site, at the intersections of Yonge Street and Queen Street, as well as Yonge Street and Richmond Street (as indicated in the maps above).

Crews will be accessing Toronto Hydro cable chambers at two (2) different locations over the month of February, resulting in intermitted and roving lane closures that will take place overnight.

Pedestrian passage will remain accessible as shown in the map above. The southwest corners of each intersection will not be accessible to vehicles and bicycles. These corners will be stanchioned off with barrier pylons while the work takes place.

Work will be carried out in phases. The first phase will take place at Yonge Street and Richmond Street from February 6 to February 10. After that, work will continue at Yonge Street and Queen Street until February 28.

## What to expect

- As early as February 6, 2025, overnight work will begin to implement new electric cables at the intersection of Yonge Street and Richmond Street until February 9. Once that work is complete, crews will move to the intersection of Yonge Street and Queen Street, which will take place from February 10 through February 28.

- Most of the work will take place within the described intersections, as shown on the above maps, resulting in temporary lane closures, with safety barriers in place to protect vehicles from the closed lanes.
- There will not be any power outages as a result of this work.
- Works will occur from 7:00 p.m. through 5:00 a.m.
- Lane and closures will be in place intermittently during this timeframe.
- Traffic signage will be in place along the work zone to direct vehicles in the area.
- All necessary construction permits will be in place prior to the commencement of the work.

**Note:**

- Work may be delayed, rescheduled, or extended due to weather conditions or unforeseen circumstances.
- Visit [metrolinx.com/OntarioLineConstruction](https://www.metrolinx.com/OntarioLineConstruction) for more information on work happening in your community.

**Contact us:**

Call us 24/7 at: [416-202-5100](tel:416-202-5100)

Write to us at: [ontarioline@metrolinx.com](mailto:ontarioline@metrolinx.com)

Find us on X, Facebook, and Instagram:

[@ontarioline](#)

Visit the website:

[www.metrolinx.com/ontarioline](https://www.metrolinx.com/ontarioline)

**Visit our community offices:**

**770 Queen Street East (near Queen & Broadview)**

General hours:

Mondays, Tuesdays, and Fridays: 9:00 a.m. to 5:00 p.m.

Wednesday: 1:00 p.m. to 6:00 p.m.

Thursday: 10:00 a.m. to 6:00 p.m.

**Thornccliffe Park:**

East York Town Centre

45 Overlea Blvd., Toronto, ON M4H 1C3

Unit 153 (across from the Rogers store)

General hours:

Monday – Friday, 9 a.m. – 5 p.m.