

Traffic Deck Installation on Danforth Avenue

Expected start date: March 2025

Expected duration: Approximately one month

Hours of work: Monday to Saturday, 7 a.m. to 7 p.m.

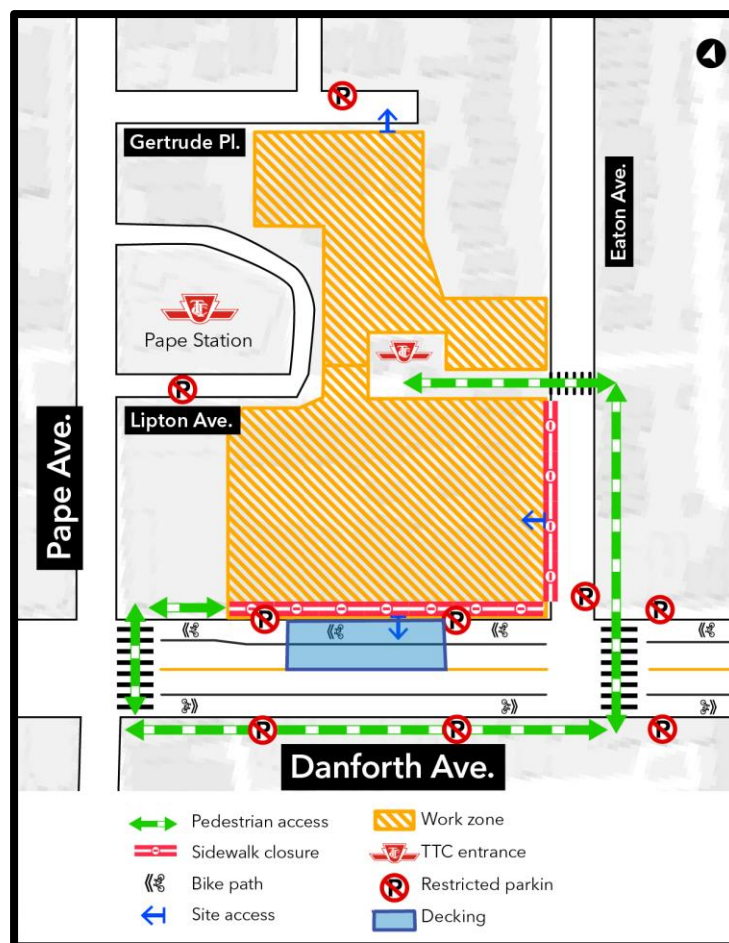

What is happening?

- In March 2025, crews will begin installing a traffic deck – a timber support structure on top of steel frames over which vehicles can travel – within the Pape-Danforth construction site along Danforth Ave. Traffic decking allows crews to work underground while traffic flows uninterrupted overtop.

- When completed, the westbound traffic lane and bike lane on Danforth Avenue will be shifted onto the deck. The north sidewalk will remain closed.
- Traffic deck installation will take place between 7 a.m. and 7 p.m., Monday through Saturday.
- The traffic deck will create new space for the existing westbound traffic lane on Danforth Avenue so future jet grouting works on Danforth Avenue can be completed without disrupting traffic.
- The traffic shift onto the deck will occur in Fall 2025, coinciding with the start of jet grouting works on Danforth Avenue. A separate notification will be distributed at that time outlining the work and the new traffic plan.

What to expect

- The installation of the traffic deck will be entirely within the existing construction site at Pape and Danforth and will not cause additional disruption.
- The north sidewalk will remain closed. Pedestrians will continue to cross Danforth Avenue using the crosswalk at Eaton Avenue. Clear and defined walking paths will be maintained to ensure public safety.
- There will be no additional impacts to street parking as a result of the traffic decking.
- Short-term traffic interruptions can be expected while trucks and equipment enter and exit work zones; traffic control personnel will be present to direct vehicles and pedestrians.
- Construction equipment and materials will be secured within the work zones.
- Signage and safety barriers will be in place to delineate work zones.
- There will be no impacts to TTC bus or subway service from this work.
- Work may be delayed due to inclement weather and/or unforeseen circumstances.
- For more information about upcoming work, please see metrolinx.com/OntarioLineConstruction or sign up for the e-newsletter at metrolinx.com/Subscribe

About the project

- 15.6-kilometre subway line that will make it faster and easier to travel within Toronto and beyond.
- 15 stops and more than 40 connections to other transit, including GO train, subway, LRT, streetcar and bus lines.
- Approximately 40 minutes from one end of the line to the other.
- 28,000 fewer cars on the road each day.

Contact us:

Call us 24/7 at: [416-202-5100](tel:416-202-5100)

Write to us at: ontarioline@metrolinx.com

Find us on Twitter, Facebook, and

Instagram: [@ontarioline](https://www.instagram.com/ontarioline)

Visit the website:

www.metrolinx.com/ontarioline

Visit our community offices:

770 Queen Street East (near Queen & Broadview)

General hours:

Mondays, Tuesdays, and Fridays: 9 a.m. to 5 p.m.

Wednesdays and Thursdays: 10 a.m. to 6 p.m.

Thorncliffe Park:

East York Town Centre

45 Overlea Blvd., Toronto, ON M4H 1C3

Unit 153 (across from the Rogers store)

General hours:

Monday to Friday, 9 a.m. to 5 p.m.