

UPDATE: Signage Installation: Parliament Street, Front Street East, Berkeley Street, King Street East

Expected start date: As early as March 24, 2025

Expected end date: Up to two weeks

Hours of work: Weekdays (Monday to Friday) from 7:00 a.m. to 7:00 p.m.

Map of work area:

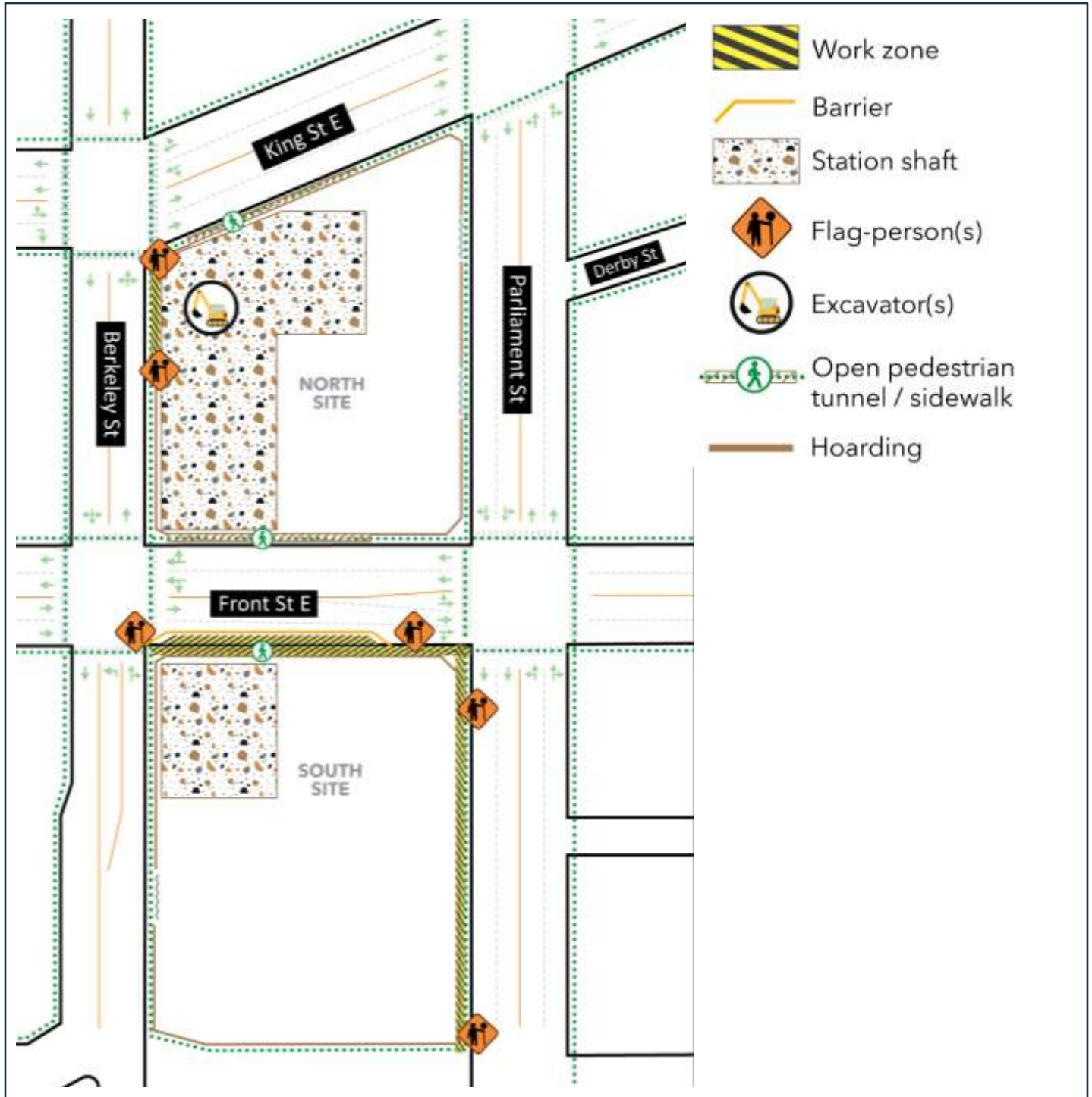

What is happening?

- **Additional** signage panels will be installed on the hoarding around the perimeter hoarding of the construction zone.
- To ensure that the public is protected during the installation process, a rolling closure of the sidewalks and a partial lane closure to facilitate the installation.
- Work originally began on the week of December 18, 2024. Installation on Front Street East and Parliament Street for this phase of work may take up to two weeks.

What to expect

- Work is expected to take place during the daytime (weekdays) between 7:00 a.m. and 7:00 p.m. from Monday to Friday. Additional working hours, including occasional Saturday shifts may be required.
- Crews are expected to be on-site prior to 7:00 a.m. to set-up equipment.

South Site

- **Commencing as early as Monday, March 24**, crews will begin to implement a partial rolling closure of the sidewalk on Front Street East at Berkeley Street, moving eastward towards Parliament Street, with the partial rolling closure continuing south of the west sidewalk on Parliament Street. See map.
- Minor impacts are expected with a partial closure of the eastbound curb lane on Front Street East between Berkeley Street and Parliament Street. See map.

North Site

- **Commencing as early as Monday, March 24**, work will continue with a partial closure of the east sidewalk on Berkeley Street at King Street East to complete installation works. See map.
- Flag-persons will be present to assist pedestrians where sidewalk closures are in effect.
- Safety barriers will be used to separate pedestrians and motorists from the work zones.
- Two-way roadway traffic will be maintained at all times.
- Clear signage will be posted for transit riders, pedestrians and motorists.
- Crews will take measures to minimize noise impacts wherever possible.
- Equipment will be cleared after every shift.
- All the necessary construction permits have been obtained.
- Work may be postponed or rescheduled due to unforeseen circumstances.
- For more information about upcoming station work please see metrolinx.com/Ontarioline or sign-up for the e-newsletter.

About the Ontario Line

- 15.6-kilometre subway line that will make it faster and easier to travel within Toronto and beyond.
- 15 stops and more than 40 connections to other transit, including GO train, subway, LRT, streetcar and bus lines.
- Less than 30 minutes from one end of the line to the other.
- 28,000 fewer car trips each day.

Contact us:

Call us 24/7 at: [416-202-5100](tel:416-202-5100)

Write to us at: ontarioline@metrolinx.com

Find us on X, Facebook, and Instagram:

[@ontarioline](#)

Visit the website:

www.metrolinx.com/ontarioline

Visit our community offices:

770 Queen Street East (near Queen & Broadview)

General hours:

Mondays, Tuesdays, and Fridays:
9:00 a.m. to 5:00 p.m.

Wednesdays: 1:00 p.m. to 6:00 p.m.
Thursdays: 10:00 a.m. to 6:00 p.m.

Thornccliffe Park:

East York Town Centre

45 Overlea Blvd., Toronto, ON M4H 1C3
Unit 153 (across from the Rogers store)

General hours:

Monday – Friday, 9:00 a.m. – 5:00 p.m.

Disponible en français sur demande. Si vous êtes intéressé, veuillez envoyer un courriel à OntarioLine@metrolinx.com