

UPDATED: Beanfield Cable Pulling

Expected Start Date: As early as April 12, 2025

Expected Duration: Two (2) days

Hours of work: Saturday and Sunday, 9 a.m. to 7 p.m.

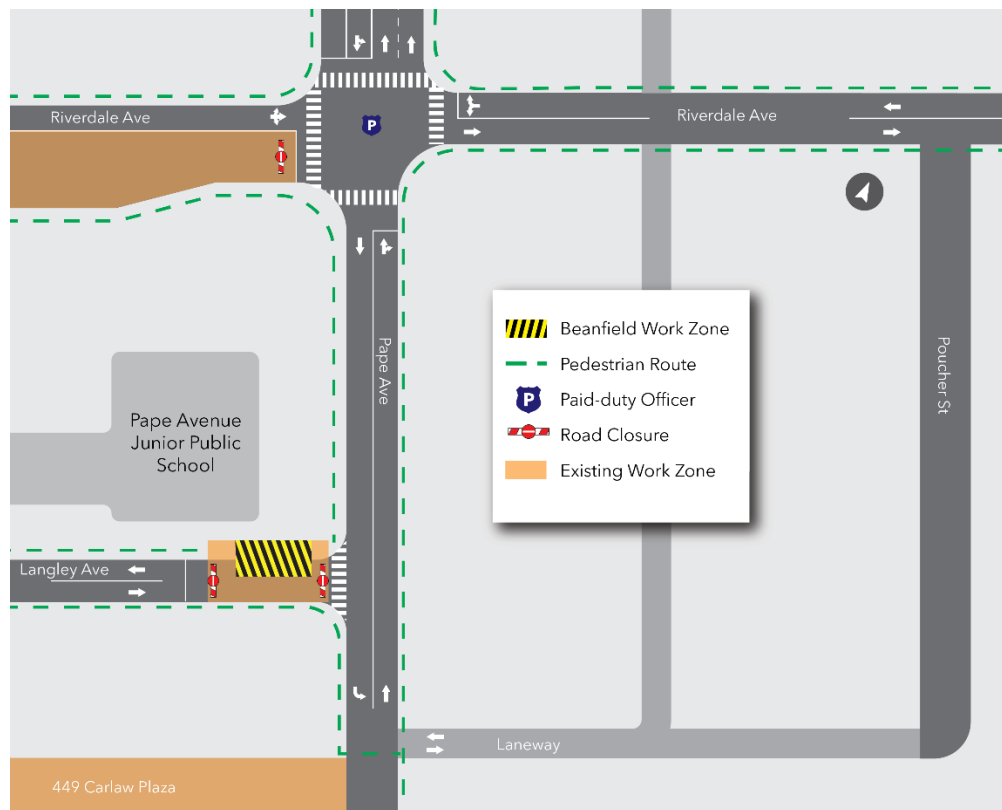

What is Happening?

- As part of the utility relocation works taking place along Pape Avenue for the Ontario Line, a crew from Beanfield will mobilize at the northwest corner of Pape and Langley for cable pulling and minor civil work.
- Work is expected to start on Saturday, April 12 and will take approximately two days to complete.

- Work will take place over a single weekend within the existing work zone on Langley Avenue.

What to expect

Construction

- Crews will be pulling cables as well as performing minor civil work to ensure duct bank access.
- A small amount of excavation will be performed with a hydrovac to clear out blocked ducts.
- Work will involve the use of cube vans, pick-up trucks, reel trailers, and may involve the use of an excavator to install cables below the ground. This is a requirement to safely protect existing utility infrastructure.
- Residents and businesses in the area may hear noise caused by work equipment. Crews will take measures to minimize noise impacts wherever possible.
- Work may be delayed due to weather conditions or unforeseen circumstances.

Traffic and Pedestrian Details

- The traffic and pedestrian measures previously implemented for existing work will be maintained during Beanfield cable pulling work.
 - Please visit metrolinx.com/ontarioline for additional details about pedestrian and traffic impacts at Pape Avenue and Langley Avenue.

Safety

- Signage will be posted around the site to direct pedestrians.
- Equipment may be left on site but will be properly secured and stored to ensure safety.

About the Ontario Line

- 15.6-kilometre subway line that will make it faster and easier to travel within Toronto and beyond.

Contact us:

Call us 24/7 at: **416-202-5100**

Write to us at:

ontarioline@metrolinx.com

Find us on Twitter, Facebook, and

Instagram: **[@ontarioline](https://www.instagram.com/ontarioline)**

Visit our website:

www.metrolinx.com/ontarioline

Visit our community offices:

770 Queen Street East (near Queen & Broadview)

General hours:

Mondays, Tuesdays, and Fridays: 9 a.m. to 5 p.m.

Wednesdays and Thursdays: 10 a.m. to 6 p.m.

Thorncliffe Park:

East York Town Centre
45 Overlea Blvd., Toronto, ON M4H 1C3
Unit 153 (across from the Rogers store)

General hours:

Monday to Friday, 9 a.m. to 5 p.m.

- 15 stops and more than 40 connections to other transit, including GO train, subway, LRT, streetcar, and bus lines.
- Less than 30 minutes from one end of the line to the other.
- 28,000 fewer cars on the road each day.

Contact us:

Call us 24/7 at: **416-202-5100**

Write to us at:

ontarioline@metrolinx.com

Find us on Twitter, Facebook, and

Instagram: **[@ontarioline](#)**

Visit our website:

www.metrolinx.com/ontarioline

Visit our community offices:

770 Queen Street East (near Queen & Broadview)

General hours:

Mondays, Tuesdays, and Fridays: 9 a.m. to 5 p.m.

Wednesdays and Thursdays: 10 a.m. to 6 p.m.

Thornccliffe Park:

East York Town Centre

45 Overlea Blvd., Toronto, ON M4H 1C3

Unit 153 (across from the Rogers store)

General hours:

Monday to Friday, 9 a.m. to 5 p.m.